

PROPERTY OF DEUTSCH E.C.D.

This drawing contains proprietary information that shall not be disclosed, duplicated, nor used in whole or in part for any purpose other than to evaluate this drawing.

A ABC16H-*****

REVISIONS			
REV	DESCRIPTION	DATE	APPROVED
A	REVISED PER E.O. D0001	111123	MA

ABC 1 6 H - * * * * - * * * *

- MODIFICATION: CONSULT FACTORY
- KEYING POSITIONS: X THRU Y
SEE ENVELOPE DRAWING 55500
- MODULE ARRANGEMENTS: SEE ENVELOPE DRAWING 55500
7000 = 1 INCH SHELL WITH NO MODULES
- STYLE: H = DYNAMIC QUARTER LOCK WITH GROUNDING BACKSHELL
- TYPES: 6 = STACKABLE PLUG SHELL
- SHELL SIZES: 1 = 1 INCH
- BASIC IDENTIFIER

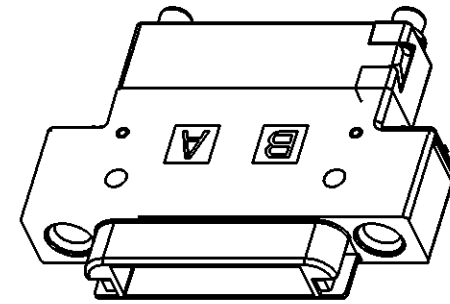

BRAID (NOT SUPPLIED)

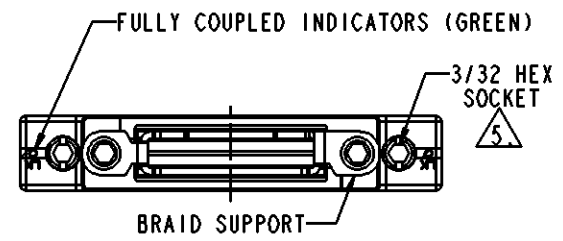
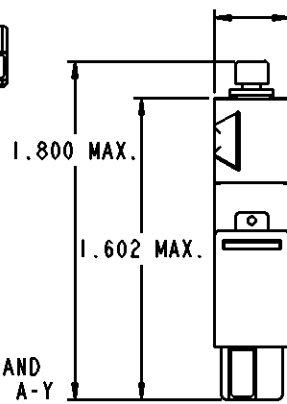

COUPLING ACTUATOR
1/4 TURN REQUIRED FOR
COUPLING AND UNCOUPLING

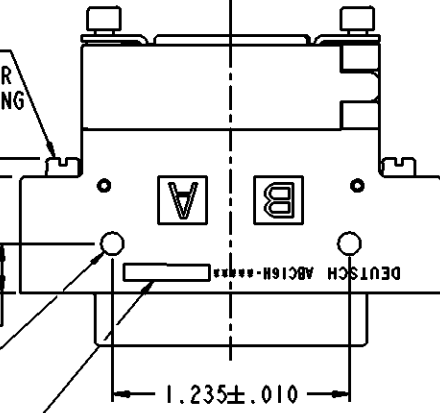
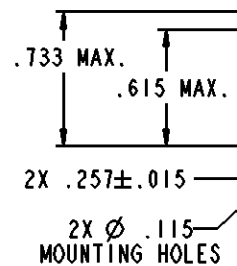

2X Ø .115
MOUNTING HOLES
CAGE AND DATE CODE

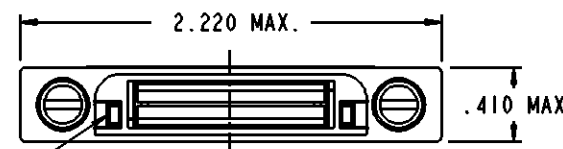

KEYING PIN

6. WHEN NO LETTER IS CALLED OUT, KEYING PINS ARE SHIPPED LOOSE AND INSTALLED BY CUSTOMER (EXAMPLE P/N: ABC26H-1972). IF LETTER A-Y IS CALLED OUT FACTORY INSTALLS THE KEYING PINS (EXAMPLE P/N: ABC26H-1972A).

5. TOOL REQUIRED (NOT SUPPLIED): 3/32 INCH HEX KEY.

4. FINISH: SHELL - NICKEL PLATED IN CONFORMANCE WITH THE PERFORMANCE REQUIREMENTS OF AFLC8810310
CONTACTS - GOLD OVER NICKEL IN CONFORMANCE WITH AS39029
BRAID SUPPORT - PASSIVATED

3. MATERIAL: SHELL - COMPOSITE IN CONFORMANCE WITH THE PERFORMANCE REQUIREMENTS OF AFLC8810310
MOUNTING HARDWARE - IN CONFORMANCE WITH AFLC8810310
CONTACTS - COPPER ALLOY IN CONFORMANCE WITH AS39029
BRAID SUPPORT - STAINLESS STEEL

2. FOR AVAILABILITY, CONSULT FACTORY.

1. DIMENSIONS ARE IN INCHES.

NOTES, UNLESS OTHERWISE SPECIFIED:

SIGNATURE & DATE	
DR	H. ZORNES 090220
CHK	H. ZORNES 090904
PE	H. ZORNES 090220
APPD	A. RENGIFO 111220
SCALE	WT

PLUG
ABC CONNECTOR
STRAIGHT GROUNDING
BACKSHELL
QUARTER LOCK COUPLING
ENVELOPE

NBO	771	MATL CODE
DEUTSCH ENGINEERED CONNECTING DEVICES 250 EDDIE JONES WAY OCEANSIDE, CA 92058		
A	ABC16H-*****	
DWG SIZE	CODE 11139	SHEET OF 1