

REVISIONS					
P	LTN	DESCRIPTION	DATE	DWN	APVD
A		NEW DRAWING	13SEP2022	BDA	DH

MATERIAL SPECIFIC DATA TABLE

TEST SPECIFICATION / MATERIAL CODE	SILICONE NICKEL GRAPHITE (SNG)	SILICONE SILVER ALUMINIUM (SSA)	FLUOROSILICONE NICKEL GRAPHITE (FNG)	FLUOROSILICONE SILVER ALUMINIUM (FSA)
RECOMMENDED OPERATING TEMPERATURE RANGE (°C)	-55 to 160	-55 to 160	-55 to 160	-55 to 160
SPECIFIC GRAVITY ± 13%	2.000	2.000	2.200	2.000
SHORE A HARDNESS ± 7	65	65	65	70
MAXIMUM VOLUME RESISTIVITY (Ω .CM)	0.05	0.008	0.05	0.012

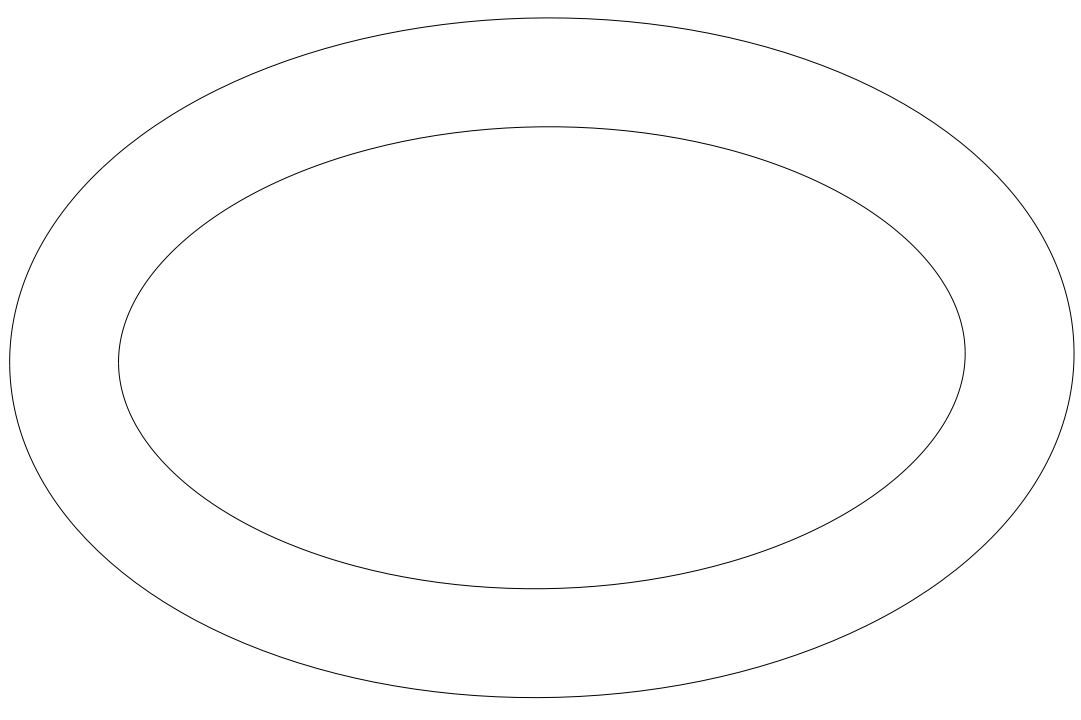
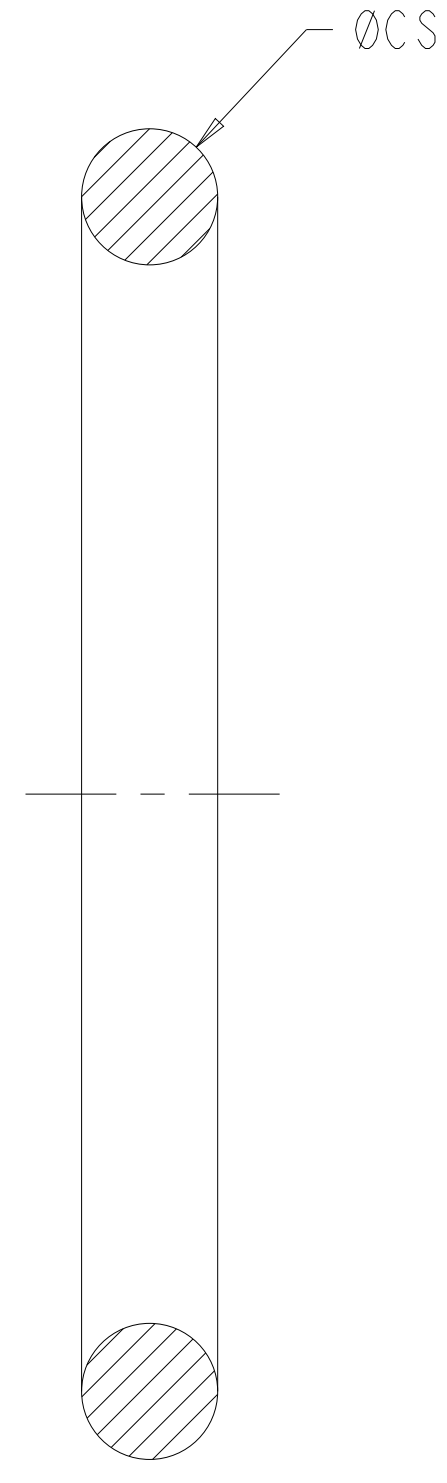
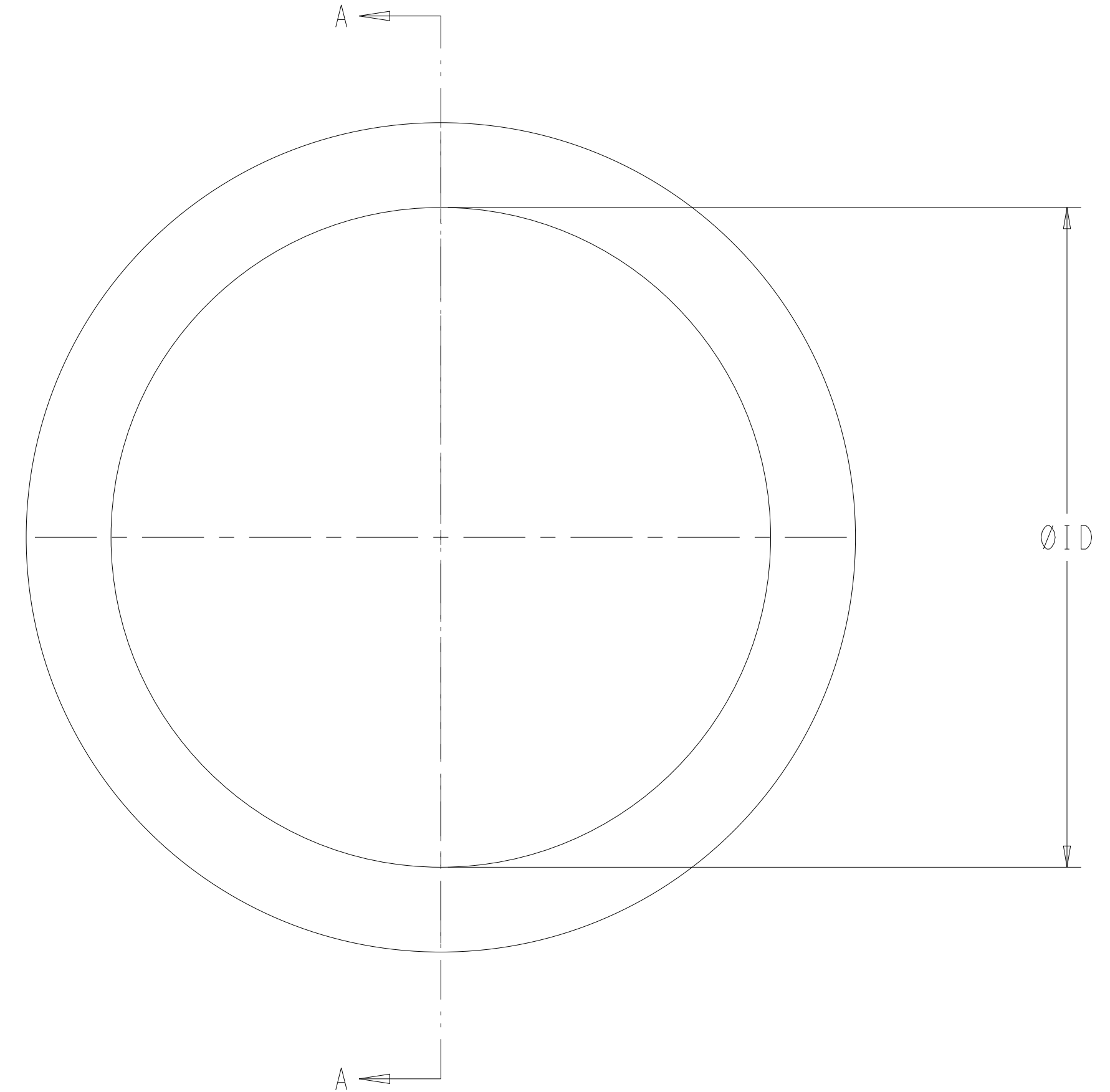

ISOMETRIC VIEW (NTS)

MIL SPEC.	MATERIAL	SHELL SIZE	COLOUR	ØCS	ØID	ALIAS PART NUMBER	PART NUMBER
FSA	25	LIGHT GREEN	2.6±0.13	47.3±0.38	98-22044-1	2430220-1	
FSA	25	LIGHT GREEN	2.6±0.13	47.3±0.38	98-22044	2430136-1	
FSA	23/24	LIGHT GREEN	2.6±0.13	44.1±0.38	98-22043-1	2430219-1	
FSA	23/24	LIGHT GREEN	2.6±0.13	44.1±0.38	98-22043	2430135-1	
FSA	21/22	LIGHT GREEN	2.6±0.13	40.9±0.38	98-22042-1	2430218-1	
FSA	21/22	LIGHT GREEN	2.6±0.13	40.9±0.38	98-22042	2430134-1	
FSA	19/20	LIGHT GREEN	2.6±0.13	37.8±0.25	98-22041-1	2430217-1	
FSA	19/20	LIGHT GREEN	2.6±0.13	37.8±0.25	98-22041	2430133-1	
FSA	17/18	LIGHT GREEN	1.8±0.1	34.7±0.25	98-22040-1	2430216-1	
FSA	17/18	LIGHT GREEN	1.8±0.1	34.7±0.25	98-22040	2430132-1	
FSA	15/16	LIGHT GREEN	1.8±0.1	31.5±0.25	98-22039-1	2430215-1	
FSA	15/16	LIGHT GREEN	1.8±0.1	31.5±0.25	98-22039	2430131-1	
FSA	13/14	LIGHT GREEN	1.8±0.1	28.3±0.25	98-22038-1	2430214-1	
FSA	13/14	LIGHT GREEN	1.8±0.1	28.3±0.25	98-22038	2430130-1	
FSA	11/12	LIGHT GREEN	1.8±0.1	25.1±0.25	98-22037-1	2430213-1	
FSA	11/12	LIGHT GREEN	1.8±0.1	25.1±0.25	98-22037	2430129-1	
FSA	9/10	LIGHT GREEN	1.8±0.1	20.4±0.25	98-22036-1	2430212-1	
FSA	9/10	LIGHT GREEN	1.8±0.1	20.4±0.25	98-22036	2430128-1	
FSA	8	LIGHT GREEN	1.8±0.1	17.2±0.25	98-22035-1	2430211-1	
FSA	8	LIGHT GREEN	1.8±0.1	17.2±0.25	98-22035	2430127-1	
FSA	6	LIGHT GREEN	1.8±0.1	14.0±0.25	98-22034-1	2430210-1	
FSA	6	LIGHT GREEN	1.8±0.1	14.0±0.25	98-22034	2430126-1	
SSA	25	BEIGE	2.6±0.13	47.3±0.38	98-22033-1	2430209-1	
SSA	25	BEIGE	2.6±0.13	47.3±0.38	98-22033	2430125-1	
SSA	23/24	BEIGE	2.6±0.13	44.1±0.38	98-22032-1	2430208-1	
SSA	23/24	BEIGE	2.6±0.13	44.1±0.38	98-22032	2430124-1	
SSA	21/22	BEIGE	2.6±0.13	40.9±0.38	98-22031-1	2430207-1	
SSA	21/22	BEIGE	2.6±0.13	40.9±0.38	98-22031	2430123-1	
SSA	19/20	BEIGE	2.6±0.13	37.8±0.25	98-22030-1	2430206-1	
SSA	19/20	BEIGE	2.6±0.13	37.8±0.25	98-22030	2430122-1	
SSA	17/18	BEIGE	1.8±0.1	34.7±0.25	98-22029-1	2430205-1	
SSA	17/18	BEIGE	1.8±0.1	34.7±0.25	98-22029	2430121-1	
SSA	15/16	BEIGE	1.8±0.1	31.5±0.25	98-22028-1	2430204-1	
SSA	15/16	BEIGE	1.8±0.1	31.5±0.25	98-22028	2430120-1	
SSA	13/14	BEIGE	1.8±0.1	28.3±0.25	98-22027-1	2430203-1	
SSA	13/14	BEIGE	1.8±0.1	28.3±0.25	98-22027	2430119-1	
SSA	11/12	BEIGE	1.8±0.1	25.1±0.25	98-22026-1	2430202-1	
SSA	11/12	BEIGE	1.8±0.1	25.1±0.25	98-22026	2430118-1	
SSA	9/10	BEIGE	1.8±0.1	20.4±0.25	98-22025-1	2430201-1	
SSA	9/10	BEIGE	1.8±0.1	20.4±0.25	98-22025	2430117-1	
SSA	8	BEIGE	1.8±0.1	17.2±0.25	98-22024-1	2430200-1	
SSA	8	BEIGE	1.8±0.1	17.2±0.25	98-22024	2430116-1	
SSA	6	BEIGE	1.8±0.1	14.0±0.25	98-22023-1	2430199-1	
SSA	6	BEIGE	1.8±0.1	14.0±0.25	98-22023	2430115-1	
FNG	25	DARK GREEN	2.6±0.13	47.3±0.38	98-22022-1	2430198-1	
FNG	25	DARK GREEN	2.6±0.13	47.3±0.38	98-22022	2430114-1	
FNG	23/24	DARK GREEN	2.6±0.13	44.1±0.38	98-22021-1	2430197-1	
FNG	23/24	DARK GREEN	2.6±0.13	44.1±0.38	98-22021	2430113-1	
FNG	21/22	DARK GREEN	2.6±0.13	40.9±0.38	98-22020-1	2430196-1	
FNG	21/22	DARK GREEN	2.6±0.13	40.9±0.38	98-22020	2430112-1	
FNG	19/20	DARK GREEN	2.6±0.13	37.8±0.25	98-22019-1	2430195-1	
FNG	19/20	DARK GREEN	2.6±0.13	37.8±0.25	98-22019	2430111-1	
FNG	17/18	DARK GREEN	1.8±0.1	34.7±0.25	98-22018-1	2430194-1	
FNG	17/18	DARK GREEN	1.8±0.1	34.7±0.25	98-22018	2430110-1	
FNG	15/16	DARK GREEN	1.8±0.1	31.5±0.25	98-22017-1	2430193-1	
FNG	15/16	DARK GREEN	1.8±0.1	31.5±0.25	98-22017	2430109-1	
FNG	13/14	DARK GREEN	1.8±0.1	28.3±0.25	98-22016-1	2430192-1	
FNG	13/14	DARK GREEN	1.8±0.1	28.3±0.25	98-22016	2430108-1	
FNG	11/12	DARK GREEN	1.8±0.1	25.1±0.25	98-22015-1	2430191-1	
FNG	11/12	DARK GREEN	1.8±0.1	25.1±0.25	98-22015	2430107-1	
FNG	9/10	DARK GREEN	1.8±0.1	20.4±0.25	98-22014-1	2430190-1	
FNG	9/10	DARK GREEN	1.8±0.1	20.4±0.25	98-22014	2430106-1	
FNG	8	DARK GREEN	1.8±0.1	17.2±0.25	98-22013-1	2430189-1	
FNG	8	DARK GREEN	1.8±0.1	17.2±0.25	98-22013	2430105-1	
FNG	6	DARK GREEN	1.8±0.1	14.0±0.25	98-22012-1	2430188-1	
FNG	6	DARK GREEN	1.8±0.1	14.0±0.25	98-22012	2430104-1	
SNG	25	DARK GREY	2.6±0.13	47.3±0.38	98-22011-1	2430187-1	
SNG	25	DARK GREY	2.6±0.13	47.3±0.38	98-22011	2430103-1	
SNG	23/24	DARK GREY	2.6±0.13	44.1±0.38	98-22010-1	2430186-1	
SNG	23/24	DARK GREY	2.6±0.13	44.1±0.38	98-22010	2430102-1	
SNG	21/22	DARK GREY	2.6±0.13	40.9±0.38	98-22009-1	2430185-1	
SNG	21/22	DARK GREY	2.6±0.13	40.9±0.38	98-22009	2430101-1	
SNG	19/20	DARK GREY	2.6±0.13	37.8±0.25	98-22008-1	2430184-1	
SNG	19/20	DARK GREY	2.6±0.13	37.8±0.25	98-22008	2430100-1	
SNG	17/18	DARK GREY	1.8±0.1	34.7±0.25	98-22007-1	2430183-1	
SNG	17/18	DARK GREY	1.8±0.1	34.7±0.25	98-22007	2430099-1	
SNG	15/16	DARK GREY	1.8±0.1	31.5±0.25	98-22006-1	2430182-1	
SNG	15/16	DARK GREY	1.8±0.1	31.5±0.25	98-22006	2430098-1	
SNG	13/14	DARK GREY	1.8±0.1	28.3±0.25	98-22005-1	2430181-1	
SNG	13/14	DARK GREY	1.8±0.1	28.3±0.25	98-22005	2430097-1	
SNG	11/12	DARK GREY	1.8±0.1	25.1±0.25	98-22004-1	2430180-1	
SNG	11/12	DARK GREY	1.8±0.1	25.1±0.25	98-22004	2430096-1	
SNG	9/10	DARK GREY	1.8±0.1	20.4±0.25	98-22003-1	2430179-1	
SNG	9/10	DARK GREY	1.8±0.1	20.4±0.25	98-22003	2430095-1	
SNG	8	DARK GREY	1.8±0.1	17.2±0.25	98-22002-1	2430178-1	
SNG	8	DARK GREY	1.8±0.1	17.2±0.25	98-22002	2430094-1	
SNG	6	DARK GREY	1.8±0.1	14.0±0.25	98-22001-1	2430177-1	
SNG	6	DARK GREY	1.8±0.1	14.0±0.25	98-22001	2430093-1	

MIL-DTL-38999
MIL-DTL-26482

THIS DRAWING IS A CONTROLLED DOCUMENT. DWN: BASAVARAJA D A, 13SEP2022
CHK: B. SELVAPANDIAN, 13SEP2022
APVD: D. HEMMING, 13SEP2022

TE TE Connectivity

NAME: 98-SERIES-JAM-NUT-SEALS

SIZE: A | CAGE CODE: 00779 | DRAWING NO: 00779 | REV: A

SCALE: 10:1 | SHEET: 1 OF 1