

REVISIONS

P	LTR	DESCRIPTION	DATE	DWN	APVD
	D1	REVISED PER ECN-23-215330	24JUL2023	RK	MF

POS. PER ROW	L±0.4	PART NO.
-	-	-
2	5.08	829706-2
3	7.62	3
4	10.16	4
5	12.70	5
6	15.24	6
7	17.78	7
8	20.32	8
9	22.86	9
10	25.40	1- -0
11	27.94	1- -1
12	30.48	1- -2
13	33.02	1- -3
14	35.56	1- -4
15	38.10	1- -5
16	40.64	1- -6
17	43.18	1- -7
18	45.72	1- -8
19	48.26	1- -9
20	50.80	2- -0
21	53.34	2- -1
22	55.88	2- -2
23	58.42	2- -3
24	60.96	2- -4
25	63.50	2- -5
26	66.04	2- -6
27	68.58	2- -7
28	71.12	2- -8
29	73.66	2- -9
30	76.20	3- -0
31	78.74	3- -1
32	81.28	3- -2
33	83.82	3- -3
34	86.36	3- -4
35	88.90	3- -5
36	91.44	3- -6
37	93.98	3- -7
38	96.52	3- -8
39	99.06	3- -9
40	101.60	4- -0
41	104.14	4- -1
42	106.68	4- -2
43	109.22	4- -3
44	111.76	4- -4
45	114.30	4- -5
46	116.84	4- -6
47	119.38	4- -7
48	121.92	4- -8
49	124.46	4- -9
50	127.00	5- 829706-0

FINISH/COLOR	MATERIAL	DESCRIPTION
	CuZn	CONTACT PIN
GREEN	PBT	PIN HOUSING

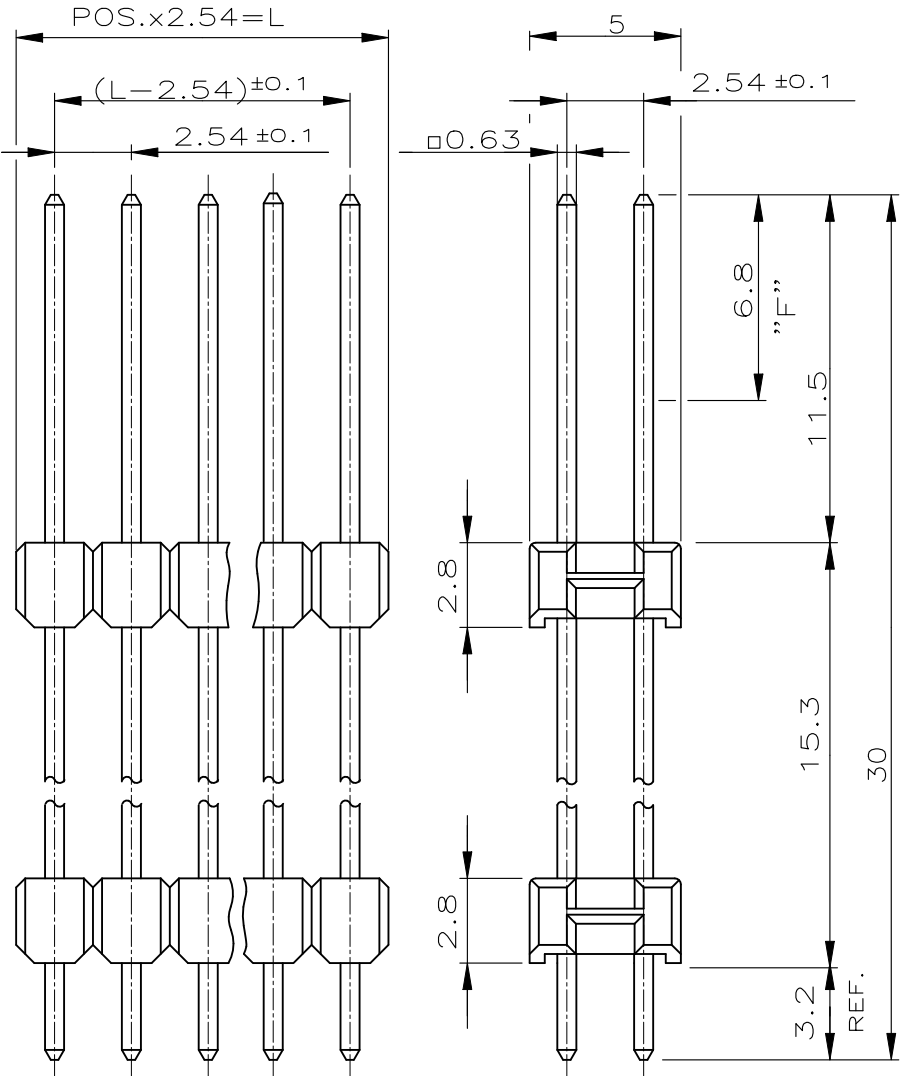

NOTES:

- MATING SIDE: MIN 0.7µm PdNi+ MIN 0.1µm GOLD FLASH IN ZONE "F" OVER 1.27µm NICKEL
SOLDER SIDE: 3.0 TO 5.0µm TIN OVER 1.27µm NICKEL.
- OBSOLETE PARTS: OBSOLETE CIS STREAMLINING PER D.RENAUD/D.SINISI
- OBSOLETE PARTS: OBSOLETE CIS STREAMLINING PER D.RENAUD/D.SINISI

TE Connectivity. All Rights Reserved.



DIMENSIONS:

mm

TOLERANCES UNLESS OTHERWISE SPECIFIED:

±0.2

0 PLC	± -
1 PLC	± -
2 PLC	± -
3 PLC	± -
4 PLC	± -
ANGLES	± -

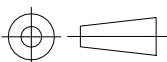

DWN A.HO	08.10.90	MATERIAL SEE TABLE	FINISH SEE TABLE
CHK M.SCHAARSCHMIDT	-	TE Connectivity	
APVD -	-		
PRODUCT SPEC 108-18012	NAME AMPMODU II STACKING PIN HEADER, DUAL ROW	-	
APPLICATION SPEC -	SIZE A4	CAGE CODE 00779	DRAWING NO C-829706
WEIGHT -	RESTRICTED TO -		SCALE 4:1
CUSTOMER DRAWING		SHEET 1 OF 1	REV D1