

P	LTR	DESCRIPTION	DATE	DWN	APVD
N		REVISED PER ECR-24-226486	20NOV2024	TB	JP

1 PINS TO COMPLY WITH AMP SOLDERABILITY SPEC. 109-11-3.

2 0.00381 MIN MATTE TIN LEAD PLATE OVER 0.00127 MIN NICKEL.

3 0.00076 MIN GOLD PLATE IN THE LOCALIZED PLATE AREA, 0.00381 MATTE TIN LEAD IN THE LOCALIZED PLATE AREA, BOTH OVER 0.00127 MIN NICKEL.

4 0.00381 MIN MATTE TIN PLATE OVER 0.00127 MIN NICKEL.

5 0.00076 MIN GOLD PLATE IN THE LOCALIZED PLATE AREA, 0.00381 MATTE TIN IN THE LOCALIZED PLATE AREA, BOTH OVER 0.00127 MIN NICKEL.

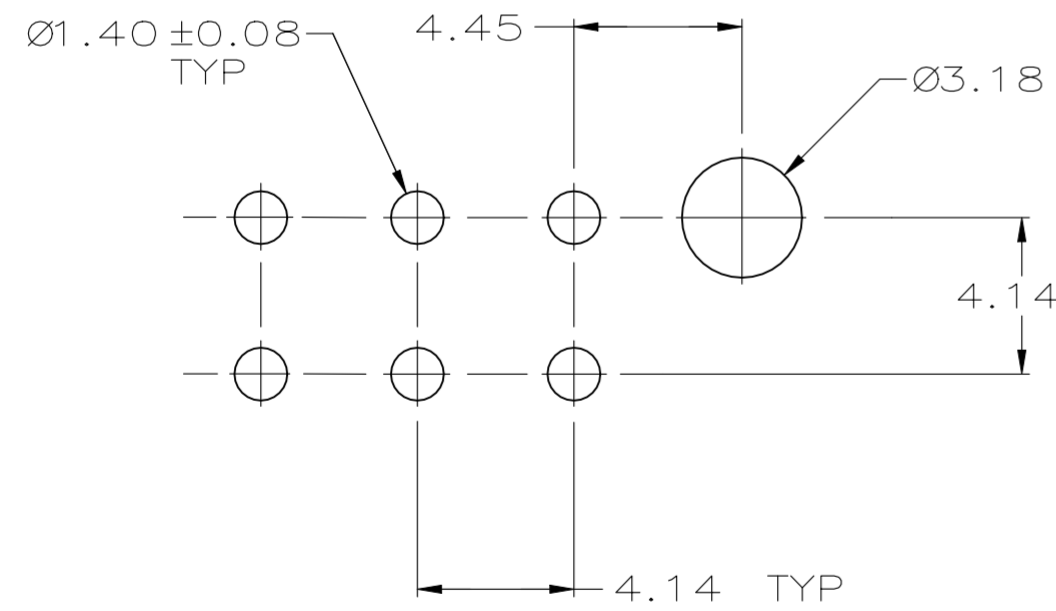
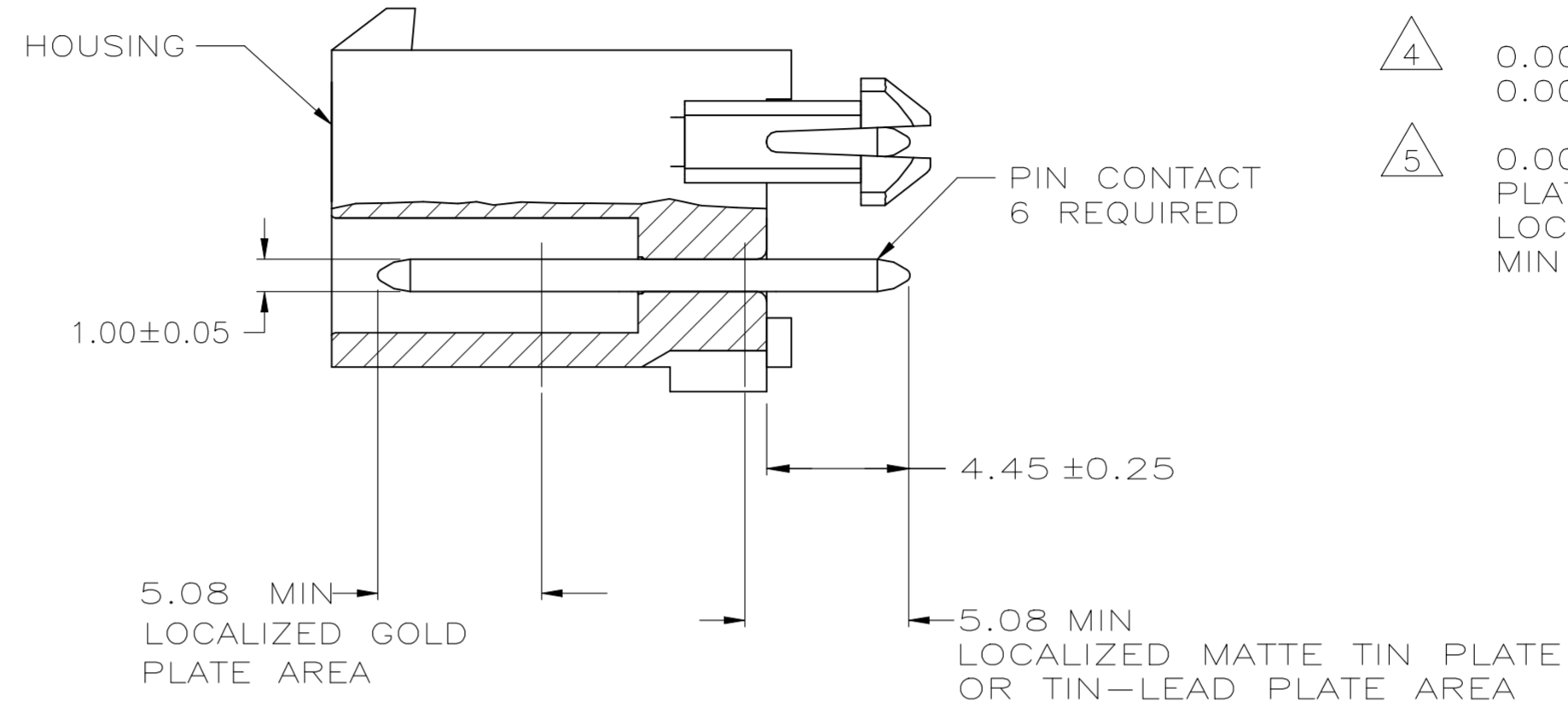
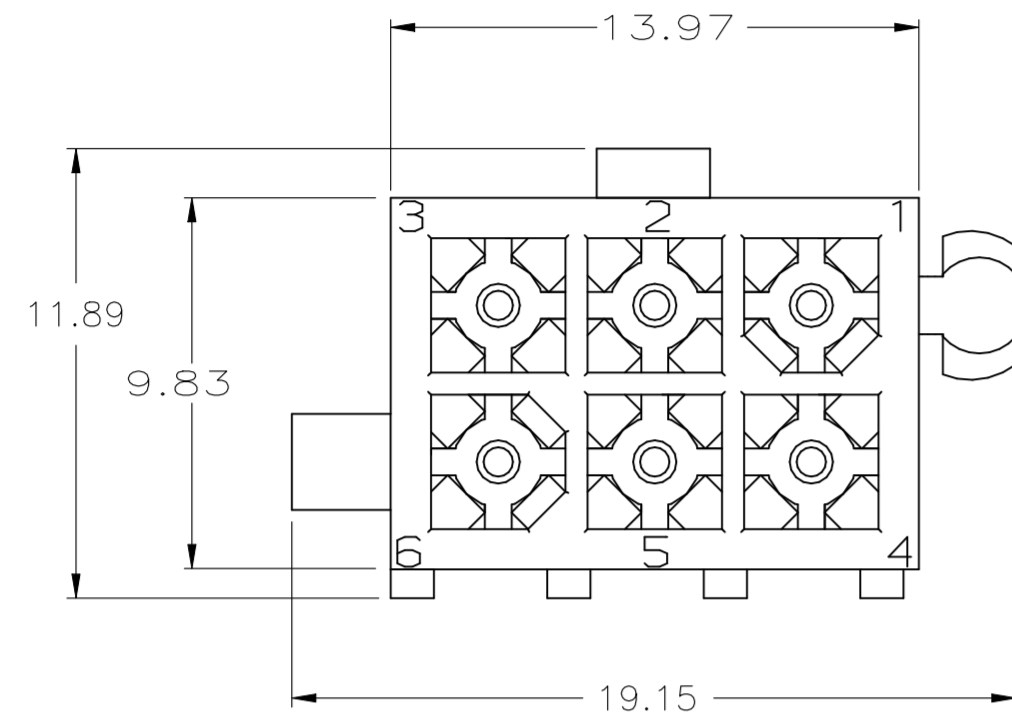

RECOMMENDED LAYOUT FOR 1.57 THICK BOARD
TOLERANCES NON-ACCUMULATIVE

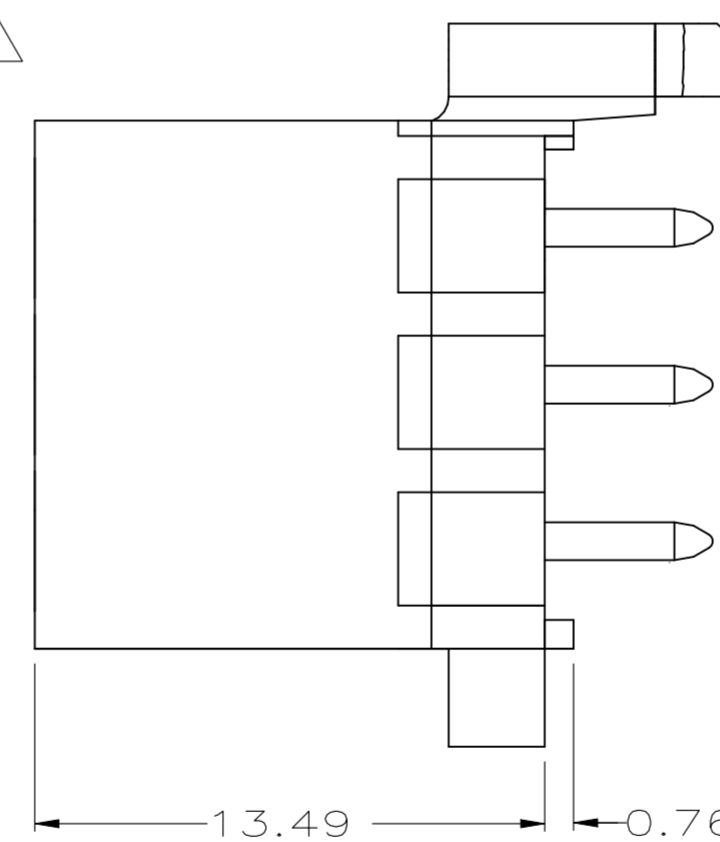

SUPERSEDE WITH 1-770178-1
SUPERSEDE WITH 1-770178-0

MATERIAL	FINISH	MATERIAL	COLOR	PART NO.
BRASS, TIN	4	NYLON, UL94V-0	BLACK	5-770178-0
BRASS, GOLD	5	NYLON, UL94V-0	WHITE	1-770178-1
BRASS, TIN	4	NYLON, UL94V-0	WHITE	1-770178-0
BRASS, GOLD	3	NYLON, UL94V-0	WHITE	770178-2
BRASS, TIN-LEAD	2	NYLON, UL94V-0	WHITE	770178-1

THIS DRAWING IS A CONTROLLED DOCUMENT.		DWN S CARPENTER 08JUN05	TE TE Connectivity	
DIMENSIONS: mm		CHK R JONES 28JUL2003		
TOLERANCES UNLESS OTHERWISE SPECIFIED:		APVD R JONES 28JUL2003	NAME	
0 PLC ± -	1 PLC ± -	PRODUCT SPEC	HEADER ASSEMBLY, 6 CKT, MINI UNIVERSAL, MATE-N-LOK	
2 PLC ± 0.13	3 PLC ± -	APPLICATION SPEC	SIZE	CAGE CODE
4 PLC ± -	ANGLES ± -	WEIGHT	A2	00779
MATERIAL	FINISH	CUSTOMER DRAWING	DRAWING NO	RESTRICTED TO
-	-	SCALE 5:1	C=770178	1 OF 1
			SHEET	REV N