

REVISIONS					
P	LTR	DESCRIPTION	DATE	DWN	APVD
	E	REV PER ECN-25-311031	13MAR2025	LP	PD

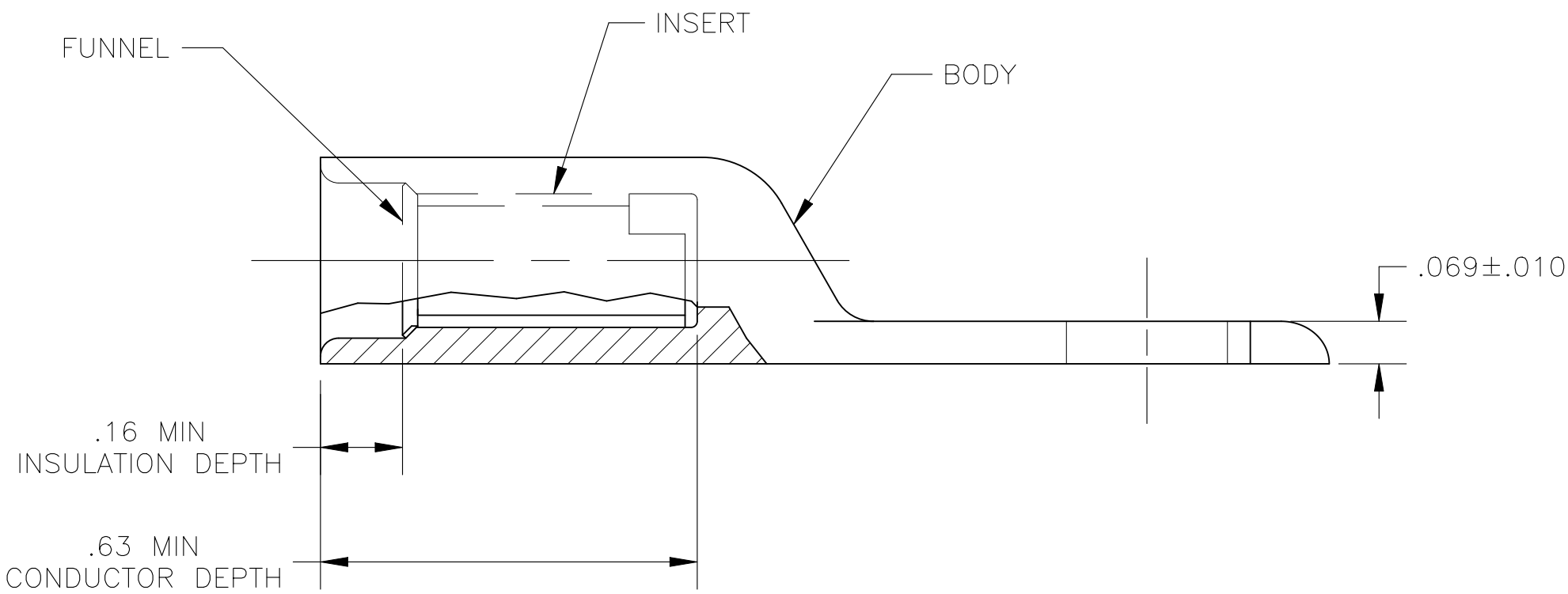
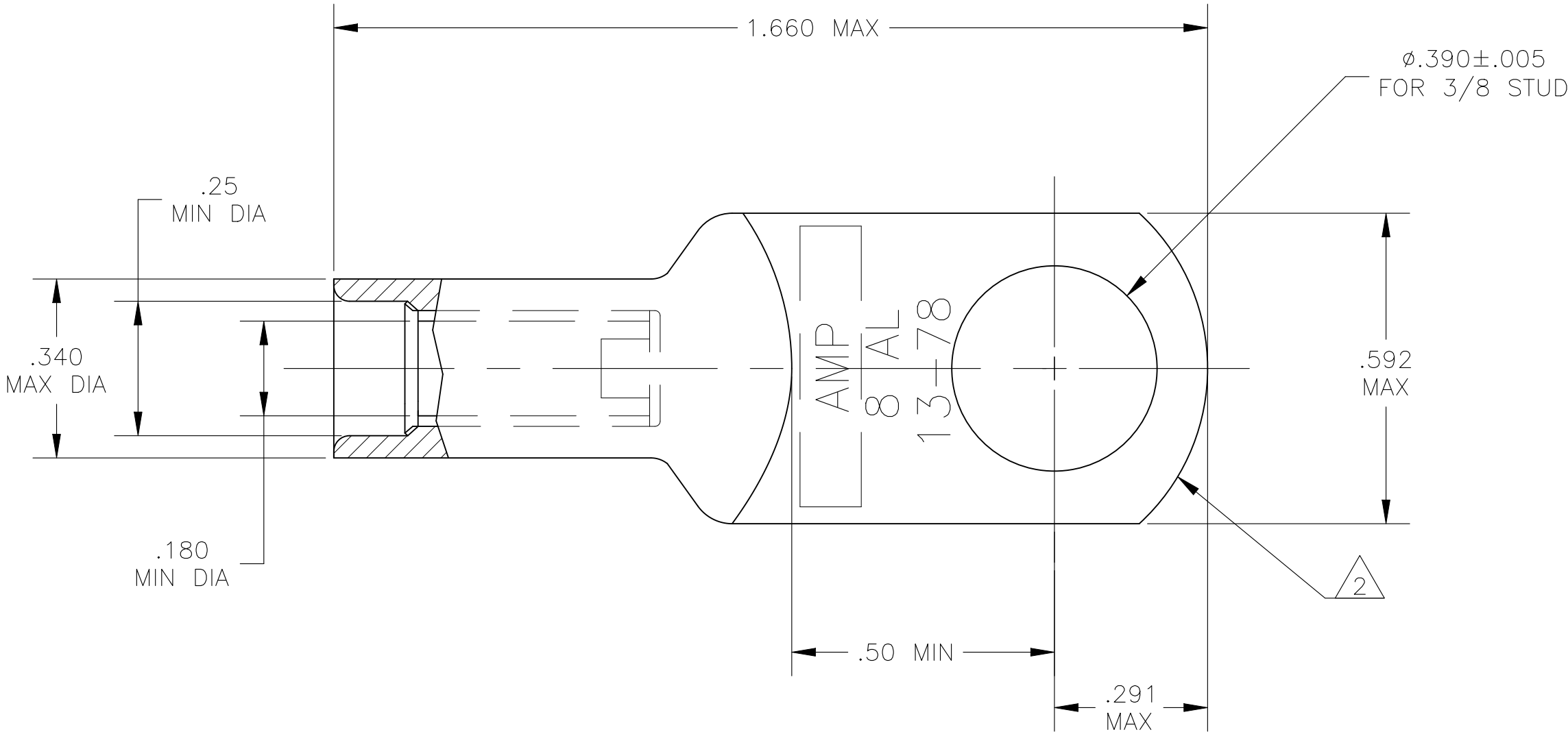

- 1 WIRE INSULATION: .220-.248 DIA
- 2 THE TONGUE RADIUS FEATURE IS NOT A TOOLING CONTROLLED DIMENSION AND MAY NOT BE A TRUE RADIUS.
3. .020 FLASH PERMITTED ON WIRE BARRELL DUE TO IMPACTING
- 4 STAMP "AMP 8 AL 13-78" SIZE AND LOCATION APPROX AS SHOWN
5. SEE TE CONNECTIVITY INSTRUCTION SHEET 408-2281 FOR TOOLING AND CRIMP INSTRUCTIONS, FIGURE 2 FOR WIRE STRIPPING DETAIL.

OBSOLETE

WARNING - THIS DOCUMENT CONTAINS TECHNOLOGY WHOSE EXPORT IS RESTRICTED BY THE EXPORT ADMINISTRATION REGULATIONS ("EAR") PURSUANT TO 15 C.F.R. PARTS 730-774. VIOLATIONS OF THE EAR ARE SUBJECT TO SEVERE CRIMINAL PENALTIES UNDER THE EXPORT CONTROL REFORM ACT, AS AMENDED (TITLE 50, U.S.C., SEC. 4801, ET SEQ.).

INSERT & FUNNEL: BRASS MIL-C-50 NICKEL PL QQ-N-290 .000300 AVG THK	696866-1
BODY: COPPER ASTM-B187 ANNEALED TIN PL PER ASTM B-545 .000150 MIN THK	
MATERIAL & FINISH	PART NO.

THIS DRAWING IS A CONTROLLED DOCUMENT.		DWN JR. RUTH 21NOV05	TE Connectivity		
DIMENSIONS: INCHES		CHK MS. FEHER 21NOV05			
		APVD MJ. SPICER 21NOV05	NAME WIRE TERMINAL, COPALUM, SEALED, RING TONGUE, WIRE SIZE: #8 AL		
		PRODUCT SPEC			
TOLERANCES UNLESS OTHERWISE SPECIFIED:		APPLICATION SPEC	SIZE A2 CAGE CODE 00779 DRAWING NO C-696866 RESTRICTED TO -		
MATERIAL SEE TABLE		FINISH SEE TABLE			
		WEIGHT 0.000000	SCALE 4:1 SHEET 1 OF 1 REV E		
		CUSTOMER DRAWING			