

D

D

C

C

B

B

A

A

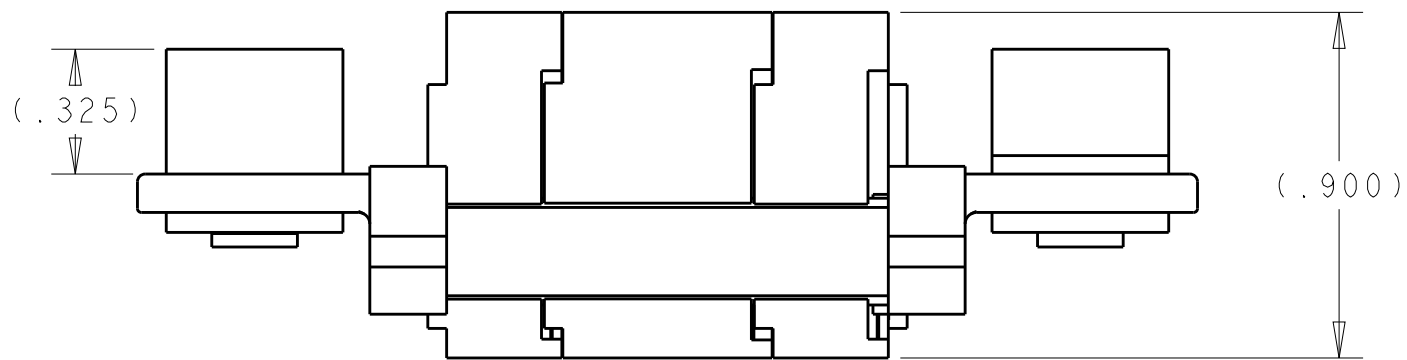
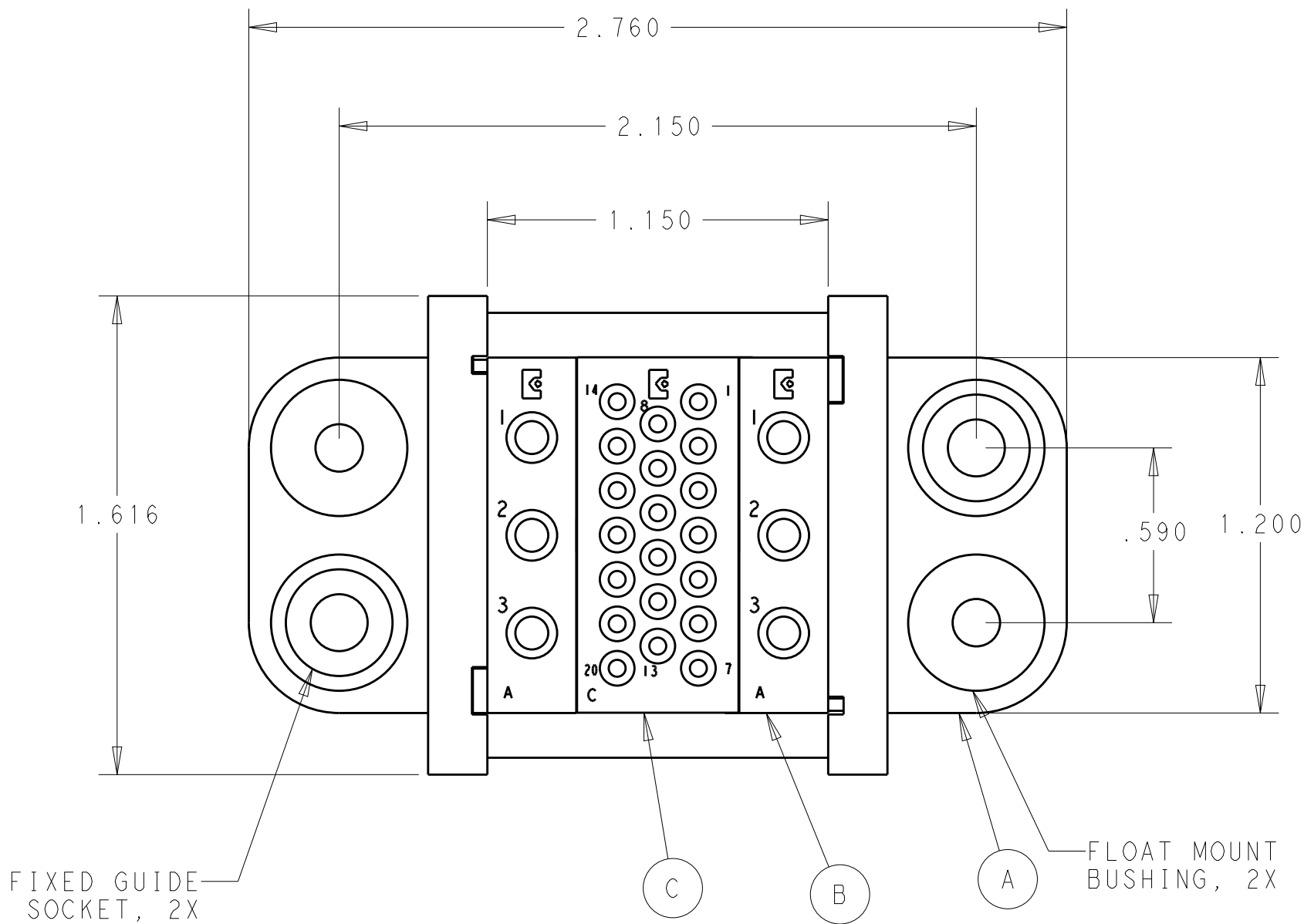

1. ITEMS PROVIDED TO THIS SPECIFICATION TO BE PERMANENTLY IDENTIFIED PER THE FOLLOWING IDENTIFIER:
- TE PART NUMBER AND MANUFACTURING DATE CODE.
2. MOUNTING FLANGE BUSHING ACCEPT 6/32 SCREW(\varnothing .156 CLERANCE HOLE, FLOAT MOUNT) OR 8/32 SCREW (\varnothing .173 CLERANCE HOLE, FIXED MOUNT), USER SUPPLIED.
3. SOCKET CRIMP CONTACT (ITEM D & E) ARE PACKAGED SEPERATELY AND SHIPPED LOOSE WITH THE CONNECTOR ASSEMBLY.
4. THE SOCKET CONNECTOR MATES WITH PIN CONNECTOR 6646146-1

2	1648325-1	SOCKET CONTACT, SIZE# 20,CRIMP	E
5	1648318-1	SOCKET CONTACT, SIZE# 12,CRIMP	D
1	1648468-1	MODULE C	C
3	1648466-1	MODULE A	B
2	6648254-1	END CAP, FLOAT MNT., GUIDE SOCKET	A
-1	PART NO.	DESCRIPTION	ITEM

THIS DRAWING IS A CONTROLLED DOCUMENT.		DWN GRANDO LI 19DEC2016	TE Connectivity			
DIMENSIONS: in		CHK SUNY ZHAO 19DEC2016				
		APVD SUNY ZHAO 19DEC2016	NAME SOCKET CONENCTOR ASSY W/PANEL CUTOUT DOMINO EDS11090-A			
		PRODUCT SPEC -	SIZE A2			
TOLERANCES UNLESS OTHERWISE SPECIFIED:		APPLICATION SPEC -	CAGE CODE -			
MATERIAL TBD		WEIGHT -	DRAWING NO C=6646147			
finish_spec_2		CUSTOMER DRAWING	RESTRICTED TO -			
			SCALE 1:1	SHEET 1	OF 2	REV A

D

C

B

A

D

C

B

A

THIS DRAWING IS UNPUBLISHED.		RELEASED FOR PUBLICATION		20
© COPYRIGHT 20	BY -	ALL RIGHTS RESERVED.		

REVISIONS					
P	LTR	DESCRIPTION	DATE	DWN	APVD
	-	SEE SHEET 1	-	-	-

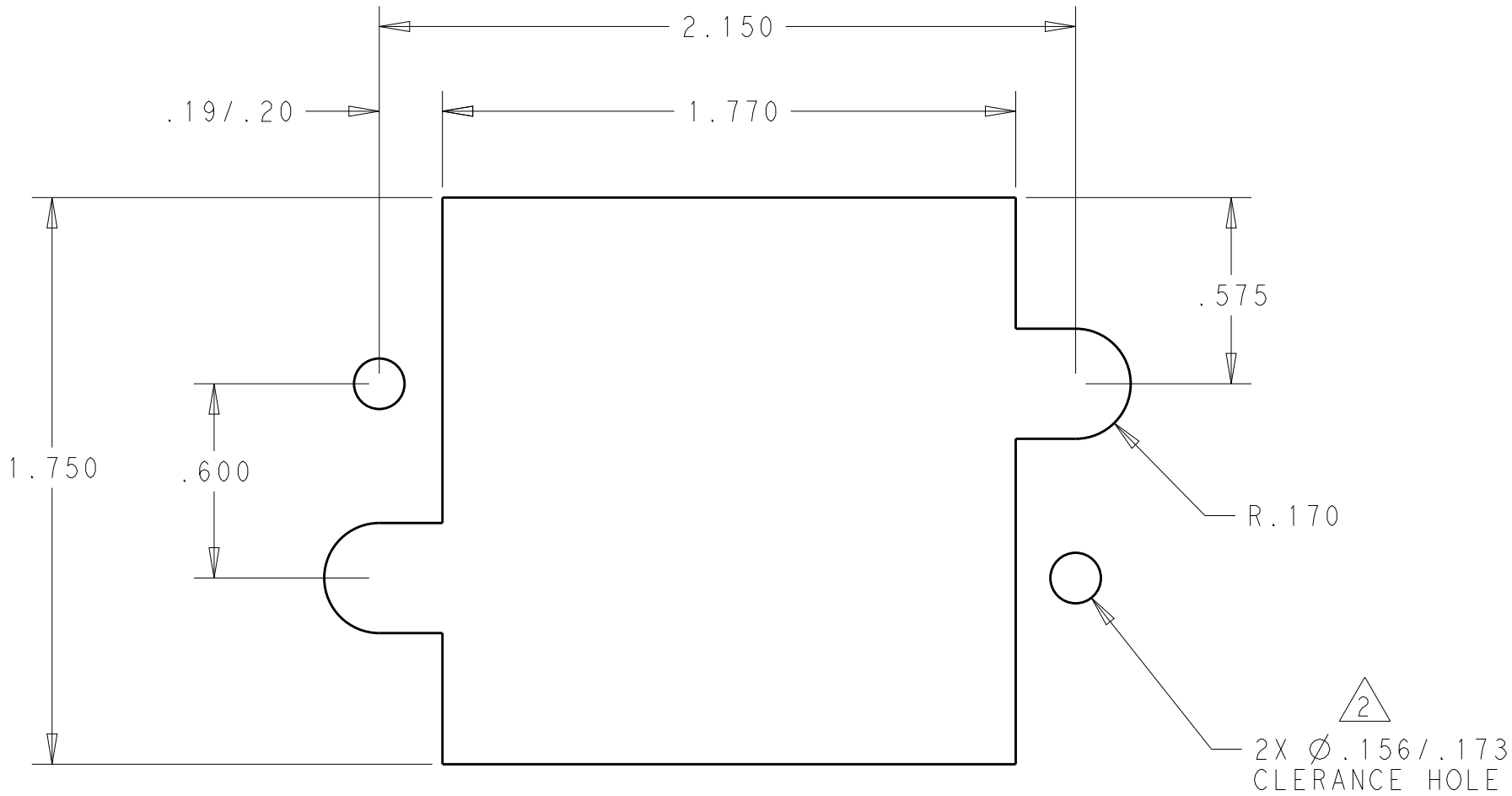

SOCKET PANEL MOUNT CUTOUT

THIS DRAWING IS A CONTROLLED DOCUMENT.		DWN GRANDO LI 19DEC2016	TE Connectivity			
		CHK SUNY ZHAO 19DEC2016				
		APVD SUNY ZHAO 19DEC2016	NAME SOCKET CONENCTOR ASSY W/PANEL CUTOUT DOMINO EDS11090-A			
DIMENSIONS: in		TOLERANCES UNLESS OTHERWISE SPECIFIED: 0 PLC ±- 1 PLC ±- 2 PLC ±.02 3 PLC ±.010 4 PLC ±- ANGLES ±- FINISH -	PRODUCT SPEC -	SIZE A2	CAGE CODE -	DRAWING NO C-6646147
MATERIAL TBD material_2		FINISH -	APPLICATION SPEC -	WEIGHT -	SCALE 1:1	
CUSTOMER DRAWING				SHEET 2	OF 2	REV A