

THIS DRAWING IS UNPUBLISHED. RELEASED FOR PUBLICATION 2006  
 © COPYRIGHT 2006 BY - ALL RIGHTS RESERVED.

REVISIONS				
P	LTR	DESCRIPTION	DATE	APVD
F		REVISED PER ECR-17-013826	20SEP2017	T.S E.T

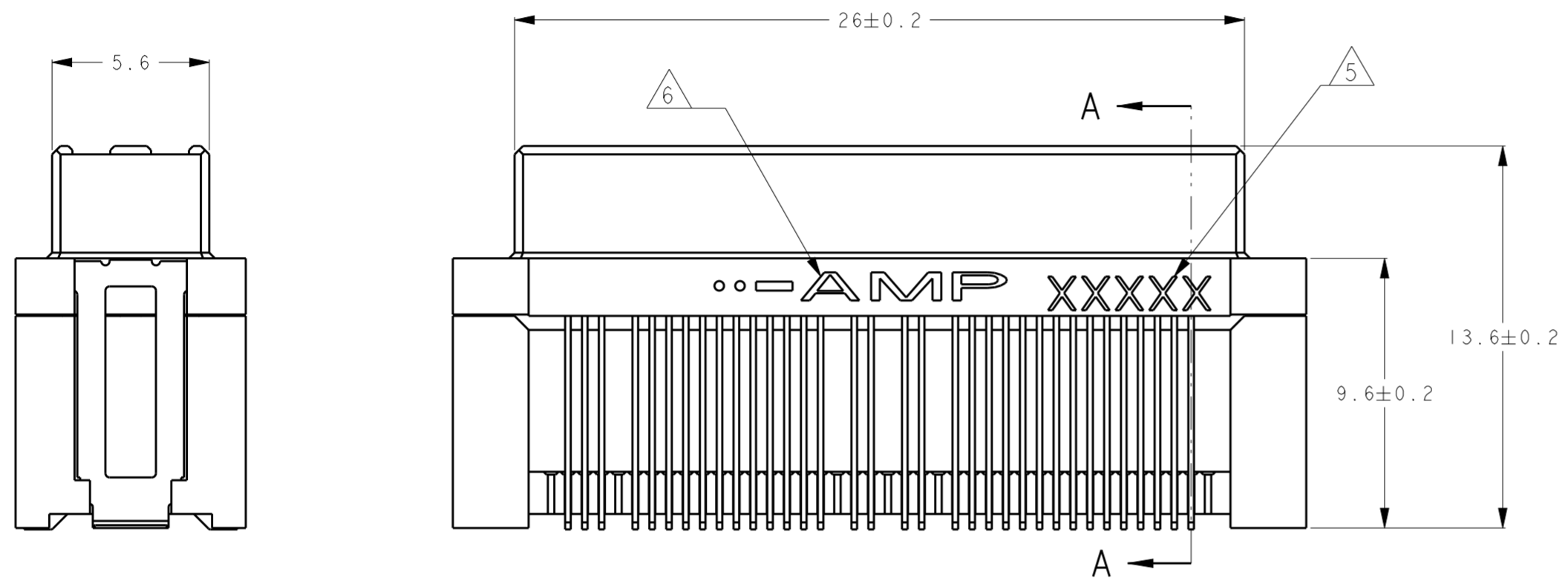

A - A  
SCALE 8:1

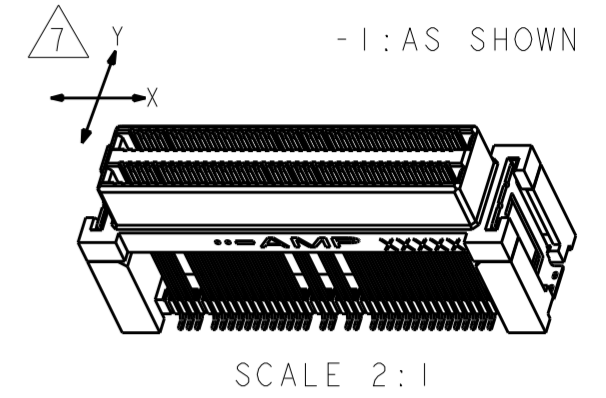
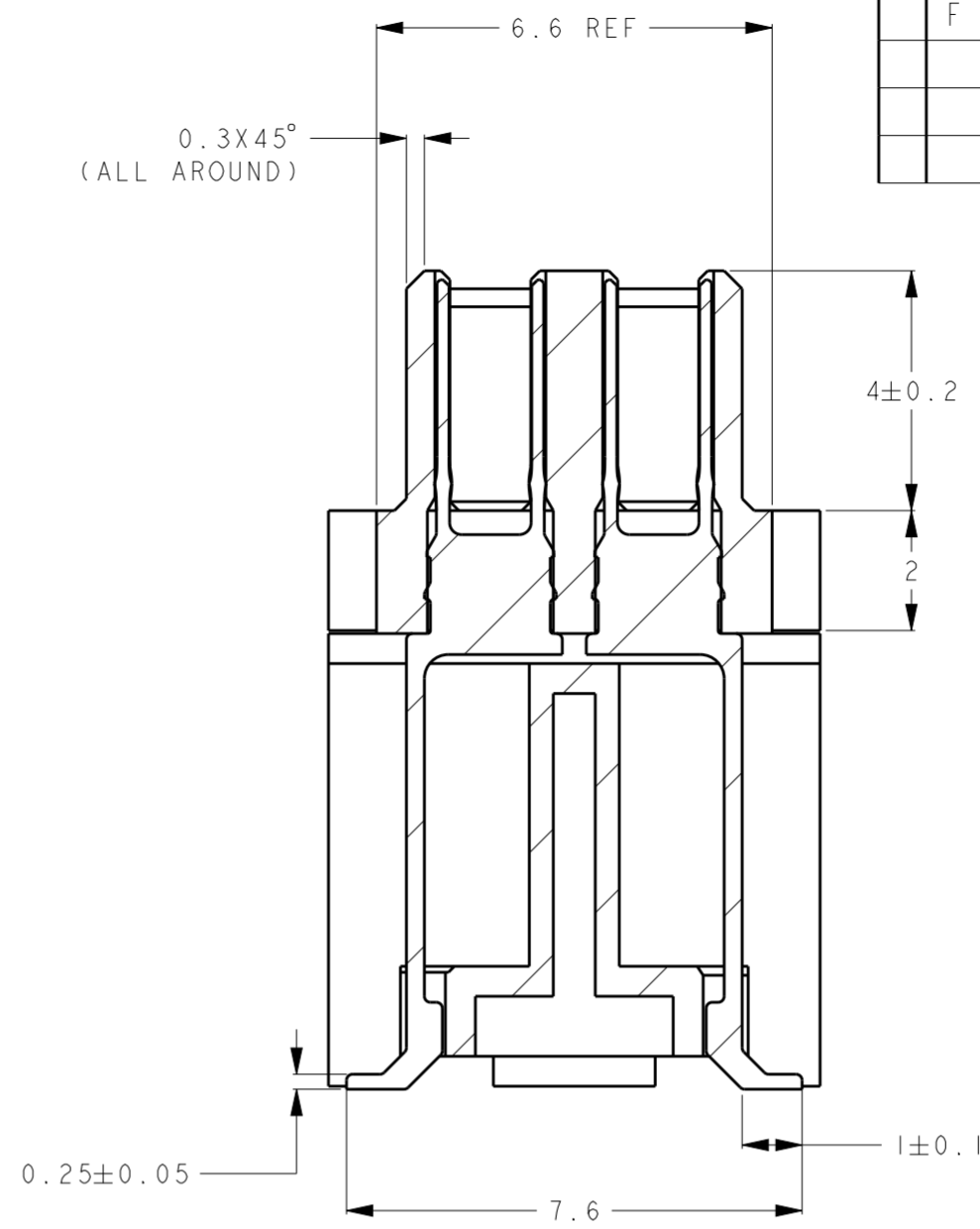
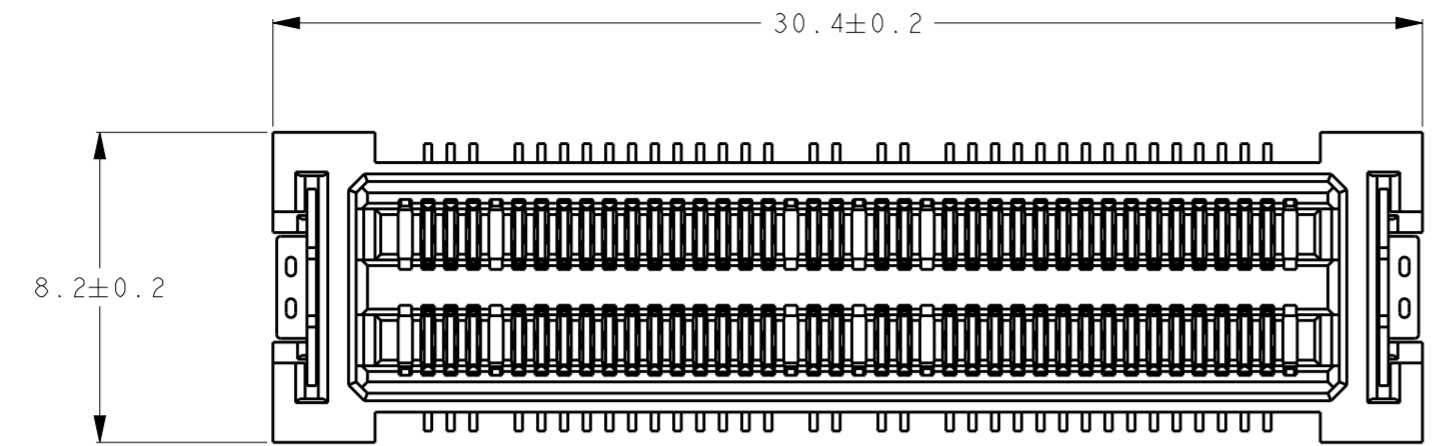
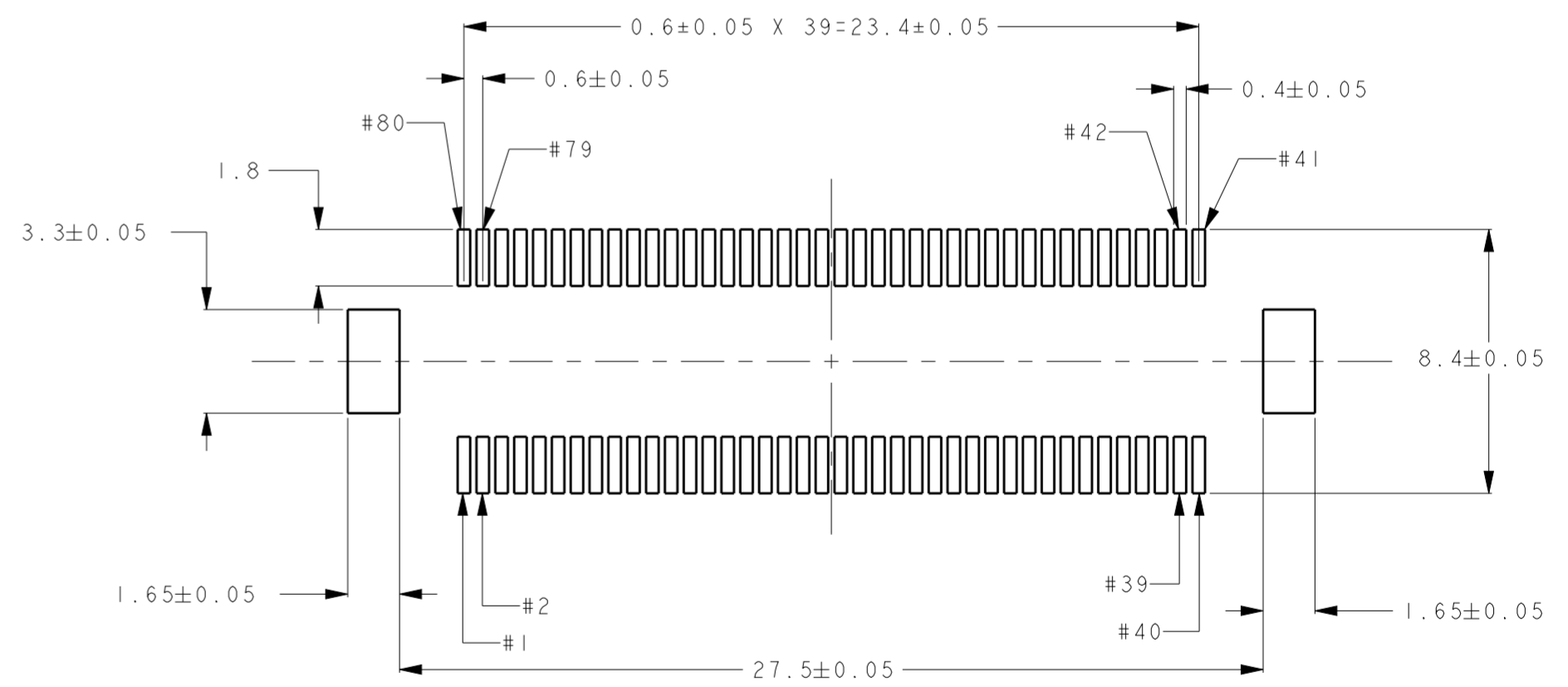
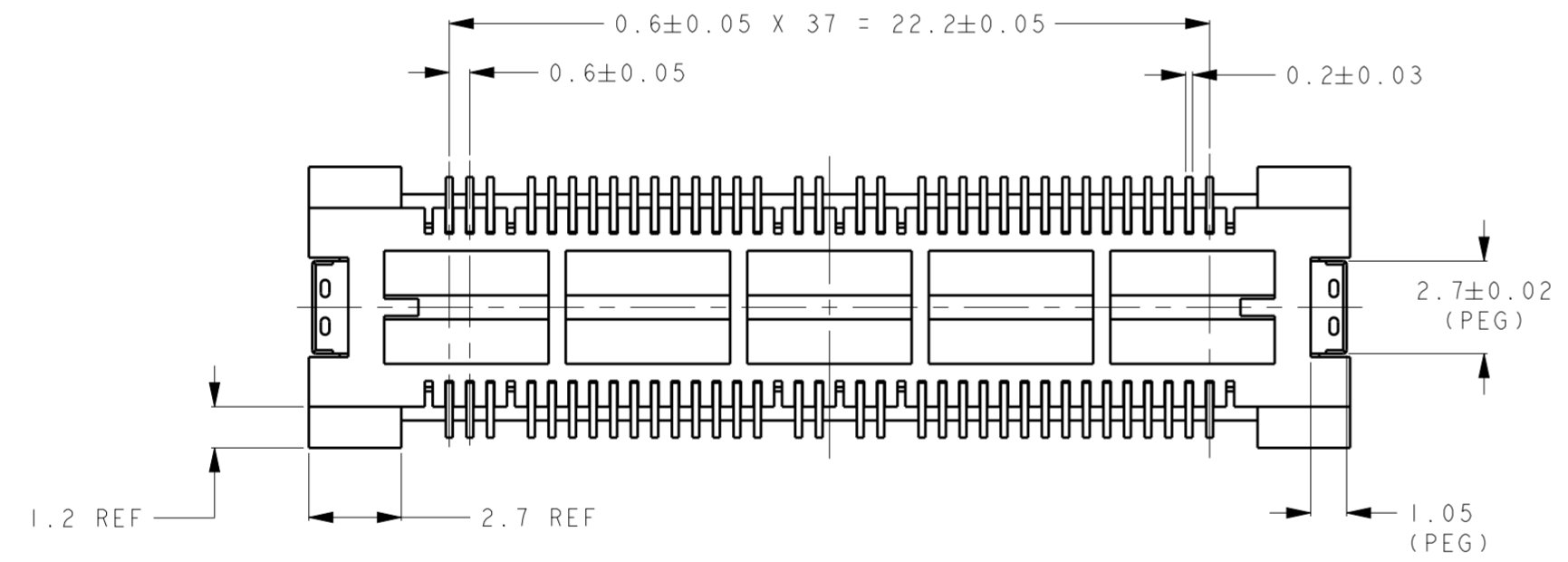

RECOMMENDED PCB LAYOUT

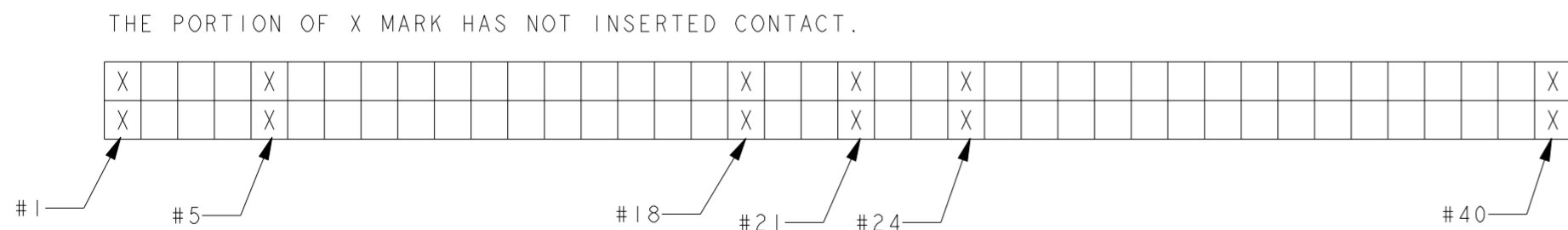

- 1 MATERIAL : HOUSING; LCP
- 2 FINISH : CONTACT; COPPER ALLOY  
: UNDER Ni PL. 0.8µmMIN  
CONTACT AREA: Au PL. 0.3µmMIN  
SOLDERING AREA: Au FLASH
- 3. COPLANARITY 0.1MAX.
- 4. SHOULD BE PUT 45 CONNECTORS IN HARD TRAY. (SEE SHEET 2)
- 5. DATE CODE IS MARKED TO CHINA PRODUCTION PRODUCT.
- 6. THE FACE SIDE AND BACK SIDE IS NOT ASKED.
- AMP : MADE IN JAPAN
- AMP : MADE IN CHINA
- 7. FLOATING AMOUNT X, Y DIRECTION ±0.3mm MAX.

THIS DRAWING IS A CONTROLLED DOCUMENT.		DWN K. Sakai 23JAN2006	TE Connectivity
DIMENSIONS: mm		CHK E. Takemasa 23JAN2006	
TOLERANCES UNLESS OTHERWISE SPECIFIED:		APVD M. Kimura 23JAN2006	NAME REC ASSEMBLY, MICRO STACK CONN 0.6mm PITCH 68P
0 PLC ±0.3 1 PLC ±0.25 2 PLC ±0.2 3 PLC ± 4 PLC ±		PRODUCT SPEC 108-5724	SIZE A20779
MATERIAL SEE NOTE		FINISH SEE NOTE	APPLICATION SPEC -
		WEIGHT 2.67g	CAGE CODE C-6473201
		CUSTOMER DRAWING	RESTRICTED TO -
		SCALE 5:1	SHEET 1 OF 2
			REV F

THIS DRAWING IS UNPUBLISHED. RELEASED FOR PUBLICATION 2006  
 © COPYRIGHT 2006 BY - ALL RIGHTS RESERVED.

REVISIONS				
P	LTR	DESCRIPTION	DATE	APVD
		SEE SHEET 1		

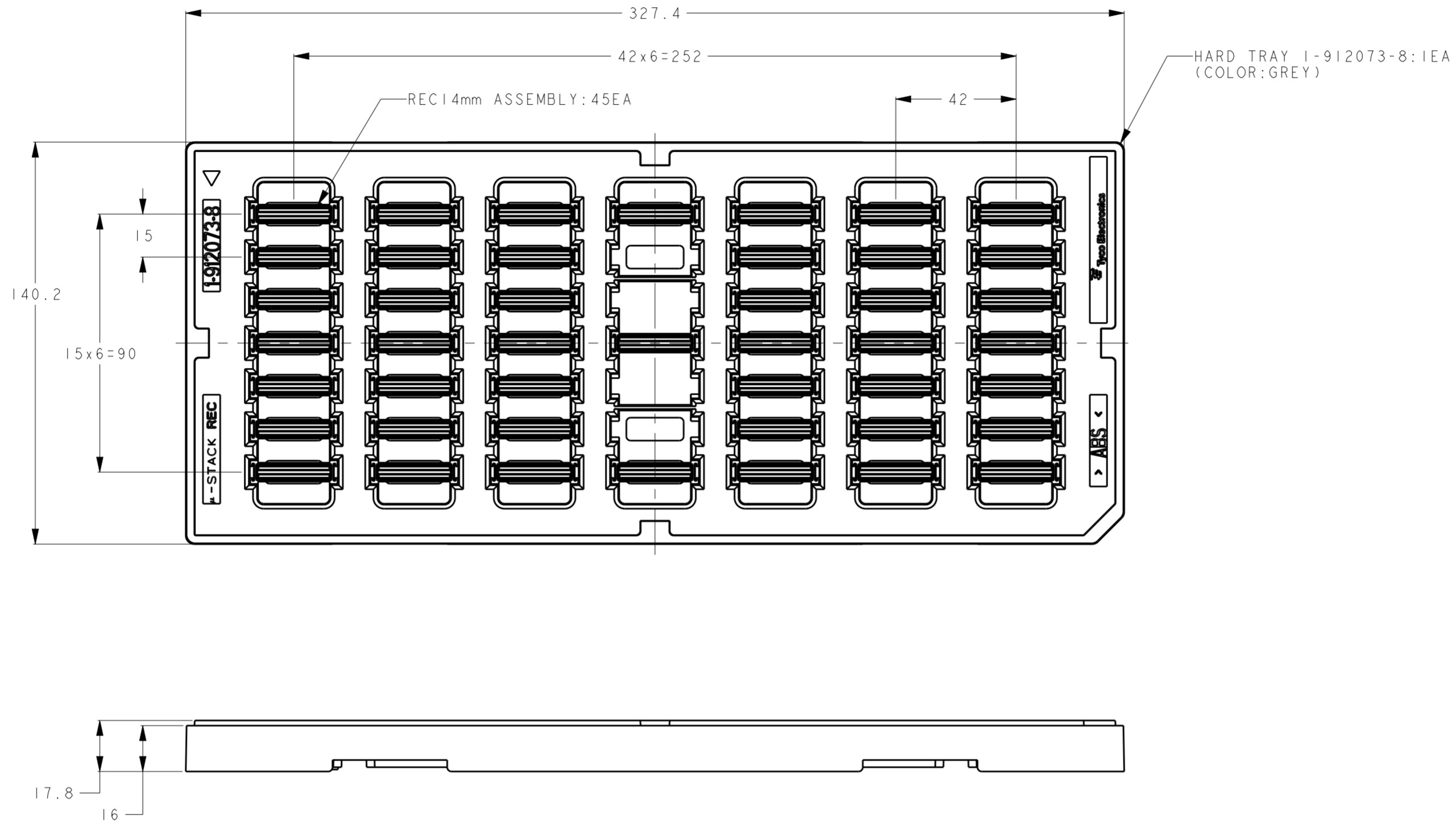

Fig 1: HARD TRAY PACKING SPEC

THIS DRAWING IS A CONTROLLED DOCUMENT.		DWN K. Sakai 23 JAN 2006	 TE Connectivity
DIMENSIONS: mm		CHK E. Takemasa 23 JAN 2006	
TOLERANCES UNLESS OTHERWISE SPECIFIED:		APVD M. Kimura 23 JAN 2006	
0-PLC ± 1-PLC ±0.1 2-PLC ±0.01 3-PLC ±0.001 4-PLC ±0.0001 ANGLES ± FINISH -		PRODUCT SPEC - APPLICATION SPEC - WEIGHT -	
MATERIAL		NAME REC ASSEMBLY, MICRO STACK CONN 0.6mm PITCH 68P	
		SIZE A20779	CAGE CODE C-6473201
		SCALE 2/3	SHEET 2 OF 2
		CUSTOMER DRAWING	RESTRICTED TO - REV F