

THIS DRAWING IS UNPUBLISHED. RELEASED FOR PUBLICATION  
 © COPYRIGHT - By - ALL RIGHTS RESERVED.

REVISIONS				
P	LTR	DESCRIPTION	DATE	APVD
F3		REVISED PER ECR-15-006702	28JUL2015	NK PQ

- 1 MATERIAL: CONNECTOR - NYLON UL94V-2 (RED).  
CONTACTS - 0.30[.012] THICK COPPER ALLOY (0.00038 [.000015] GOLD) OVER (0.00203 [.000080] MIN THICK BRIGHT TIN-LEAD (93/7) FOR -9 OR MATTE FOR -39
- 2. CONTACTS ACCEPT 22 AWG WIRE WITH 1.52[.060] MAX INSULATION DIAMETER.
- 3. CONTACTS MUST ACCEPT 0.36-0.51[.014-.020] SQUARE OR ROUND POST AND REMAIN LOCKED IN POSITION.
- 4 IDENTIFICATION NUMBER FOR LAST CIRCUIT MAY NOT APPEAR ON ALL ASSEMBLIES.
- 5. DIMENSIONS IN BRACKETS ARE IN INCHES.
- 6. HOUSING FEATURES ARE: CLOSED END WITH LOCKING RAMP & LED CONTACT.

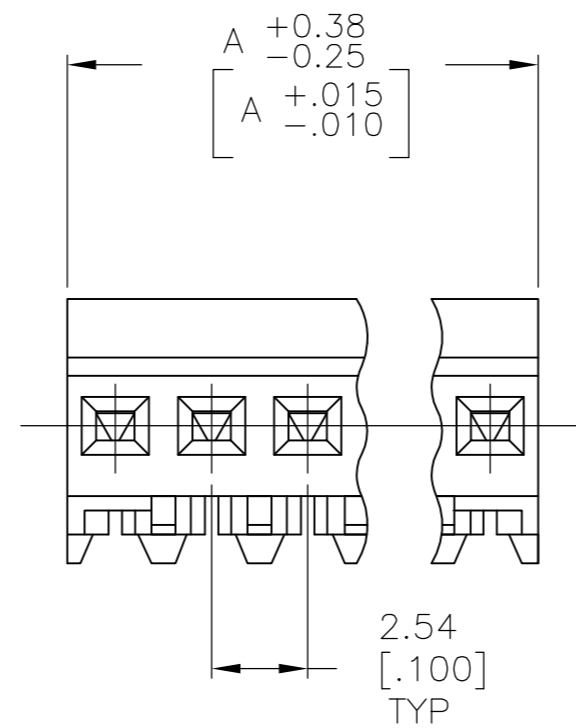
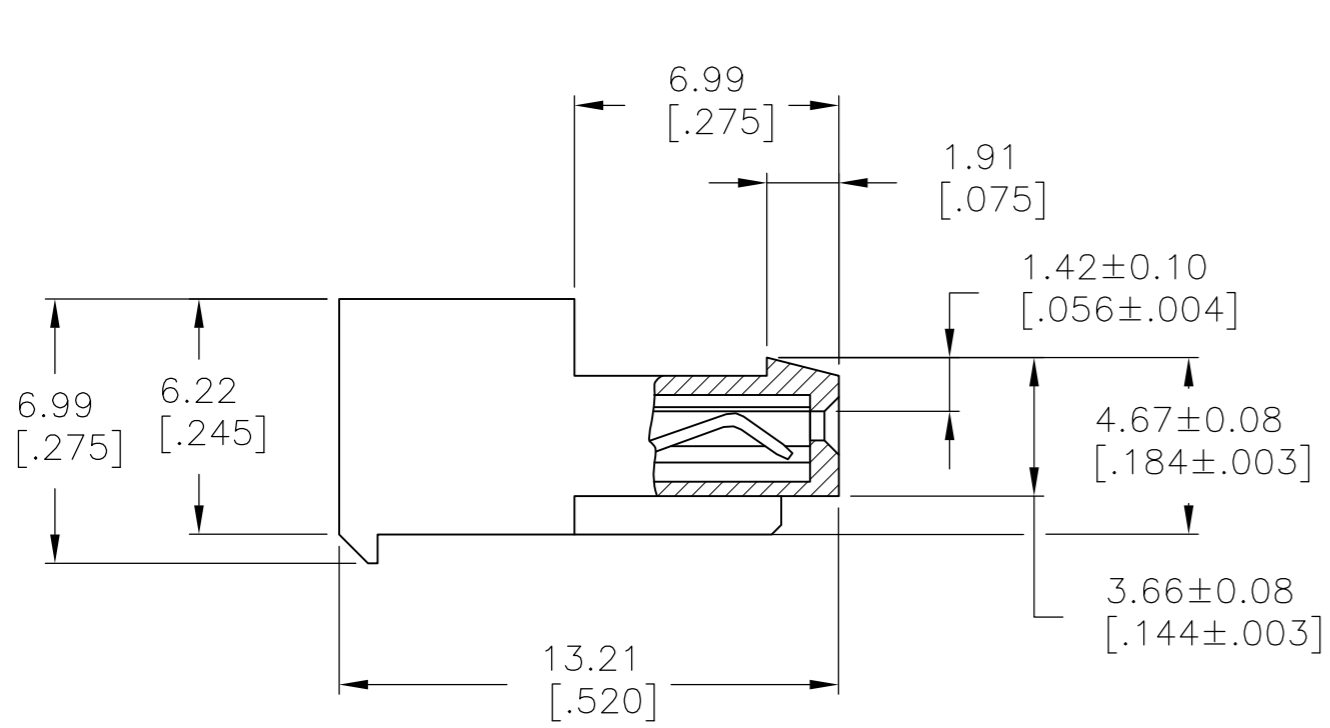
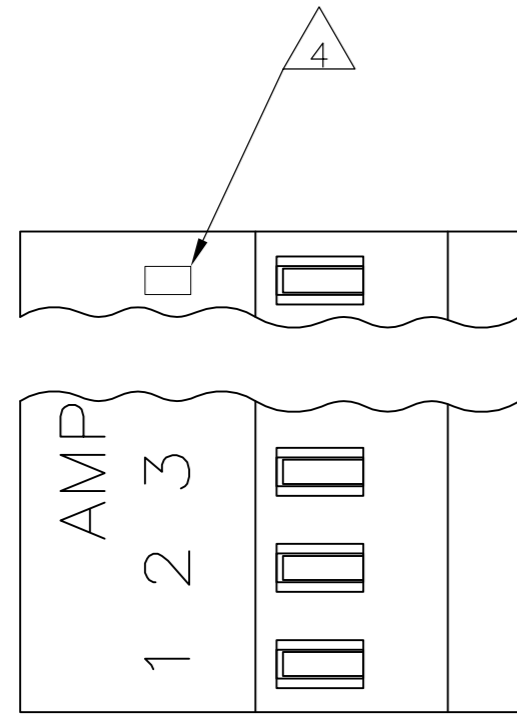

DIM A	NO OF CKTS	PART NO
22.86 [.900]	9	3-644151-9
OBSOLETE	9	644151-9

THIS DRAWING IS A CONTROLLED DOCUMENT.		DWN K. WHITAKER 23JUN05	TE Connectivity	
DIMENSIONS: mm [INCHES]		CHK D. BOSSI 23JUN05	MTA 100 CONNECTOR ASSEMBLY, 22 AWG, FOR .014 TO .020 POST, SPECIAL	
TOLERANCES UNLESS OTHERWISE SPECIFIED:		APVD D. BOSSI 23JUN05	SIZE A2	CAGE CODE 00779
0 PLC ± -		PRODUCT SPEC 108-1050	DRAWING NO C=644151	RESTRICTED TO -
1 PLC ± -		APPLICATION SPEC 114-1019	SCALE 5:1	SHEET 1 OF 1
2 PLC ± -		WEIGHT -	REV F3	
3 PLC ± 0.13[.005]		CUSTOMER DRAWING		
4 PLC ± -				
ANGLES ± -				
FINISH 1				