

REV	DATE	DESCRIPTION	BY	CHK	APP
F	0	REVISED PER ECR-20-000808		PC	SW

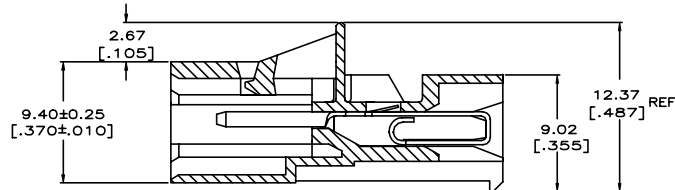
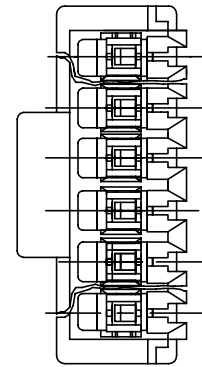
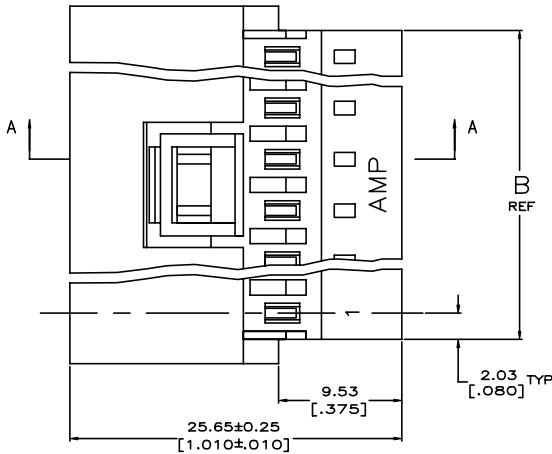
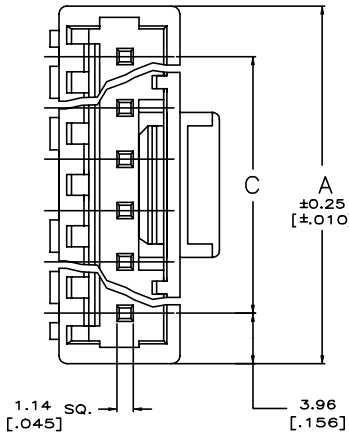

- MATERIAL: CONNECTOR - NYLON UL94-V2 (RED). CONTACTS - 0.30[.012] THICK COPPER ALLOY (BRIGHT TIN-LEAD 0.00203[.000080] MIN. THICK FOR CONTACTS 641437-2 THRU 2-641437-4). (MATTE TIN PLATE 0.00203[.000080] MIN. THICK FOR CONTACTS 3-641437-2 THRU 5-641437-4).
- CONTACTS ACCEPT #22 AWG SOLID, FUSED STRANDED OR STRANDED (7 STRANDS) WIRE WITH 2.41 [.095] MAX INSULATION DIA.
- BOW, IN ANY DIRECTION, NOT TO EXCEED 0.15 [.006] PER IN.
- HOUSING FEATURES: CLOSED END.
- DIMENSIONS IN BRACKETS ARE IN INCHES.
- OBsolete PARTS: OBsolete CIS STREAMLINING PER D.RENAUD/D.SINISI
- OBsolete PARTS

	91.14	3.588	95.20	3.748	99.06	3.900	24	5-641437-4
	55.47	2.184	59.54	2.344	63.40	2.498	15	4-641437-5
	43.59	1.716	47.65	1.876	51.51	2.028	12	4-641437-2
	31.70	1.248	35.76	1.408	39.62	1.560	9	3-641437-9
	19.81	.780	23.88	.940	27.74	1.092	6	3-641437-6
	11.89	.468	15.95	.628	19.81	.780	4	3-641437-4
	7.92	.312	11.99	.472	15.85	.624	3	3-641437-3
	3.96	.156	8.03	.316	11.89	.468	2	3-641437-2
OBsolete	91.14	3.588	95.20	3.748	99.06	3.900	24	2-641437-4
SUPERSEDED	55.47	2.184	59.54	2.344	63.40	2.498	15	1-641437-5
OBsolete	43.59	1.716	47.65	1.876	51.51	2.028	12	1-641437-2
SUPERSEDED	31.70	1.248	35.76	1.408	39.62	1.560	9	641437-9
SUPERSEDED	19.81	.780	23.88	.940	27.74	1.092	6	641437-6
SUPERSEDED	11.89	.468	15.95	.628	19.81	.780	4	641437-4
SUPERSEDED	7.92	.312	11.99	.472	15.85	.624	3	641437-3
SUPERSEDED	3.96	.156	8.03	.316	11.89	.468	2	641437-2

FINISH	C	B	A	NO. OF CIRCUITS	PART NUMBER
THIS DRAWING IS A CONTROLLED DOCUMENT.					
DESIGNED BY: S. CARPENTER 5/24/00			DATE: 7/21/02		
DRAWN BY: D. BOSSI			DATE: 7/21/02		
CHECKED BY: D. BOSSI			DATE: 7/21/02		
APPROVED BY: D. BOSSI			DATE: 7/21/02		
DIMENSIONS: mm (INCHES)			SCALE: 5:1		
MATERIAL: NYLON UL94-V2 (RED)			FINISH: BRIGHT		
APPLICATION: MTA 156			DRAWING NO: A100779C-641437		
PRODUCT SPEC: 22 AWG			RESTRICTED TO: CUSTOMER DRAWING		