

# SPECIFICATIONS

## ELECTRICAL

RESISTANCE:  $1K\Omega \pm 10\%$   
 ELECTRICAL ANGLE:  $340^\circ \pm 2^\circ$   
 LINEARITY:  $\pm .5\%$  INDEPENDENT  
 OUTPUT SMOOTHNESS:  $.01\%$  MAX  
 RESISTANCE TEMPERATURE COEFFICIENT: 400 PPM/°C MAX  
 POWER RATING: 75 WATT @ 70°C, DERATED TO 0.0 WATT @ 125°C  
 DIELECTRIC STRENGTH: 750Vrms @ 60 Hz  
 INSULATION RESISTANCE: 100 MEG OHMS @ 500 VDC

## MECHANICAL

ROTATION: CONTINUOUS 360°  
 TORQUE: 0.25OZ-IN MAX STARTING

## ENVIRONMENTAL

ROTATIONAL LIFE: 50 MILLION CYCLES MINIMUM  
 OPERATING TEMPERATURE: -65°C TO +125°C  
 ALL OTHER ELECTRICAL AND MECHANICAL SPECIFICATIONS PER MIL-PRF-39023

## MATERIALS

HOUSING: ANODIZED ALUMINUM  
 SHAFT: PASSIVATED CENTERLESS GROUND SST  
 BEARINGS: PRECISION MINIATURE BALL  
 ROTOR: BERYLLIUM COPPER  
 CONTACTS: PRECIOUS METAL  
 ELEMENT: CO-MOLDED CONDUCTIVE PLASTIC  
 TERMINALS: GOLD PLATED BRASS

CHANGE HISTORY		
REV.	DESCRIPTION	DATE
A	RELEASE	8/4/00
B0	ECN 1699-SSC	9/2/08

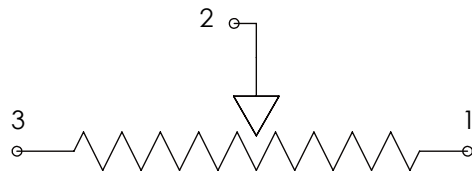
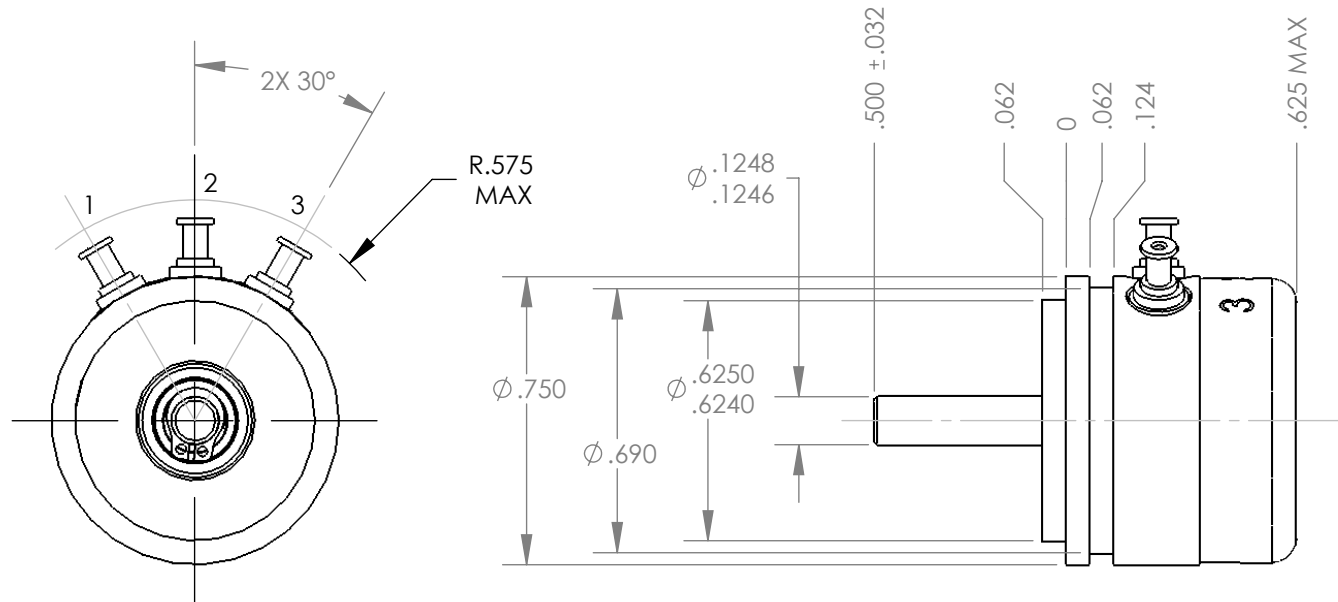

INCREASING FUNCTION VIEWED FROM SHAFT END

**PROPRIETARY AND CONFIDENTIAL**  
 THE INFORMATION CONTAINED IN THIS DRAWING IS THE SOLE PROPERTY OF SPECTRUM SENSORS & CONTROLS, INC.. ANY REPRODUCTION IN PART OR AS A WHOLE WITHOUT THE WRITTEN PERMISSION OF SPECTRUM SENSORS & CONTROLS, INC. IS PROHIBITED.

DIMENSIONS ARE IN INCHES TOLERANCES: ANGULAR $\pm 2^\circ$ TWO PLACE DECIMAL $\pm .01$ THREE PLACE DECIMAL $\pm .005$ FOUR PLACE DECIMAL $\pm .0005$		NAME	DATE	SPECTRUM SENSORS & CONTROLS GRASS VALLEY, CALIFORNIA
DRAWN	PDC	8/4/00		
CHECKED				
ENG APPR.	RFP			
MFG APPR.				
MATERIAL	NOTED	Q.A.		<h1>POTENTIOMETER</h1>
FINISH	NOTED	<b>Information in this box is for Engineering Reference Only</b>		
DO NOT SCALE DRAWING				
SIZE	CAGE CODE	DWG. NO.		
A	5W885	6008-1000-030		
				SHEET 1 OF 1