

© - TE Connectivity. All Rights Reserved.

REVISIONS				
P	LTR	DESCRIPTION	DATE	APVD
	C4	REVISED PER ECN-22-156403	06JUN2022	RK CSD

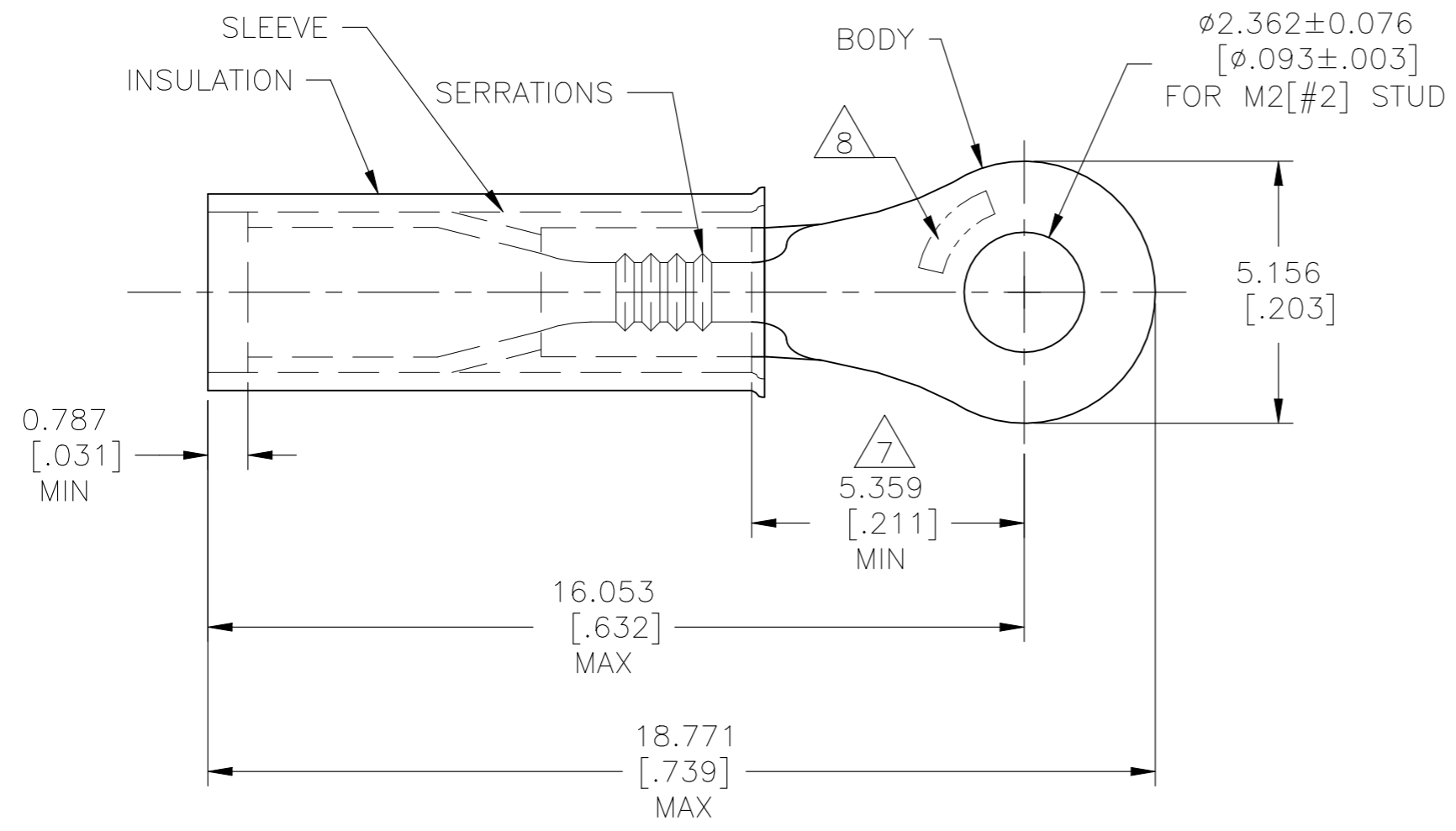
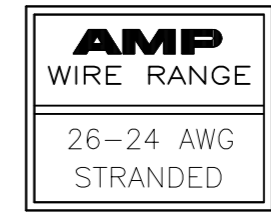

- 1 BODY MATERIAL THK IS 0.686±0.025[.027±.001]
- 2 FOR $\phi 1.270$ TO $\phi 2.667$ [$\phi .050$ TO $\phi .105$] WIRE INS.
- 3 MUST BE CRIMPED WITH 22-18 OR 22-16 PIDG (RED) TOOL
- 4 MEETS MS25036-143, CLASS 1
- 5 MATERIAL:
BODY AND SLEEVE: COPPER PER ASTM B152
INSULATION: NYLON
- 6 FINISH:
BODY AND SLEEVE: TIN PLATE PER ASTM B545
INSULATION: COLOR, YELLOW
- 7 APPLIES FROM EDGE OF METAL WIRE BARREL TO CENTER OF STUD HOLE
- 8 STAMP AMP APPROX AS SHOWN

LOOSE PIECE	1000	54310-1	4
PACKAGE TYPE	QTY	PART NO	

AMP INCORPORATED
CUSTOMER SERVICE SYSTEMS

THIS DRAWING IS A CONTROLLED DOCUMENT.

DWN	JR RUTH	27JAN04
CHK	T MICHELUTTI	27JAN04
APVD	T MICHELUTTI	27JAN04
PRODUCT SPEC	-	
APPLICATION SPEC	114-2157	
WEIGHT	-	



NAME
TERMINAL, NYLON PIDG,
RING TONGUE; WIRE SIZE 26-24

FOR ADDITIONAL PRODUCT INFORMATION OR COPIES OF DRAWINGS AND TECHNICAL DOCUMENTS	PRODUCT INFORMATION CENTER 1-800-522-6752
FOR APPLICATION TOOLING INFORMATION	TOOLING ASSISTANCE CENTER 1-800-722-1111
FOR ORDER ENTRY	1-800-526-5142

MAX RECOMMENDED OPERATING TEMPERATURE: 105°C [221°F]
VOLTAGE RATING: 300 V MAX
WIRE CROSS SECTIONAL AREA RANGE, 0.12-0.24mm ² [238-475] CIR MILS STRANDED

DIMENSIONS: mm [INCHES]	TOLERANCES UNLESS OTHERWISE SPECIFIED:
	0 PLC ± -
	1 PLC ± -
	2 PLC ± -
	3 PLC ± 0.127[.005]
	4 PLC ± -
	ANGLES ± 1°
MATERIAL	FINISH
5	6

SIZE	CAGE CODE	DRAWING NO	RESTRICTED TO
A3	00779	C-54310	-
CUSTOMER DRAWING		SCALE 8:1	SHEET 1 OF 1 REV C4