

LOC		DIST		REVISIONS			
AD	00	REV	DATE	BY	CHK	APPV	
A	NEW DRAWING		20DEC11	KH	AS		

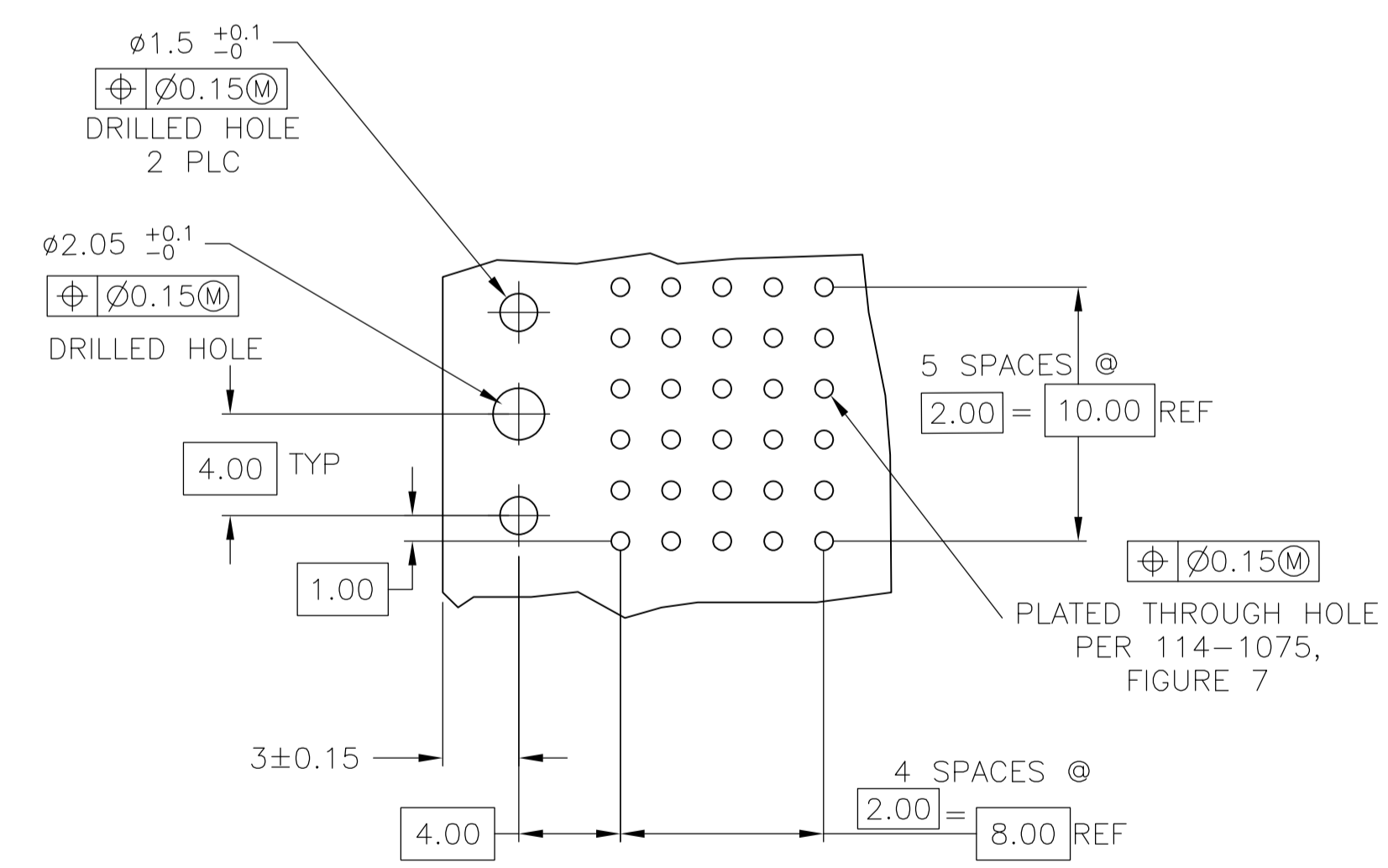

RECOMMENDED CIRCUIT PATTERN  
PER IPC-D300 TYPE II, CLASS C  
(COMPONENT SIDE)

- 1 HOUSINGS MATERIAL: LIQUID CRYSTAL POLYMER.
- 2 CONTACT MATERIAL: COPPER ALLOY
- 3 CONTACT FINISH:(D)  
UNDERPLATE (ENTIRE CONTACT):  
0.00127 MIN NICKEL PER SAE-AMS-QQ-N-290  
ON MATING SURFACES:  
0.00076 MIN GOLD PER ASTM B 488 OVER UNDERPLATE.  
ON LEADS:  
0.00127 MIN MATTE TIN PER ASTM B 545 OVER UNDERPLATE.  
LUBRICATION (MIN MATING SURFACES):  
SURFACE CONDITIONER AFTER PLATING.

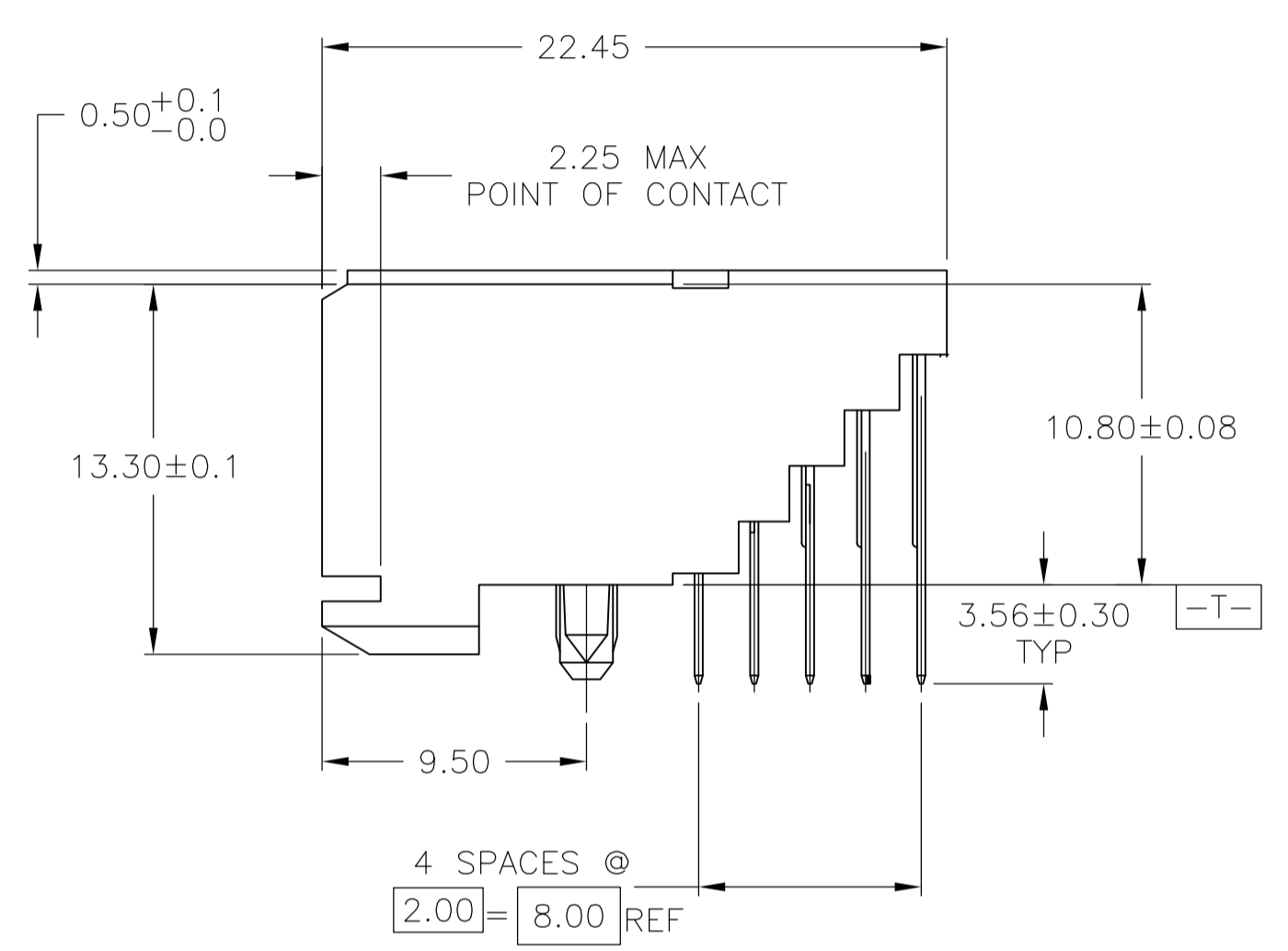
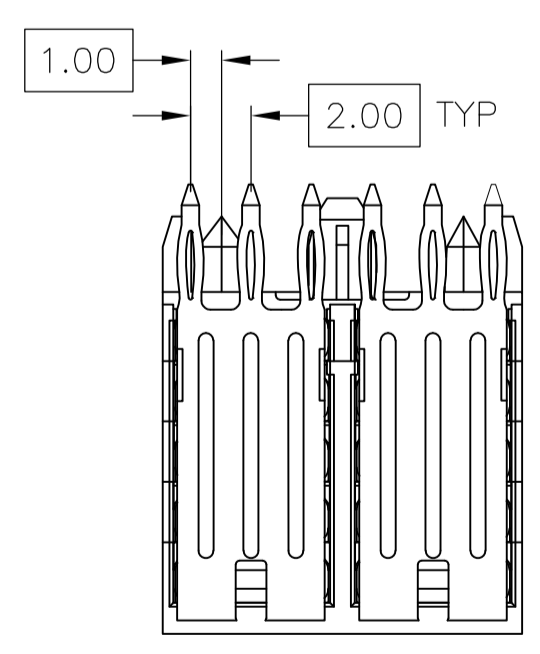
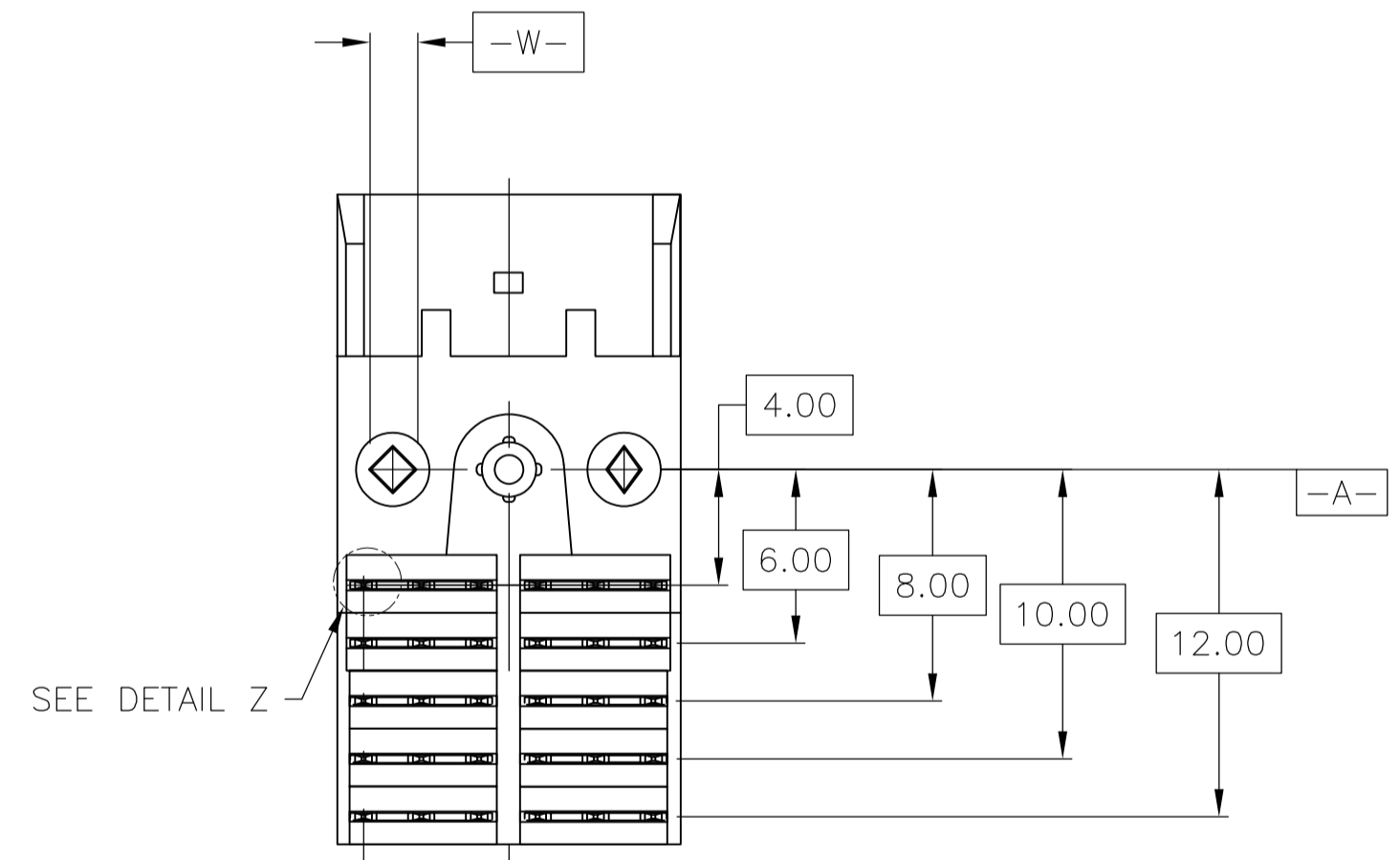
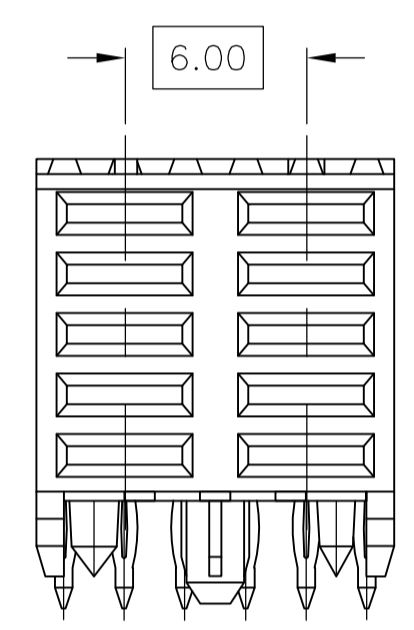
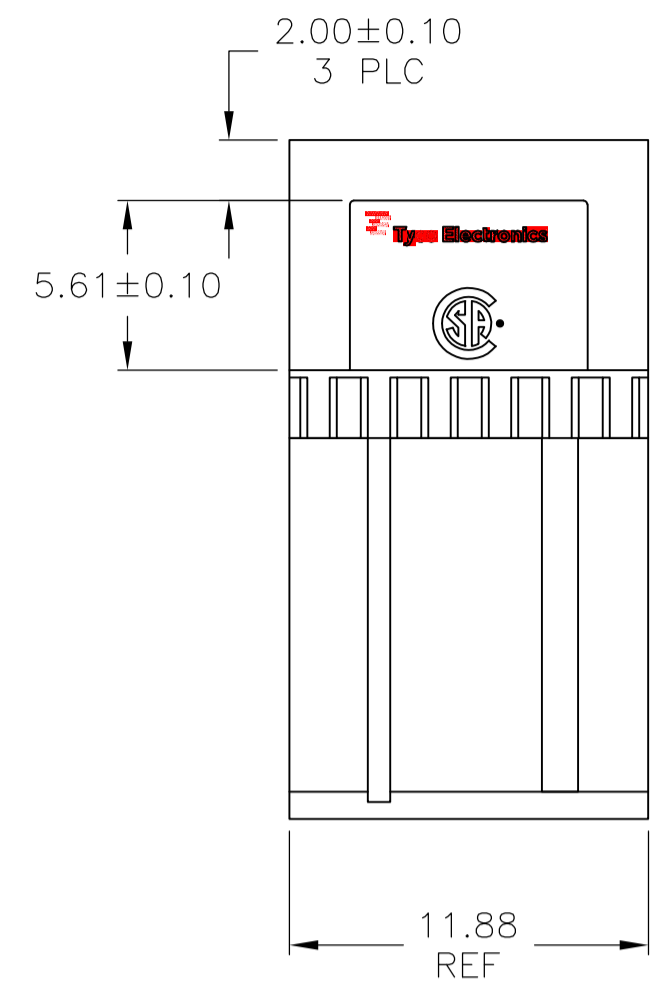
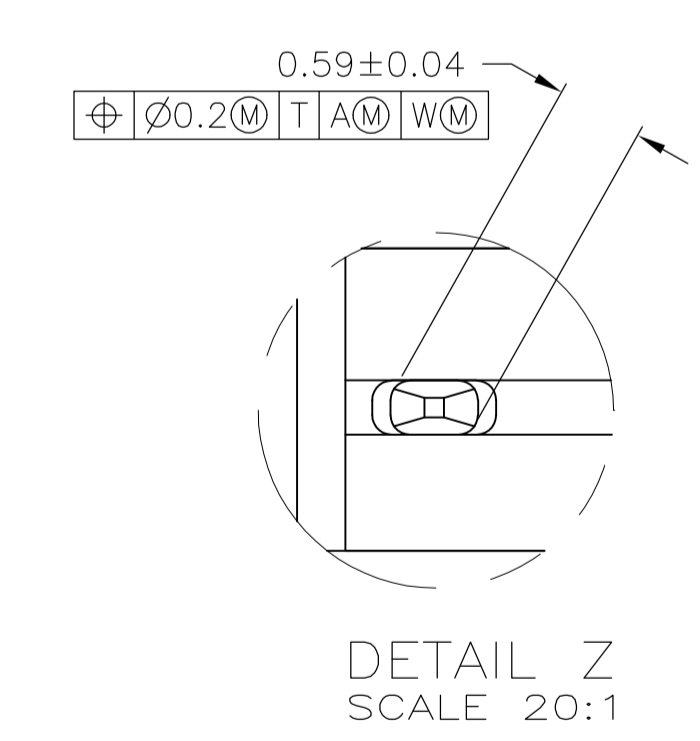

10	5223175-1
NO OF POSN	PART NUMBER

THIS DRAWING IS A CONTROLLED DOCUMENT.		DWG: KIRAN HOLAL 20DEC11		TE Connectivity	
DIMENSIONS: mm		CHK: SHARPE ALEXANDER 20DEC11			
TOLERANCES UNLESS OTHERWISE SPECIFIED:		APVD: SHARPE ALEXANDER 20DEC11		NAME: ASSEMBLY, RECEPTACLE, 5 ROW, PRESS FIT, 3.56, POWER, 2mm FB	
0 PLC ± -		PRODUCT SPEC		APPLICATION SPEC	
1 PLC ± -		SIZE		CAGE CODE	
2 PLC ± 0.13 [0.005]		DRAWING NO		RESTRICTED TO	
3 PLC ± 0.013 [0.0005]		A1 00779		5223175	
4 PLC ± -		WEIGHT		CUSTOMER DRAWING	
ANGLES ± -		SCALE 4:1		SHEET 1 OF 1	
FINISH		REV A			