

- 1 HOUSING MATERIAL: LIQUID CRYSTAL POLYMER PER ASTM D5138 LCP000 G30A 32250, COLOR: NATURAL.
- 2 CONTACT MATERIAL: PHOSPHOR BRONZE PER UNS ALLOY NO. C51100, TEMPER: H04.
- 3 CONTACT FINISH:(D)
 UNDERPLATE (ENTIRE CONTACT):
 0.00127 MIN NICKEL PER SAE-AMS-QQ-N-290
 ON MATING SURFACES:
 0.00076 MIN GOLD PER ASTM B488 OVER UNDERPLATE.
 ON LEADS:
 0.00127 MIN MATTE TIN PER ASTM B545 OVER UNDERPLATE.
 LUBRICATION (MIN MATING SURFACES):
 SURFACE CONDITIONER AFTER PLATING.
- 4 PART MARKING, LOCATED APPROXIMATELY AS SHOWN.

ROW	D	AA	AA	AA	AA
C	AA	AA	AA	AA	AA
B	AC	AC	AC	AC	AC
A	AA	AA	AA	AA	AA
	1	2	3		X
	POWER			POWER	
	POSITION				

CODE LETTER	MATING POST LENGTH ±0.1	LEAD LENGTH (REF)
AA	6.50	4.25
AC	8.00	4.25

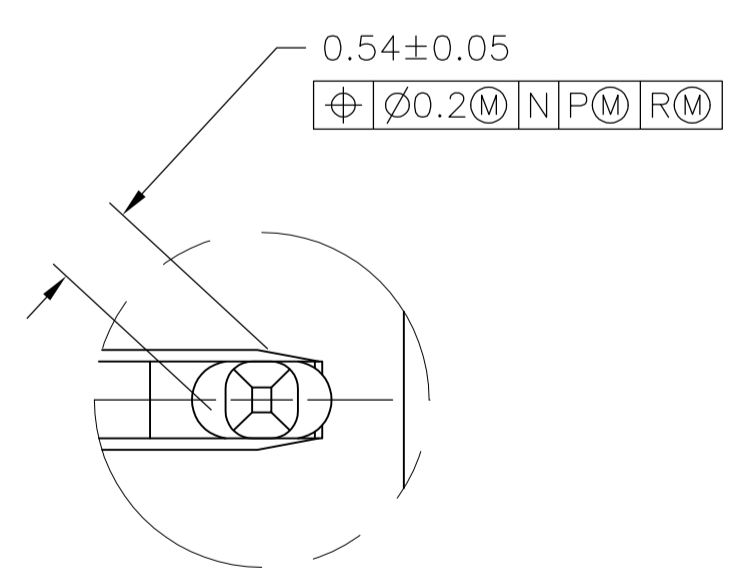
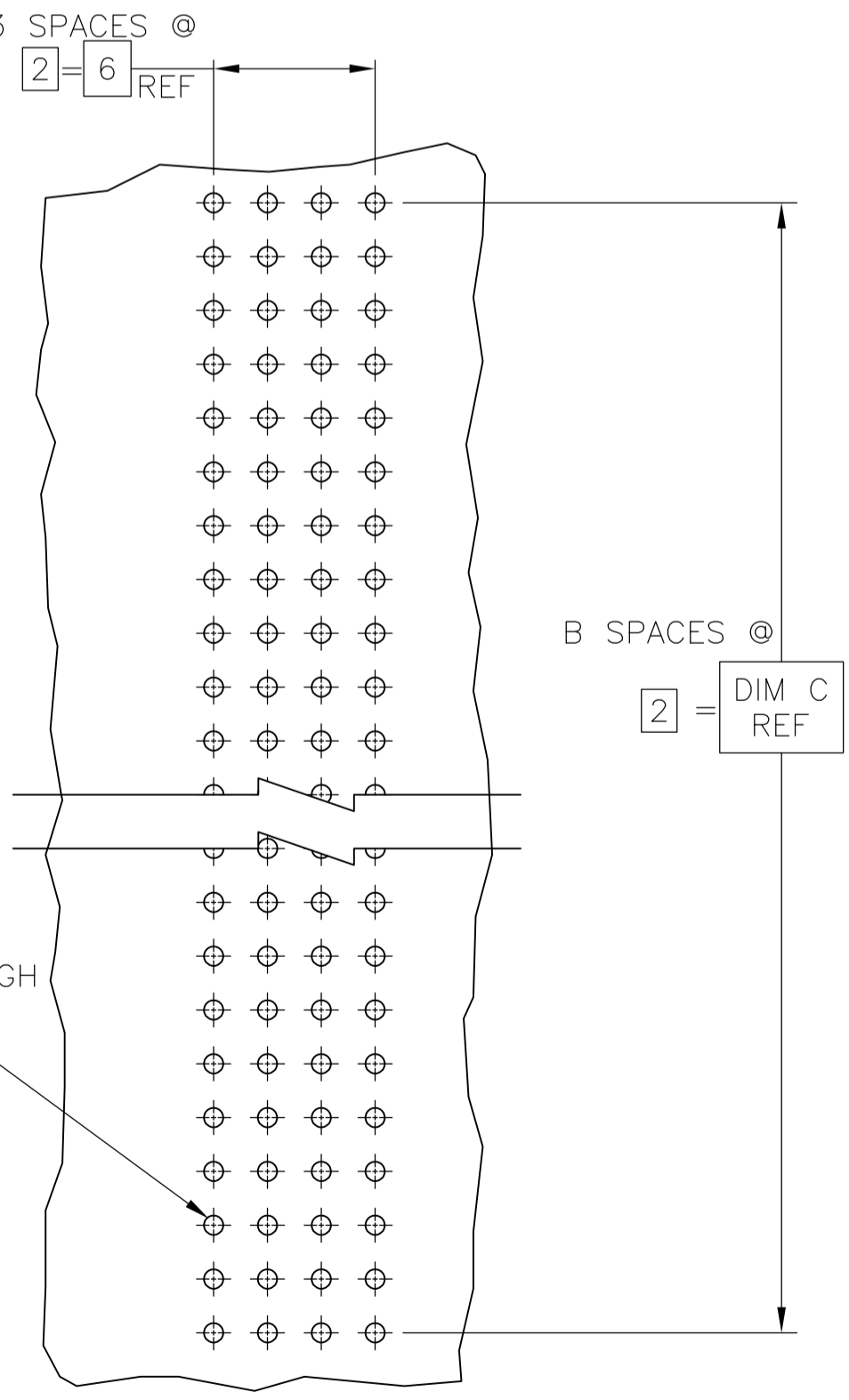
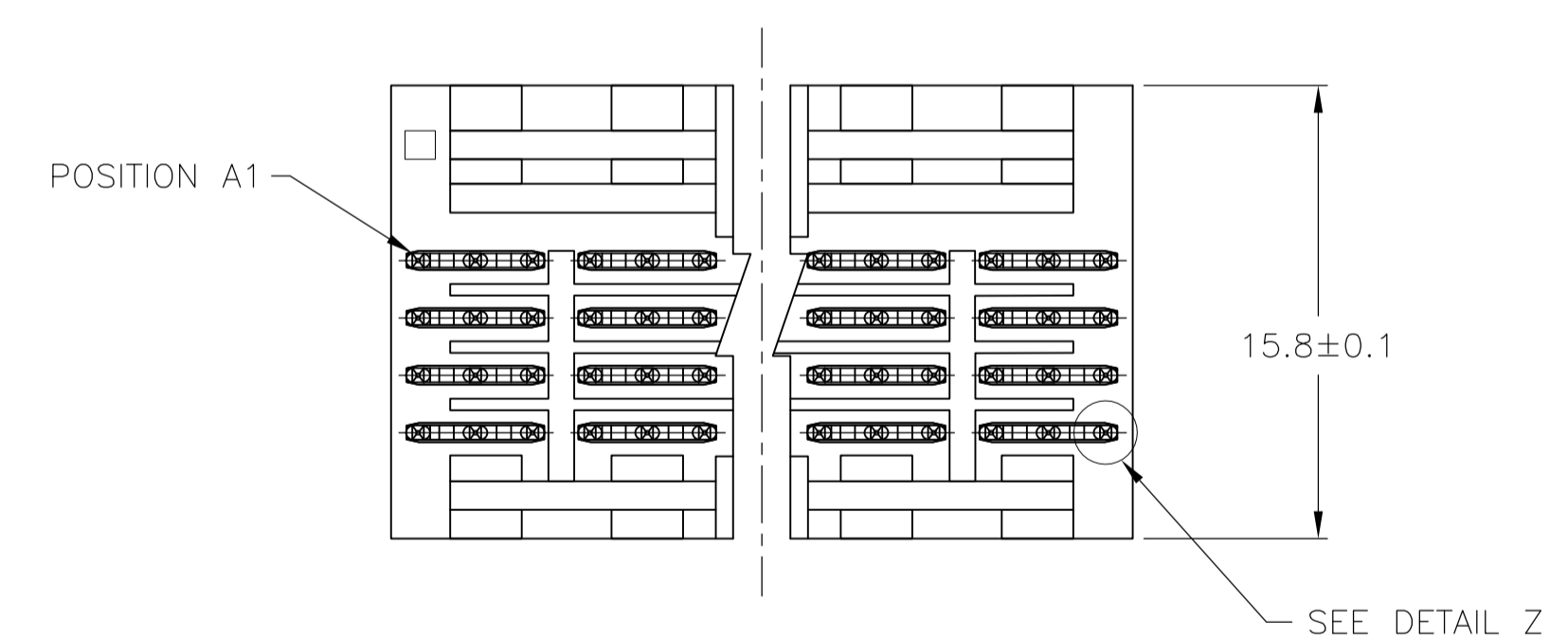

DETAIL Z
SCALE 20:1

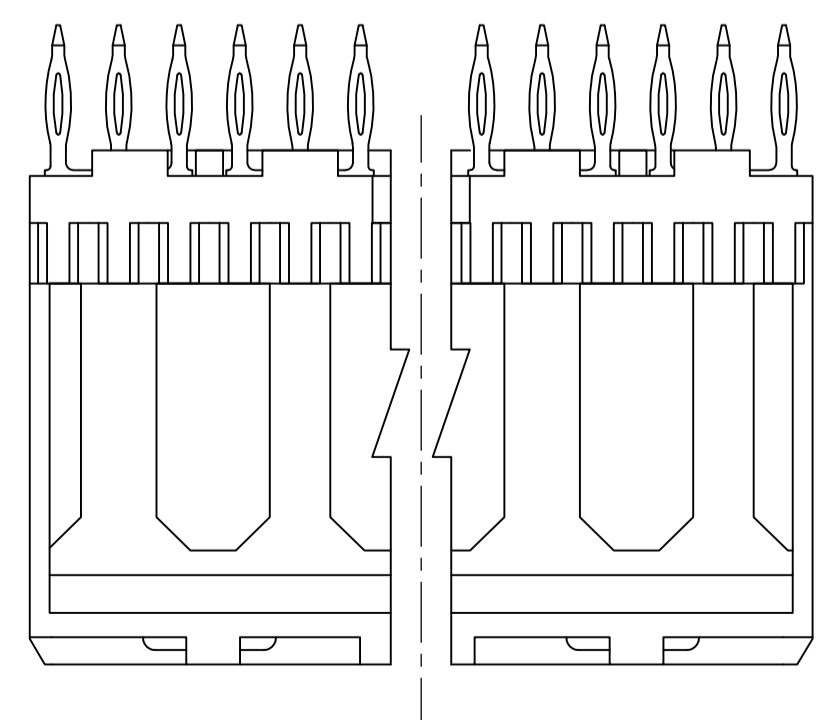

RECOMMENDED CIRCUIT PATTERN PER IPC-D300 TYPE II, CLASS C (COMPONENT SIDE)

6.00	1	10.00	5	11.88	3	8	5223173-1
E	D	C	B	A	FINISH	NO OF POWER POSN	PART NUMBER

THIS DRAWING IS A CONTROLLED DOCUMENT.		DWN	KIRAN HOLAL	23DEC11
DIMENSIONS: mm		CHK	SHARPE ALEXANDER	23DEC11
TOLERANCES UNLESS OTHERWISE SPECIFIED:		APVD	SHARPE ALEXANDER	23DEC11
0. PLC	± -	NAME		
1. PLC	± 0.13	ASSEMBLY, PIN, 4 ROW, SEQUENCED, PRESS-FIT, 4.25, POWER, 2mm FB		
2. PLC	± -	SIZE		
3. PLC	± -	CAGE CODE		
4. PLC	± -	DRAWING NO		
ANGLES	± -	RESTRICTED TO		
MATERIAL	FINISH	WEIGHT	A1	00779
CUSTOMER DRAWING		SCALE 4:1 SHEET 1 OF 1 REV A		