

LOC		DIST		REVISIONS			
P	LTR	DESCRIPTION	DATE	DN	APVD		
C		REVISED PER ECO-09-008889	24-03-09	CT	RL		

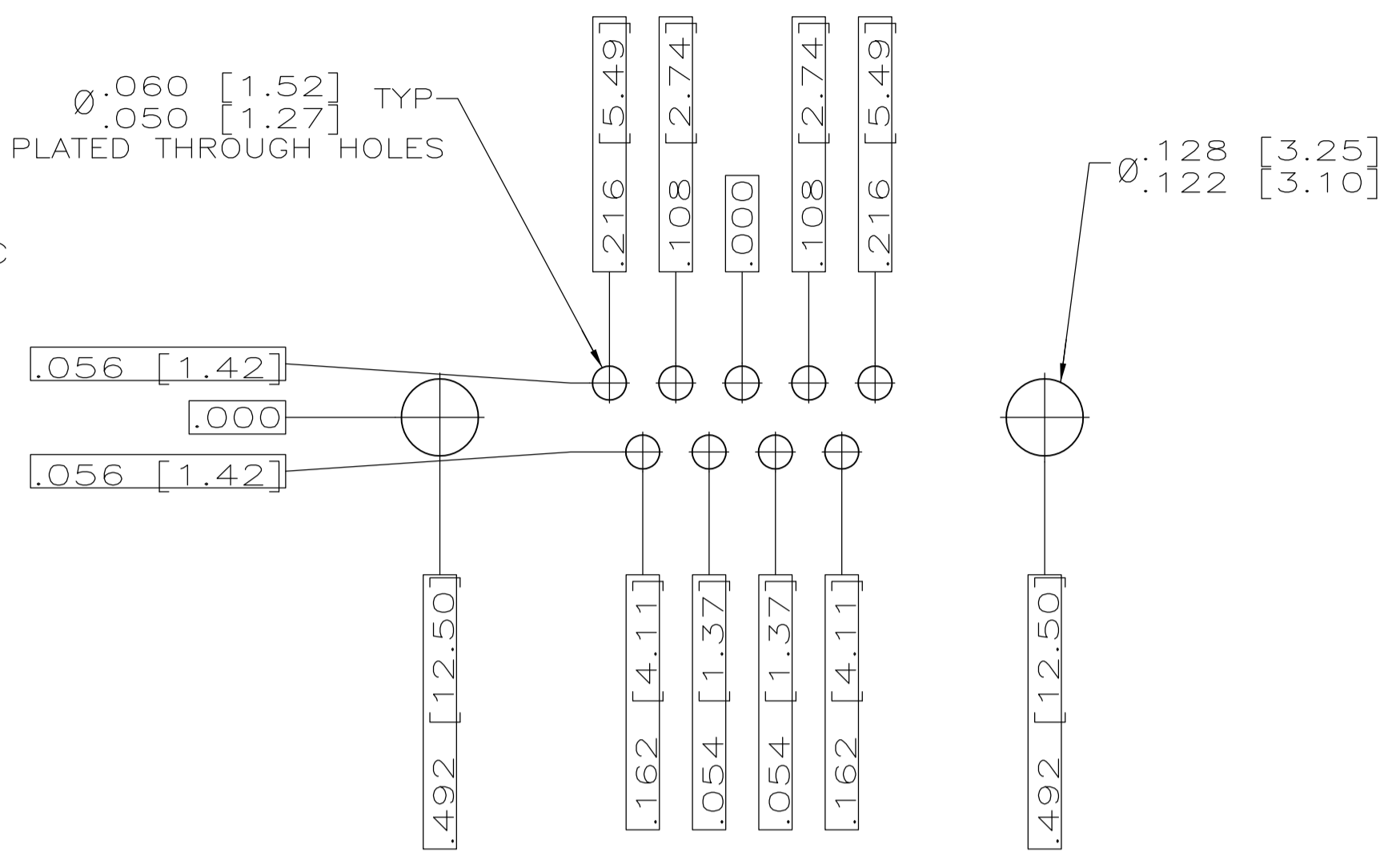

1. TRUE POSITION TOLERANCE FOR P.C. BOARD LAYOUT IS .010 [0.25] AT MAX MATERIAL CONDITION. SUGGESTED BOARD THICKNESS IS .094 [2.39]
2. THE CONNECTORS DESCRIBED IN THIS DOCUMENT MEET THE REQUIREMENTS OF MIL-C-24308 AND MATE WITH ANY RECEPTACLE CONNECTOR WITH SAME INSERT ARRANGEMENT, EXCEPT AS NOTED DIMENSIONALLY HEREIN. SALT SPRAY PER MIL-C-24308 NOT APPLICABLE.
3. MARK WITH .047 [1.19]-.062 [1.57] HIGH CHARACTERS. FAR SIDE REFERS TO THE WIDE SIDE OF THE KEYSTONE. NEAR SIDE REFERS TO THE NARROW SIDE OF THE KEYSTONE.
4. REQUIREMENT FOR FULL PIN DIAMETER EXTENSION IS .159 [4.04] MIN.
5. SPACERS (QTY 2) ARE SUPPLIED WITH CONNECTORS (NOT ATTACHED TO THE CONNECTOR).
6. DIMENSIONS AND TOLERANCES PER ANSI Y14.5M-1982.
7. THIS DRAWING SHALL BE INTERPRETED IN ACCORDANCE WITH APPLICABLE STANDARDS LISTED IN MIL-STD-100.

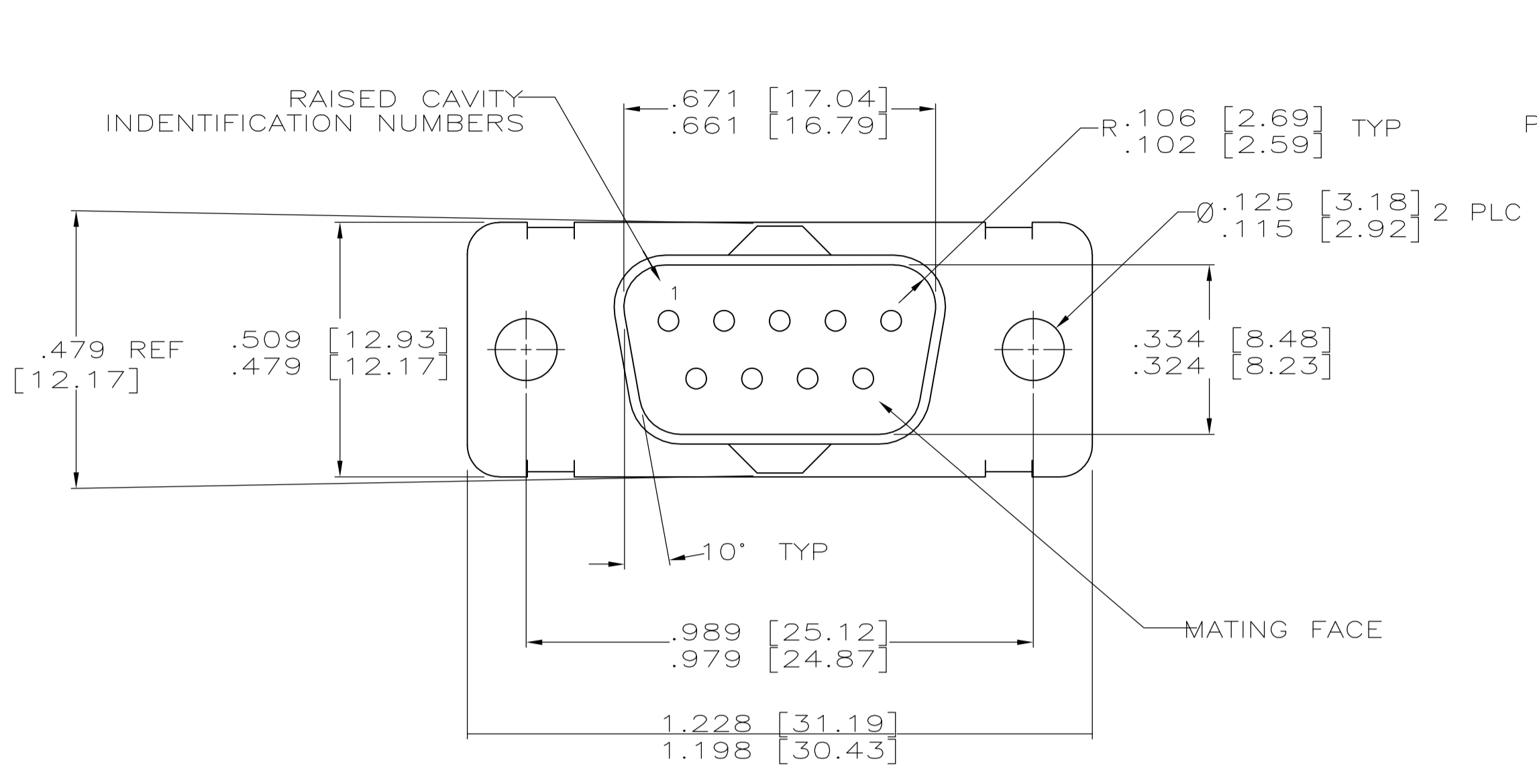
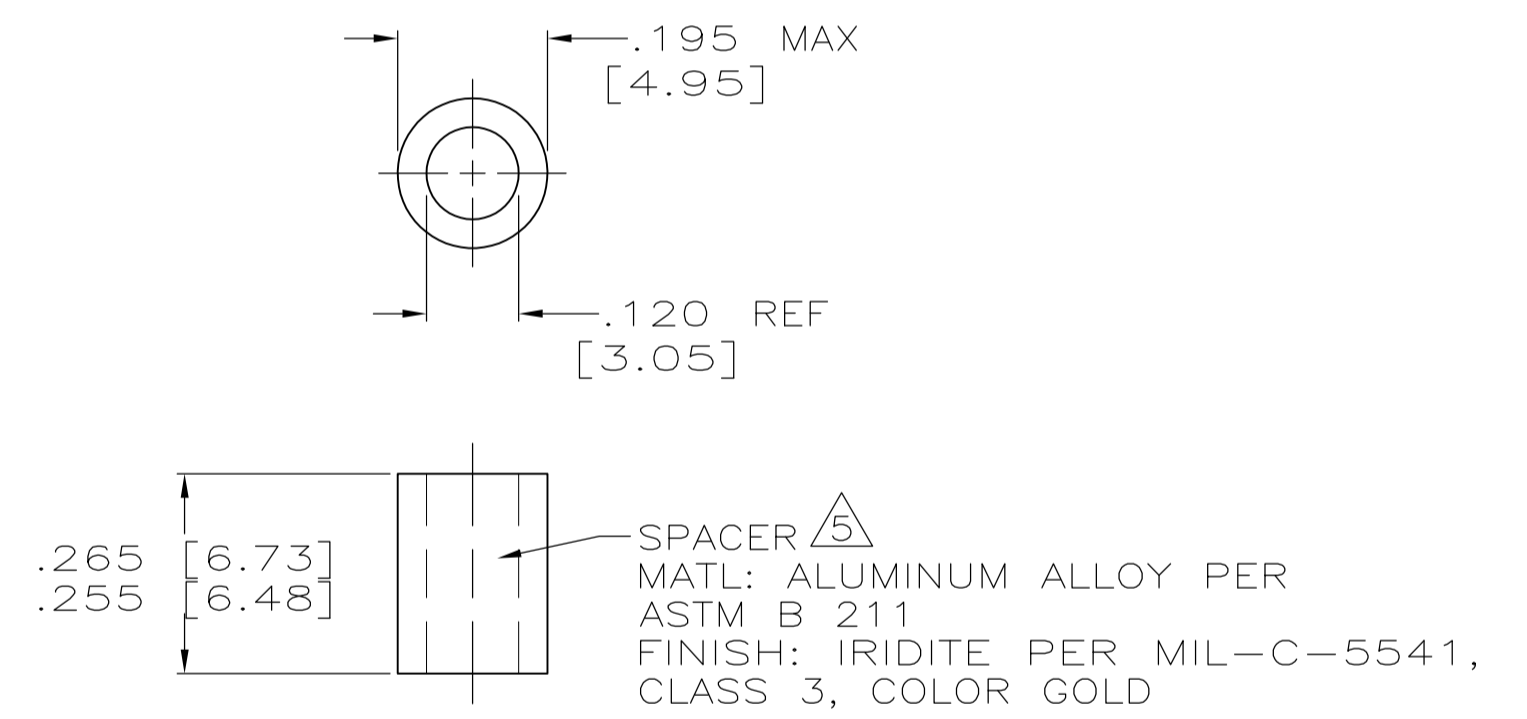
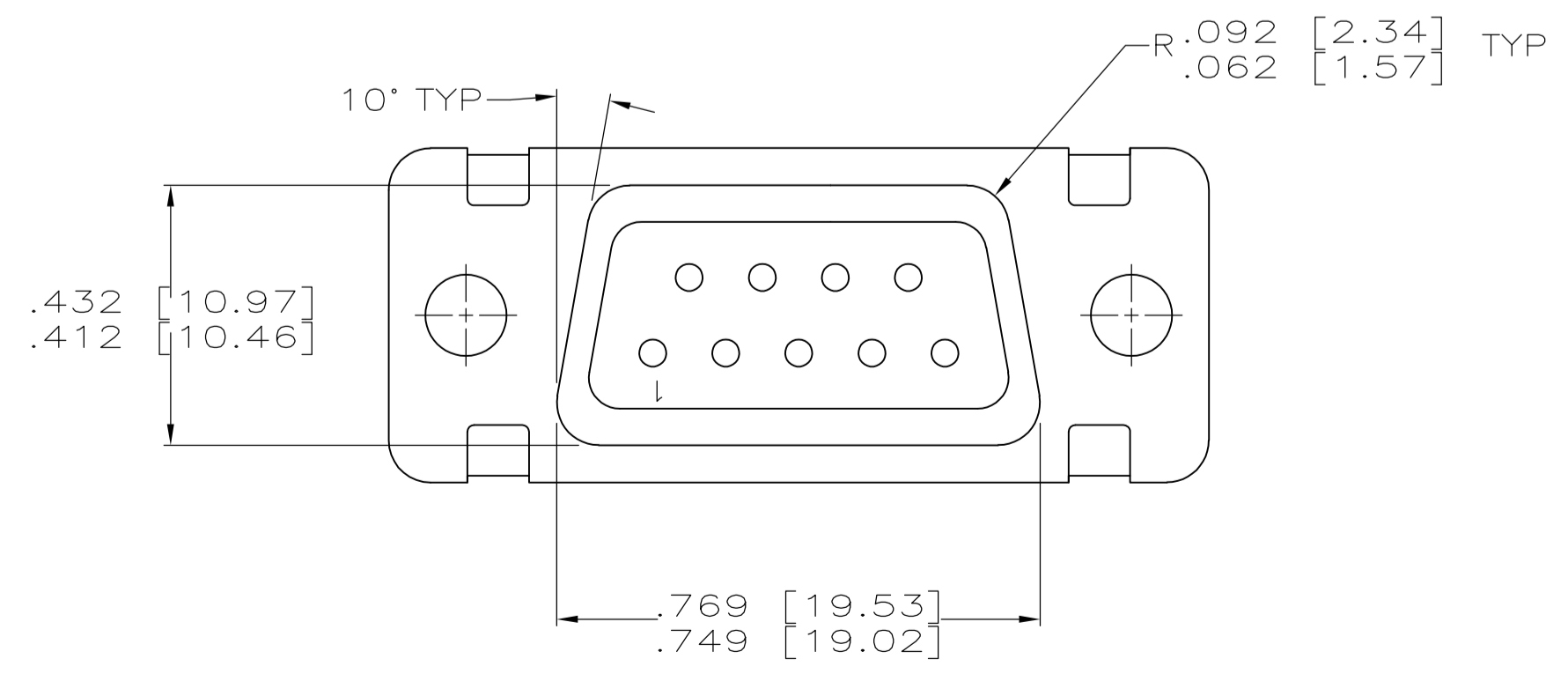
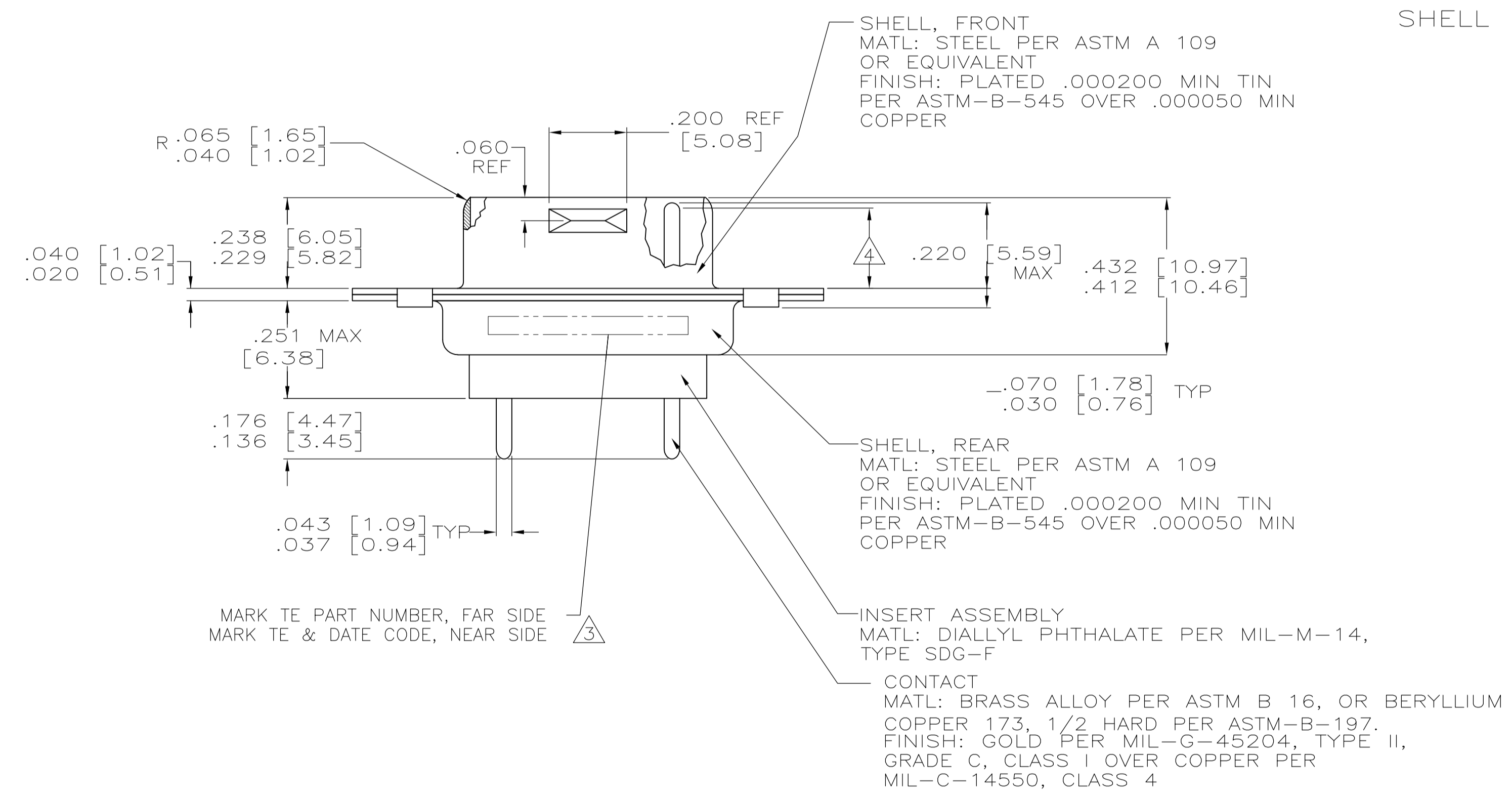

THIS DRAWING IS A CONTROLLED DOCUMENT.		DN AJ GRAFF 25MAY93	Tyco Electronics Corporation Harrisburg, PA 17105-3608	
DIMENSIONS: INCHES		CHK F. KINSEY 07JUN93	NAME AMPLIMITE PLUG ASSY WITH SIZE 20 STRAIGHT POSTED P.C. BOARD CONTACTS, SERIES 109, SHELL SIZE 1	
TOLERANCES UNLESS OTHERWISE SPECIFIED:		APVD	PRODUCT SPEC MIL-C-24308	
0 PLC ± -			APPLICATION SPEC	
1 PLC ± -			SIZE A1	
2 PLC ± -			CAGE CODE 00779	
3 PLC ± -			DRAWING NO. 449568	
4 PLC ± -			RESTRICTED TO	
ANGLES ± -			CUSTOMER DRAWING	
MATERIAL SEE CALLOUTS		FINISH SEE CALLOUTS	WEIGHT	SCALE 1:1 SHEET 1 OF 1 REV C