

THIS DRAWING IS UNPUBLISHED. RELEASED FOR PUBLICATION 20
 © COPYRIGHT 20 BY - ALL RIGHTS RESERVED.

REVISIONS				DATE	DWN	APVD
LOC	DIST	P	LTR	DESCRIPTION		
-	-			REV PER ECO-12-014446	19DEC2012	RJM3 RG

△ ELECTRICAL ENGAGEMENT POINT.

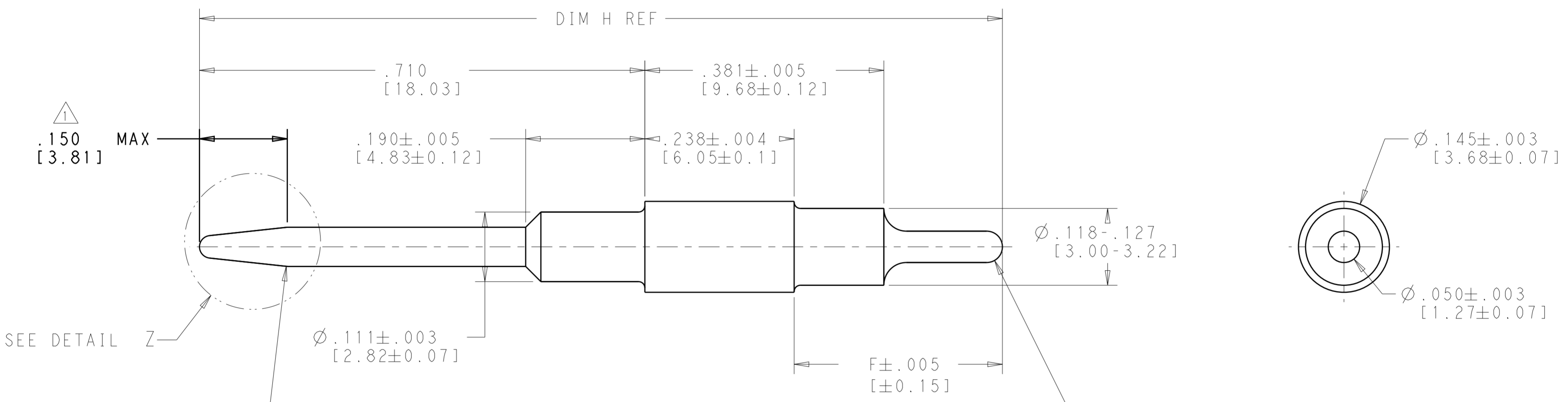

MAT'L: COPPER ALLOY PER ASTM-B-301
 FINISH: PLATED GOLD .000050 [0.0012] MIN. THK.
 PER ASTM-B-488 OVER NICKEL .000050 [0.0012]
 MIN THK. PER QQ-N-290

SPHERICAL RAD.
 .012 [.30] MAX FLAT
 PERMISSIBLE

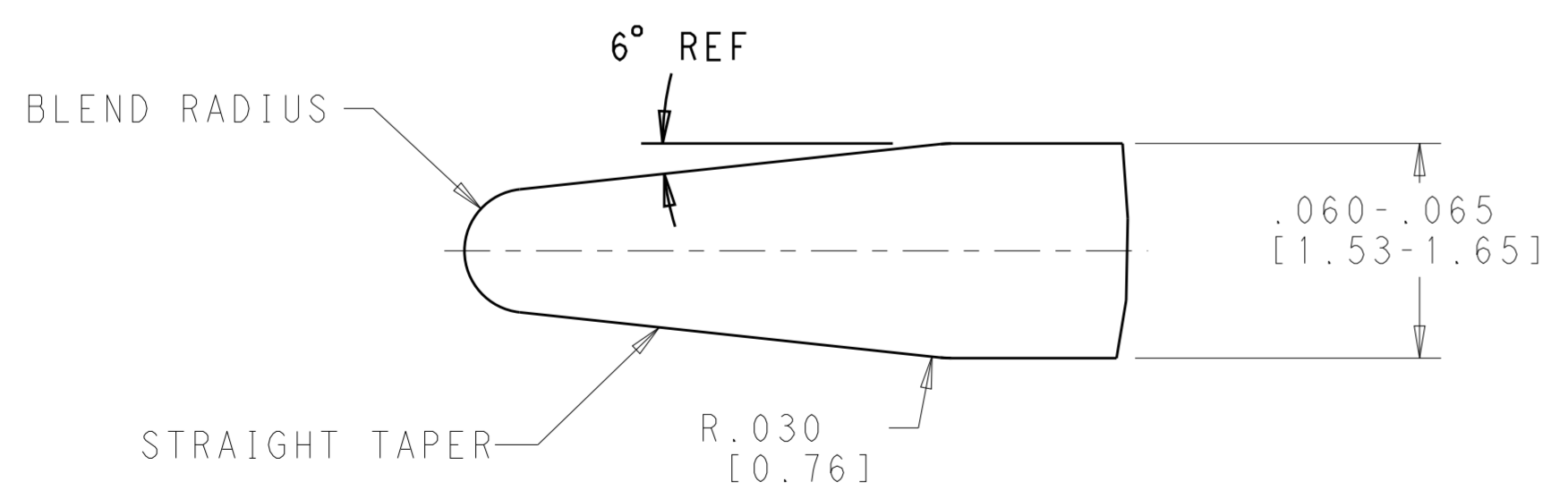

DETAIL Z
 SCALE 20:1

1.357 [34.47]	.409 [10.39]	446547-5
1.402 [35.61]	.454 [11.53]	446547-3
1.280 [32.51]	.332 [8.43]	446547-1
DIM F REF	DIM. F	PART NUMBER

THIS DRAWING IS A CONTROLLED DOCUMENT. DIMENSIONING AND TOLERANCING PER ASME Y14.5M-2009		DWN C.C. THOMAS 3-5-90	STE TE Connectivity	
DIMENSIONS: INCHES		CHK S. WRIGHT 3-7-90		
TOLERANCES UNLESS OTHERWISE SPECIFIED:		APVD S. WRIGHT 3-7-90	NAME PIN CONTACT, SIZE 16, ARINC 600	
0 PLC ±-		PRODUCT SPEC	-	
1 PLC ±.1		APPLICATION SPEC	-	
2 PLC ±.02		WEIGHT	-	
3 PLC ±.005		SCALE 8:1	SHEET 1 OF 1	
4 PLC ±.0005		CUSTOMER DRAWING	REV E	
ANGLES ±-		SIZE A200779 C-446547		
FINISH		RESTRICTED TO		
SEE CALLOUT		-		