

REVISIONS					
P	LTR	DESCRIPTION	DATE	DWN	APVD
AB7		REDRAWN PER ECO-19-005708	14MAY2019	BKW	SF
AB8		REVISED PER ECR-24-203684	04APR2024	AK	BR
AB9		REVISED PER ECR-24-224610	10MAR2025	AK	BR

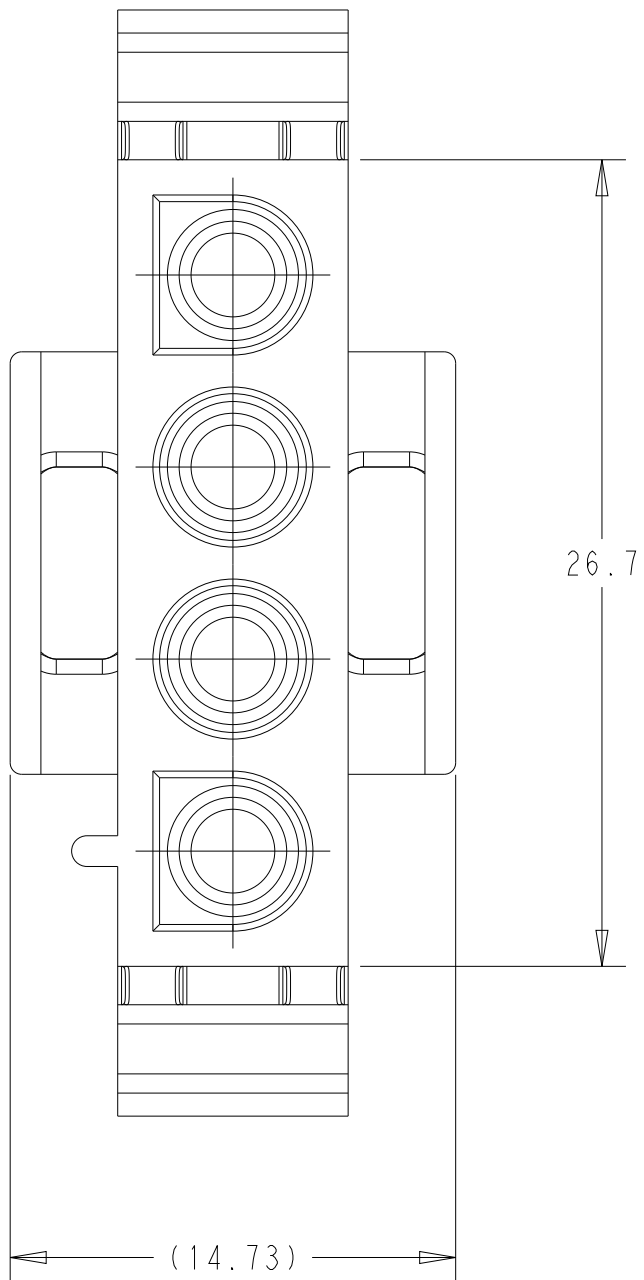

- MATES WITH APPROPRIATE UNIVERSAL MATE-N-LOCK™ CAP OR HEADER.
 - SMALL NICKS ARE PERMITTED ON THE CIRCUIT TOWERS WHICH COULD INCREASE THE INITIAL HOUSING MATING FORCE BY UP TO 4.4 NEWTONS (1.0 LBS.). NO INDIVIDUAL NICKED TOWER SHALL INCREASE THIS FORCE BY OVER 2.2 NEWTONS (.5 LBS.).
 - DIMENSIONS SHOWN REPRESENT PRODUCT IN DRY, AS MOLDED, CONDITION. ADDITIONAL 2% GROWTH DUE TO SUBSEQUENT MOISTURE ABSORPTION MAY OCCUR AND SHOULD BE ACCOUNTED FOR.
- 4 FOUR RIBS EQUALLY SPACED, NO SPECIFIC ORIENTATION, NO RIBS OR SIX RIBS EQUALLY SPACED, NO SPECIFIC ORIENTATION, OPTIONAL.
- 5 NOT MANUFACTURED IN THE U.S.
- 6 UNDERWRITERS RECOGNIZED COMPONENT LOGO AND CSA CERTIFICATION LOGO TO BE LOCATED ONCE ON ANY SIDE OF HOUSING.
- 7 MATERIAL CORRESPONDING TO THE REQUIREMENT OF IEC60335-1 (INCL. GWT 750°C WITHOUT FLAME)
- 8 SHOWN FOR CONVENIENCE: AMP OR TE LOGO MAY BE ON ANY EXTERNAL SURFACE.

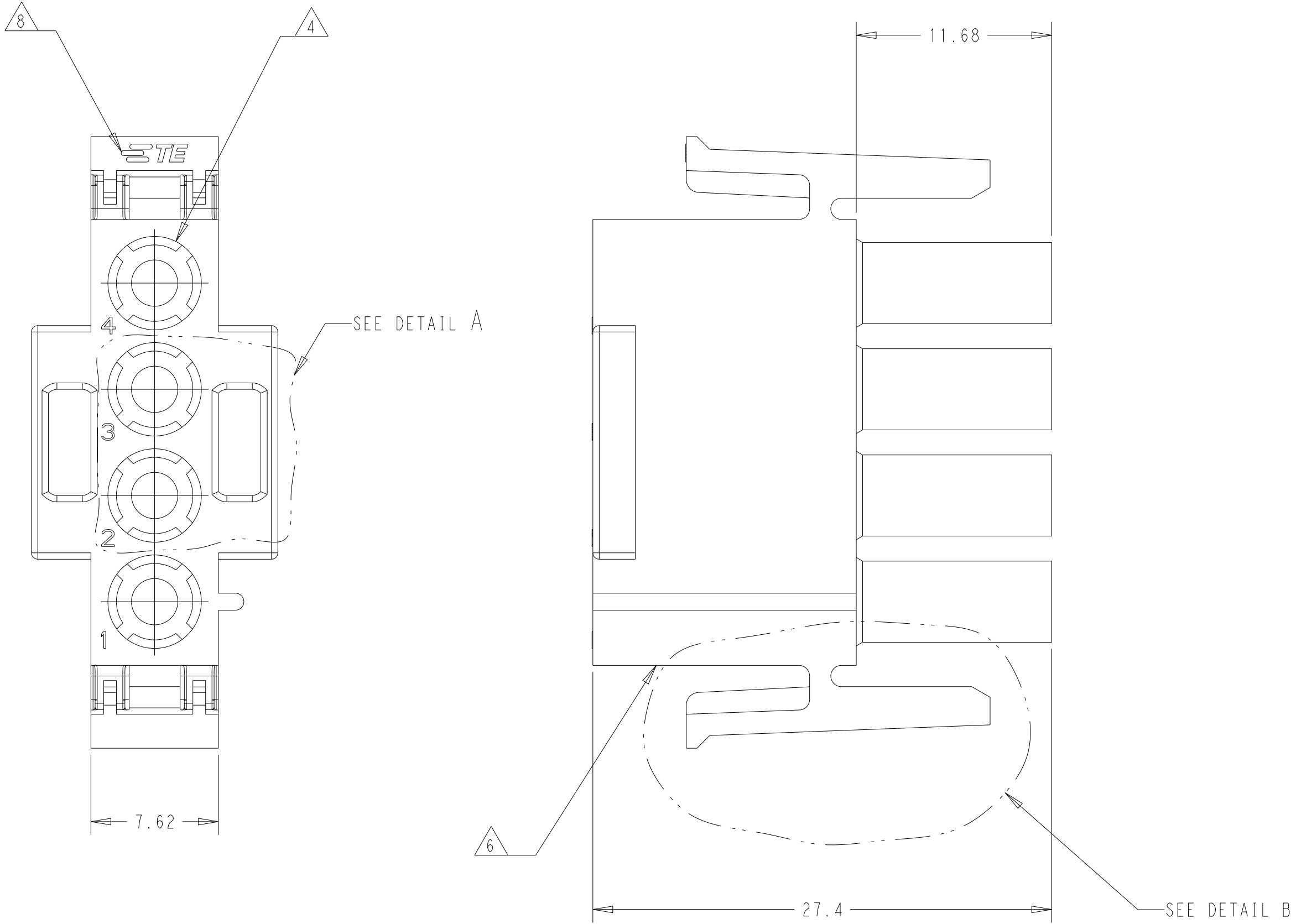
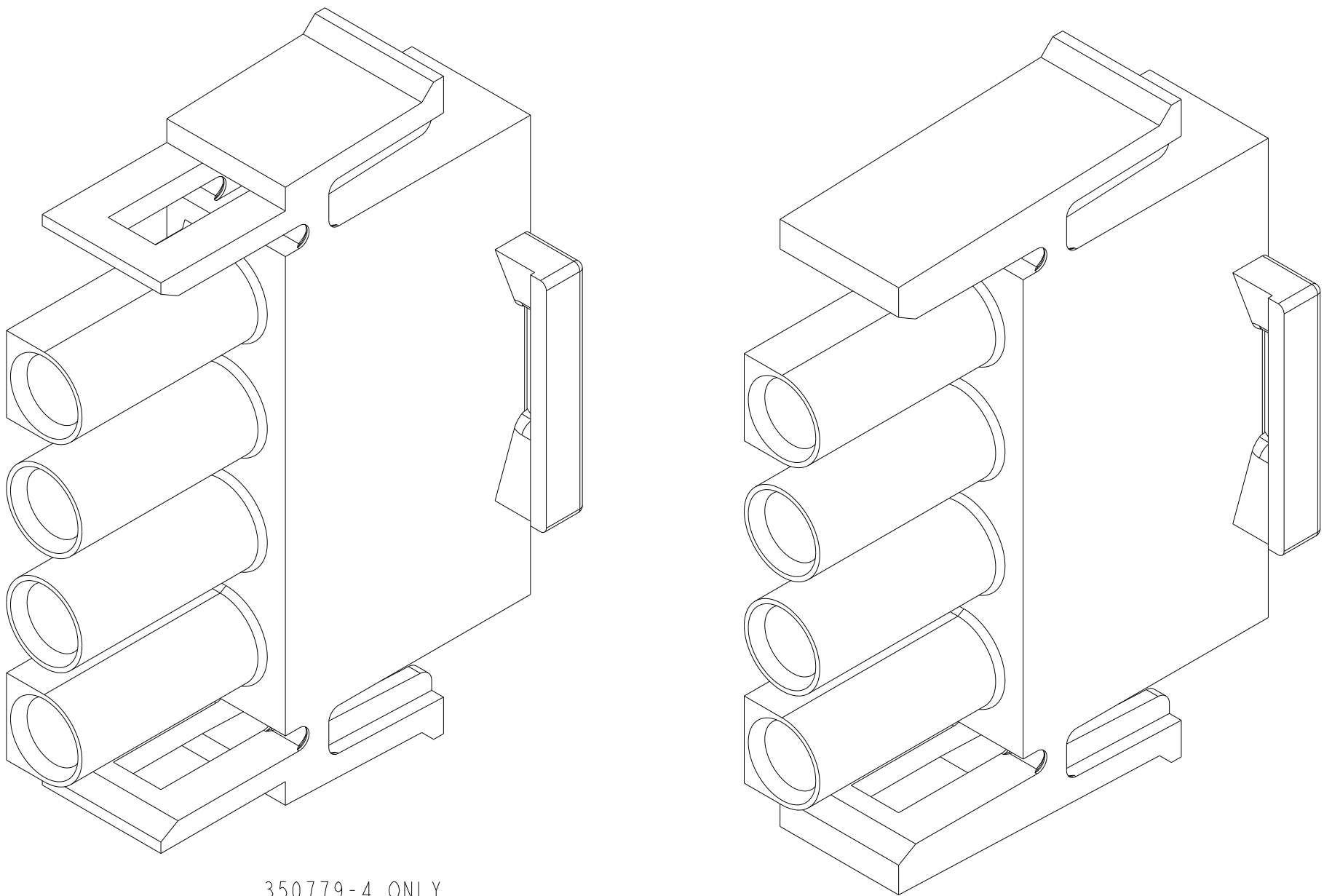
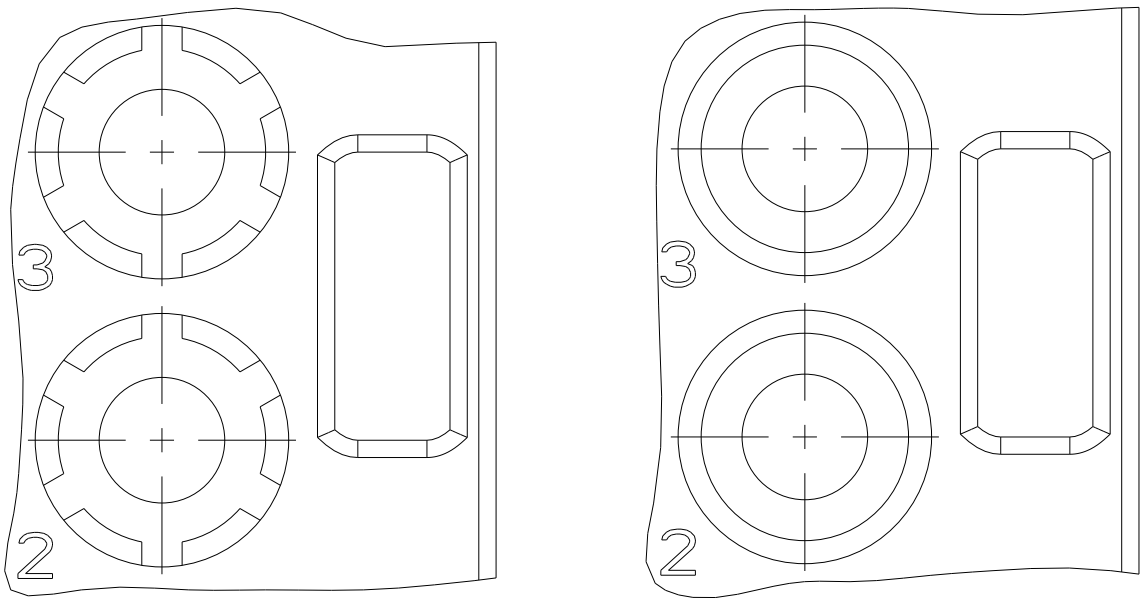
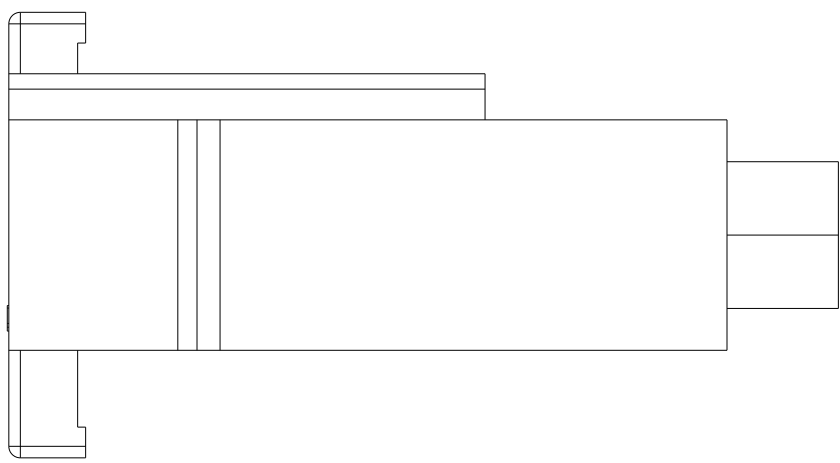

350779-4 ONLY

	NATURAL	350779-5
	BLACK	1-350779-9
	GRAY	1-350779-8
	BLUE	1-350779-6
	GREEN	1-350779-5
	YELLOW	1-350779-4
	ORANGE	1-350779-3
OBsolete	RED	1-350779-2
	BROWN	1-350779-1
		350779-4
	NATURAL	350779-1
	COLOR	PART NUMBER

THIS DRAWING IS A CONTROLLED DOCUMENT.		DWN B. WEAVER 14MAY2019	TE Connectivity	
		CHK S. FERNANDES 14MAY2019		
		APVD T. BENCHOFF 14MAY2019		
		NAME PLUG, 4 CIRCUIT, UNIVERSAL MATE-N-LOCK		
DIMENSIONS:		PRODUCT SPEC	SIZE CAGE CODE DRAWING NO	
mm		APPLICATION SPEC	A 00779 C=350779	
TOLERANCES UNLESS OTHERWISE SPECIFIED:		WEIGHT	RESTRICTED TO	
0 PLC ±.4		CUSTOMER DRAWING	SCALE 4:1 SHEET 1 OF 1 REV AB9	
1 PLC ±0.4				
2 PLC ±0.20				
3 PLC ±.4				
4 PLC ±.4				
ANGLES ±0°30'				
FINISH				
MATERIAL NYLON 94V-0				