

P	LTR	DESCRIPTION	DATE	DWN	APVD
	A	ECN-24-249693	29JAN2024	SS	RB

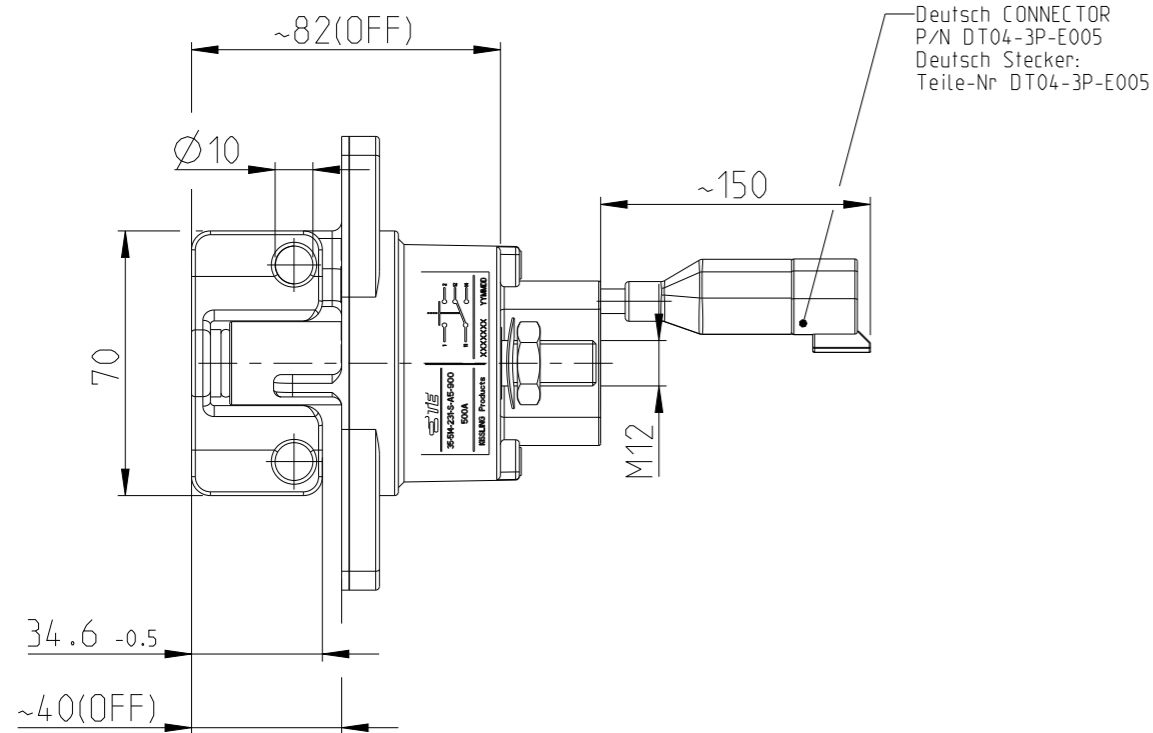

Deutsch CONNECTOR  
P/N DT04-3P-E005  
Deutsch Stecker:  
Teile-Nr DT04-3P-E005

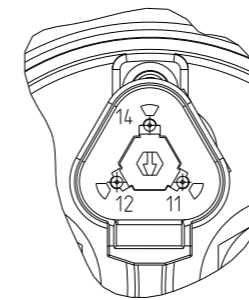
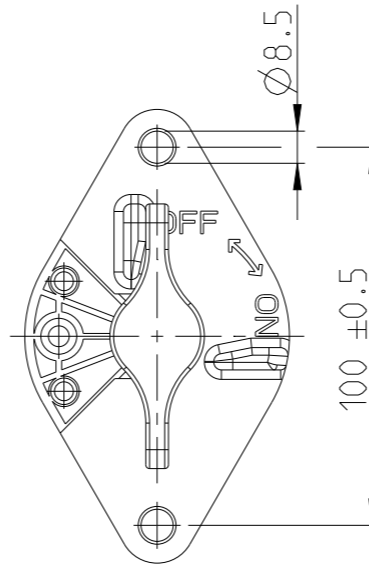

1:1

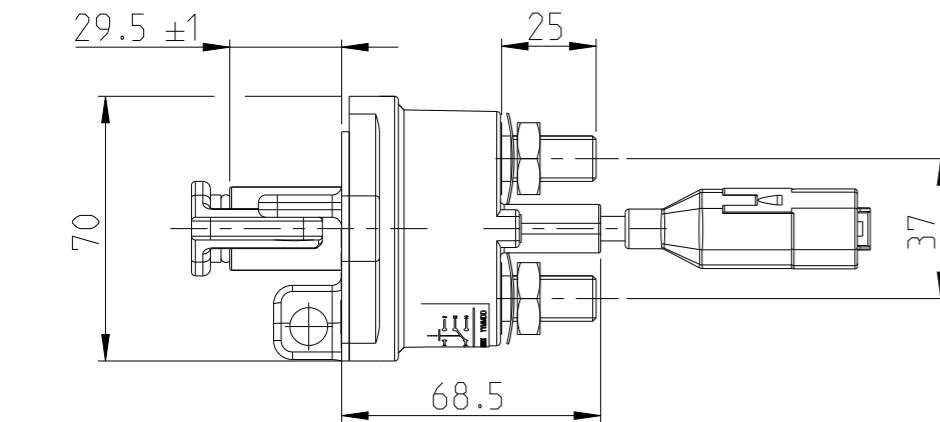

TECHNICAL DATA:  
 MATERIAL: COVER.....VYNOLIT BLACK  
 BASE PLATE.....PA GF BLACK  
 SWITCH LEVER.....PA GF BLACK  
 MIN. INSULATION RESISTANCE.....100MΩ  
 DIELECTRIC WITHSTANDING VOLTAGE.....1050V-1min.  
 MAX. CONTACT DROP DURING RESISTIVE LOAD.....150mV  
 VOLTAGE.....UP TO 32VDC  
 DUTY RATING.....500A  
 OVERLOAD.....1500A-4min.  
 .....2000A-1.5min.  
 .....2500A-10sec.  
 AUXILIARY CONTACT:  
 CONTINUOUS CURRENT.....10A  
 MAKE AND BRAKE.....24V L/R 5ms 10A  
 .....24V L/R 20ms 6A  
 SEALING.....IP 67 / IEC 529  
 VIBRATION.....4G / 50-2000Hz  
 SHOCK.....6G / 11ms  
 TEMPERATURE RANGE.....-40°C TO +85°C  
 WIRE SECTION (AT NOMINAL LOAD MAIN TERMINALS).....MIN. 250mm<sup>2</sup>  
 SWITCH LEVER.....NOT REMOVABLE  
 MAX. TORQUE (MAIN TERMINALS).....18-22 Nm

Technische Daten:  
 Werkstoff: Haube .....Vyncolit Schwarz  
 Befestigungssockel.....PA GF Schwarz  
 Schalthebel.....PA GF Schwarz  
 Min. Isolationswiderstand.....100 MΩ  
 Hochspannungsfestigkeit.....1050V-1min.  
 Max. Kontaktspannungsabfall bei Nennlast.....150mV  
 Betriebsspannung.....bis 32 VDC  
 Dauerstrom.....500A  
 Ueberlast.....1500A-4min.  
 .....2000A-1.5min.  
 .....2500A-10 Sek.  
 Hilfskontakt:  
 Dauerstrom.....10A  
 Schaltstrom.....24V L/R 5ms 10A  
 .....24V L/R 20ms 6A  
 Schutzart.....IP67 / IEC 529  
 Vibration.....4G / 50-2000Hz  
 Schock.....6G / 11ms  
 Umgebungstemperatur.....-40°C bis +85°C  
 Anschlussquerschnitt bei Nennlast Hauptkontakte.....min. 250mm<sup>2</sup>  
 Schalthebel.....nicht abziehbar  
 Max. Anzugsmoment (Hauptkontakte).....18-22Nm

NOTES  
Bemerkungen

- 1 TE-CONNECTIVITY ORDER-NUMBER  
TE-Connectivity Bestellnummer
- 2 DO NOT SWITCH UNDER LOAD!  
Nicht unter Last schalten!

CIRCUIT  
Schaltbild

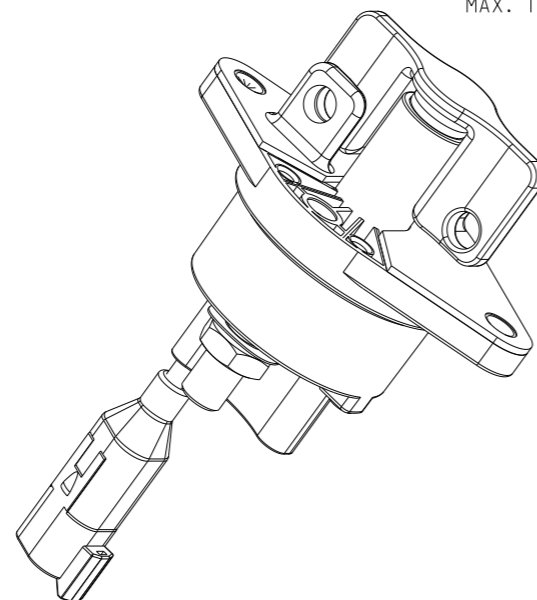
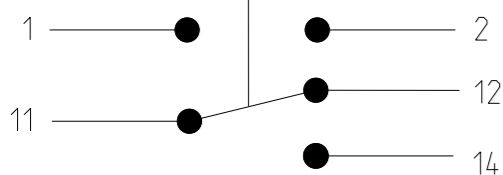

THIS DRAWING IS A CONTROLLED DOCUMENT.

DIMENSIONS:	TOLERANCES UNLESS OTHERWISE SPECIFIED:
mm	DIN ISO 2768 cL
	0 PLC ±
	1 PLC ±
	2 PLC ±
	3 PLC ±
	4 PLC ±
	ANGLES ±
MATERIAL	FINISH

DWN	N.Mielke	19NOV2014
CHK	N.Mielke	19NOV2014
APVD	U.Grindemann	03DEC2014
PRODUCT SPEC		
APPLICATION SPEC		
WEIGHT		

K1125921	A	BATTERY DISCONNECTOR 500A WITH AUX Batterietrennschalter 500A mit Hilfskontakt	403	1
TE ORDER-NO.	REV.	DESCRIPTION	WEIGHT [g]	ITEM NO
		TE Connectivity		
		NAME BATTERY DISCONNECTOR 500A WITH AUX Batterietrennschalter 500A mit Hilfskontakt		
SIZE	CAGE CODE	DRAWING NO	RESTRICTED TO	
A3	00779	35-514-231-S-A5-900	-	
CUSTOMER DRAWING		SCALE	SHEET	REV
		1:2	1 OF 1	A