

REVISIONS				
P.	LTM	DESCRIPTION	DATE	APVD
A		INITIAL RELEASE ECO-18-006327	23APR2018	JR GG

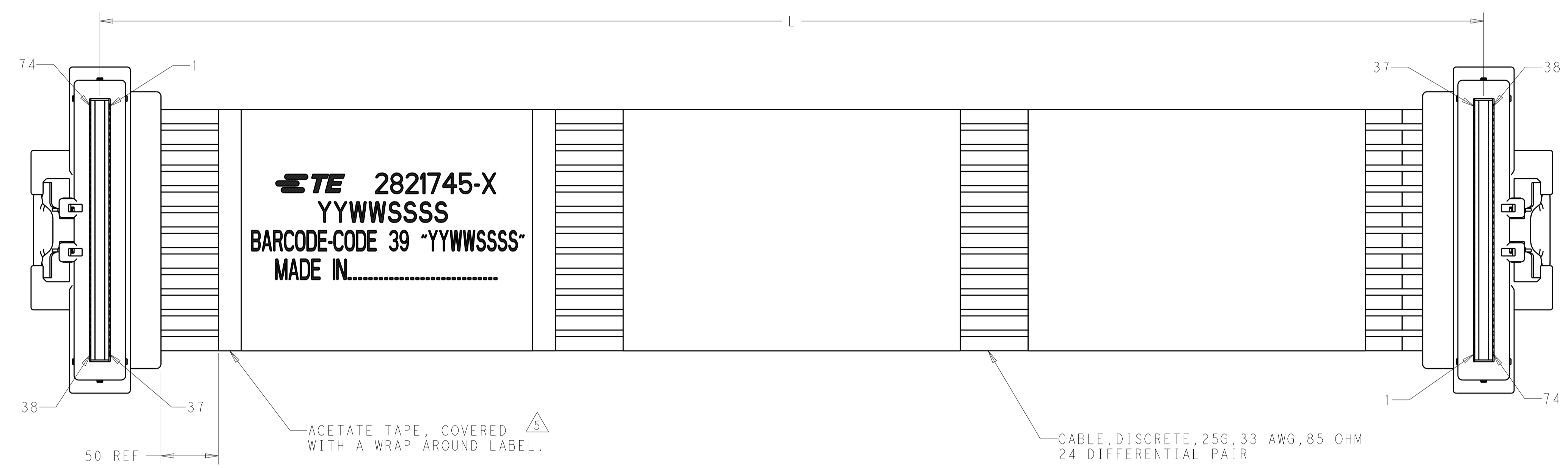
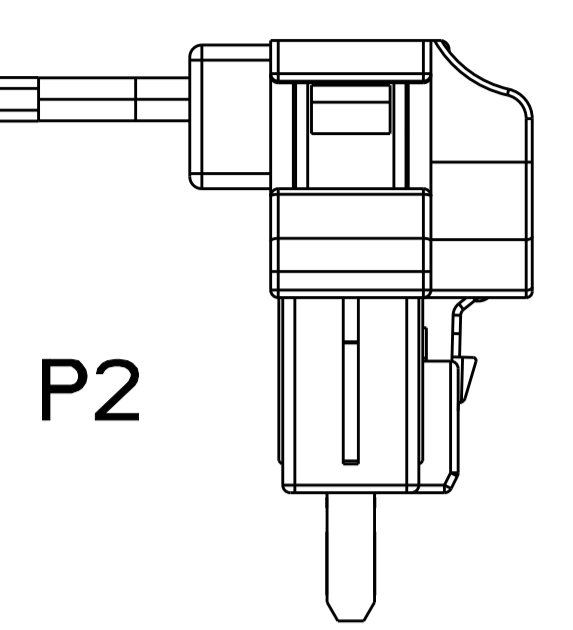
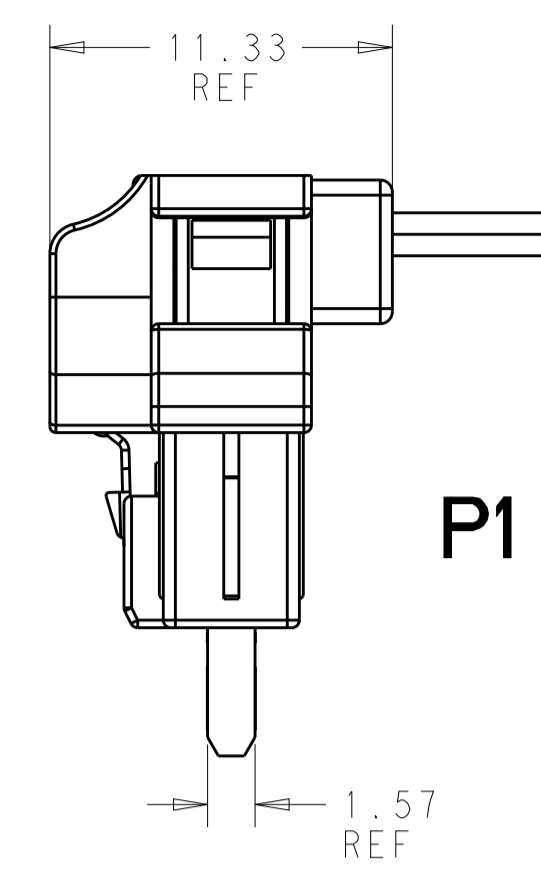
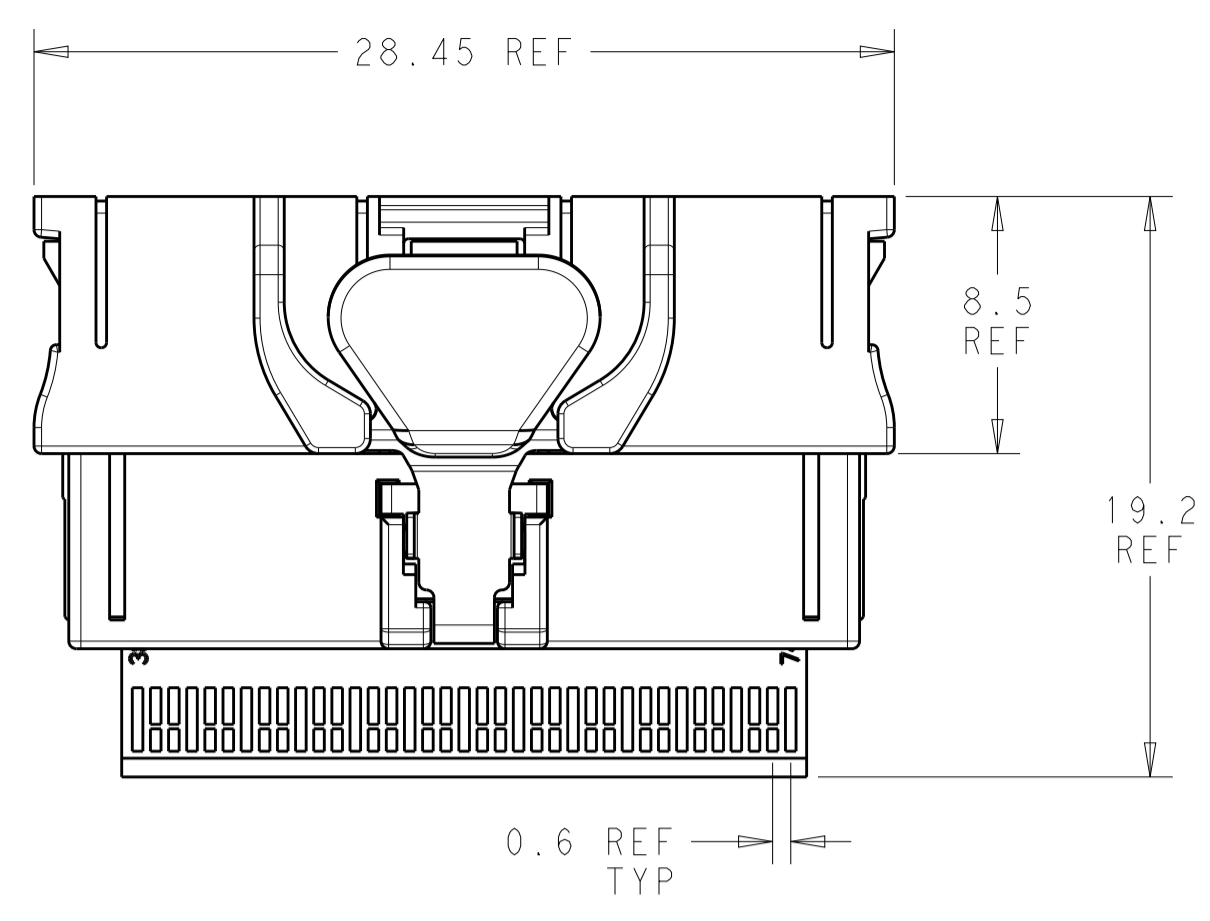

- CABLE ASSEMBLY TO BE TESTED FOR OPENS, SHORTS AND WIRING MAPPING. CABLES ARE ALSO TO BE TESTED FOR SIGNAL INTEGRITY. 10% OF PRODUCT TO BE TESTED FOR SIGNAL INTEGRITY.
- ALL MATERIALS, COMPONENTS AND PROCESS SHALL COMPLY WITH TEC-138-702. (CONTAINS NO BANNED OR RESTRICTED SUBSTANCES).
- SEE SHEET 2 FOR WIRING SCHEMATIC.
- MINIMUM BEND RADIUS OF THE CABLE = R4.5mm IN THE CABLE THICKNESS AXIS ONLY. MIN BEND RADIUS DOES NOT APPLY TO CABLE BENT IN THE WIDTH AXIS.

5 LABEL INFORMATION:

STE 2821745-X	TE LOGO & TE P/N
YYWSSSS	DATE CODE AND SERIAL NUMBER
BARCODE - CODE 39 "YYWSSSS"	
MADE IN	COUNTRY OF ORIGIN

- CABLE ASSEMBLIES ARE INDIVIDUALLY PACKAGED IN A CLEAR PLASTIC TUBE, SEALED ON BOTH ENDS.
- CABLE TO HAVE UP TO A 20MM DIFFERENCE IN BUNDLE OR SECTION HEIGHT, MEASURED FROM A TABLE OR OTHER FLAT SURFACE TO OUTERMOST SECTION OF RAW CABLE. THIS DIMENSION APPLIES BETWEEN LABEL AND NEXT CLOSEST SECTION OF TAPE OR CONNECTOR. CABLE ASSEMBLY IS STILL TO CONFORM TO LENGTH DIMENSION AND TOLERANCE.
- NO REACH SvHC SHALL BE CONTAINED ABOVE THE THRESHOLD AS DEFINED IN REACH SvHC COMPLIANCE DEFINITION IN ANNEX A OF TEC-138-702.

1000±20	2821745-2
500±10	2821745-1
L	PART NO

THIS DRAWING IS A CONTROLLED DOCUMENT.		OWN: B. MATTHEWS 15AUG2016	STE TE Connectivity
DIMENSIONS: mm		CHK: G. GUTGOLD 15AUG2016	
TOLERANCES UNLESS OTHERWISE SPECIFIED:		APVD: G. GUTGOLD 15AUG2016	NAME: CABLE ASSEMBLY, SLIVER, 74 POSITION, 85 OHM, RA TO RA
0 PLC ±		PRODUCT SPEC	SIZE: A1
1 PLC ±		APPLICATION SPEC	CAGE CODE: -
2 PLC ±		WEIGHT	DRAWING NO: C=2821745
3 PLC ±		CUSTOMER DRAWING	RESTRICTED TO: A
4 PLC ±		SCALE: 4:1	SHEET: 1 OF 2
ANGLES ±		REV: A	

REVISIONS				
P.	LTN	DESCRIPTION	DATE	APVD
-	-	SEE SHEET 1	-	-

P1			P2		
GND	1	↔	37	GND	
TX1 P	2	↔	36	RX1 P	
TX1 N	3	↔	35	RX1 N	
GND	4	↔	34	GND	
TX2 P	5	↔	33	RX2 P	
TX2 N	6	↔	32	RX2 N	
GND	7	↔	31	GND	
TX3 P	8	↔	30	RX3 P	
TX3 N	9	↔	29	RX3 N	
GND	10	↔	28	GND	
TX4 P	11	↔	27	RX4 P	
TX4 N	12	↔	26	RX4 N	
GND	13	↔	25	GND	
TX5 P	14	↔	24	RX5 P	
TX5 N	15	↔	23	RX5 N	
GND	16	↔	22	GND	
LOW SPEED	17	↔	21	LOW SPEED	
LOW SPEED	18	↔	22	LOW SPEED	
GND	19	↔	19	GND	
POWER	20	↔	18	POWER	
POWER	21	↔	17	POWER	
GND	22	↔	16	GND	
RX5 N	23	↔	15	TX5 N	
RX5 P	24	↔	14	TX5 P	
GND	25	↔	13	GND	
RX4 N	26	↔	12	TX4 N	
RX4 P	27	↔	11	TX4 P	
GND	28	↔	10	GND	
RX3 N	29	↔	9	TX3 N	
RX3 P	30	↔	8	TX3 P	
GND	31	↔	7	GND	
RX2 N	32	↔	6	TX2 N	
RX2 P	33	↔	5	TX2 P	
GND	34	↔	4	GND	
RX1 N	35	↔	3	TX1 N	
RX1 P	36	↔	2	TX1 P	
GND	37	↔	1	GND	

P1			P2		
GND	38	↔	74	GND	
RX6 P	39	↔	73	TX6 P	
RX6 N	40	↔	72	TX6 N	
GND	41	↔	71	GND	
RX7 P	42	↔	70	TX7 P	
RX7 N	43	↔	69	TX7 N	
GND	44	↔	68	GND	
RX8 P	45	↔	67	TX8 P	
RX8 N	46	↔	66	TX8 N	
GND	47	↔	65	GND	
RX9 P	48	↔	64	TX9 P	
RX9 N	49	↔	63	TX9 N	
GND	50	↔	62	GND	
RX10 P	51	↔	61	TX10 P	
RX10 N	52	↔	60	TX10 N	
GND	53	↔	59	GND	
LOW SPEED	54	↔	58	LOW SPEED	
LOW SPEED	55	↔	57	LOW SPEED	
GND	56	↔	56	GND	
POWER	57	↔	55	POWER	
POWER	58	↔	54	POWER	
GND	59	↔	53	GND	
TX10 N	60	↔	52	RX10 N	
TX10 P	61	↔	51	RX10 P	
GND	62	↔	50	GND	
TX9 N	63	↔	49	RX9 N	
TX9 P	64	↔	48	RX9 P	
GND	65	↔	47	GND	
TX8 N	66	↔	46	RX8 N	
TX8 P	67	↔	45	RX8 P	
GND	68	↔	44	GND	
TX7 N	69	↔	43	RX7 N	
TX7 P	70	↔	42	RX7 P	
GND	71	↔	41	GND	
TX6 N	72	↔	40	RX6 N	
TX6 P	73	↔	39	RX6 P	
GND	74	↔	38	GND	

WIRING MAPPING

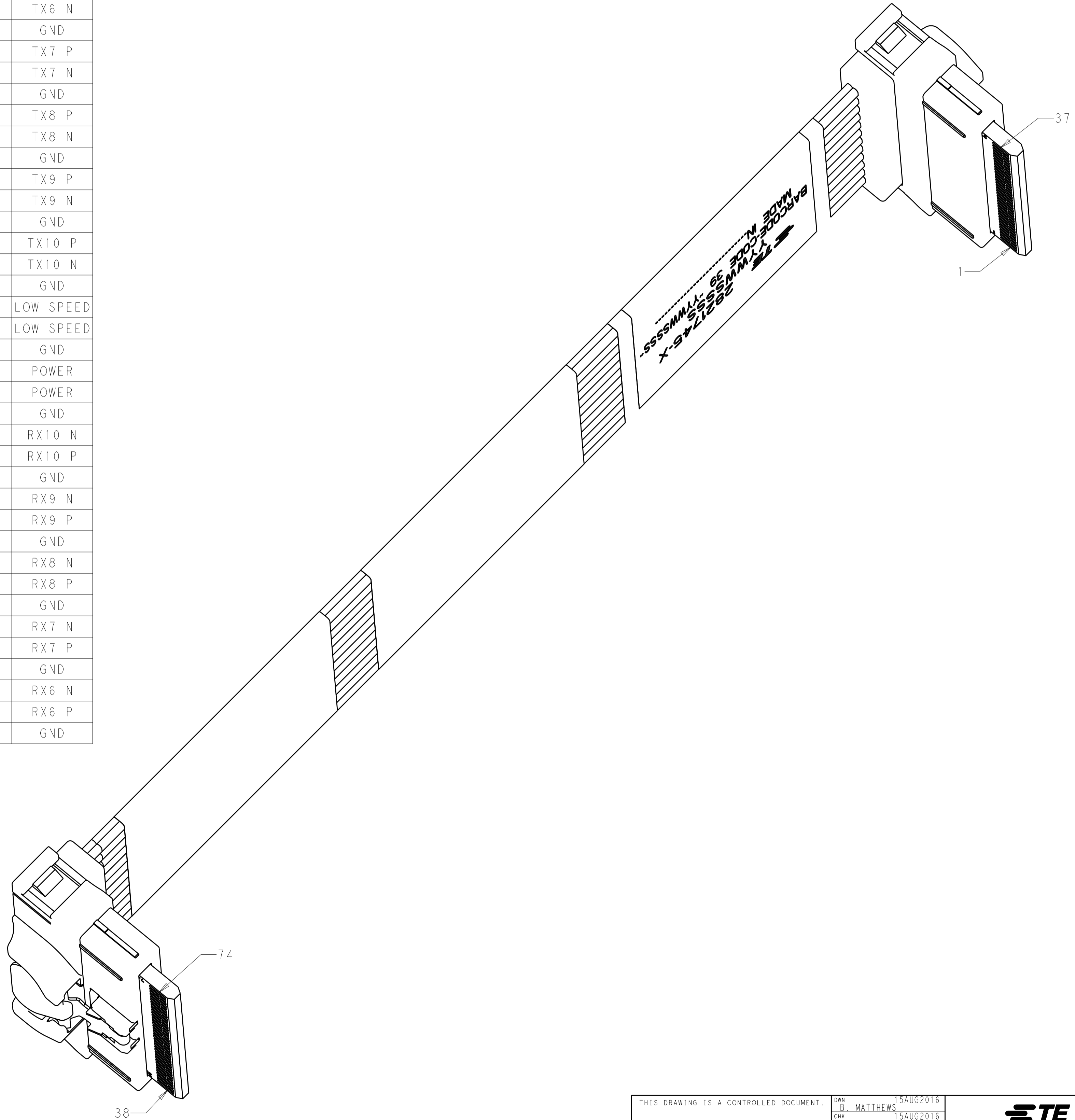

THIS DRAWING IS A CONTROLLED DOCUMENT.		OWN: B. MATTHEWS 15AUG2016	TE Connectivity
DIMENSIONS: mm		CHK: G. GUTGOLD 15AUG2016	
TOLERANCES UNLESS OTHERWISE SPECIFIED: 0 PLC ± 1 PLC ± 2 PLC ± 3 PLC ± 4 PLC ± ANGLES ±		APVD: G. GUTGOLD 15AUG2016	NAME: CABLE ASSEMBLY, SLIVER, 74 POSITION, 85 OHM, RA TO RA
MATERIAL: -		FINISH: -	RESTRICTED TO: -
WEIGHT: -		CUSTOMER DRAWING	SIZE: A1 CAGE CODE: - DRAWING NO: C=2821745 SCALE: 4:1 SHEET: 2 OF 2 REV: A