

REVISIONS					
P	LTR	DESCRIPTION	DATE	DWN	APVD
	A	INITIAL RELEASE	27DEC2023	G.C	H.L

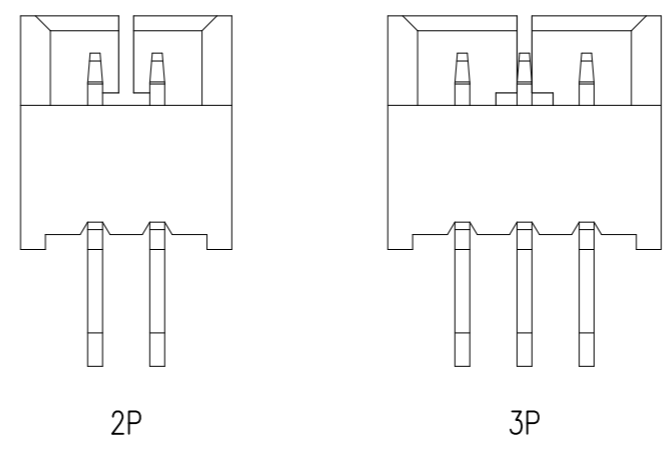

- NOTES:
- 1,Current Rating: 1.0A
 - 2,Contact Resistance: 20mΩ Max
 - 3,Withstand Voltage: 500V AC
 - 4,Insulation Resistance: 100MΩ Min
 - 5,Operation Temperature: -25°C to +85°C
 - 6,Housing: High temperature thermoplastic, UL94V-0, Natural
 - 7,Contact: Brass
100u" Matte tin over 50u" nickel

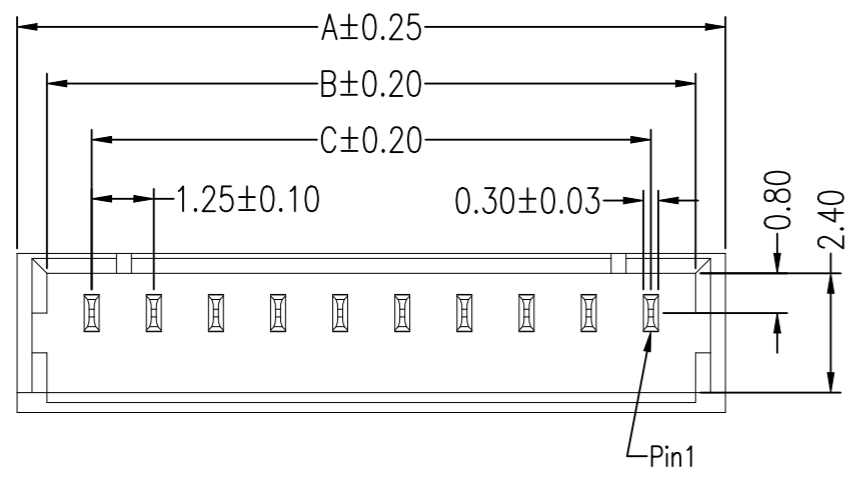
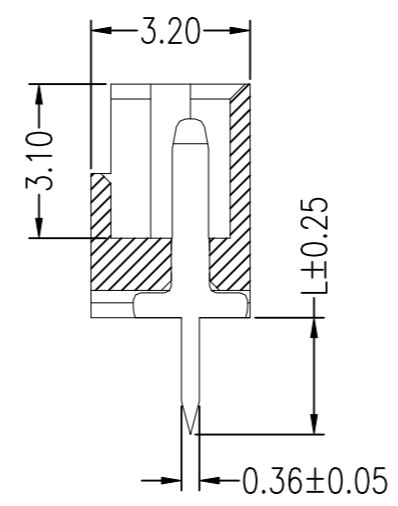
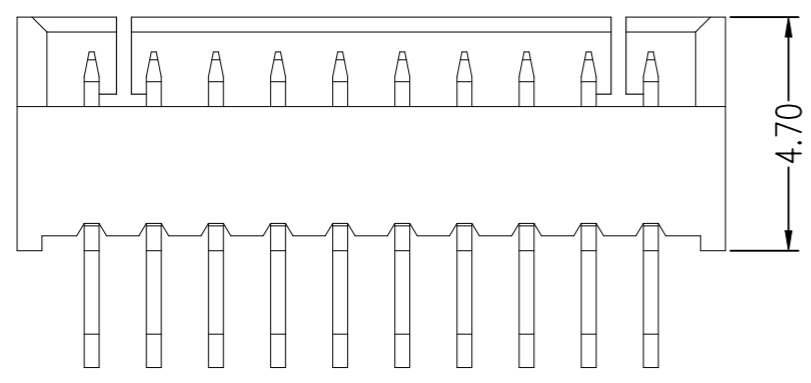

4~15P

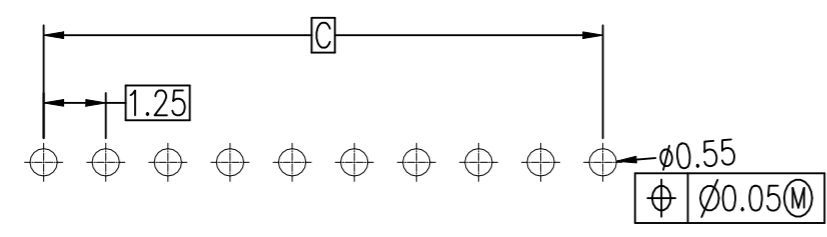

L	PINS	DIM A	DIM B	DIM C	PN
2.35	15	20.50	19.30	17.50	3-2473226-5
	14	19.25	18.05	16.25	3-2473226-4
	13	18.00	16.80	15.00	3-2473226-3
	12	16.75	15.55	13.75	3-2473226-2
	11	15.50	14.30	12.50	3-2473226-1
	10	14.25	13.05	11.25	3-2473226-0
	9	13.00	11.80	10.00	2-2473226-9
	8	11.75	10.55	8.75	2-2473226-8
	7	10.50	9.30	7.50	2-2473226-7
	6	9.25	8.05	6.25	2-2473226-6
	5	8.00	6.80	5.00	2-2473226-5
	4	6.75	5.55	3.75	2-2473226-4
	3	5.50	4.30	2.50	2-2473226-3
	2	4.25	3.05	1.25	2-2473226-2
	1.70	15	20.50	19.30	17.50
14		19.25	18.05	16.25	1-2473226-4
13		18.00	16.80	15.00	1-2473226-3
12		16.75	15.55	13.75	1-2473226-2
11		15.50	14.30	12.50	1-2473226-1
10		14.25	13.05	11.25	1-2473226-0
9		13.00	11.80	10.00	2473226-9
8		11.75	10.55	8.75	2473226-8
7		10.50	9.30	7.50	2473226-7
6		9.25	8.05	6.25	2473226-6
5	8.00	6.80	5.00	2473226-5	
4	6.75	5.55	3.75	2473226-4	
3	5.50	4.30	2.50	2473226-3	
2	4.25	3.05	1.25	2473226-2	

RECOMMENDED P.C.B LAYOUT
(COMPONENT SIDE)(TOLERANCE: ±0.05)

THIS DRAWING IS A CONTROLLED DOCUMENT.		DWN GOWTHAM 27DEC23	TE Connectivity		
DIMENSIONS: mm		CHK CONNOR KANG			
TOLERANCES UNLESS OTHERWISE SPECIFIED:		APVD HOPE LU 27DEC23	NAME		
0 PLC ± -		PRODUCT SPEC	1.25 MM PITCH WIRE TO BOARD CONNECTOR, HEADER,DIP,VERTICAL		
1 PLC ± -		108-161194	-		
2 PLC ± 0.25		APPLICATION SPEC	SIZE	CAGE CODE	DRAWING NO
3 PLC ± -		114-160812	A3	00779	C-247326
4 PLC ± -		MATERIAL	RESTRICTED TO		
ANGLES ± -		FINISH	-		
-		WEIGHT	-		
-		CUSTOMER DRAWING	SCALE	SHEET	REV
-			1:1	1 OF 2	A

REVISIONS					
P	LTR	DESCRIPTION	DATE	DWN	APVD
	-	SEE SHEET 1	-	-	-

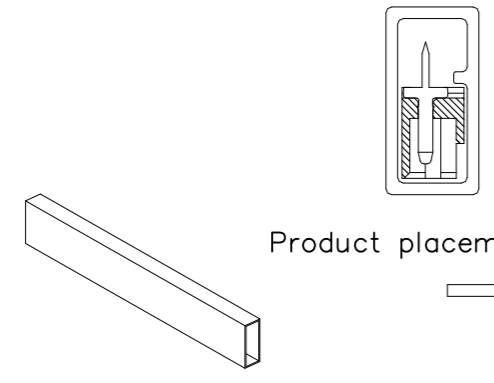

Product placement diagram

No: 1

Put the product into the vacuum tube
SG-B199(600*3.6*8.5mm)

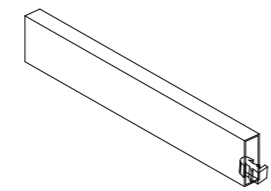

No: 2

Place the plastic plug

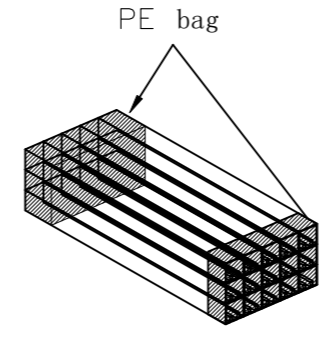

No: 3

20 tubes for a tie,
use PE bag to fix the two ends of
each tie vacuum tube

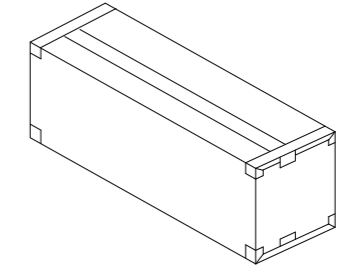

No: 4

Put the vacuumed products into the inner box.
(18 ties/box) and seal the box.
box specification: CTN-10ATE(63*15*17CM)

Large transparent adhesive

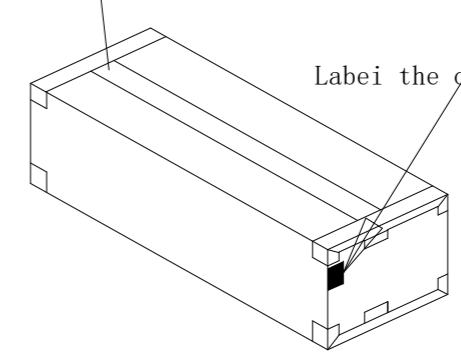

Label the outer box

No: 5

Seal the box and stick the
label on the top left corner
of the side of the outer box

TEP/N	PCS/Tube	PCS/Box
2473226-2	136	48960
2-2473226-2	136	48960
2473226-3	105	37800
2-2473226-3	105	37800
2473226-4	85	30600
2-2473226-4	85	30600
2473226-5	72	25920
2-2473226-5	72	25920
2473226-6	62	22320
2-2473226-6	62	22320
2473226-7	55	19800
2-2473226-7	55	19800
2473226-8	49	17640
2-2473226-8	49	17640
2473226-9	44	15840
2-2473226-9	44	15840
1-2473226-0	40	14400
3-2473226-0	40	14400
1-2473226-1	37	13320
3-2473226-1	37	13320
1-2473226-2	34	12240
3-2473226-2	34	12240
1-2473226-3	32	11520
3-2473226-3	32	11520
1-2473226-4	30	10800
3-2473226-4	30	10800
1-2473226-5	25	9000
3-2473226-5	25	9000

Instructions:

- Place the product into the vacuum tube as per the product placement diagram;
- Pay attention to the style of each label. Position and direction of consistency;
- When playing the outer box packing tape need to pay attention to, play for the cross type.

THIS DRAWING IS A CONTROLLED DOCUMENT.		DWN GOWTHAM 27DEC23	TE Connectivity		
DIMENSIONS: mm		CHK CONNOR KANG -			
TOLERANCES UNLESS OTHERWISE SPECIFIED:		APVD HOPE LU 27DEC23	NAME 1.25 MM PITCH WIRE TO BOARD CONNECTOR, HEADER,DIP,VERTICAL		
0 PLC ± - 1 PLC ± - 2 PLC ± 0.25 3 PLC ± - 4 PLC ± - ANGLES ± -		PRODUCT SPEC -	APPLICATION SPEC -		
MATERIAL -	FINISH -	WEIGHT 0	SIZE A3	CAGE CODE 00779	DRAWING NO C-247326
CUSTOMER DRAWING			SCALE 1:1	SHEET 2 OF 2	REV A