

REVISIONS					
P	LTR	DESCRIPTION	DATE	DWN	APVD
A1		ECN-23-242146	04DEC2023	BTV	KJ

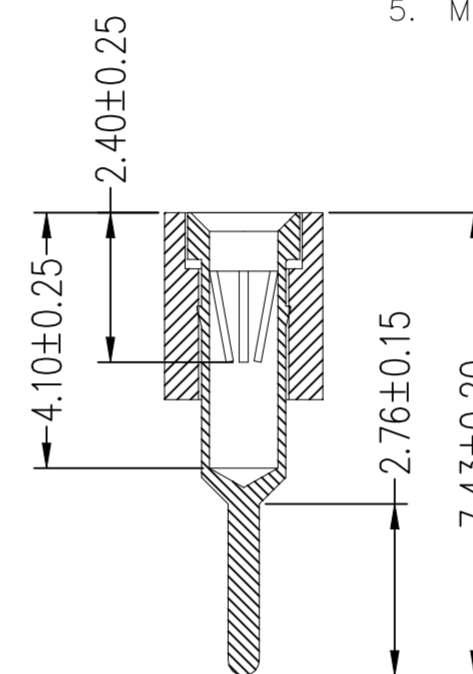

NOTES:

- MATERIAL:
 - 1, INSULATOR – THERMOPLASTIC UL-94-V-0 BLACK
 - 2, SLEEVE & CONTACT – COPPER ALLOY
 - PIN SPECIFICATION: CONTACT ACCEPTS: ROUND PIN Ø0.40 TO 0.56.
 - ELECTRICAL:
 - CONTACT RESISTANCE– 10 mΩ MAX.
 - CONTACT RATING– 1Amp
 - INSULATION RESISTANCE– 10000 MΩ.
 - DIELECTRIC VOLTAGE– 1000V AC
 - ENVIRONMENTAL:
 - OPERATION TEMPERATURE – -55 +125°C
 - SOLDERING PROCESS CAPABILITY – 260°C
 - MECHANICAL LIFE:
 - 100 CYCLES MIN (0.75 Au)
 - 50 CYCLES MAX (FLASH Au)
 - 25 CYCLES MAX (Sn)
- INSERTION FORCE – 200GRAMS/PIN
 WITHDRAWAL FORCE – 60GRAMS/PIN
 CONTACT RETENSION – 1.5KG.F MIN/PIN

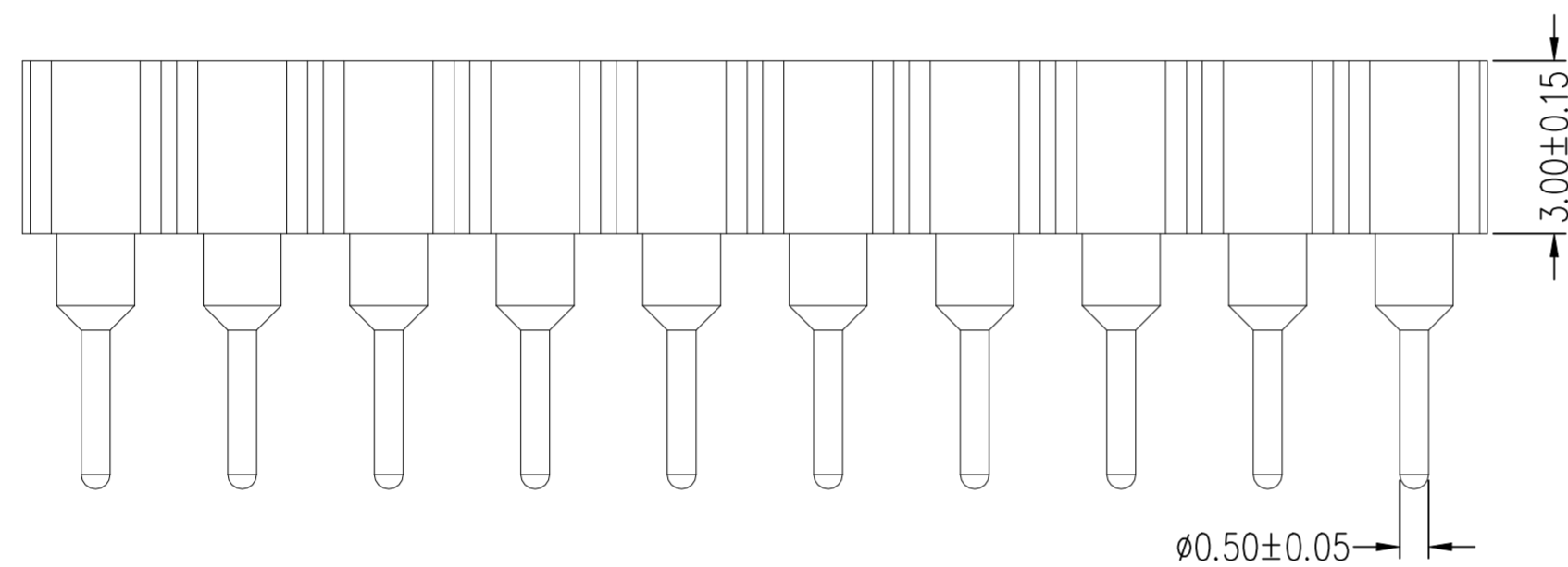
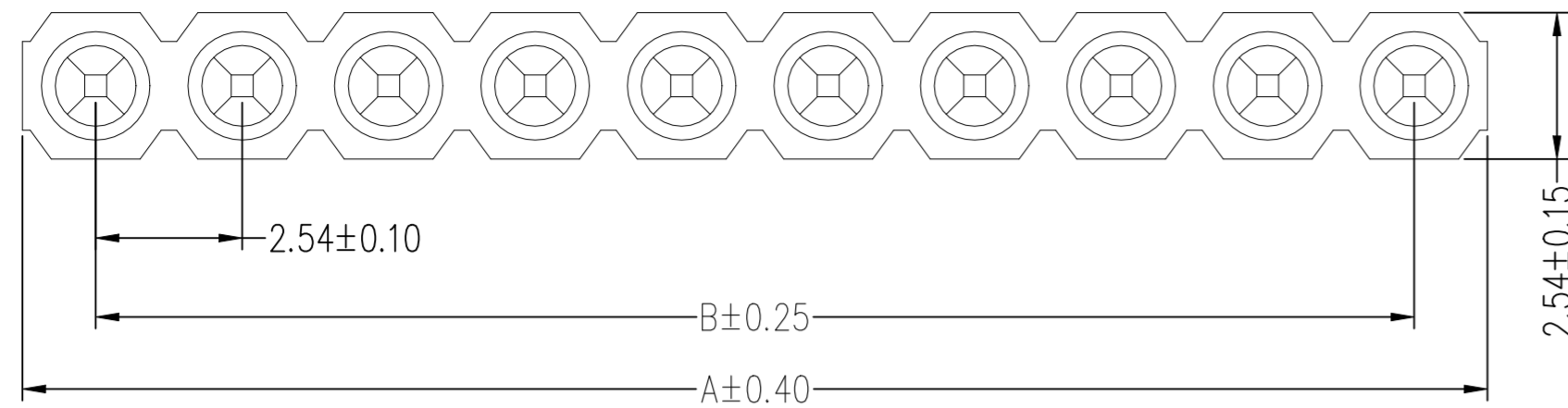

RECOMMENDED P.C.B LAYOUT
(COMPONENT SIDE)(TOLERANCE: ±0.05)

10800	1800	300	Au flash OVER Ni	2µm MIN Sn OVER 2-3µm Ni	50.80	48.26	20	2444090-5
10800	1800	300	.75µm Au OVER Ni	2µm MIN Sn OVER 2-3µm Ni	50.80	48.26	20	2444090-4
18000	3000	500	Au flash OVER Ni	2µm MIN Sn OVER 2-3µm Ni	40.64	38.10	16	2444090-3
14400	2400	600	Au flash OVER Ni	2µm MIN Sn OVER 2-3µm Ni	25.40	22.86	10	2444090-2
14400	2400	600	.75µm Au OVER Ni	2µm MIN Sn OVER 2-3µm Ni	25.40	22.86	10	2444090-1
PCS/ OUTER BOX	PCS/ INNER BOX	PCS/ BAG	Contact Plating	Sleeve Plating	DIM A	DIM B	Number Of Positions	Part No

THIS DRAWING IS A CONTROLLED DOCUMENT.

DWN	15FEB2023	BONEY THOMAS
CHK	-	-
APVD	15FEB2023	KIM JIN
PRODUCT SPEC	108-160875	
APPLICATION SPEC	-	
WEIGHT	0	
CUSTOMER DRAWING		

TE Connectivity

SIP SOCKET

SIZE: A2 CAGE CODE: 00779 DRAWING NO: C-2444090 RESTRICTED TO: -

SCALE: 1:1 SHEET: 1 of 1 REV: A1