

CUT OFF WITH POLARISATION

Befestigungsausschnitt mit Polarisation

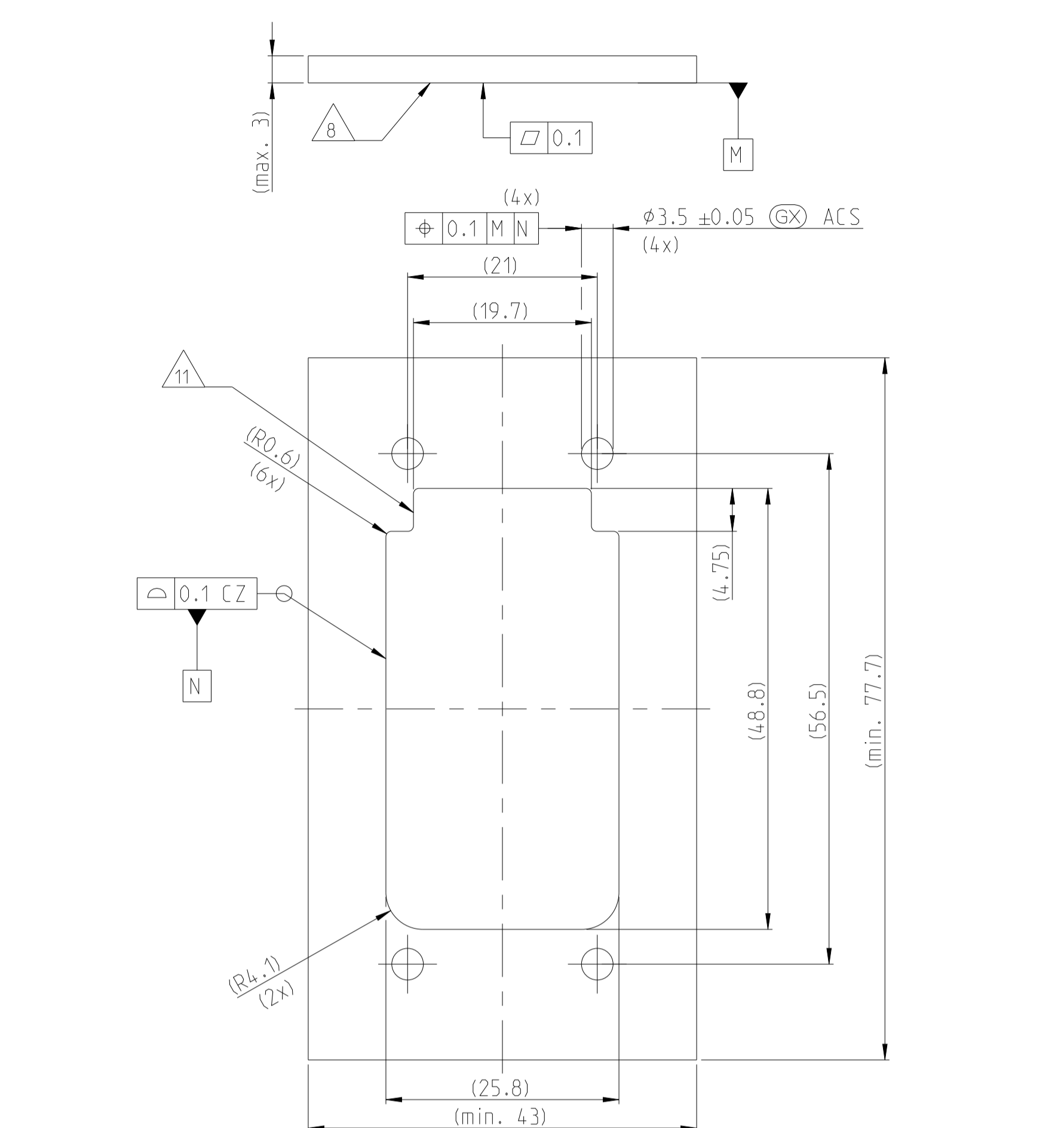

PCB LAYOUT

Leiterplatte Layout

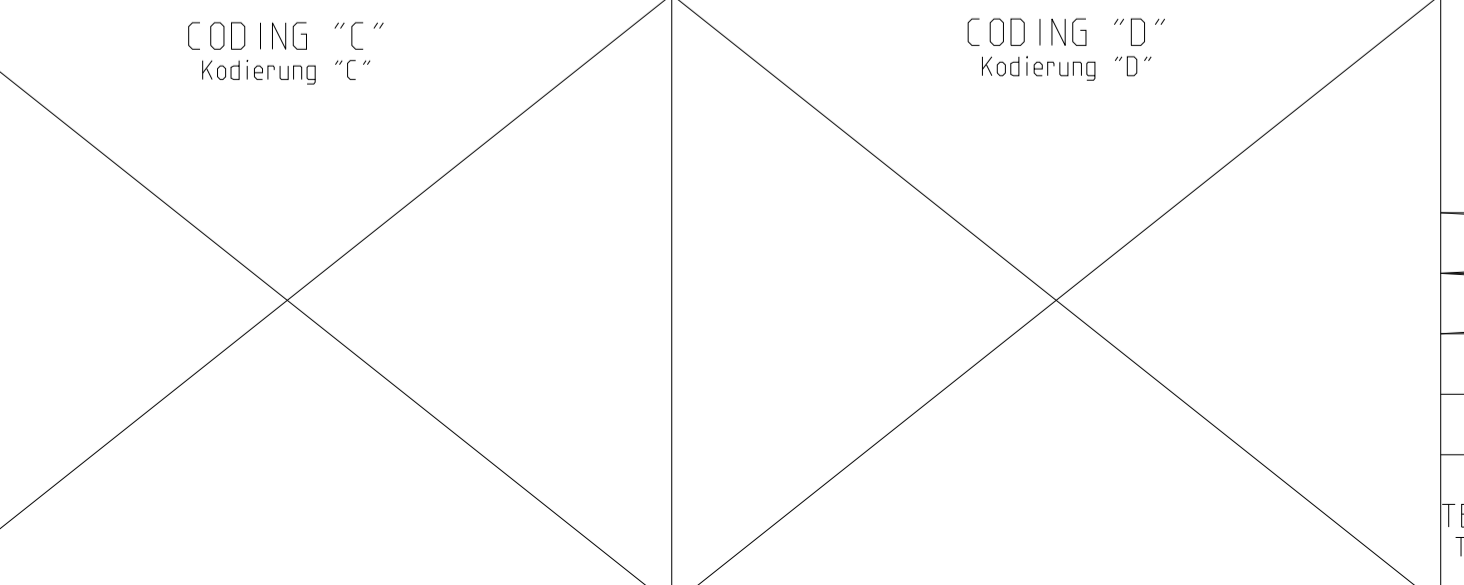
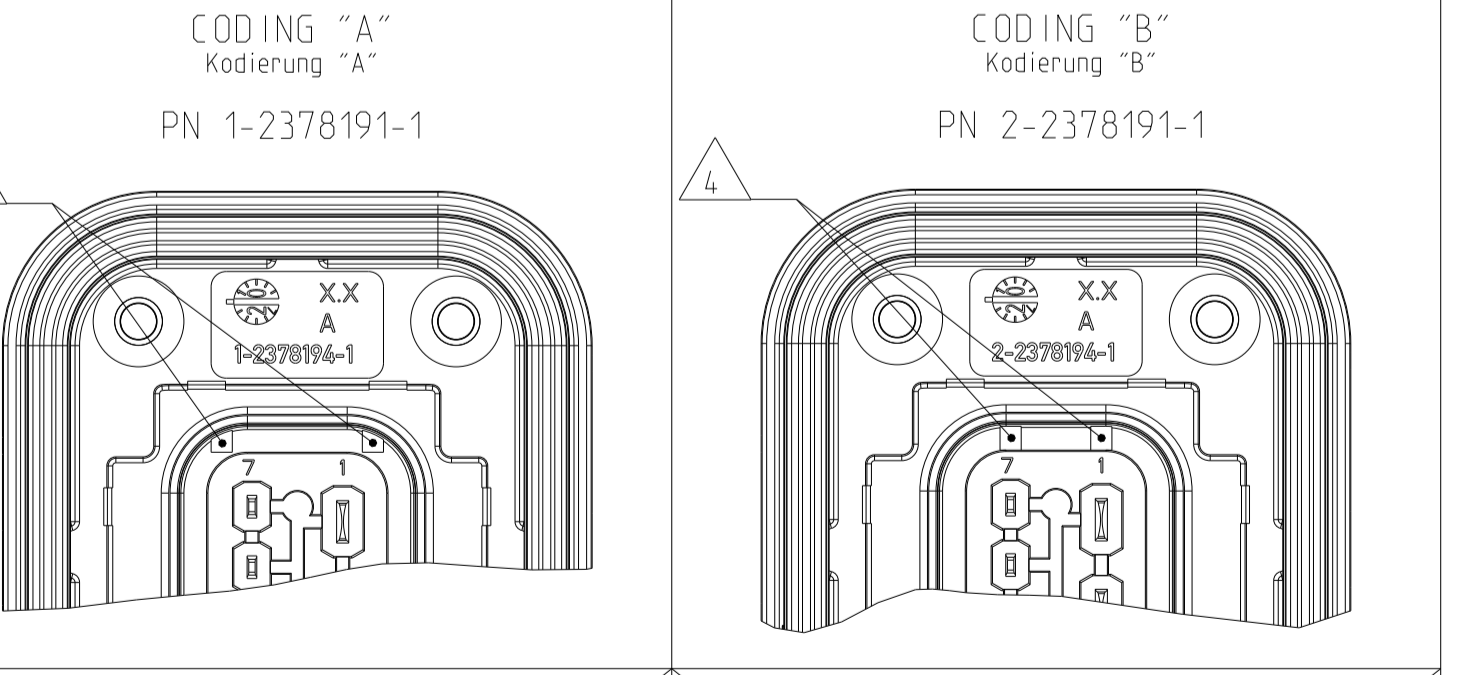
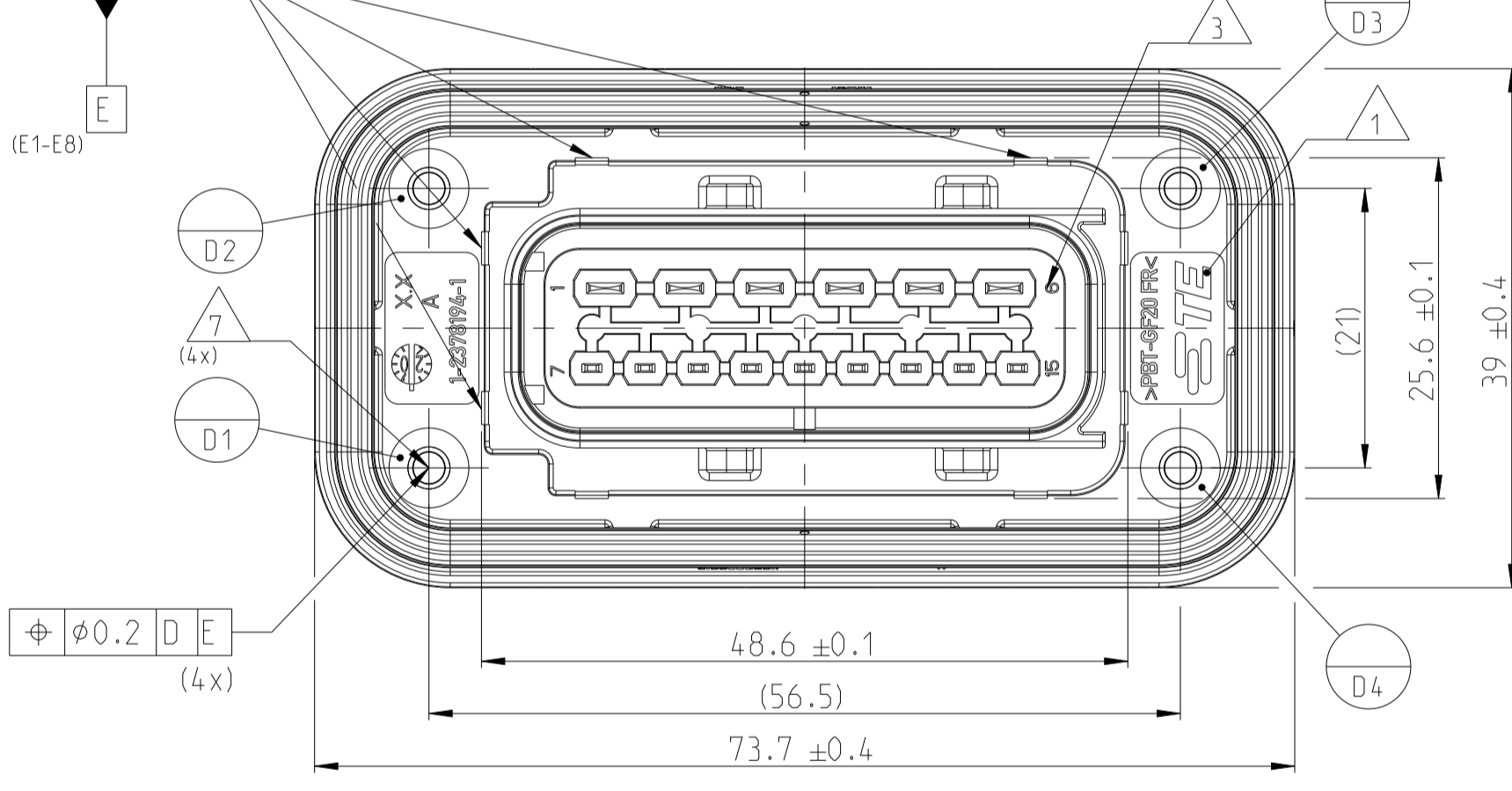
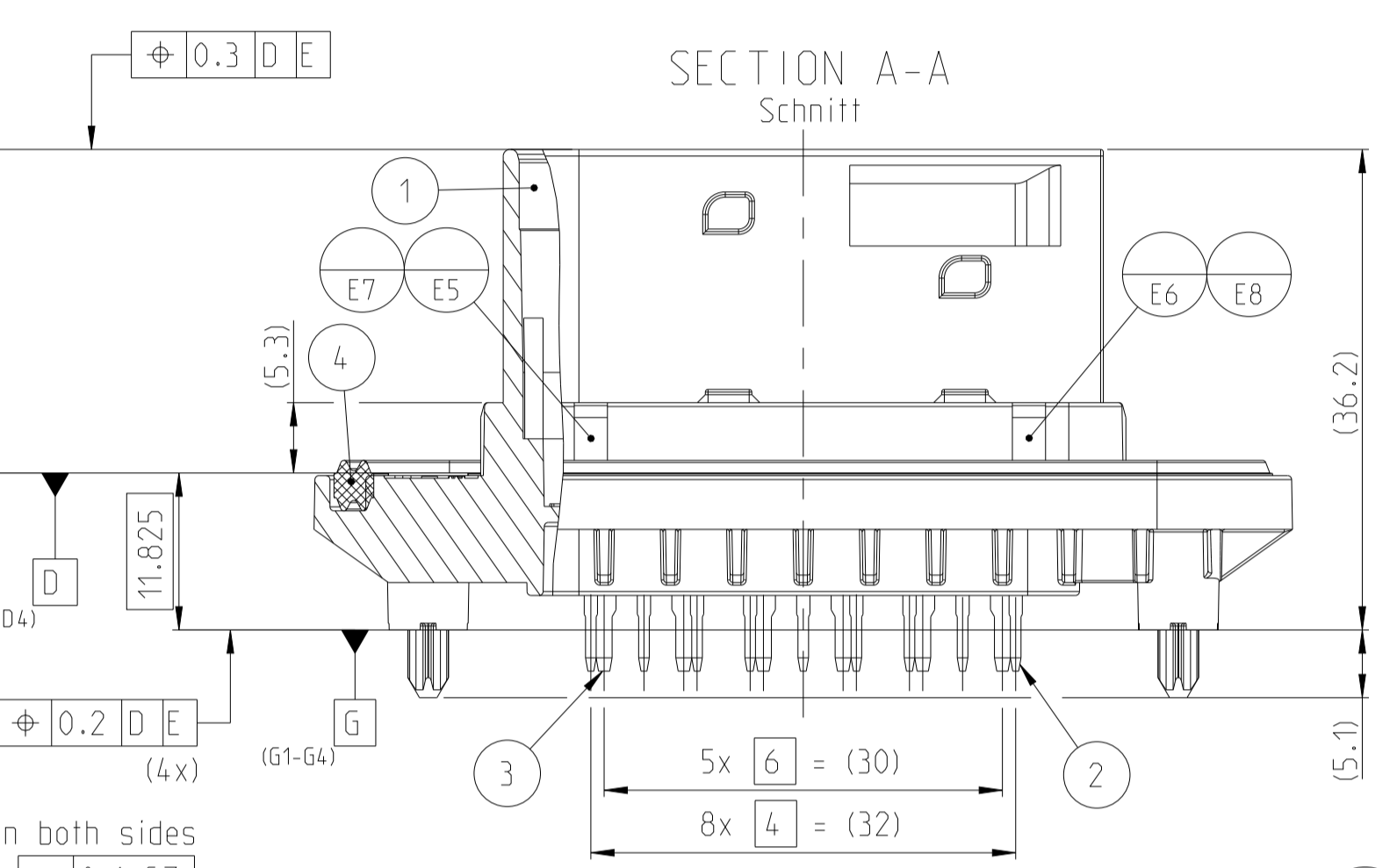
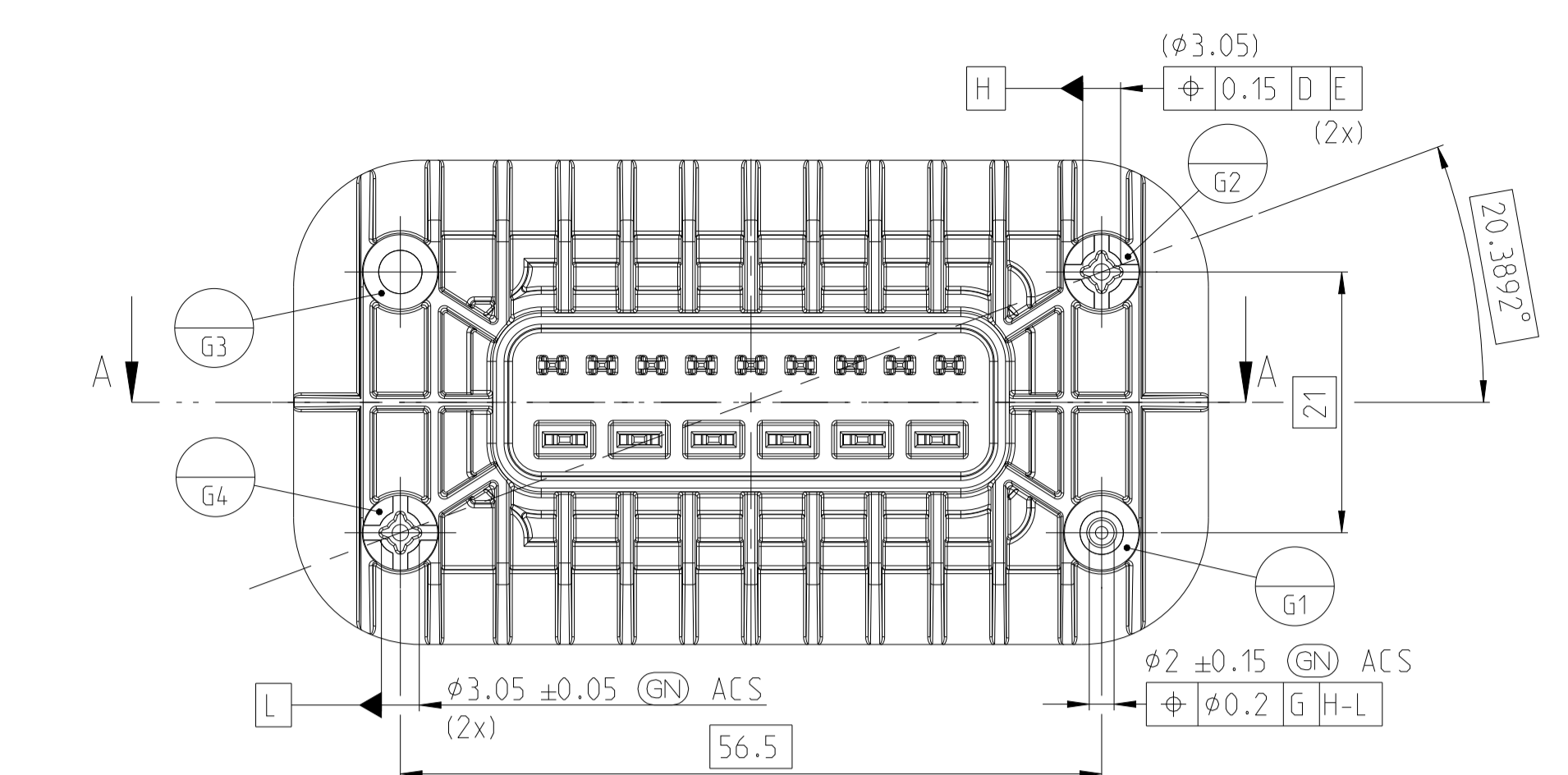
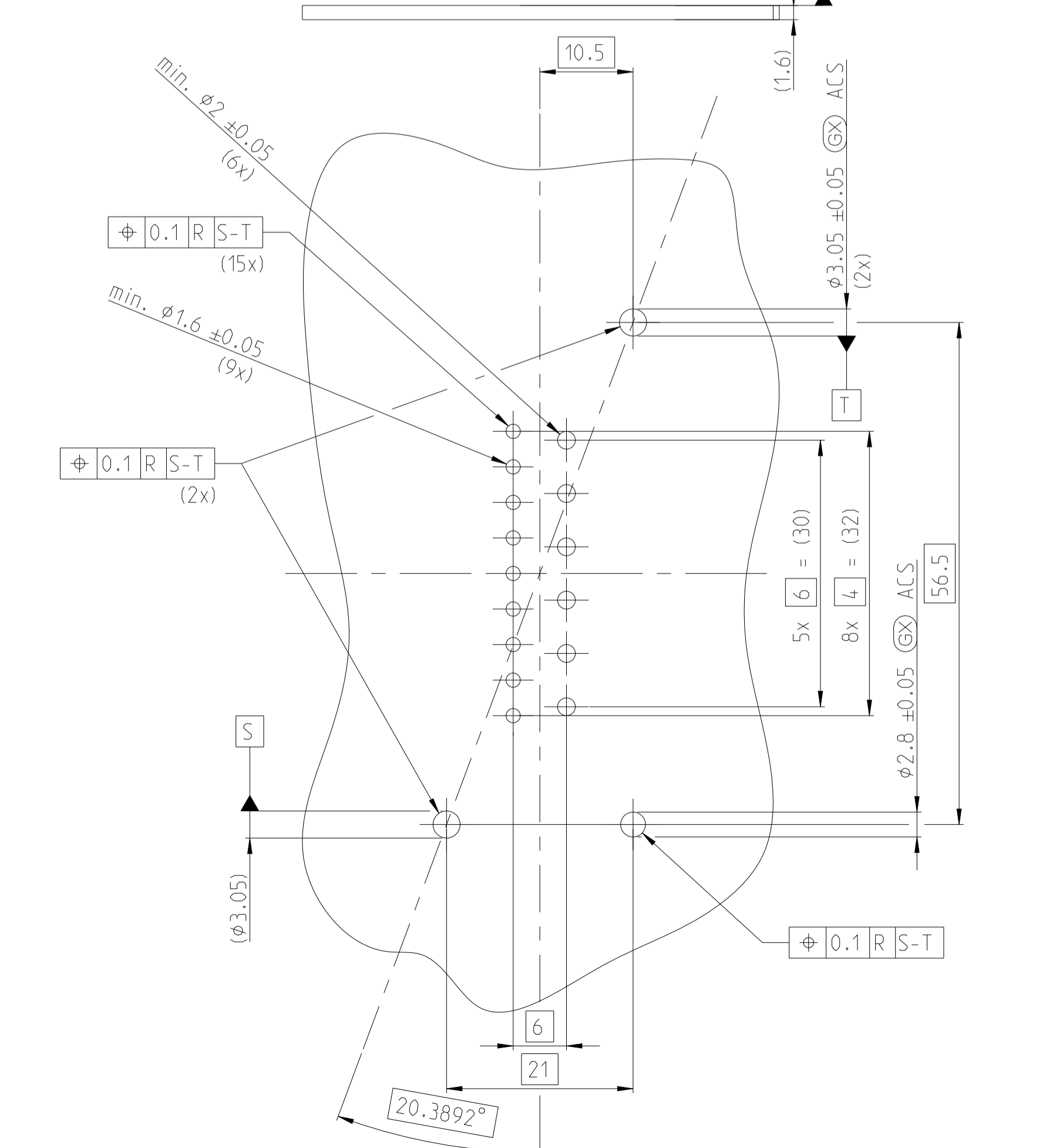

1-2378191-1 AS SHOWN
1-2378191-1 wie gezeigt

| REVISIONS | | DATE | OWN | APVD |
|-----------|-----|----------------------------------|-----------|-------|
| P | LTN | DESCRIPTION | | |
| A | | NEW DRAWING | 11DEC2020 | MK FE |
| A1 | | UPDATED VIEWS | 23FEB2021 | MK FE |
| A2 | | ADJUSTMENT OF HOUSING TOLERANCES | 28JUN2021 | MK FE |
| A3 | | ADJUSTED TO PRODUCTION PROCESS | 16NOV2022 | MK FE |

- NOTES
Bemerkungen
- TE CONNECTIVITY (TE) LOGO
TE Connectivity (TE) Logo
 - ASSY PN, ASSY REVISION, PRODUCTION DATE (CALENDER DAY/YEAR):
MARKING OPTIONAL AS LASER ENGRAVING OR LASER WITH COLOR CHANGE.
GOOD PART MARKING AFTER PASSED EOL-TEST.
Assy PN, Assy Revision, Produktionsdatum (Kalendertag/Jahr):
Beschriftung wahlweise als Lasergravur oder Laser mit Farbumschlag,
Gutteilmarkierung nach bestandenen EOL-Test.
 - CONTACT CAVITY NUMBERING
Kammernummerierung
 - DIFFERENT CODINGS
Unterschiedliche Kodierungen
 - INTERFACE ACCORDING TO TE-SPECIFICATION 114-18799-1, REV.: A6
Schnittstelle gemäß TE-Spezifikation 114-18799-1, Rev.: A6
 - SUITABLE TO COUNTERPART: TE PN 1563878
Passend zu Gegenstück: TE PN 1563878
 - HOLE FOR SELF-TAPPING SCREW EJOT DELTA PT 30
Bohrung für gewindelfurchende Schraube Ejot Delta PT 30
 - REQUIREMENTS FOR SEALING AREA ON CUSTOMER HOUSING: $\square 0.1$ Rz 6.3 μ m
Anforderungen für Dichtungsbereich am Kundengehäuse:
 - POSITION OF SEAL MUST BE CHECKED BEFORE ASSEMBLY
Vor dem Verbau ist die Dichtung auf richtigen Sitz zu überprüfen
 - MALFUNCTION CAUSED BY LACQUER IS NOT COVERED BY TE WARRANTY.
Funktionsbeeinträchtigung durch Lackieren liegt nicht im Einfluss und Gewährleistungsumfang von TE.
 - LAYOUT FOR HOUSING CAN BE USED WITH OR WITHOUT POLARISATION FEATURE
Layout fuer das Gehäuse kann mit oder ohne Polarisierungs-Feature genutzt werden
 - CLEANLESS ACCORDING TO THE TE STANDARD TECHNOLOGY
Sauberkeit nach der TE Standard Verfahrenstechnik
 - PACKED IN TRAY
Verpackt im Tray

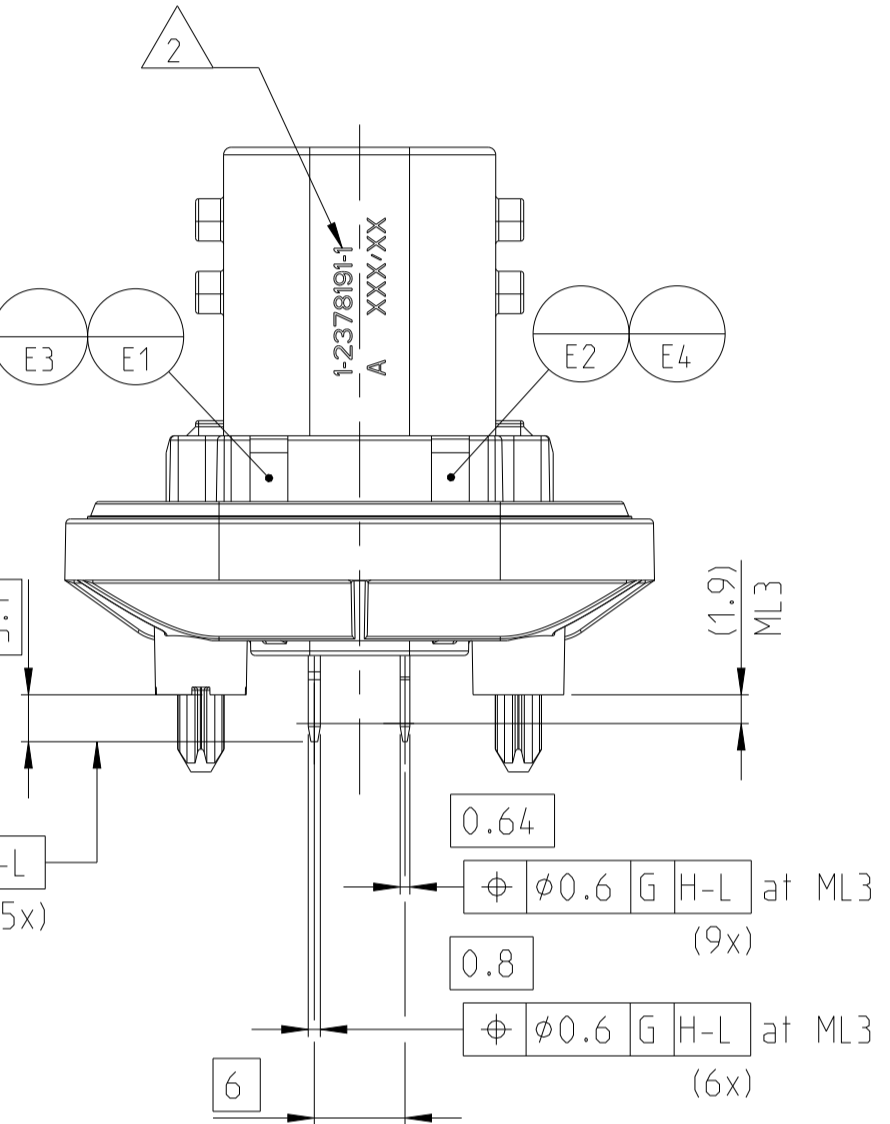

| ITEM NO | DESCRIPTION | QUANTITY | UNIT | REMARKS |
|---------|--|----------|------|---------|
| 1 | BLACK TAB HEADER, LOD, "A" | 1 | | |
| 1 | BLACK TAB HEADER, MOD, "A" | 1 | | |
| 1 | GREEN TAB HEADER, LOD, "B" | 1 | | |
| 1 | GREEN TAB HEADER, MOD, "B" | 1 | | |
| 1 | BLUE TAB HEADER, LOD, "D" | 1 | | |
| 1 | BLUE TAB HEADER, MOD, "D" | 1 | | |
| 2 | SILVER VERBÜRST 1,6mm Flachstreifen | 2 | | |
| 3 | 2,8mm TAB VERBÜRST 2,8mm Flachstreifen | 3 | | |
| 4 | AXIAL SEAL | 4 | | |

DIMENSION AND TOLERANCES ACCORDING TO:
Bemaßungen und Toleranzen gemäß:
DIN ISO 20457
DIN EN ISO 8015 (M) - DIN EN ISO 291
DIN EN ISO 11405-1/-2/-3

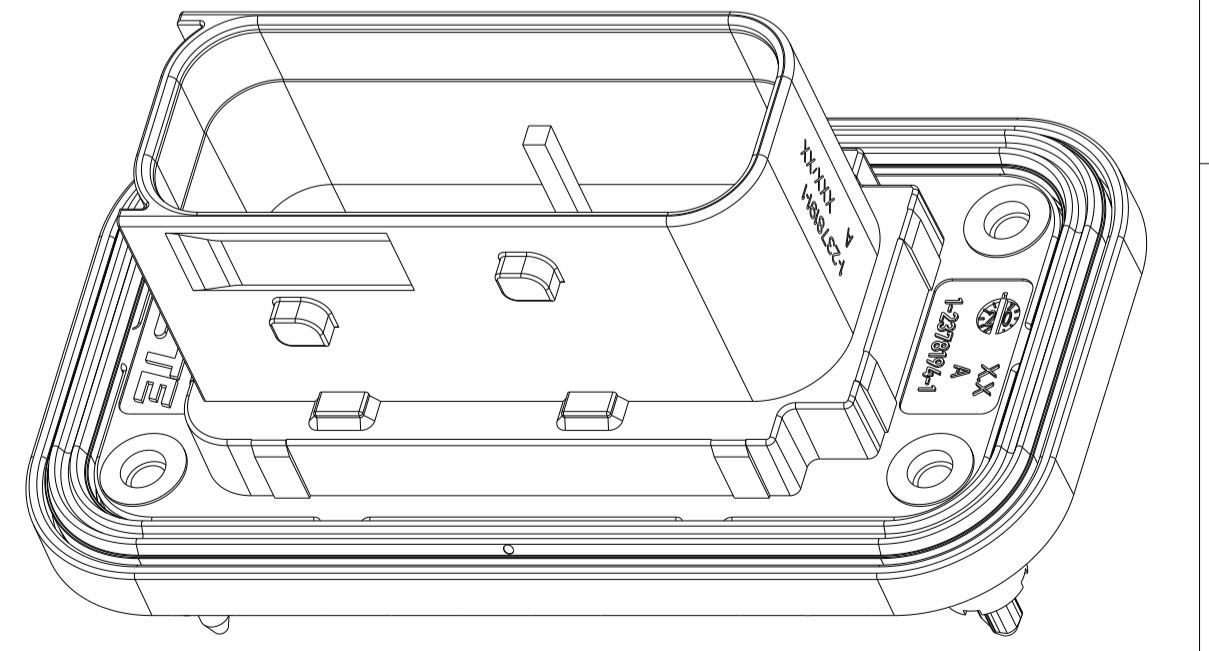

| | | | | | | | | | | | | | | | | | | | | |
|-------------|---|----|---|---|---|---|---|---|---|---|--|--|--|--|--|--|--|--|--|--|
| 4-2378191-1 | - | 15 | 0 | - | 1 | 9 | 6 | 1 | 4 | | | | | | | | | | | |
| 3-2378191-1 | - | 15 | C | - | 1 | - | 9 | 6 | 1 | 3 | | | | | | | | | | |
| 2-2378191-1 | A | 15 | B | - | 1 | - | 9 | 6 | 1 | 2 | | | | | | | | | | |
| 1-2378191-1 | A | 15 | A | 1 | - | - | 9 | 6 | 1 | 1 | | | | | | | | | | |

TE ORDER-NO. REV. NO. OF POS. CODE QUANTITY ITEM NO.
TE Bestell-Nr. Polzahl Kodierung Stück Assy

MATERIAL: SEE TABLE
DIMENSIONS: SEE TABLE
TOLERANCES UNLESS OTHERWISE SPECIFIED: SEE TABLE
DIMENSIONS: SEE TABLE
TOLERANCES UNLESS OTHERWISE SPECIFIED: SEE TABLE

DRAWING NO. 09DEC2020
DRAWING NO. 11DEC2020
DRAWING NO. 23FEB2021
DRAWING NO. 28JUN2021
DRAWING NO. 16NOV2022

OWN: M. Kilian
CHK: J. Hoffmann
APVD: F. Elfröd

NAME: 15POS. HYBRID, HDR ASSY, 180DEG
15pol. gemischt, Stiftwanne, 180 Grad
Heavy Duty Sealed Connector Series

SIZE: 114-94654
CAGE CODE: 07779
DRAWING NO.: 2378191

RESTRICTED TO: NUR FÜR: -

CUSTOMER DRAWING /KUNDENZEICHNUNG SCALE MASSSTAB 2:1 SHEET BLATT 1 OF 1 REV. A.3