

REVISIONS					
P	LTM	DESCRIPTION	DATE	DWN	APVD
A		RELEASED PER ECO-19-011704	22JUL2019	KF	NE
A1		REVISED PER ECO-20-010646	31JUL2020	CN	AC
A2		REVISED PER ECO-21-001765	08FEB2021	CN	AC
A3		REVISED PER ECN-21-128686	01DEC2021	CN	AC

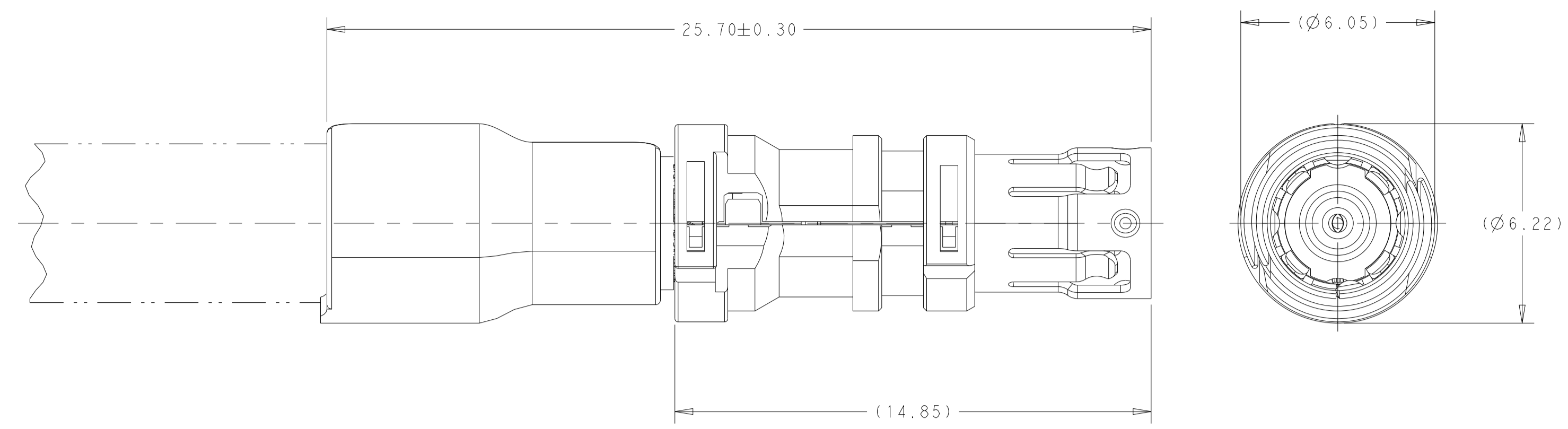

ASSEMBLED VIEWS

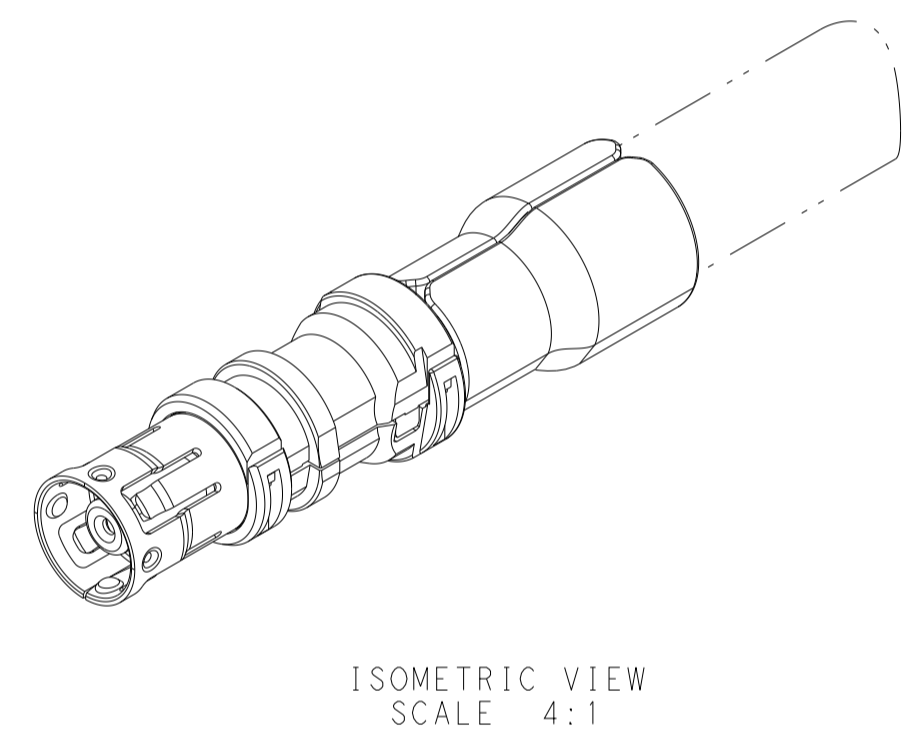
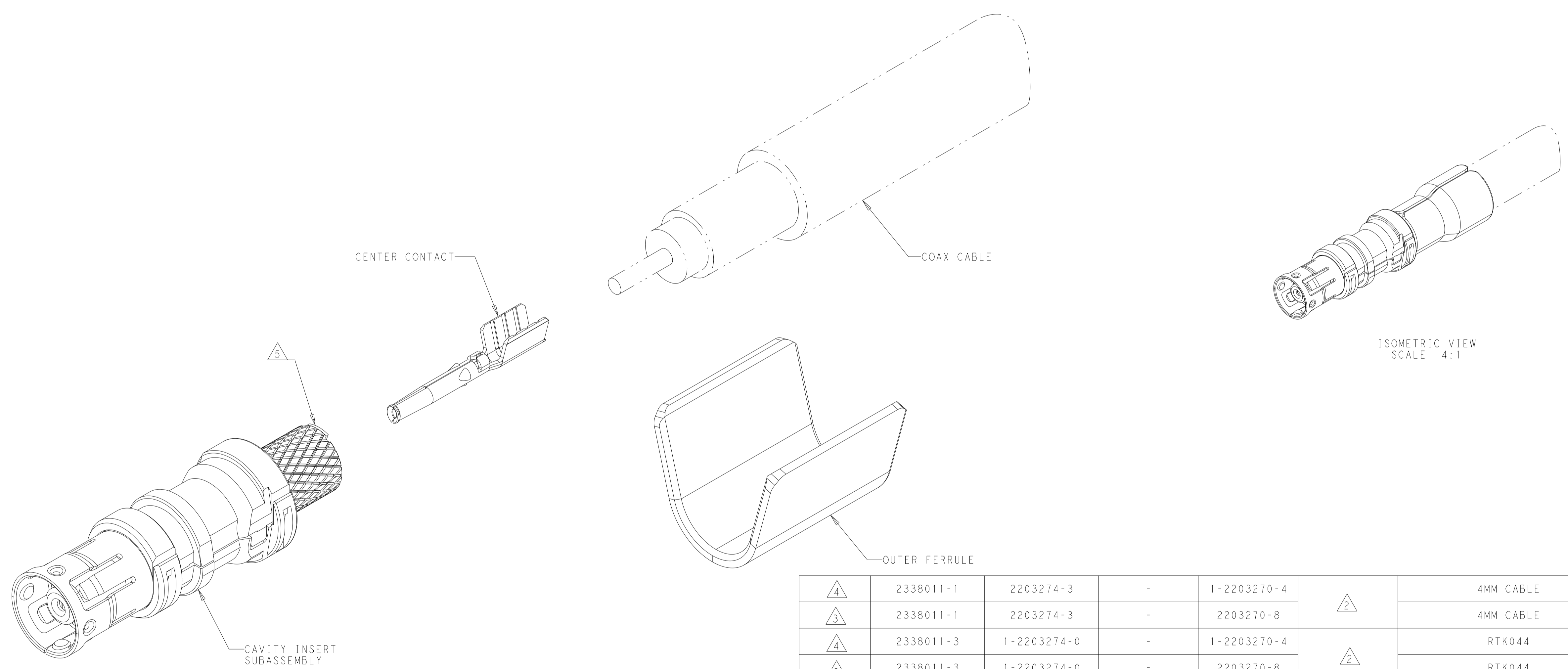
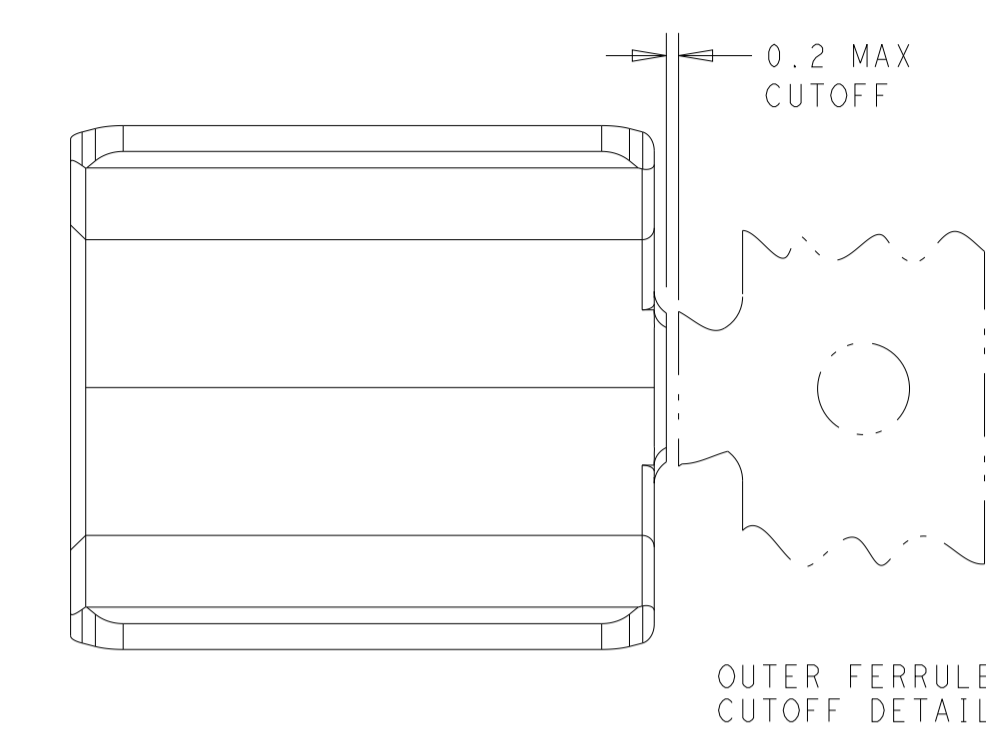
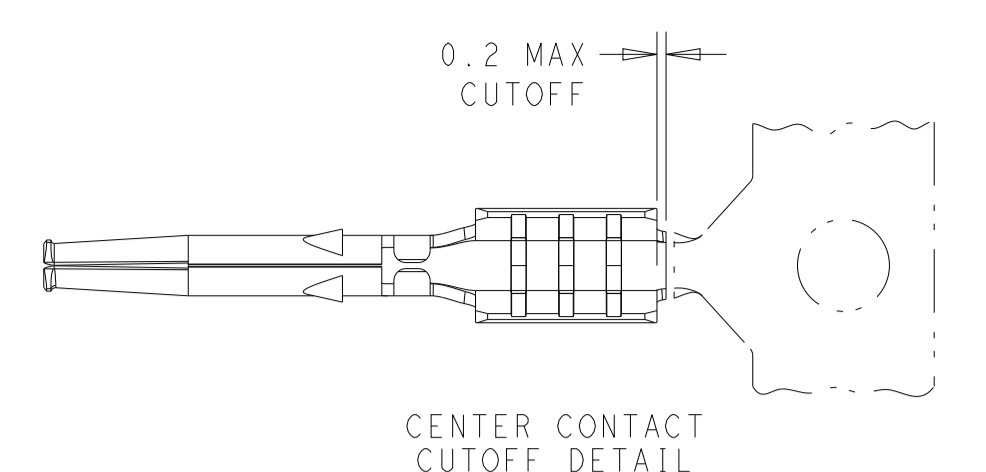

1. 2344361-1 AS SHOWN.
2. COAX CABLE NOT INCLUDED.
 CENTER CONTACT - PHOSPHOR BRONZE
 CAVITY INSERT SUBASSEMBLY - PHOSPHOR BRONZE, NYLON, AND POLYESTER PBT.
 OUTER FERRULE - COPPER ALLOY.
3. CENTER CONTACT - 0.38µm MIN GOLD ON INTERFACE END,
 2.5µm MIN TIN ON CRIMP END, BOTH OVER 1.5µm MIN NICKEL.
 CAVITY INSERT SUBASSEMBLY - METAL PORTION PREPLATED 1.0µm MIN TIN.
 OUTER FERRULE - PREPLATED 1.0µm MIN TIN.
4. CENTER CONTACT - 0.80µm MIN GOLD ON INTERFACE END,
 2.5µm MIN TIN ON CRIMP END, BOTH OVER 1.27µm MIN NICKEL.
 CAVITY INSERT SUBASSEMBLY - METAL PORTION PREPLATED 1.0µm MIN TIN.
 OUTER FERRULE - PREPLATED 1.0µm MIN TIN.
5. CAVITY INSERT SUBASSEMBLY, TO BE CUTOFF AT ASSEMBLY;
 [0.15 MAX CUTOFF STUB]
6. COMPONENTS DELIVERED ON METAL CARRIER STRIP.

FINISH	OUTER FERRULE QTY=1	CAVITY INSERT SUBASSEMBLY QTY=1	ALTERNATE CENTER CONTACT QTY=1	PRIMARY CENTER CONTACT QTY=1	COAX CABLE QTY=AR	APPLICABLE CABLE SIZE	PART NUMBER
4	2338011-1	2203274-3	-	1-2203270-4	2	4MM CABLE	1-2344361-4
3	2338011-1	2203274-3	-	2203270-8	2	4MM CABLE	2344361-4
4	2338011-3	1-2203274-0	-	1-2203270-4	2	RTK044	1-2344361-3
3	2338011-3	1-2203274-0	-	2203270-8	2	RTK044	2344361-3
4	2338011-2	2203274-3	-	1-2203270-4	2	RTK031	1-2344361-2
3	2338011-2	2203274-3	-	2203270-8	2	RTK031	2344361-2
4	2338011-1	2203274-1	3-2203270-2	1-2203270-5	2	RG-58LL	1-2344361-1
3	2338011-1	2203274-1	-	1-2203270-9	2	RG-58LL	2344361-1

THIS DRAWING IS A CONTROLLED DOCUMENT. DWN: H. FOLTZ 16OCT2018
 CHK: N. EVANS 18OCT2018
 APVD: N. EVANS 18OCT2018

DIMENSIONS: mm
 TOLERANCES UNLESS OTHERWISE SPECIFIED:
 0 PLC ±
 1 PLC ±0.25
 2 PLC ±
 3 PLC ±
 4 PLC ±
 ANGLES ±

MATERIAL: SEE TABLE
 FINISH: SEE TABLE

NAME: TERMINAL, UNASSEMBLED, FEMALE, 180 DEGREE, FAKRA
 SIZE: A1
 CAGE CODE: -
 DRAWING NO: 114-32145
 WEIGHT: -
 CUSTOMER DRAWING

TE Connectivity
 SCALE: 8:1
 SHEET 1 OF 2
 REV: A3

REVISIONS					
P	LTN	DESCRIPTION	DATE	OWN	APVD
-		SEE SHEET 1	-	-	-

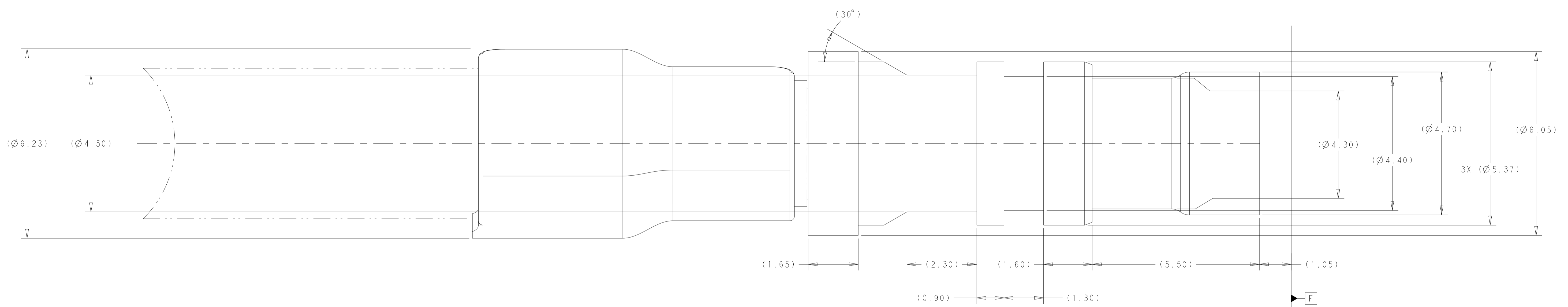

SCALE 15:1

2344361-1 AS SHOWN
 (SIMPLIFIED REPRESENTATION SHOWN FOR REFERENCE ONLY)

THIS DRAWING IS A CONTROLLED DOCUMENT.		OWN K. FOLTZ 16OCT2018	TE Connectivity															
DIMENSIONS:		CHK N. EVANS 18OCT2018																
mm	TOLERANCES UNLESS OTHERWISE SPECIFIED:	APVD N. EVANS 18OCT2018	NAME TERMINAL, UNASSEMBLED, FEMALE, 180 DEGREE, FAKRA															
<table border="1"> <tr><td>0 PLC</td><td>±</td></tr> <tr><td>1 PLC</td><td>±</td></tr> <tr><td>2 PLC</td><td>±0.25</td></tr> <tr><td>3 PLC</td><td>±</td></tr> <tr><td>4 PLC</td><td>±</td></tr> <tr><td>ANGLES</td><td>±</td></tr> <tr><td>FINISH</td><td>±</td></tr> </table>	0 PLC	±	1 PLC	±	2 PLC	±0.25	3 PLC	±	4 PLC	±	ANGLES	±	FINISH	±	SEE TABLE	PRODUCT SPEC 108-32137	APPLICATION SPEC 114-32145	RESTRICTED TO
0 PLC	±																	
1 PLC	±																	
2 PLC	±0.25																	
3 PLC	±																	
4 PLC	±																	
ANGLES	±																	
FINISH	±																	
MATERIAL		WEIGHT	SIZE A1	CAGE CODE -														
		CUSTOMER DRAWING	DRAWING NO 2344361	SCALE 8:1														
			SHEET 2	OF 2														
			REV A3															