

P	LTR	DESCRIPTION	DATE	DWN	APVD
	A	RELEASED	05MAR2019	T.G	N.Y
	B	REVISED(ECR-21-116260)	05OCT2021	E.S	N.Y

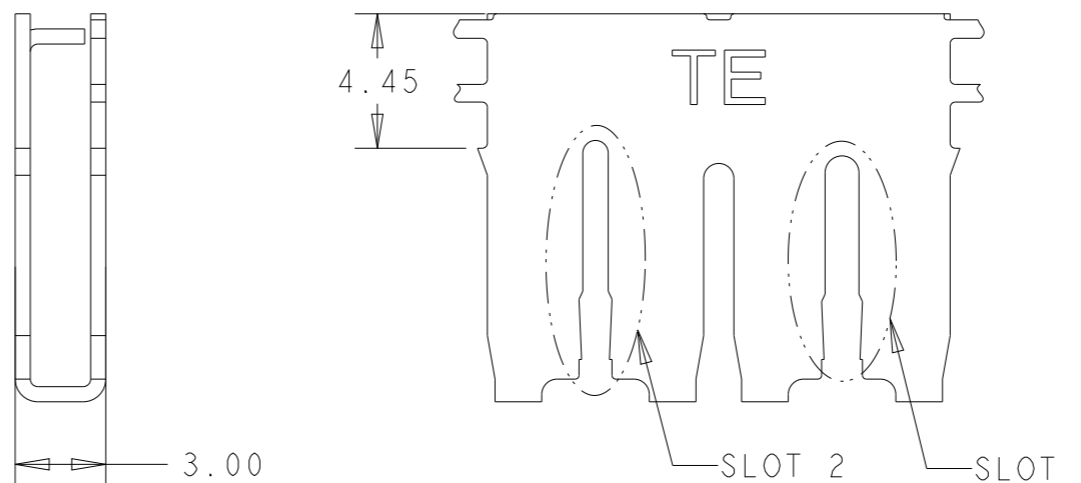
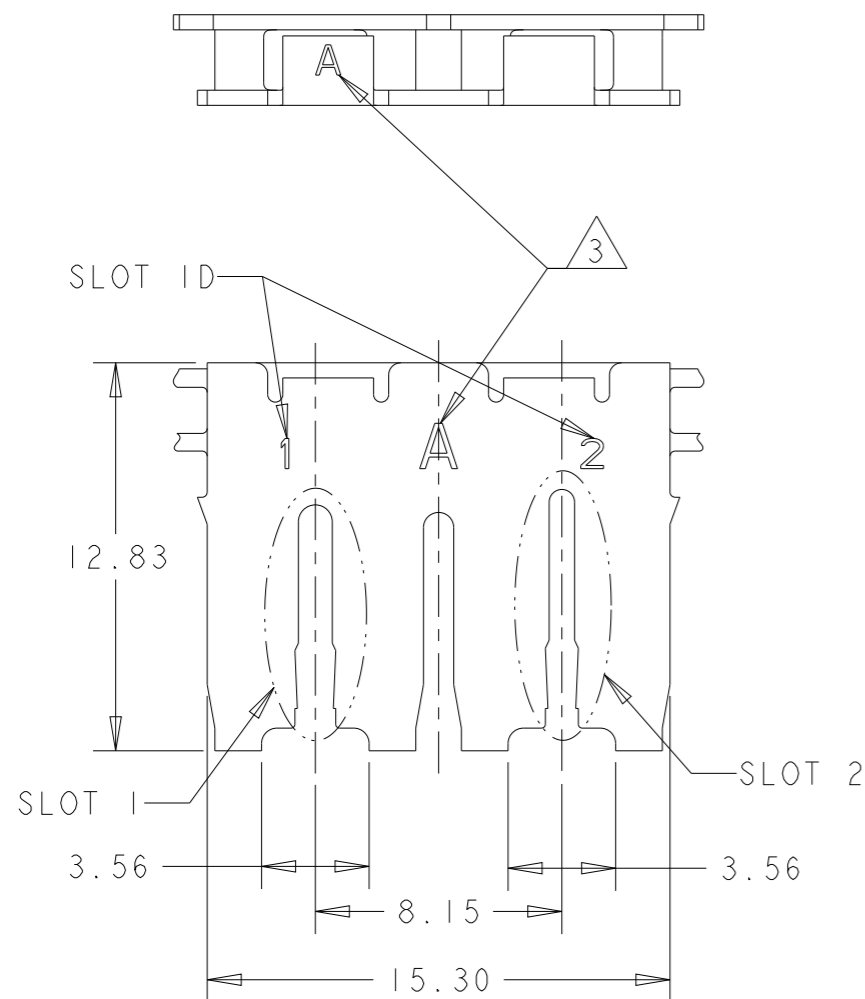

- 1. CONTINUOUS STRIP ON REELS WITH TERMINALS LOCATED ON 16.9 ± 0.05 mm CENTERS.
- 2. SLOT 1 AND 2 ACCEPTS SINGLE COPPER MAGNET WIRE ONLY.
- 3 ID MARK OF SLOT SIZE: SEE TABLE 1.
- 4 RECOMMEND TO EVALUATE THE WIRE IN CASE OF USING NEW WIRE.
- 5 MATERIAL: PHOSPHOR BRONZE
FINISH: TIN PLATE

TABLE 1

C	$\Phi 1.90 \sim \Phi 2.2$	AWG12 ($\Phi 2.03 \sim \Phi 2.05$)	1-2335804-3
B	$\Phi 1.54 \sim \Phi 1.83$	AWG14	1-2335804-2
A	$\Phi 1.09 \sim \Phi 1.30$	($\Phi 1.54 \sim \Phi 1.83$)	1-2335804-1
D	$\Phi 0.8 \sim \Phi 1.0$		1-2335804-7
ID MARK 3	4 SLOT 2 WIRE RANGE	4 SLOT 1 WIRE RANGE	PART No.

THIS DRAWING IS A CONTROLLED DOCUMENT.		DWN T.GOTO 24APR2018	TE Connectivity	
DIMENSIONS: mm		CHK N.YAMASAKI 24APR2018		
TOLERANCES UNLESS OTHERWISE SPECIFIED: ± 0.3		APVD N.YAMASAKI 24APR2018	NAME TERMINAL, 2SLOT-TYPE 5SERIES, MAGTERM I	
0 PLC \pm 1 PLC ± 0.5 2 PLC ± 0.13 3 PLC ± 0.013 4 PLC ± 0.0001 ANGLES \pm		PRODUCT SPEC 108-140195	SIZE A3	
MATERIAL 5		FINISH 5	APPLICATION SPEC 114-78035	CAGE CODE 00779
		WEIGHT 1.54g	DRAWING NO C-2335804	RESTRICTED TO -
CUSTOMER DRAWING			SCALE 4:1	SHEET 1 OF 1
			REV B	