

REVISIONS				
P.	LTN.	DESCRIPTION	DATE	APVD.
B		RELEASED PER ECO-20-010207	29JUN2020	JM OD

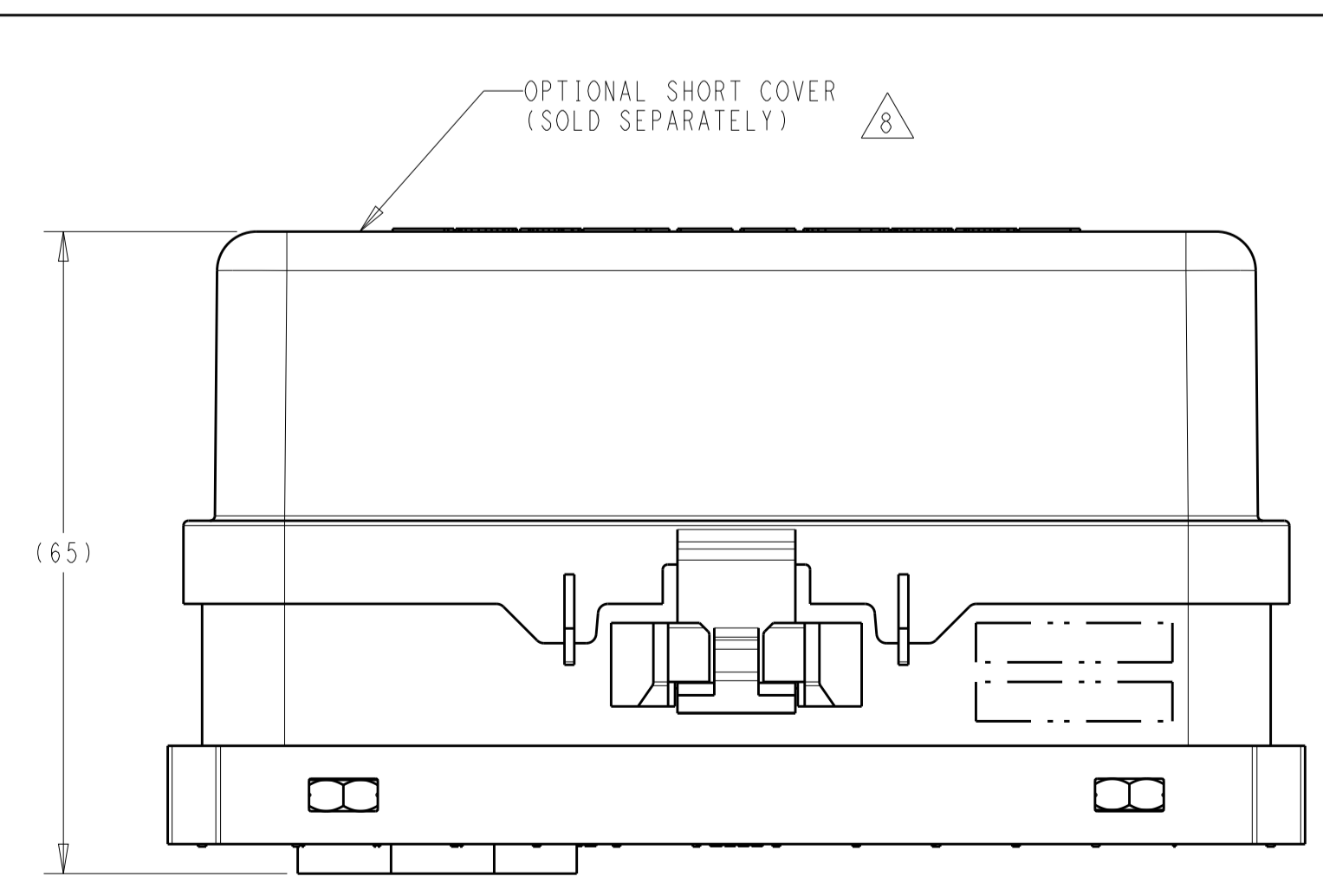
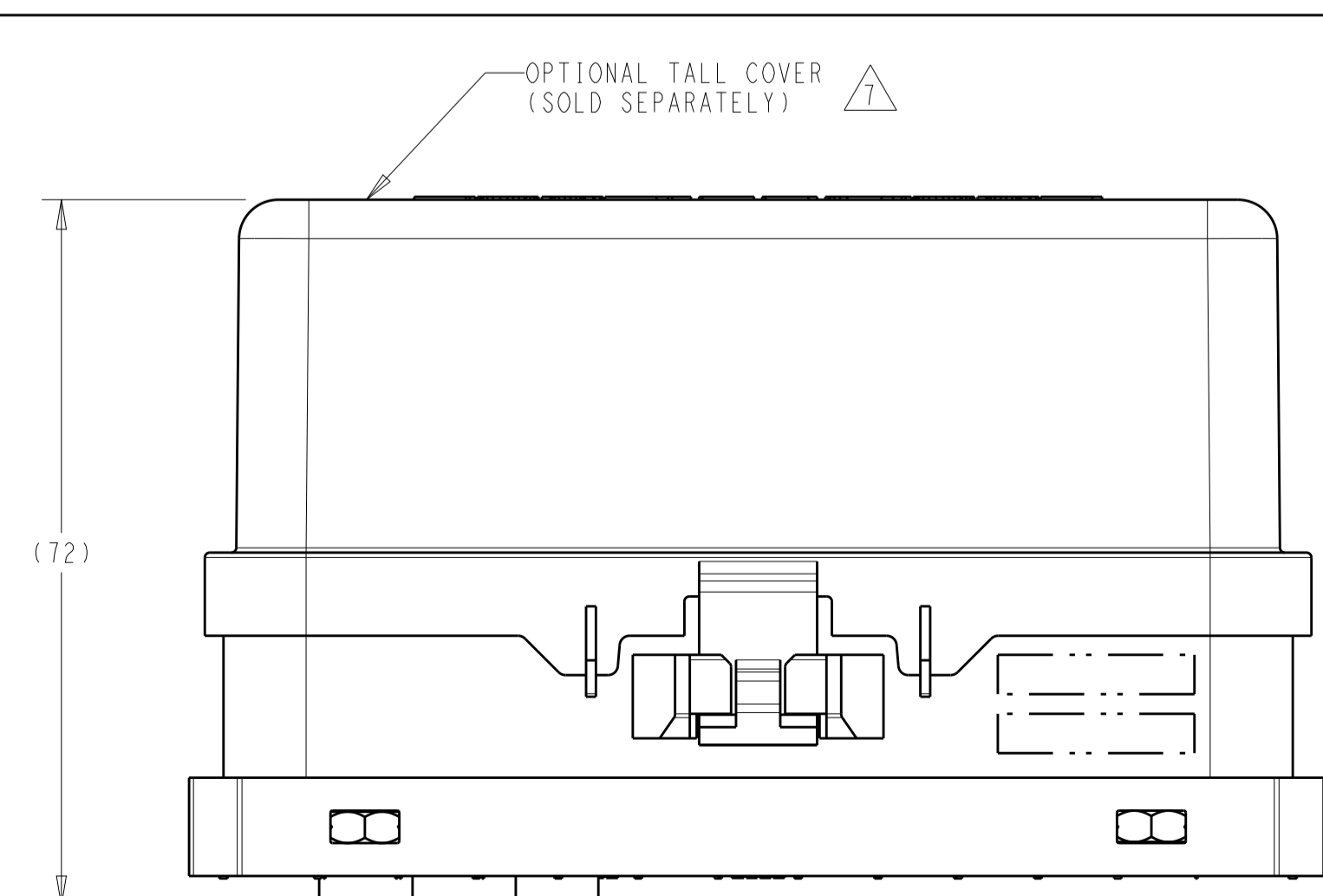
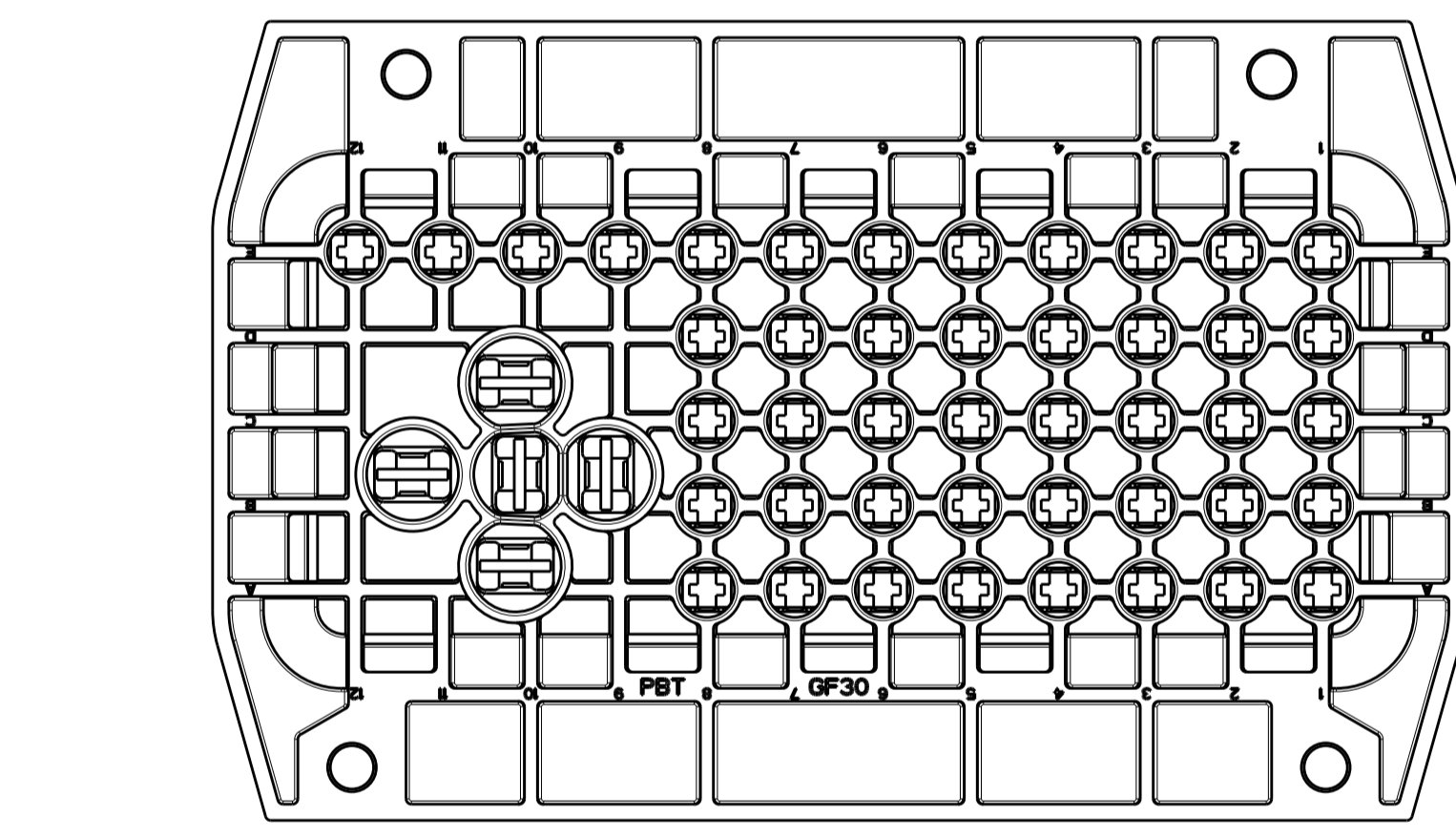
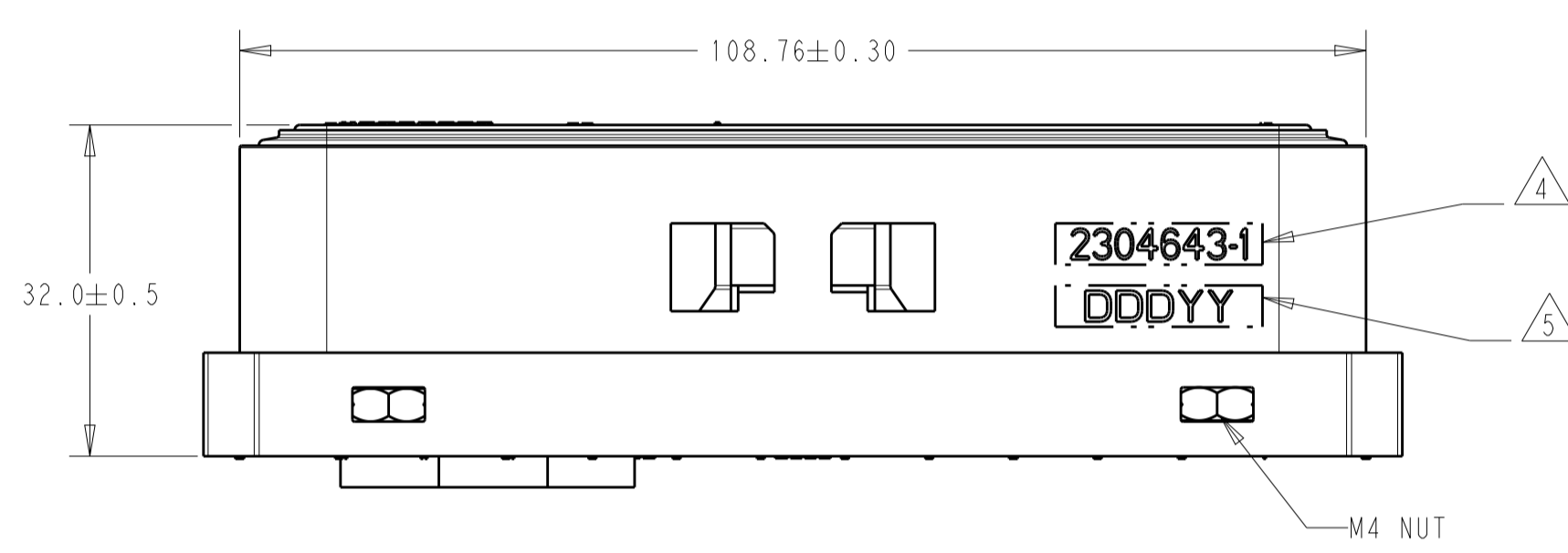
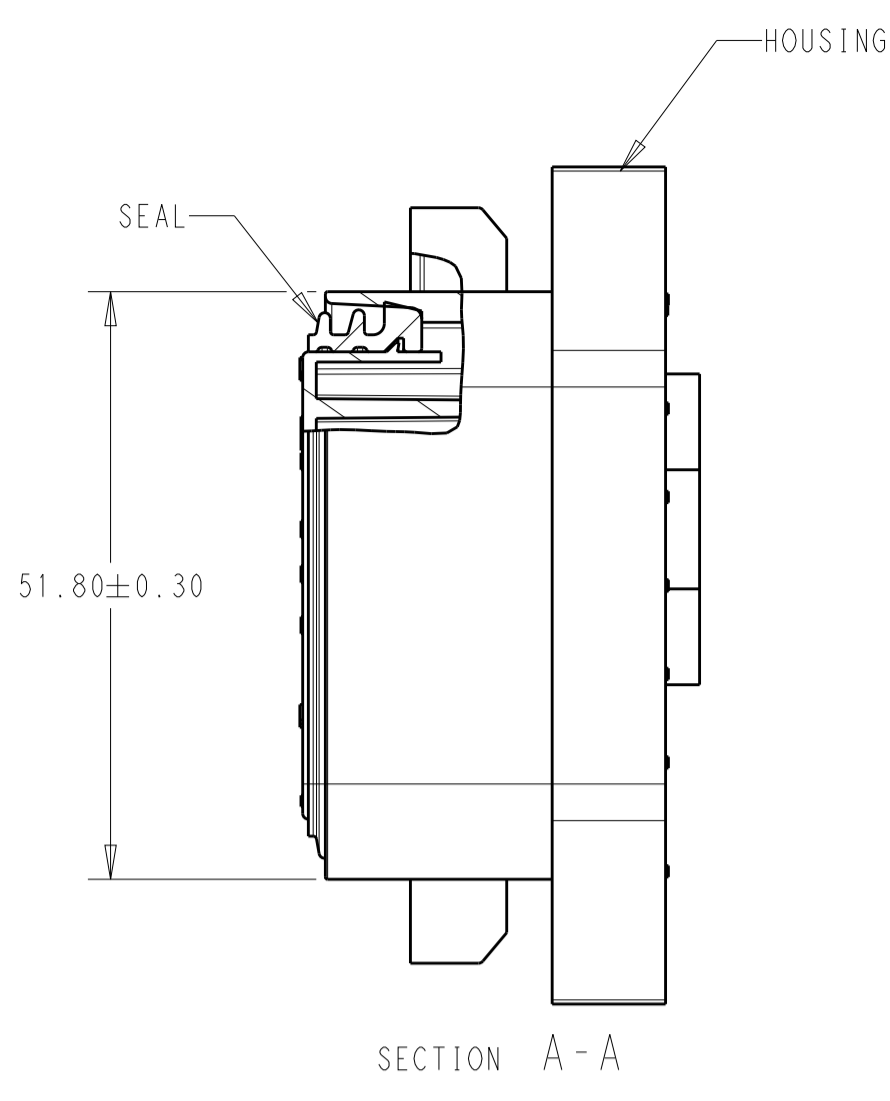
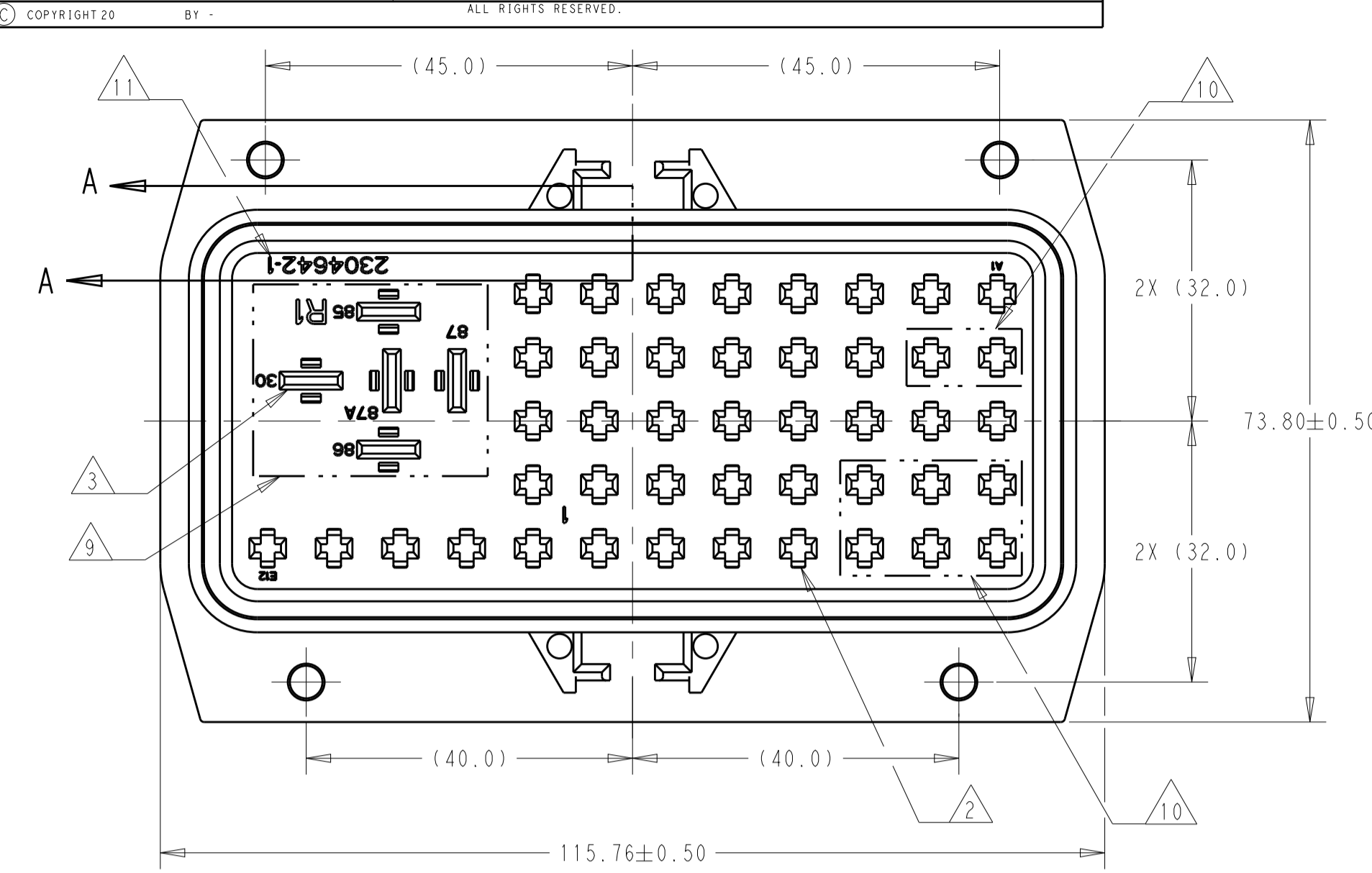

VIEW SHOWN FOR REFERENCE ONLY

VIEW SHOWN FOR REFERENCE ONLY

- 1 MATERIAL:
HOUSING: PBT GF30, COLOR: BLACK
SEAL: SILICONE, COLOR: BLUE
M4 NUTS: CARBON STEEL, FINISH: ZINC W/CLEAR CHROMATE (III)
- 2 CIRCUIT CAVITIES USE AMP MCP 2.8 RECEPTACLE TERMINALS SEE CUSTOMER DRAWING 1355036 FOR TERMINAL SELECTION. RECOMMENDED WIRE INSULATION RANGE 1.2-3.0 mm.
- 3 CIRCUIT CAVITIES USE AMP MCP 6.3 RECEPTACLE TERMINALS. SEE CUSTOMER DRAWING 1241438 FOR TERMINAL SELECTION. RECOMMENDED WIRE INSULATION RANGE 1.4-4.5 mm.
- 4 TE ASSEMBLY PART NUMBER MARKED IN APPROXIMATE AREA SHOWN.
- 5 DATE CODE IN DDYY FORMAT MARKED IN APPROXIMATE AREA SHOWN.
- 6. RECOMMENDED SCREW IS M4 X 0.7 mm WITH MINIMUM THREAD LENGTH OF 10 mm. RECOMMENDED TORQUE RANGE 1.7-2.15 Nm.
- 7 FOR OPTIONAL TALL COVER, SEE CUSTOMER DRAWING 2098164.
- 8 FOR OPTIONAL SHORT COVER, SEE CUSTOMER DRAWING 1443996.
- 9 CIRCUIT PATTERN ACCEPTS ISO MINI RELAYS PER ISO 7588-1.
- 10 CIRCUIT PATTERN ACCEPTS BLADE TYPE FUSES PER ISO 8820-3 OR ISO 280 MICRO RELAYS PER ISO 7588-3 OR MINI CIRCUIT BREAKERS PER SAE J553.
- 11 TE HOUSING PART NUMBER SHOWN FOR REFERENCE ONLY, SEE TABLE BELOW FOR CORRESPONDING TE ASSEMBLY NUMBER.

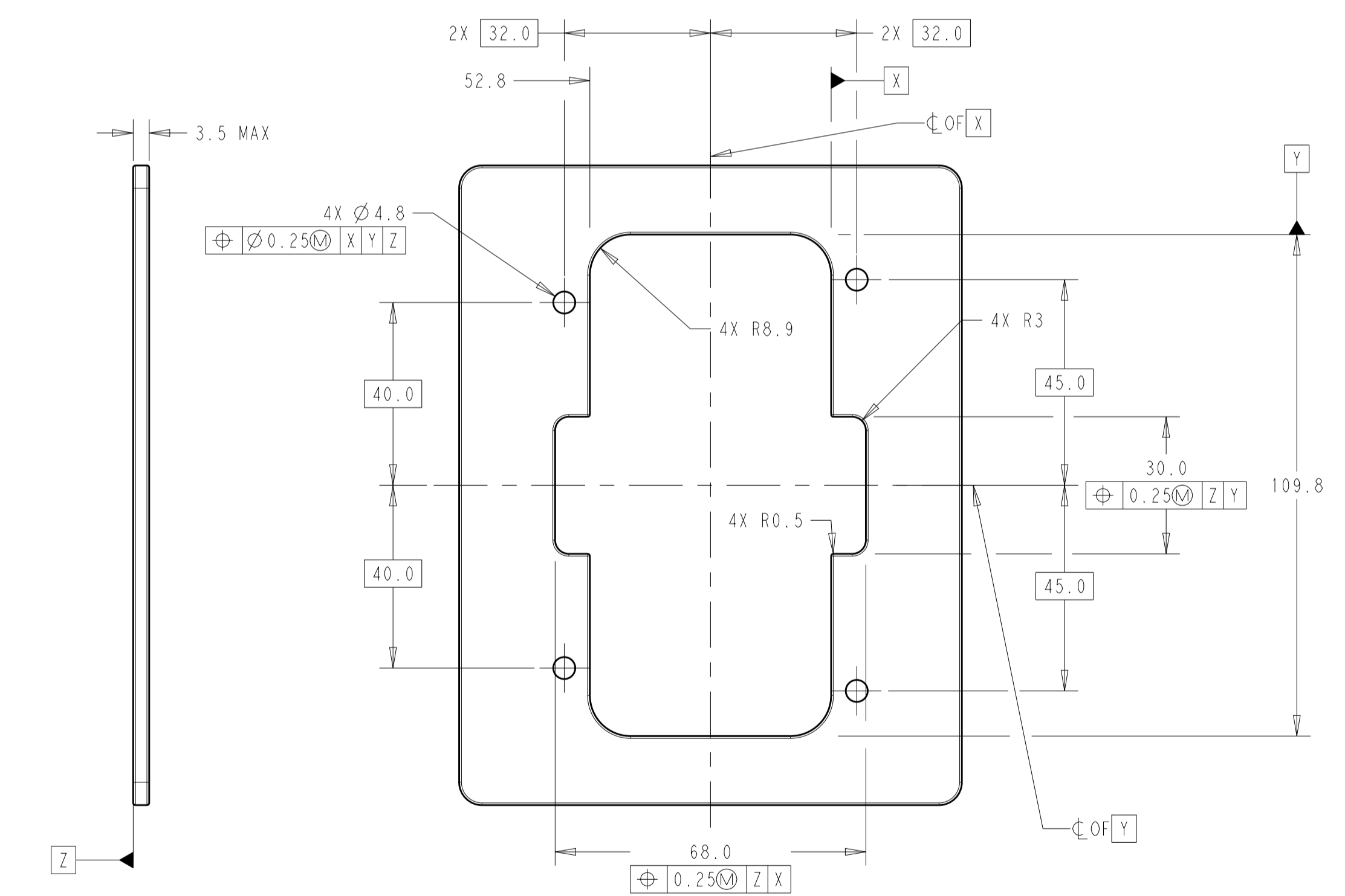

RECOMMENDED PANEL CUTOUT
SCALE 1:1

CIRCUITS	DESCRIPTION	PART NO
(60) AMP MCP 2.8	60 POS, AMP MCP 2.8, REC HSG ASSY, SEALED	2304643-4
(12) AMP MCP 2.8 / (15) AMP MCP 6.3	27 POS, HYBRID, REC HSG ASSY, SEALED	2304643-3
(28) AMP MCP 2.8 / (10) AMP MCP 6.3	38 POS, HYBRID, REC HSG ASSY, SEALED	2304643-2
(44) AMP MCP 2.8 / (5) AMP MCP 6.3	49 POS, HYBRID, REC HSG ASSY, SEALED	2304643-1

THIS DRAWING IS A CONTROLLED DOCUMENT.		CHK D. STRAUSSER	11JUL2016	TE Connectivity
DIMENSIONS:		APVD O. DONKERVOORT	24SEP2019	
mm	TOLERANCES UNLESS OTHERWISE SPECIFIED:	PRODUCT SPEC		NAME FUSE AND RELAY BOX, FLANGED
0 PLC	±0.5	APPLICATION SPEC		SIZE A1
1 PLC	±0.2	108-151059		CAGE CODE -
2 PLC	±	114-151059		DRAWING NO C=2304643
3 PLC	±	WEIGHT		RESTRICTED TO
4 PLC	±	CUSTOMER DRAWING		SCALE 3:2
ANGLES	±	SHEET 1 OF 2		REV B

REVISIONS				
P.	LTN.	DESCRIPTION	DATE	APVD.
-	-	SEE SHEET 1	-	-

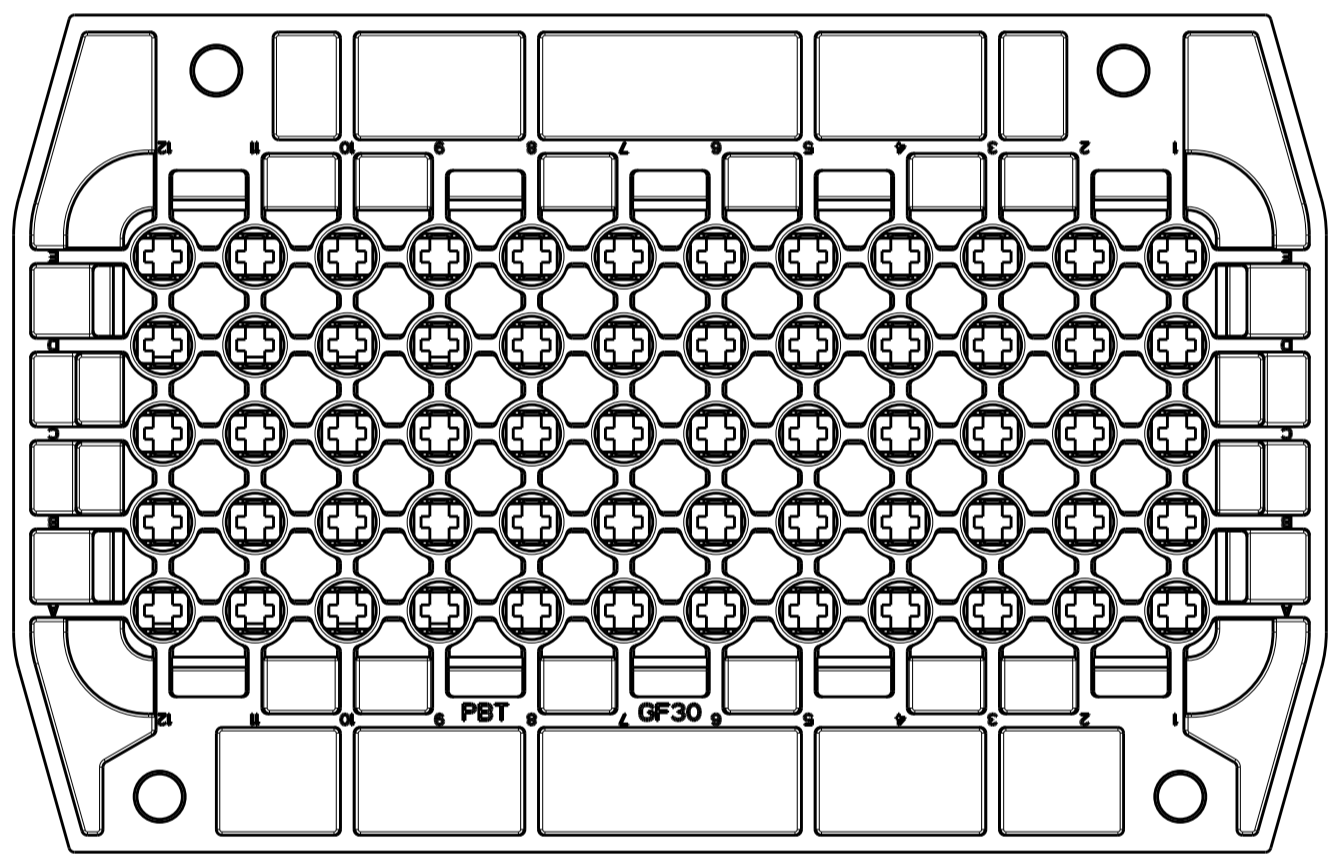
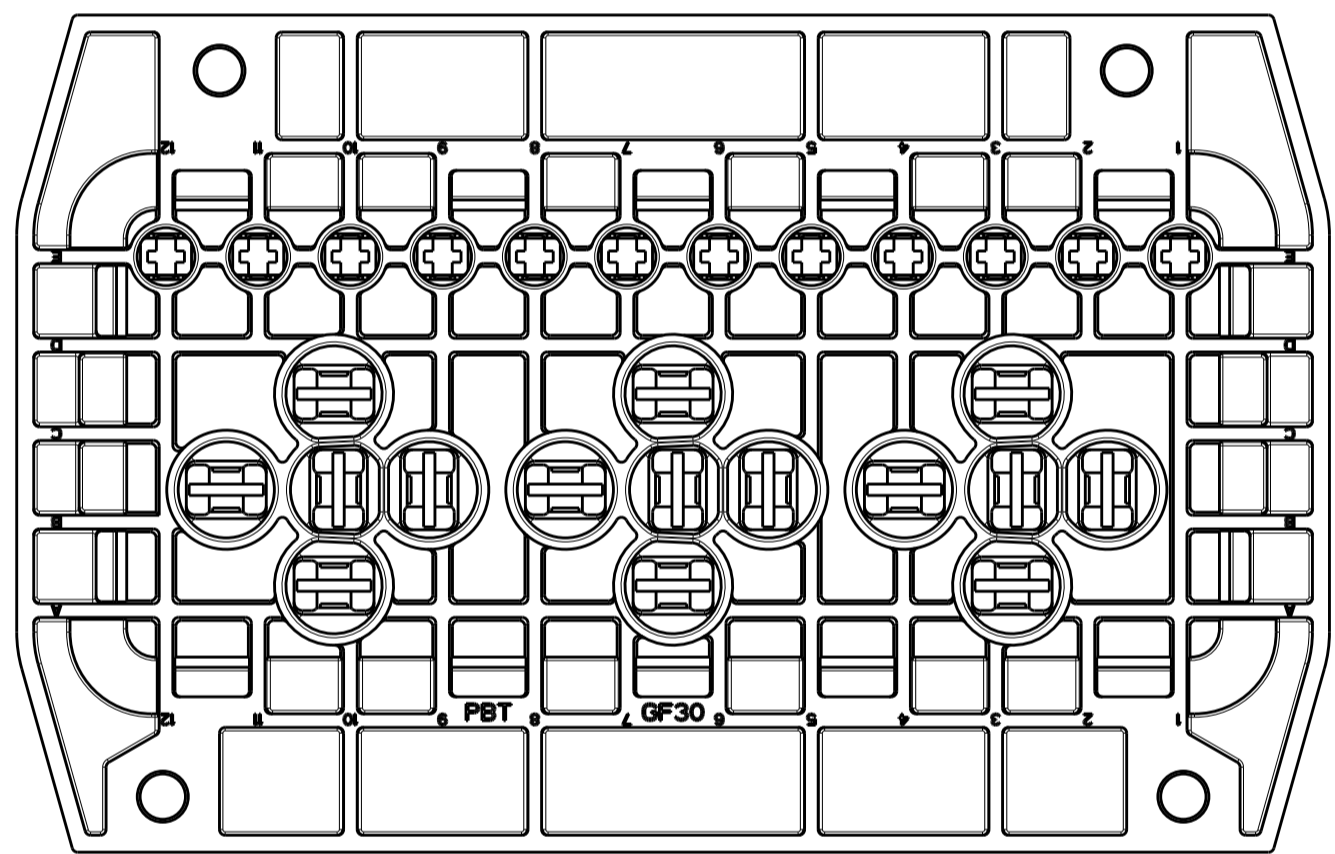
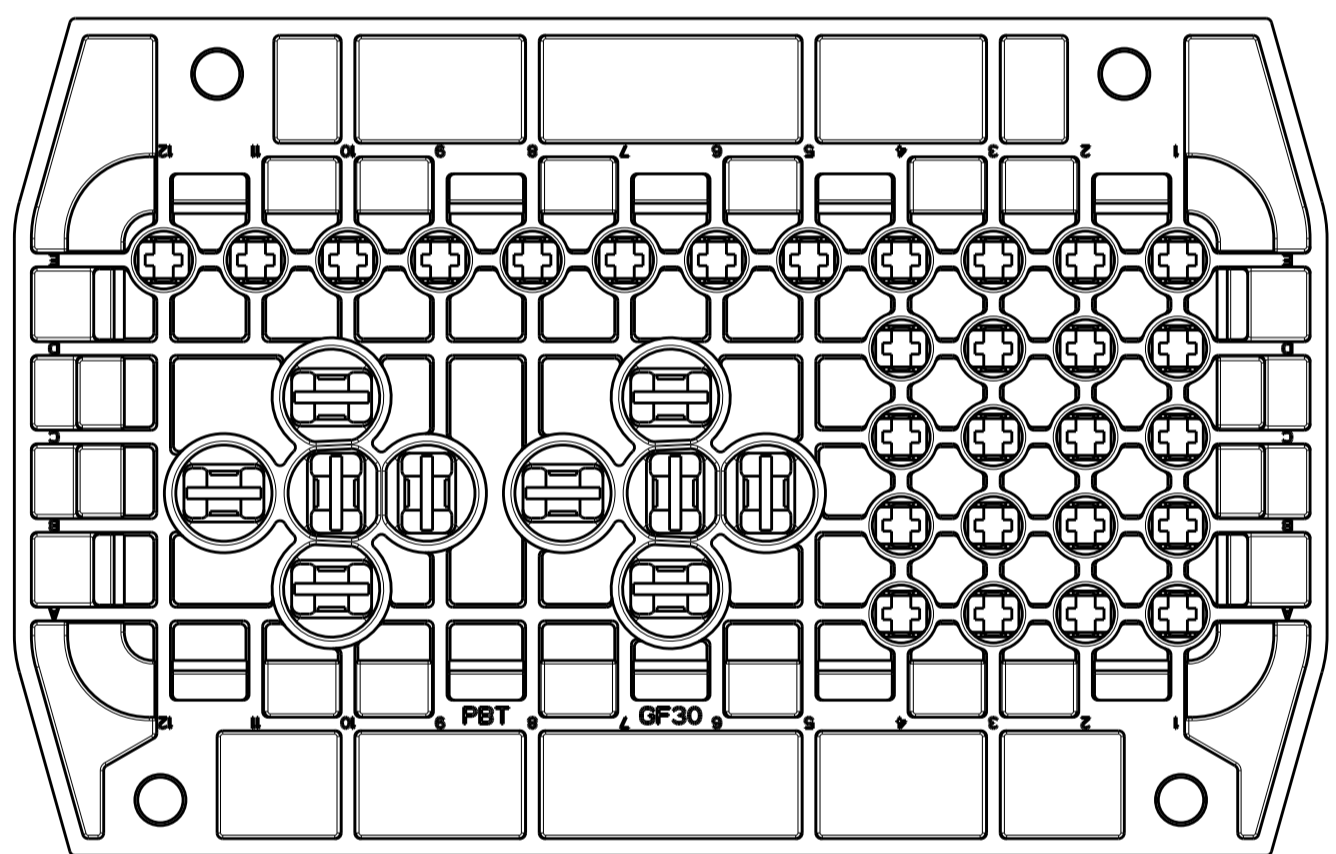
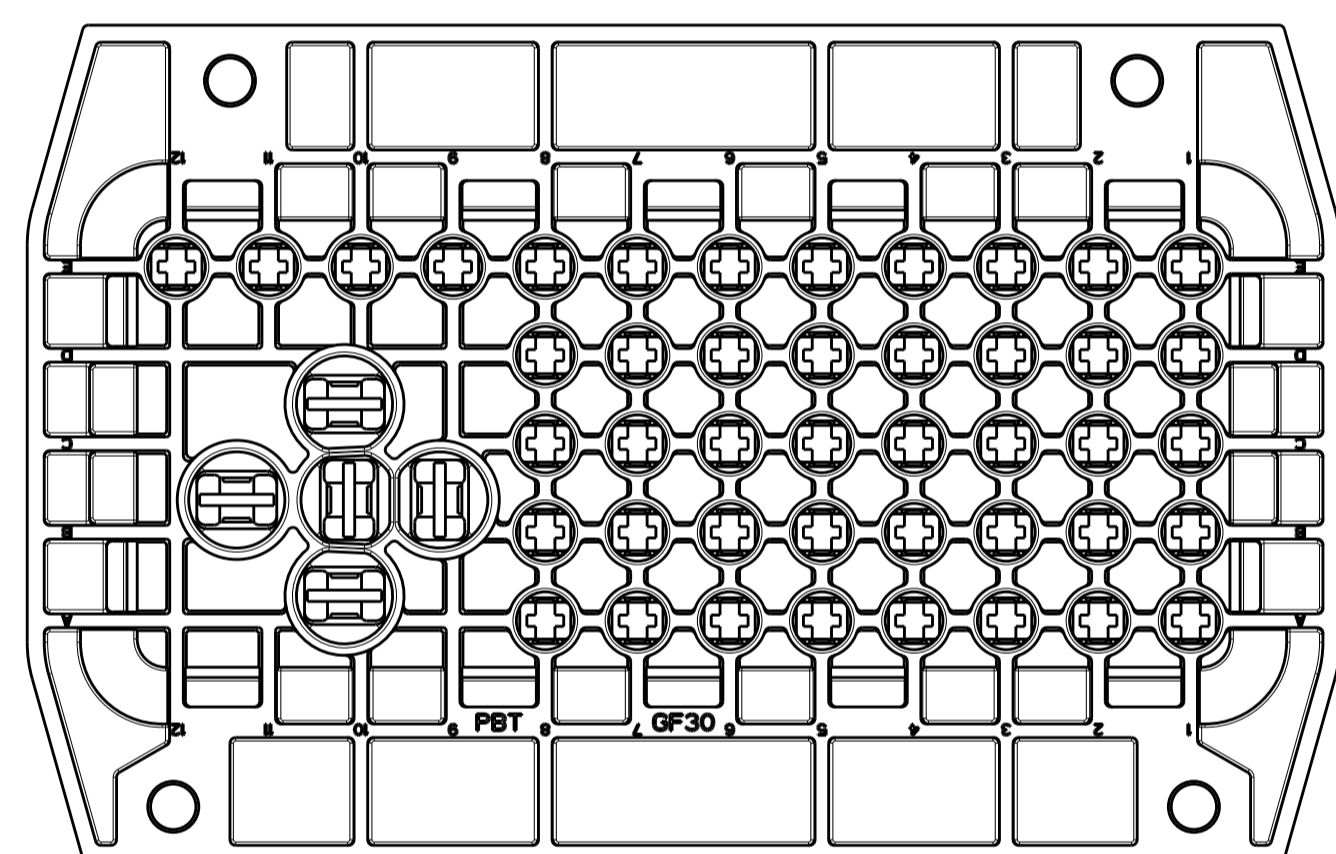
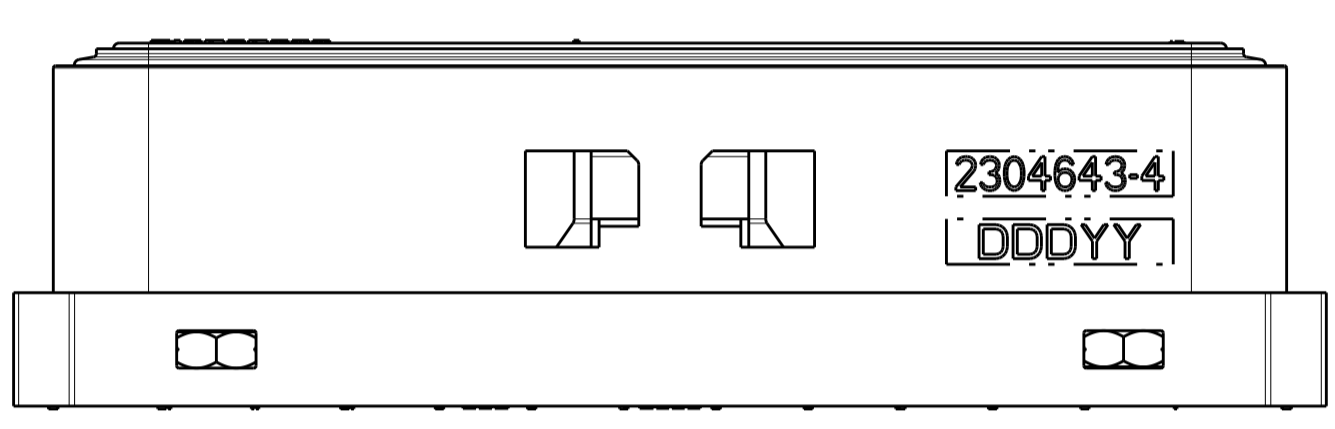
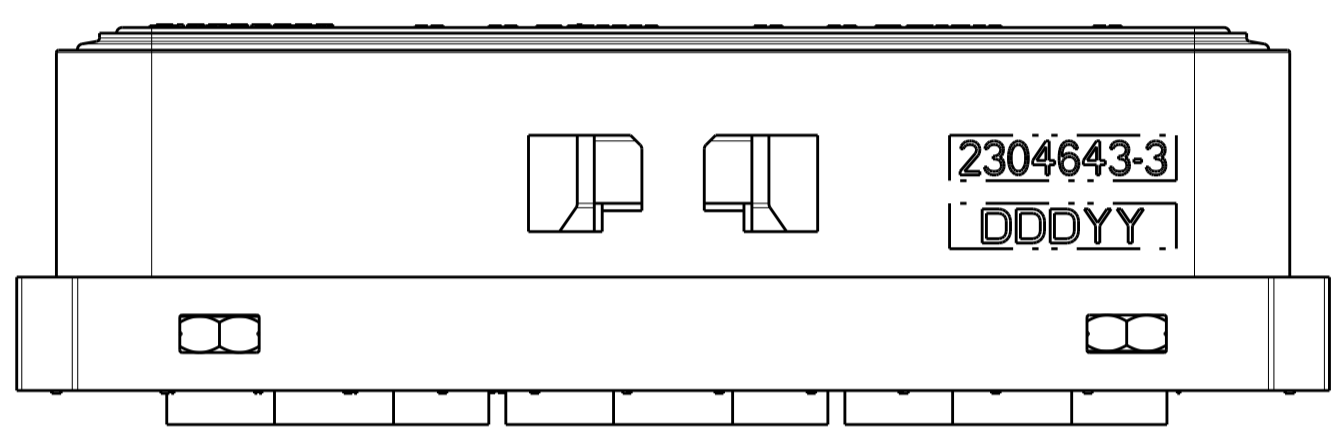
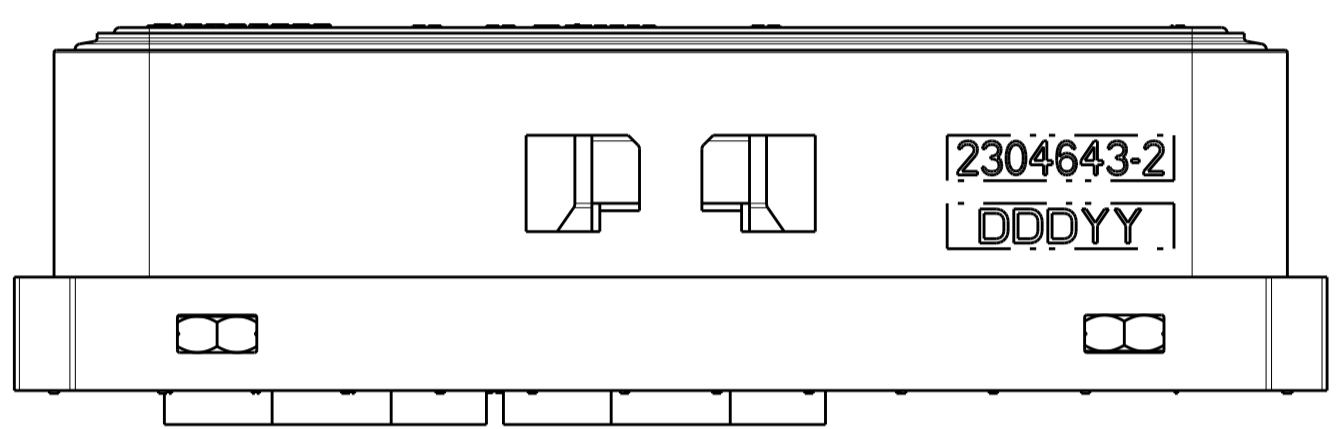
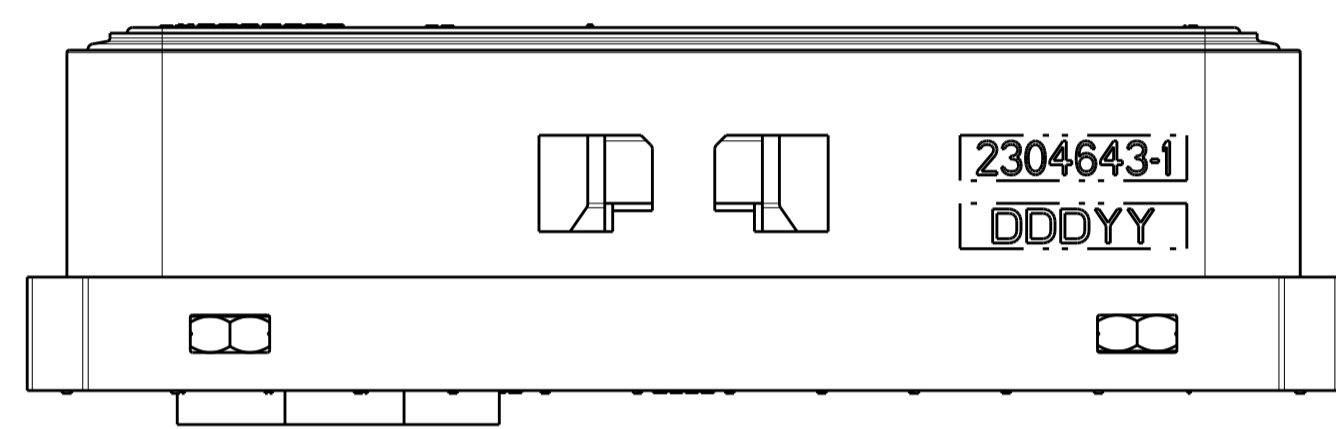
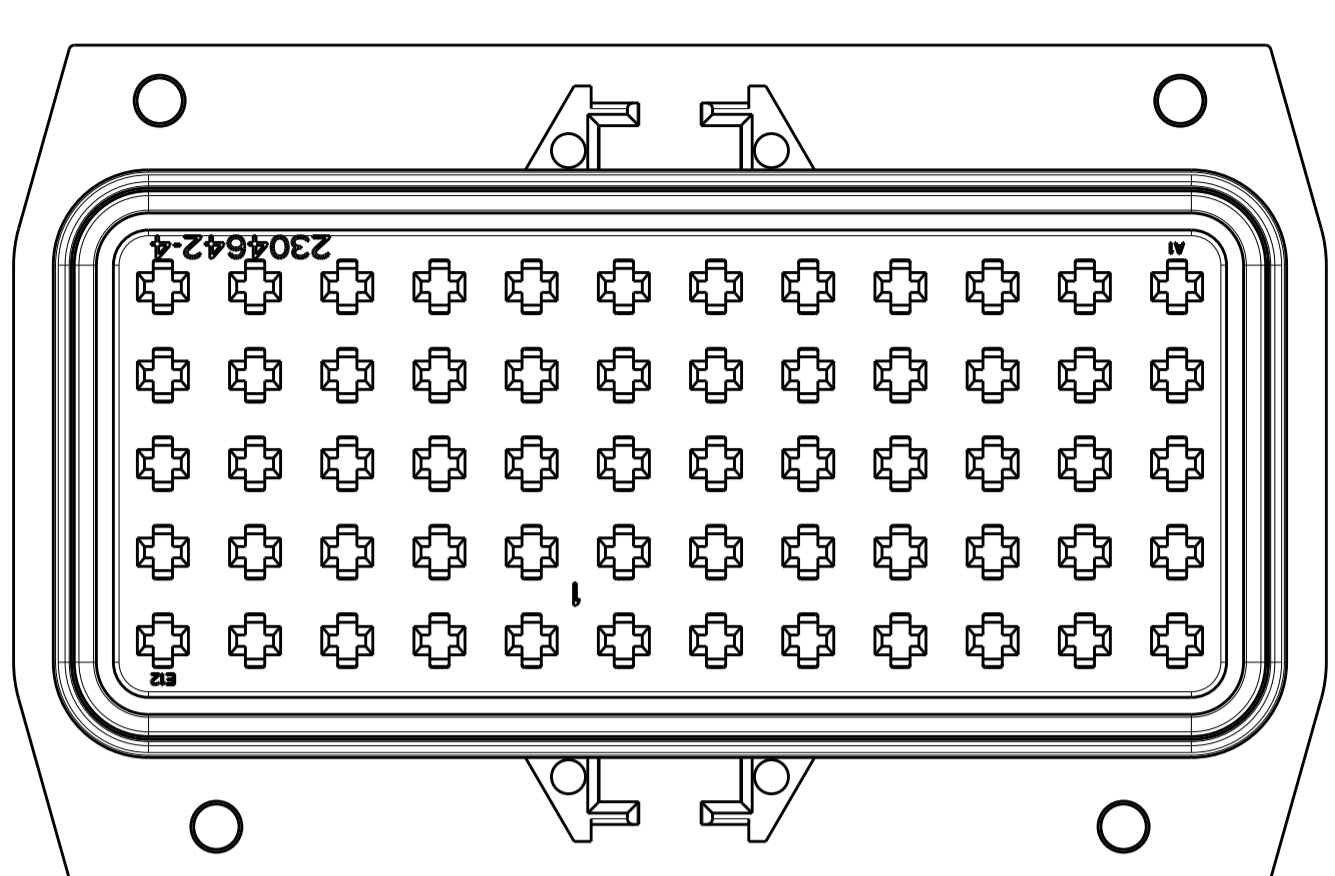
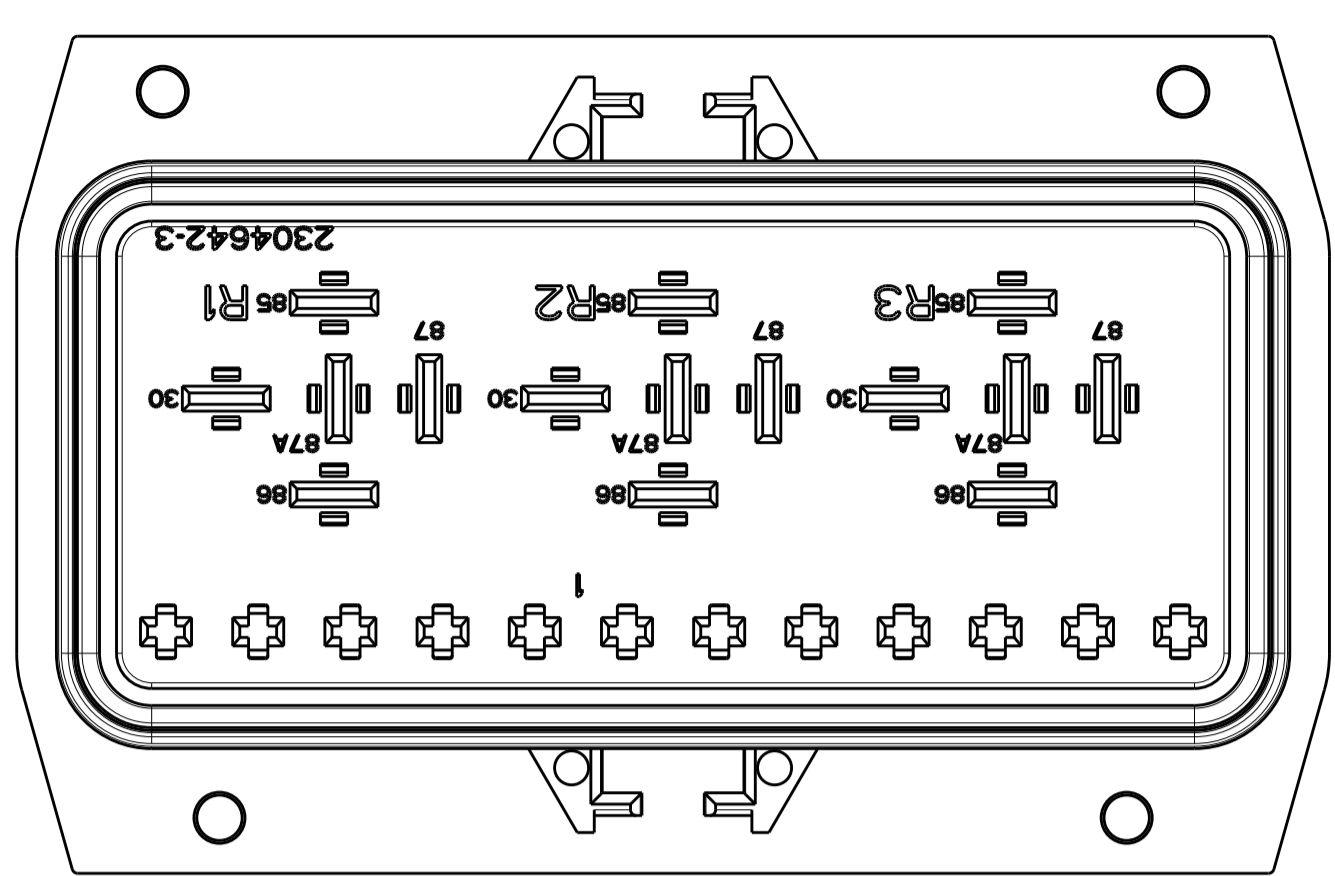
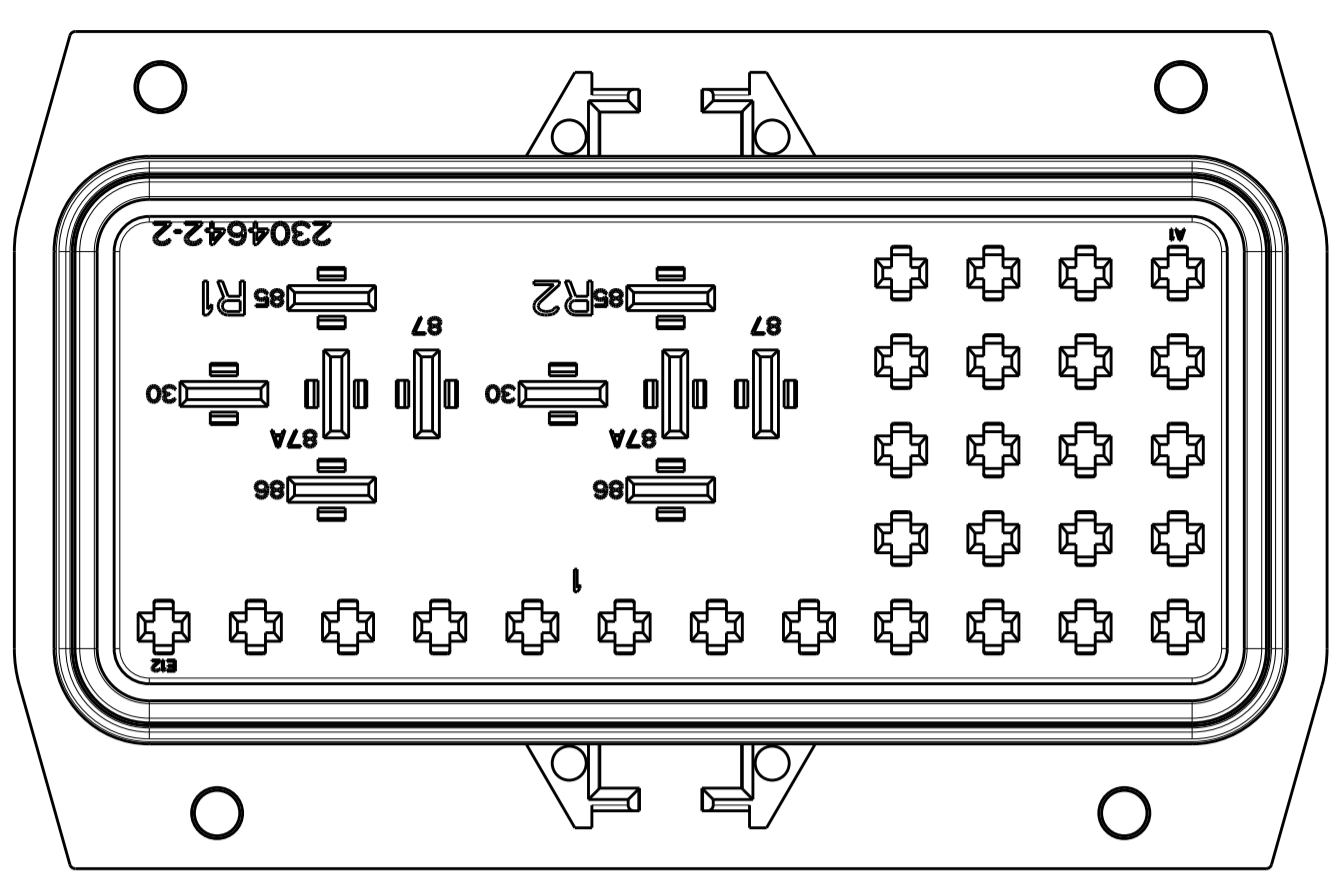
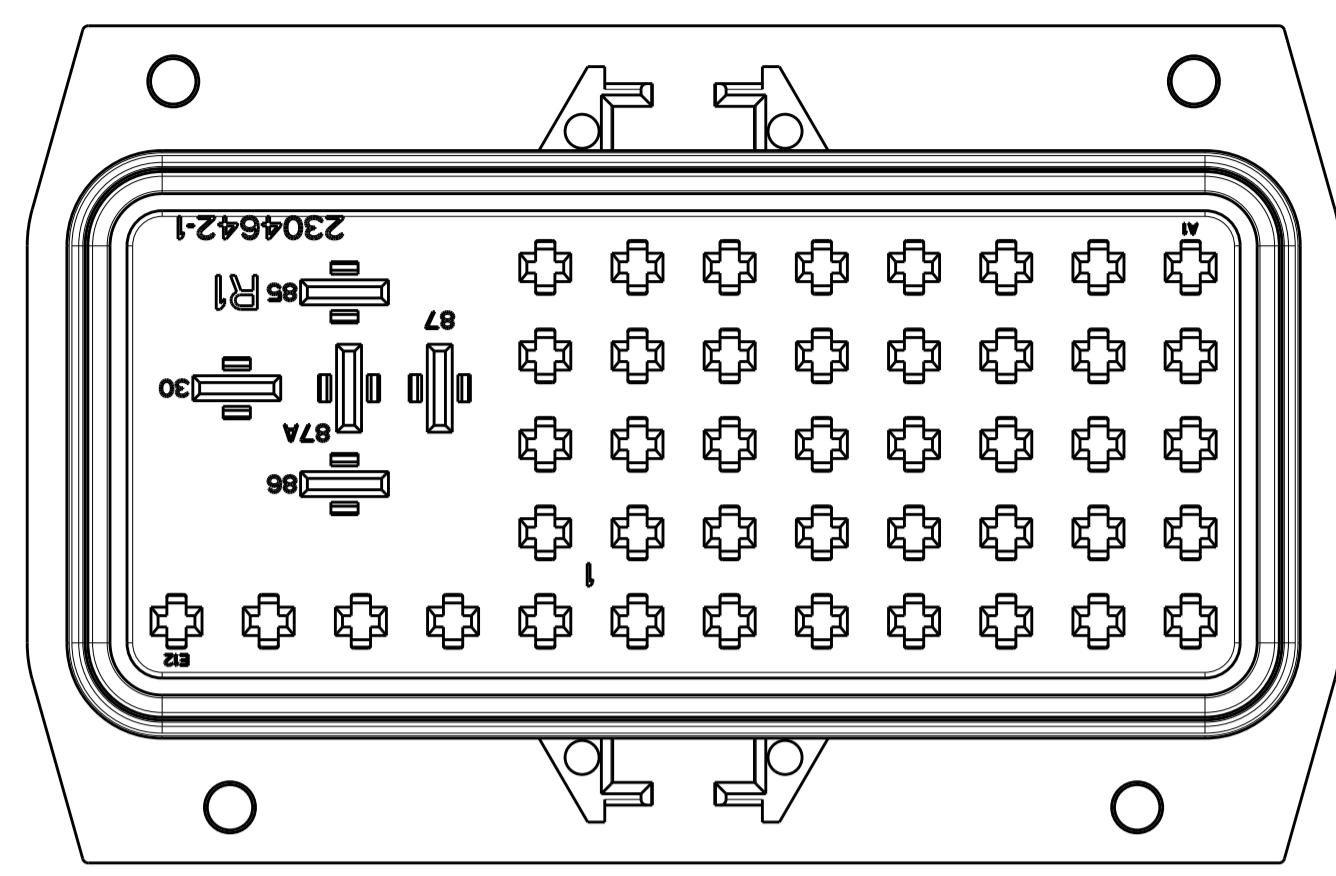

2304643-1 SHOWN

2304643-2 SHOWN

2304643-3 SHOWN

2304643-4 SHOWN

THIS DRAWING IS A CONTROLLED DOCUMENT.		DWN: L. HEYCK 11 JUL 2016 CHK: D. STRAUSSER 11 JUL 2016 APVD: O. DONKERVOORT 24 SEP 2019	TE Connectivity NAME: FUSE AND RELAY BOX, FLANGED
DIMENSIONS: mm	TOLERANCES UNLESS OTHERWISE SPECIFIED: 0 PLC ±0.5 1 PLC ±0.2 2 PLC ± 3 PLC ± 4 PLC ± ANGLES ± FINISH	PRODUCT SPEC: 108-151059 APPLICATION SPEC: 114-151059 WEIGHT:	
MATERIAL:		CUSTOMER DRAWING	RESTRICTED TO: