

THIS DRAWING IS UNPUBLISHED. VERTRAULICHE UNVERÖFFENTLICHTE ZEICHNUNG. RELEASED FOR PUBLICATION FREI FUER VERÖFFENTLICHUNG. 20. MATED WITH: PASSEND ZU: -

PROJEKT NR.:		REVISIONS			
P	LTR	DESCRIPTION	DATE	DWN	APVD
	D	TABLE UPDATE	29NOV2018	GKU	DWE
	D1	9.4g was 2.4g	03JAN2019	GKU	DWE
	D2	NOTES AND DIM 6.75 TOL. UPDATED	19JAN2021	AHM	DWE
	D3	ADDED NOTE FOR COLOR MARKING AFTER EL.TEST	24NOV2021	JJH	TSA

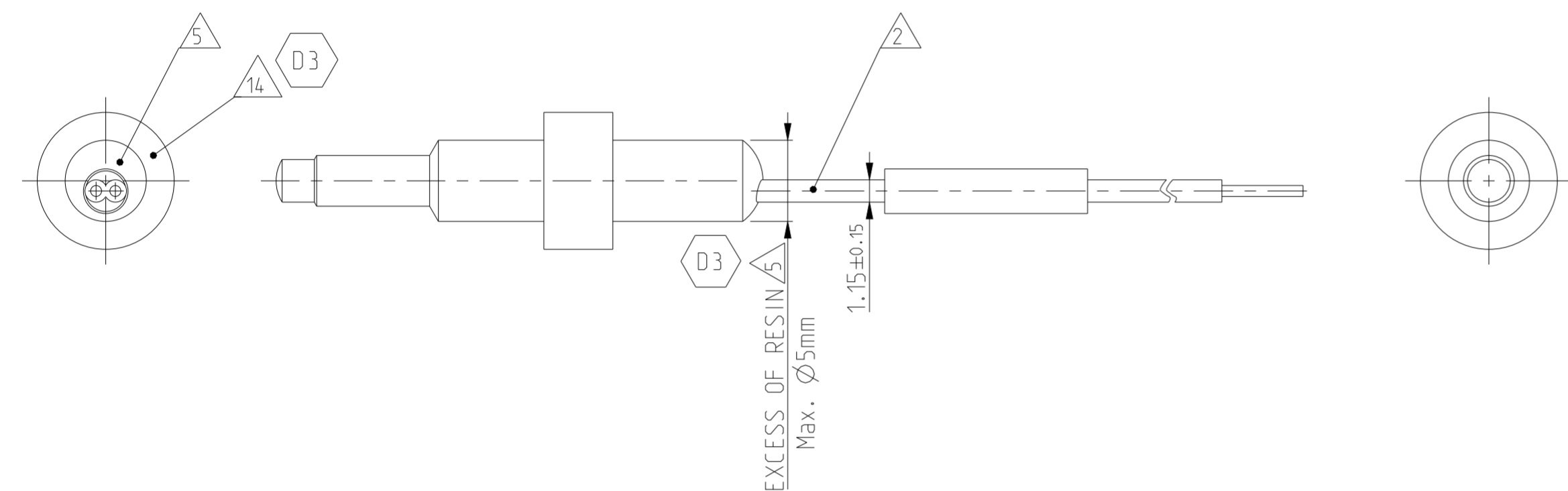
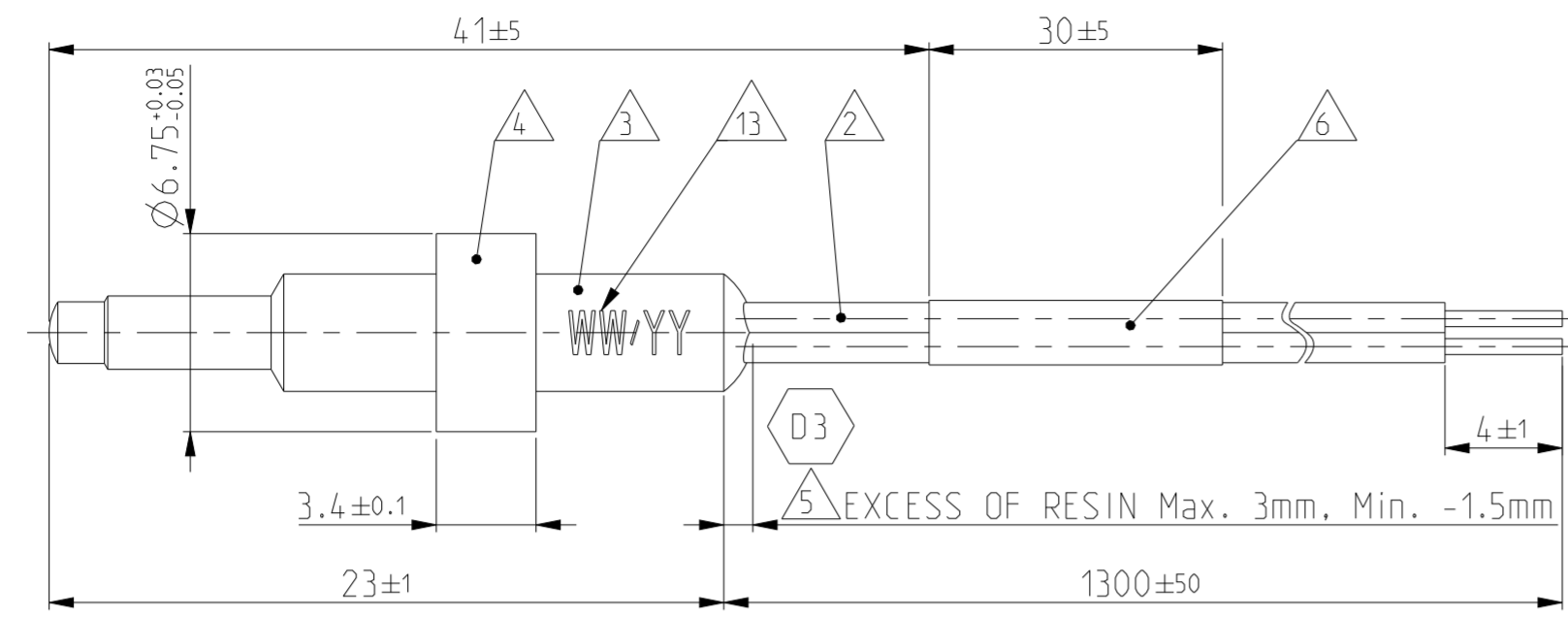

- 1 PT1000 MICRO CHIP
- 2 INSULATED LEADS: AWG#22 STRANDED, TIN PLATED CONDUCTOR, MODIFIED POLYESTER INSULATION (RATING 600V), COLOR BLACK MECHANICAL STABILITY OF CABLING PULL OUT FORCE MAX. 8N
- 3 STAINLESS STEEL HOUSING
- 4 BRASS COLLAR, RETENTION FORCE ON STAINLESS STEEL HOUSING MAX. 25N
- 5 ELECTROLUBE UR5528 RESIN
- 6 HEAT SHRINK SLEEVE
- 7 MIN. BREAKDOWN VOLTAGE: 500 VAC (10s), STEEL BALLS.
- 8 INSULATION RESISTANCE (500 VDC): MIN. 200 MΩ.
- 9 MAX. LEAKAGE CURRENT 10mA WITH 500VAC.
- 10 APPLIED CURRENT TO BE LIMITED TO MAX. 0.4mA
- 11 TEMP SENSOR HAS TO MEET REQUIREMENTS DEFINED IN ISO 16750-A-D-N-C-Z-IP43
SUPPLY VOLTAGE: 6-16V
OPERATING TEMPERATURE RANGE: -40 to 120°C
- 12 RESISTANCE OF WIRE IS 110MΩ PER METER LENGTH AT AMBIENT TEMPERATURE (NOT INCLUDED IN THE TABLE)
- 13 PRODUCTION DATE MARKING (WEEK/YEAR)
- 14 COLOR MARKING IN THIS AREA AFTER SUCCESSFUL ELECTRICAL TEST (RESISTANCE TEST).

TEMPERATURE [°C]		RESISTANCE [Ohms]		
Nominal	Tolerance [±]	Nominal	Max	Min
-50	1,95	803,1	810,8	795,3
-40	1,8	842,7	849,8	835,6
-30	1,65	882,2	888,7	875,7
-20	1,5	921,6	927,5	915,7
-10	1,35	960,9	966,2	955,6
0	1,2	1000	1004,7	995,3
10	1,5	1039	1043,7	1034,3
20	1,58	1077,9	1083,2	1072,7
30	1,65	1116,7	1122,6	1110,9
40	1,8	1155,4	1162,4	1148,5
50	1,95	1194	1201,5	1186,5
60	2,1	1232,4	1240,5	1224,4
70	2,25	1270,8	1279,4	1262,1
80	2,4	1309	1318,1	1299,8
90	2,55	1347,1	1356,8	1337,4
100	2,7	1385,1	1395,3	1374,8
110	2,85	1422,9	1433,7	1412,1
120	3	1460,7	1472	1449,4
130	3,15	1498,3	1510,2	1486,5

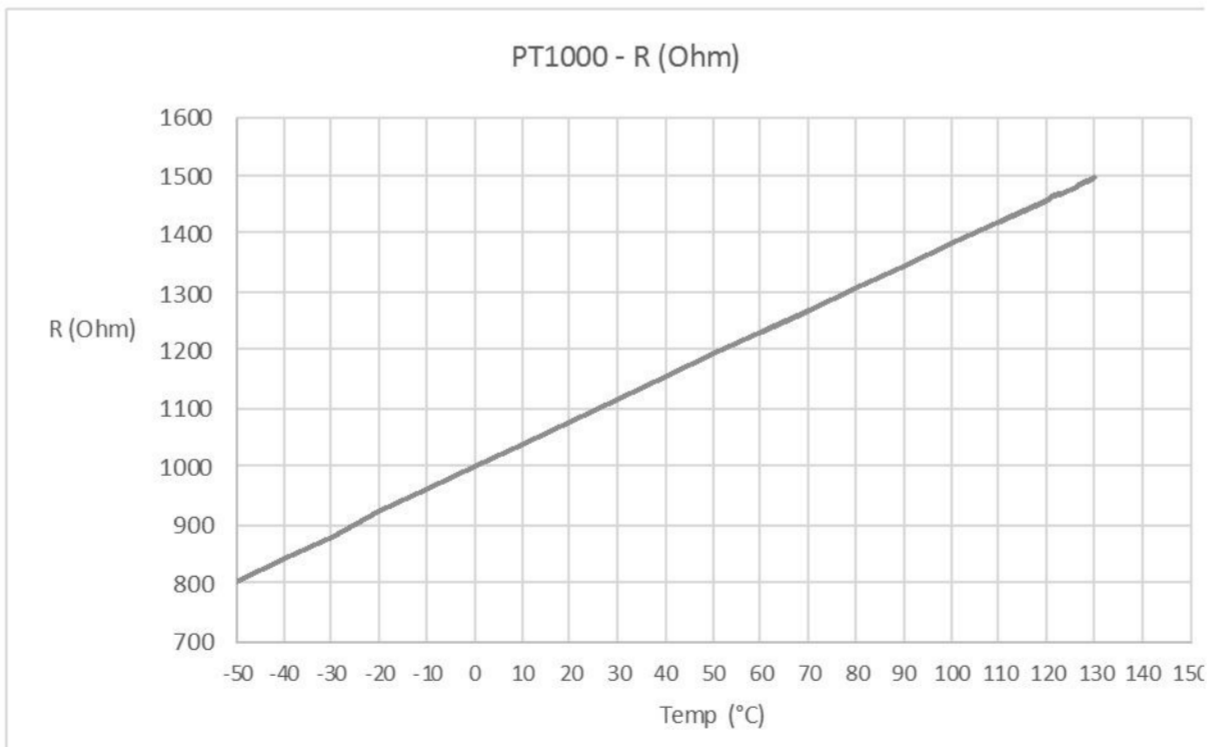

T _n Nominal (°C)	R _n (Ohms)	R _n tol.
25	1097	1%

MEASUREMENT SPECIALITIES	SUPPLIER	TE PN	REV	DESCRIPTION
		2288391-1	D	PT1000 TEMP SENSOR

DIESE ZEICHNUNG IST EIN KONTROLLIERTES DOKUMENT. BEMASSUNGEN UND TOLERANZEN GEMAESS GPS (ISO STANDARDS).

THIS DRAWING IS A CONTROLLED DOCUMENT. DIMENSIONING AND TOLERANCING PER GPS (ISO STANDARDS).

DWN: Sundarshan M D, 10NOV2014
CHK: Vishwa. A, 30JAN2015
APVD: D. Weyrauch, 30JAN2015

STE TE Connectivity

NAME: PT1000 TEMP SENSOR

SIZE: A2, CAGE CODE: -, DRAWING NO: C-2288391, RESTRICTED TO NUR FUER: -

MATERIAL: -, DIMENSIONS: -, TOLERANCES: -, FINISH/SURFACE/FARBE: -

WEIGHT: 9.4g, SCALE: 4:1, SHEET: 1 OF 1, REV: D3