

REVISIONS				
P.	LTN	DESCRIPTION	DATE	APVD
A3		REVISED PER ECO-15-010921	27JUL2015	DLD CJS
A4		REVISED PER ECO-16-001710	08FEB2016	DLD CJS
A5		REVISED PER ECO-16-016507	30NOV2016	DLD CJS

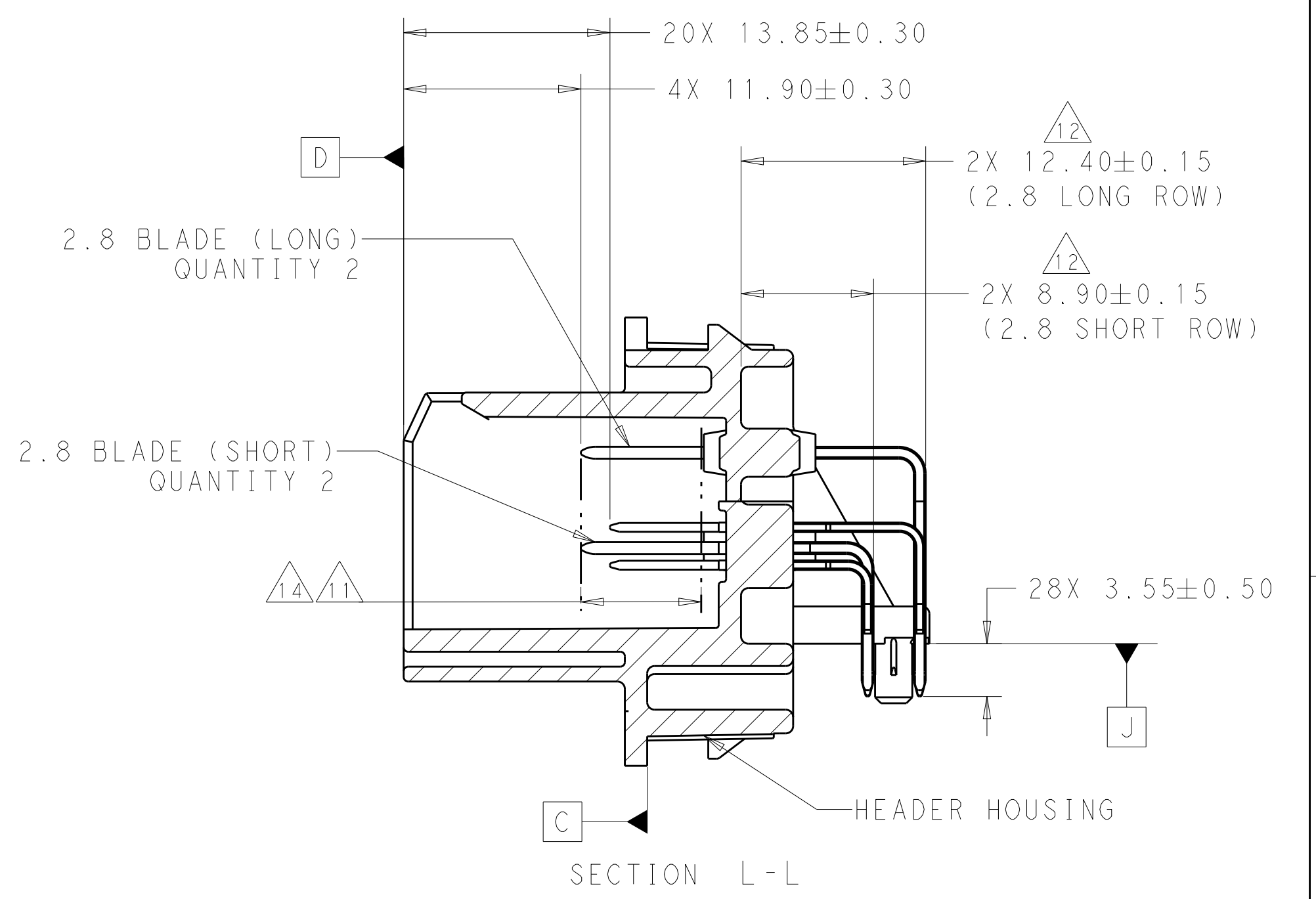

- MATERIAL:**
HOUSING: PBT 30% GLASS FILLED, COLOR: SEE TABLE
CONTACTS: COPPER ALLOY
- PLATING:**
0.64 BLADES: 0.76-2.0µm NICKEL UNDERPLATING ALL OVER
TIN MATING END: 1.0-2.5µm TIN
PRESS FIT AREA: 1.5µm TIN MAX

2.8 BLADES: 0.76-2.0µm NICKEL UNDERPLATING ALL OVER
TIN MATING END: 1.0-2.5µm TIN
PRESS FIT AREA: 1.5µm TIN MAX
- 1-2288241-1 SHOWN IN GENERAL VIEWS. SEE SHEET 3, KEYING DETAIL VIEWS FOR OTHER PART NUMBERS.
- MARK JULIAN DATE CODE IN APPROXIMATE LOCATION.
- TP FUNCTIONALLY GAUGED. GAUGING TAKES PRECEDENCE OVER TP DATA.
- TO BE MEASURED AT [C]
- SIGNAL PIN PLATED THRU HOLE DIMENSIONS:
HOLE PRIOR TO PLATING Ø1.15±0.025mm
THICKNESS OF PTH -WALL > 25µm Cu
FINISHED PLATING: HAL OR GALVANIC TIN 5-15µm OR CHEMICAL TIN >0.5µm
FINISHED HOLE Ø0.94-1.09mm
- POWER PIN PLATED THRU HOLE DIMENSIONS:
HOLE PRIOR TO PLATING Ø1.60±0.025mm
THICKNESS OF PTH -WALL > 25µm Cu
FINISHED PLATING: HAL OR GALVANIC TIN 5-15µm OR CHEMICAL TIN >0.5µm
FINISHED HOLE Ø1.39-1.54mm
- [SC] SYMBOL DENOTES SPECIAL CHARACTERISTICS WHICH ARE SUBJECT TO SPECIAL MANUFACTURING CONTROLS, PER AAIP62.

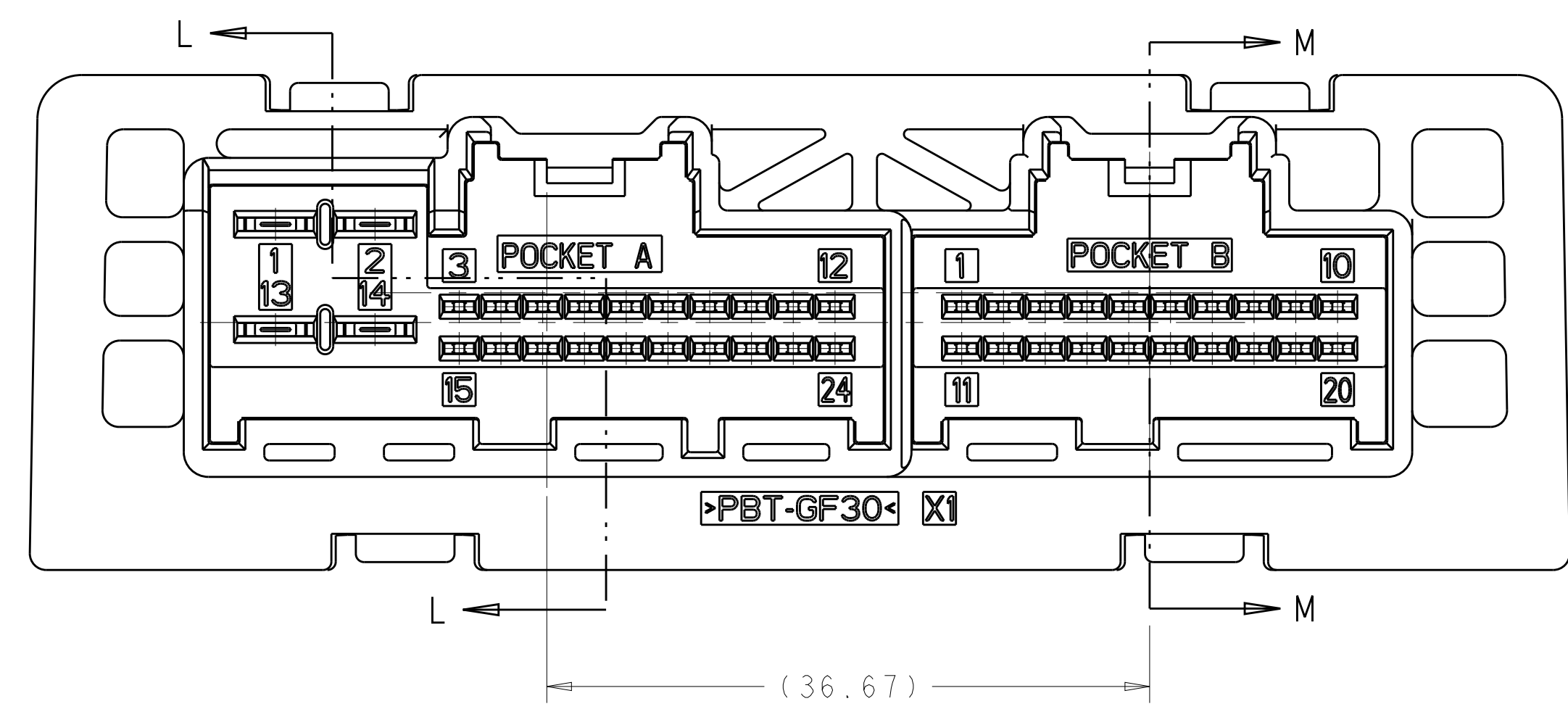
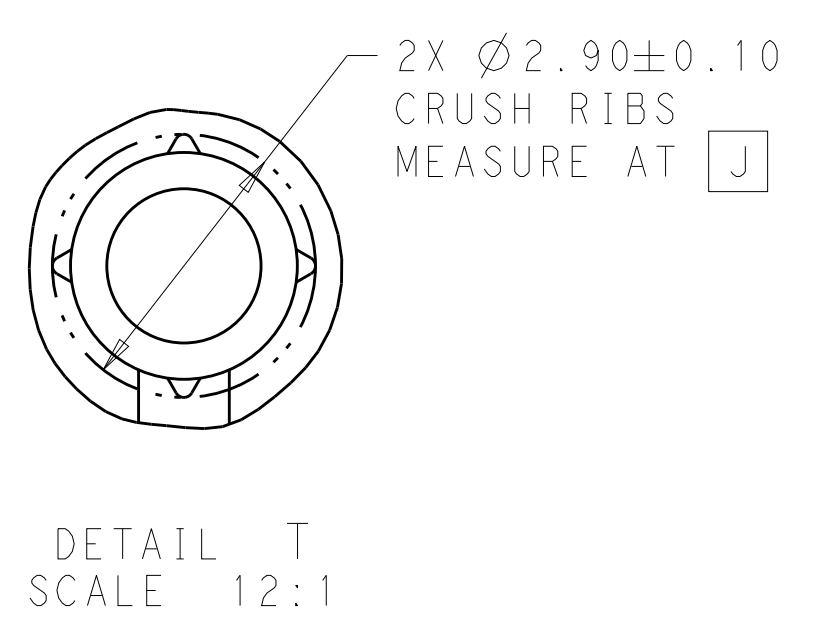
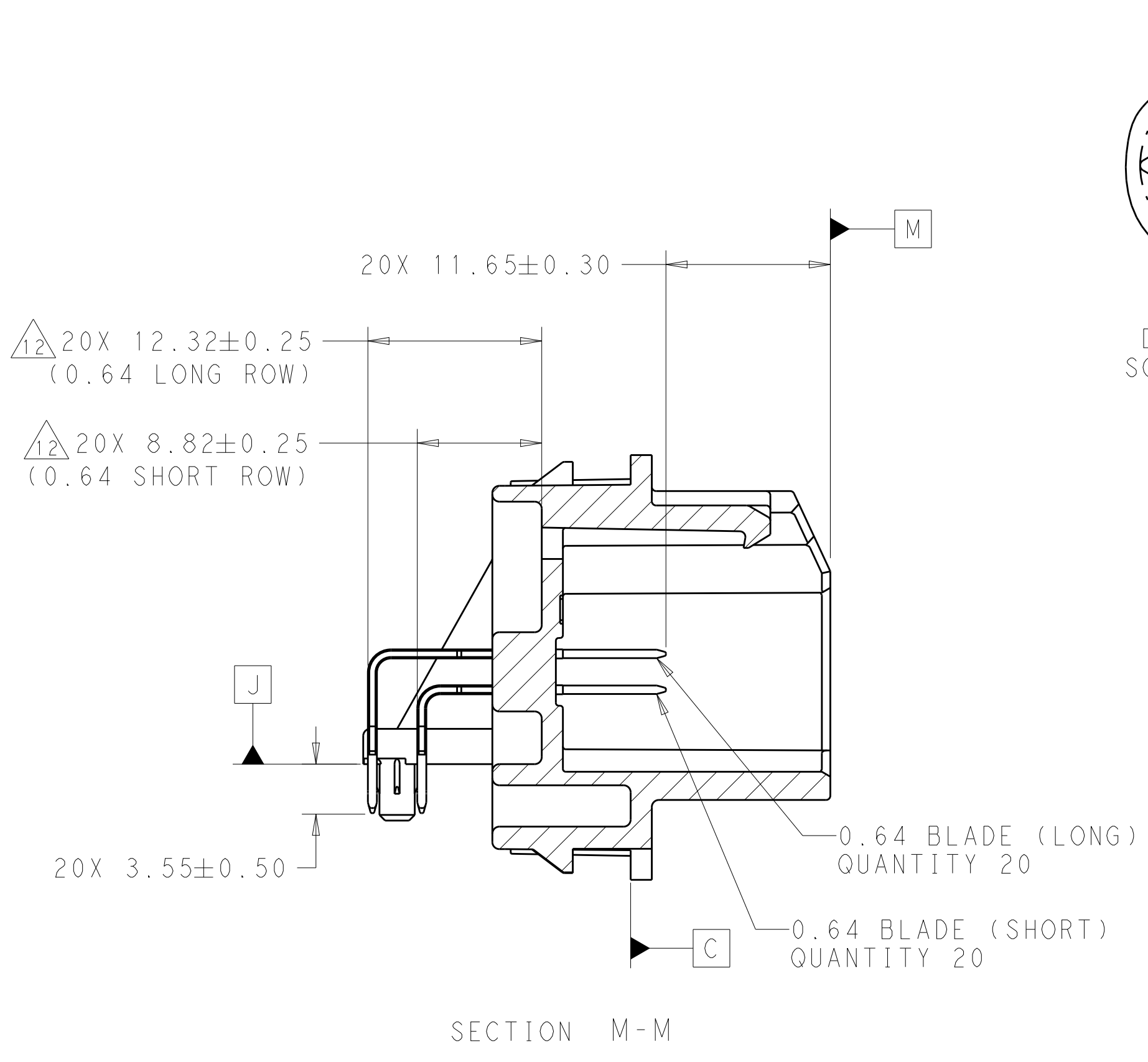
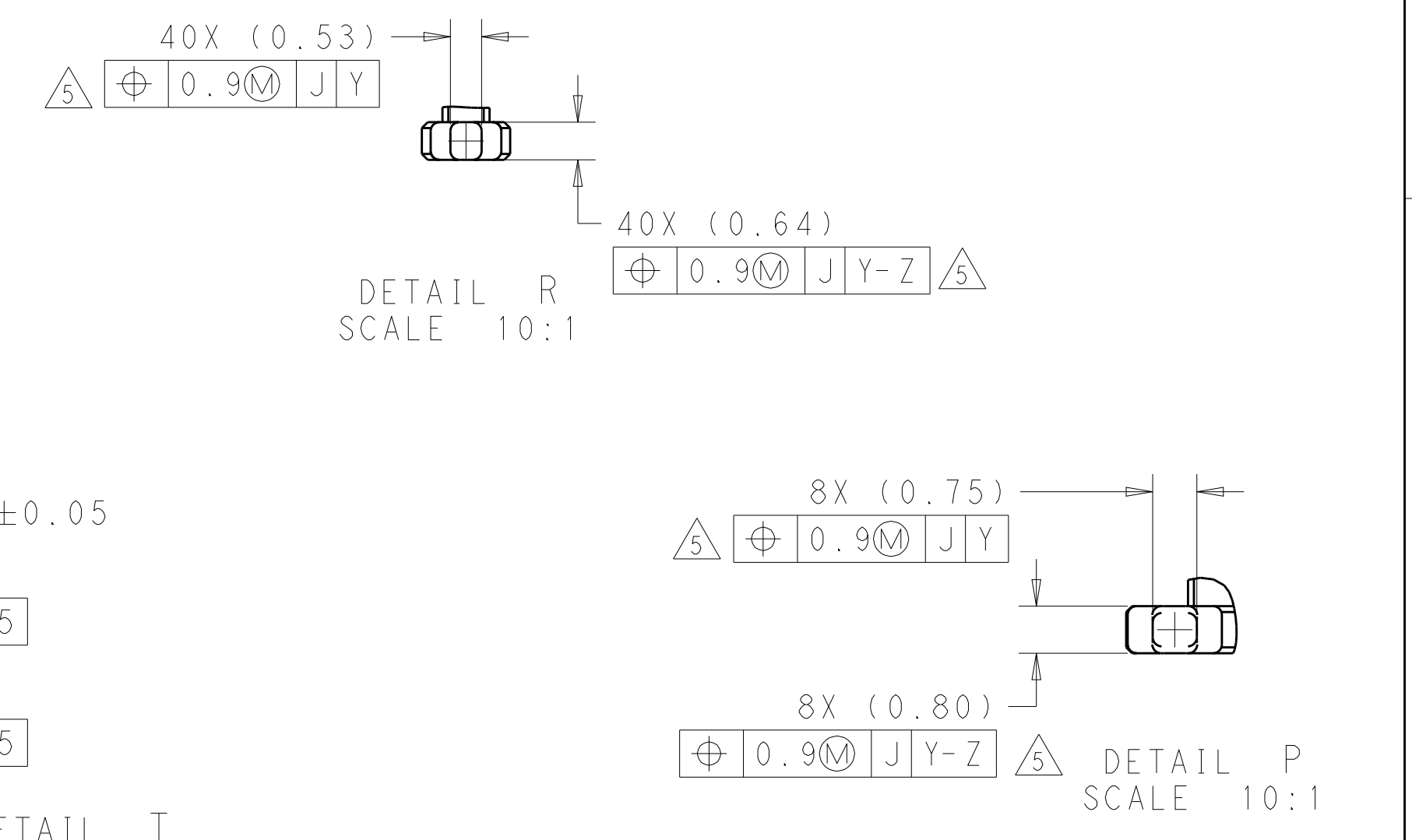
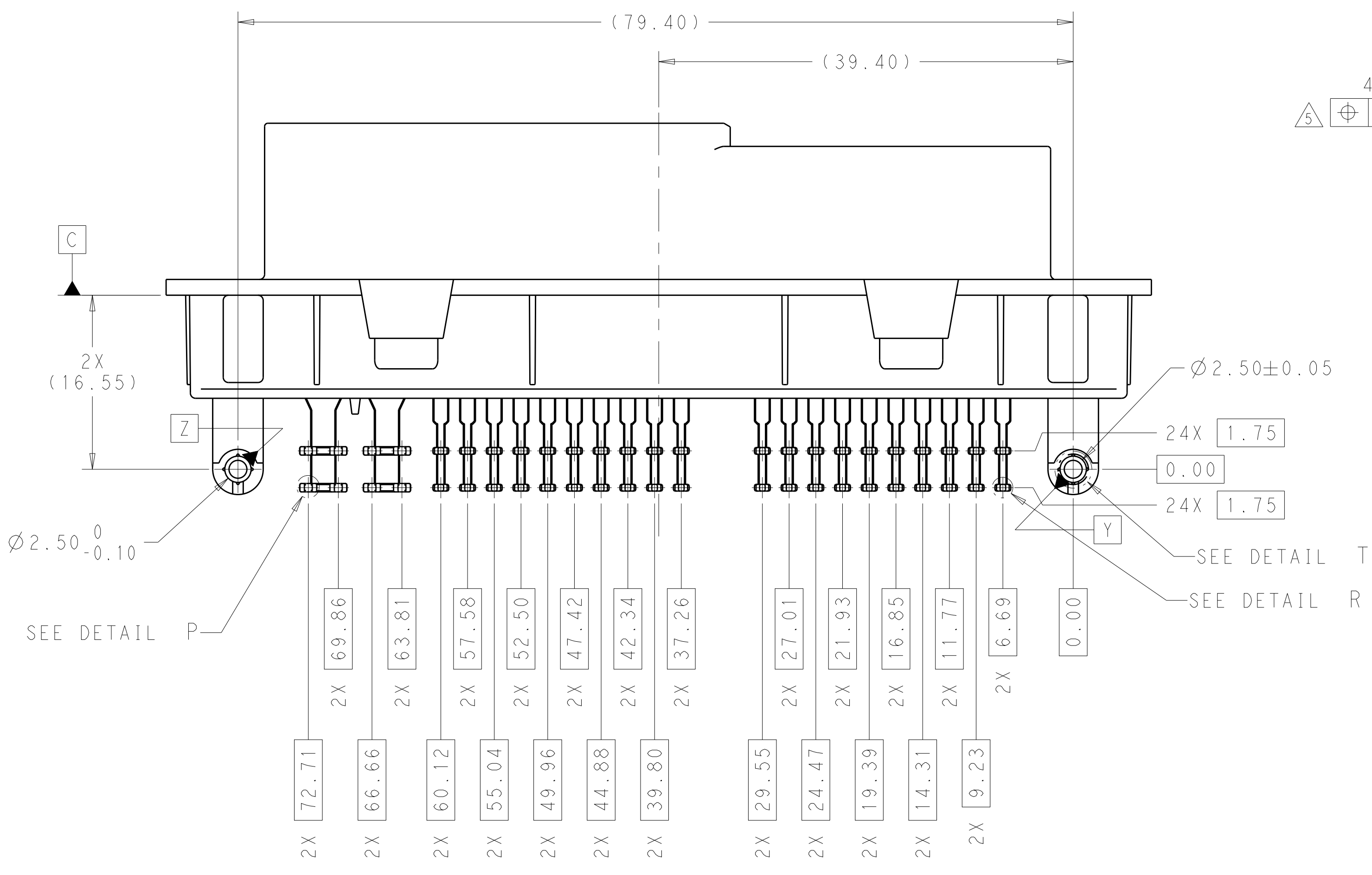

- MATING CONNECTORS: 2288274 (POCKET A, 24P HYBRID) AND 2288276 (POCKET B, 20P 0.64)
- NOTE REMOVED
- BEND LOCATIONS TO BE MEASURED FROM HOUSING AT POINTS INDICATED ON SHT 2 TO THE TARGET POINT OF THE BEND.
- PRELIMINARY - NOT RELEASED FOR PRODUCTION
- BLADES HAVE NYE LUBRICANTS, INC NYEACT 568J-20-UV APPLIED IN MATING REGION INDICATED. THIS IS A WHITISH COLORED LUBE AND VISIBILITY MAY VARY.
- NOTE REMOVED

[13]	[14]	GRAY	B-B	1-2288241-2
[14]	[14]	BLACK	A-A	1-2288241-1
LUBRICANT	COLOR	KEY	PART NUMBER	

THIS DRAWING IS A CONTROLLED DOCUMENT.

DIMENSIONS:	TOLERANCES UNLESS OTHERWISE SPECIFIED:	APVD	DATE
mm	0 PLC ±0.3 1 PLC ±0.3 2 PLC ±0.13 3 PLC ±0.13 4 PLC ±0.13 ANGLES ±0.5°	C. SCHMID	27OCT2014
MATERIAL:	FINISH:	PRODUCT SPEC	APPLICATION SPEC
-	-	-	-
CUSTOMER DRAWING		SIZE	SCALE
-		114-13312	3:1

STE TE Connectivity

NAME: 44-WAY UNSEALED HYBRID, MULTI-SPRING (20X 0.64, 20X 0.64-4X 2.8) RIGHT ANGLE HEADER ASSEMBLY

SIZE: A1 CAGE CODE: 100779 DRAWING NO: 2288241

RESTRICTED TO: A5

REVISIONS				
P.	LTM	DESCRIPTION	DATE	APVD
-	-	SEE SHEET 1	-	-

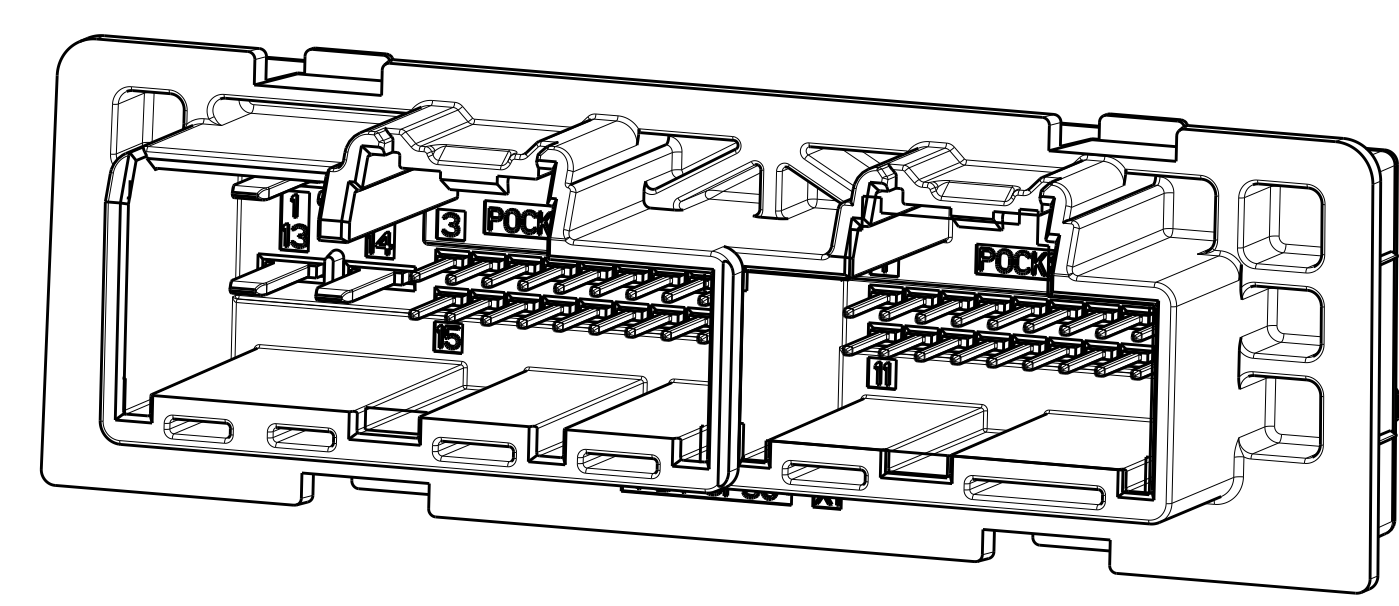
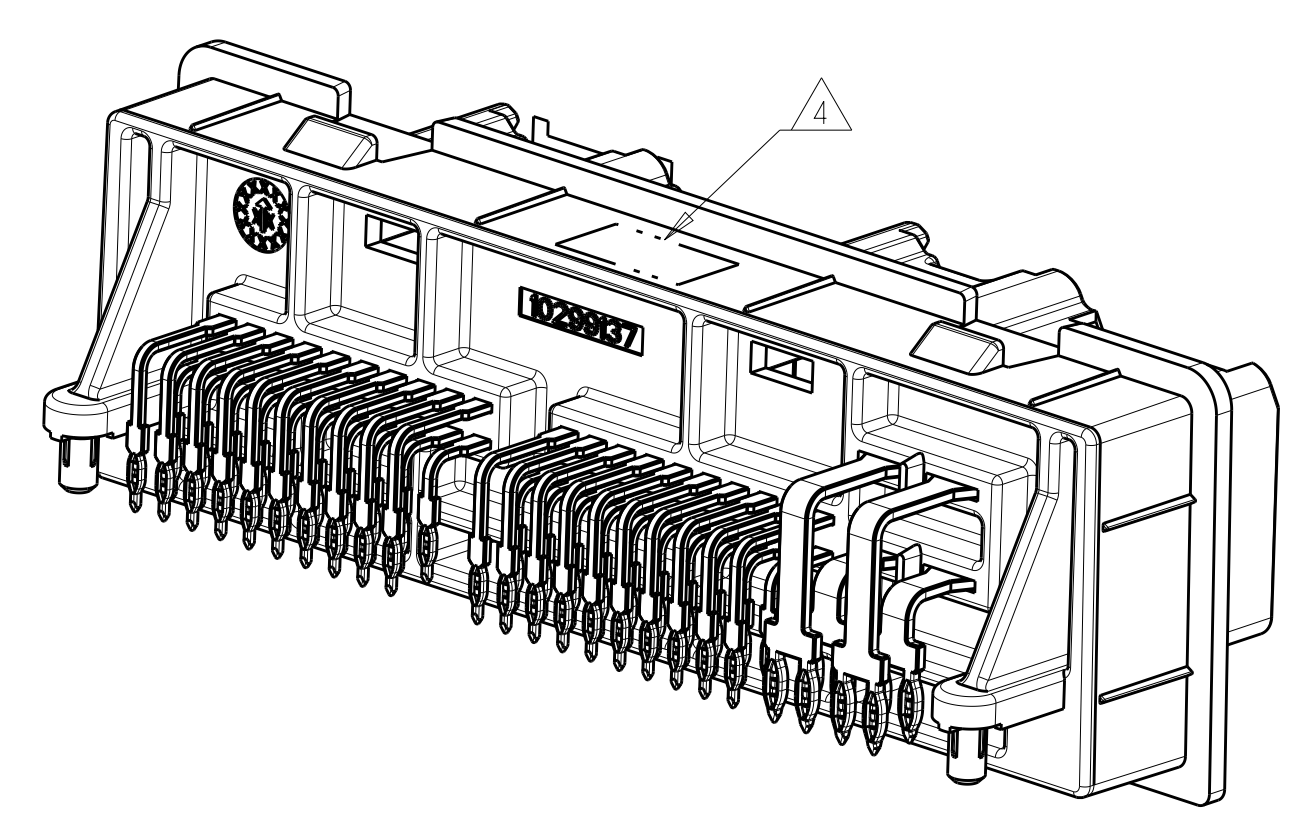
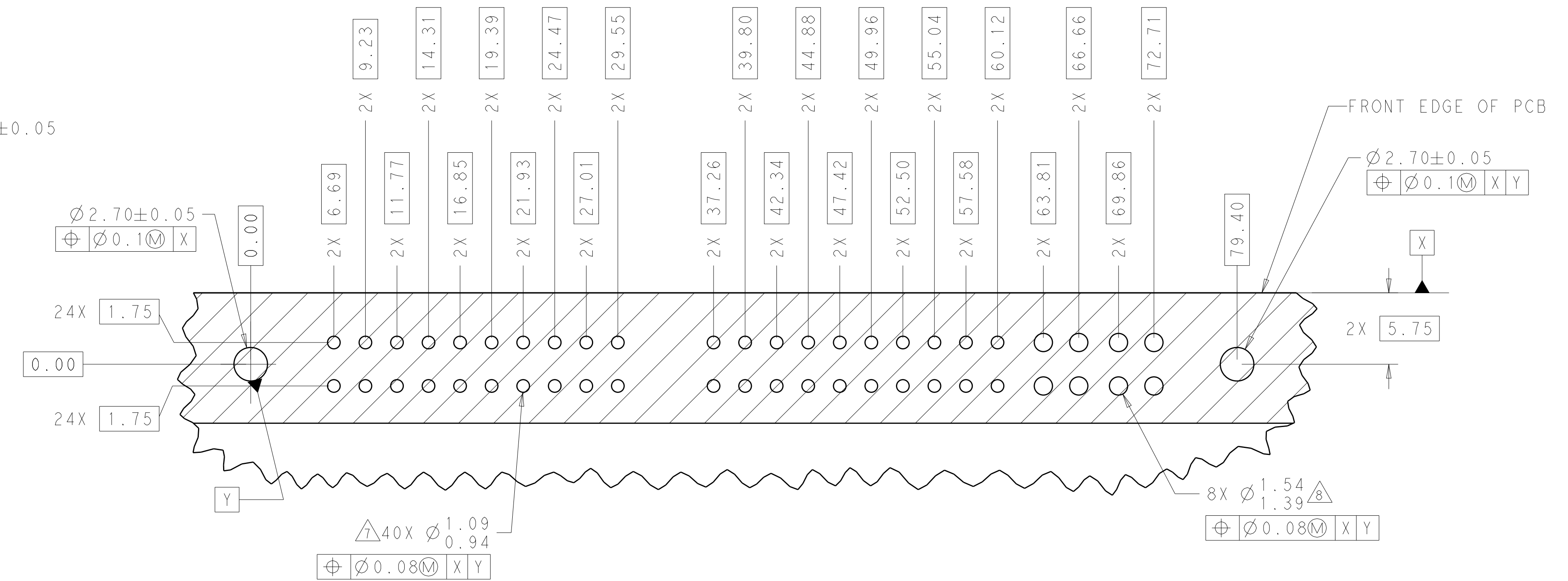
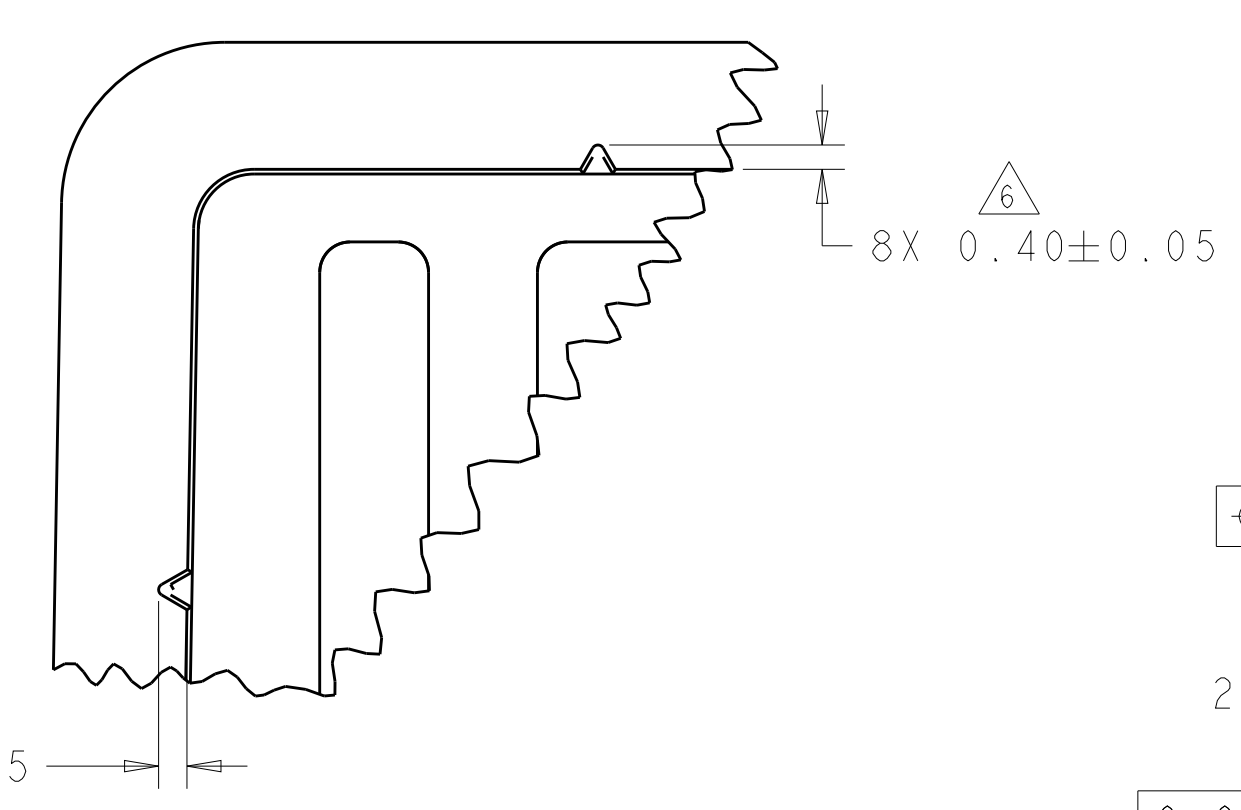
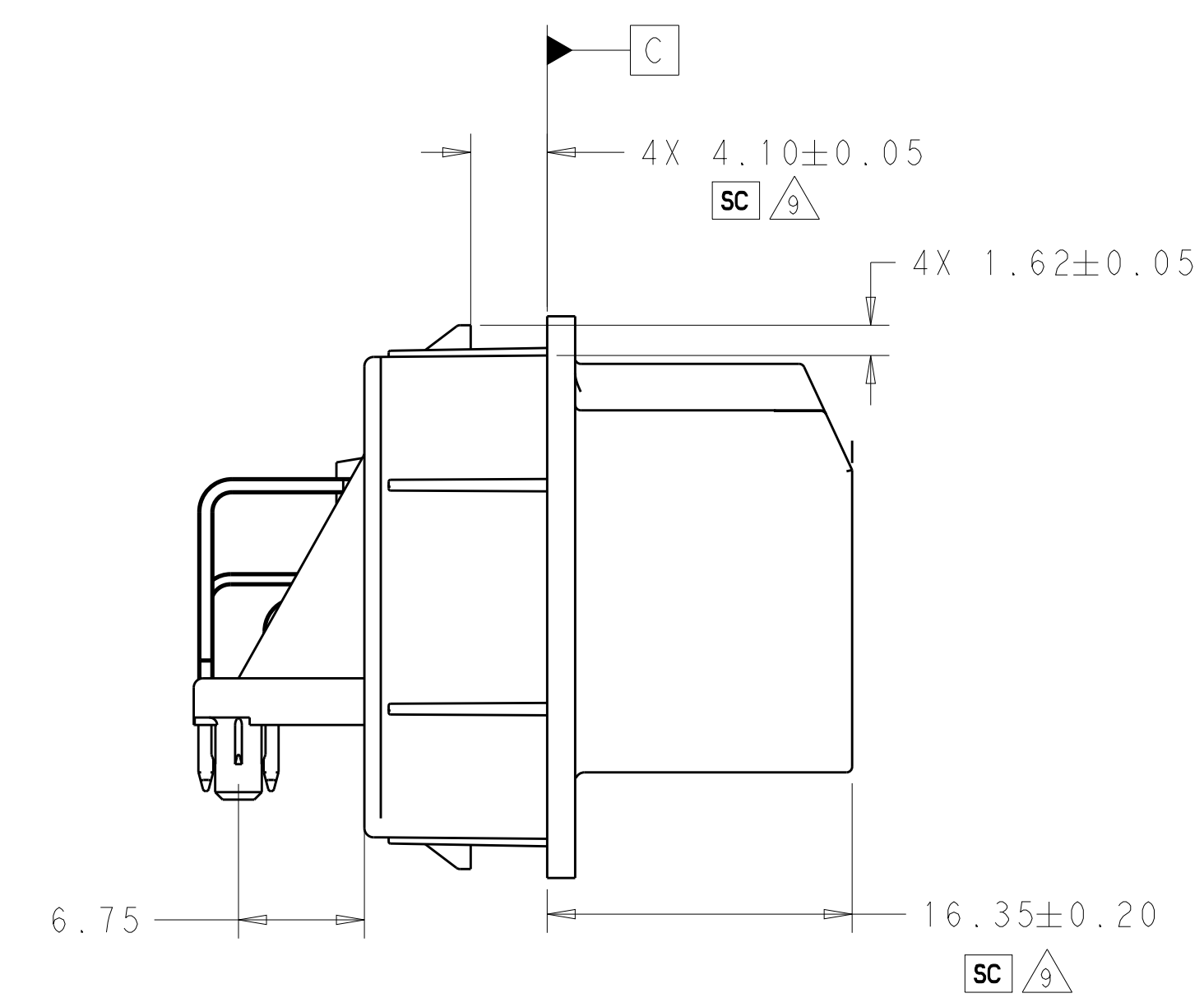
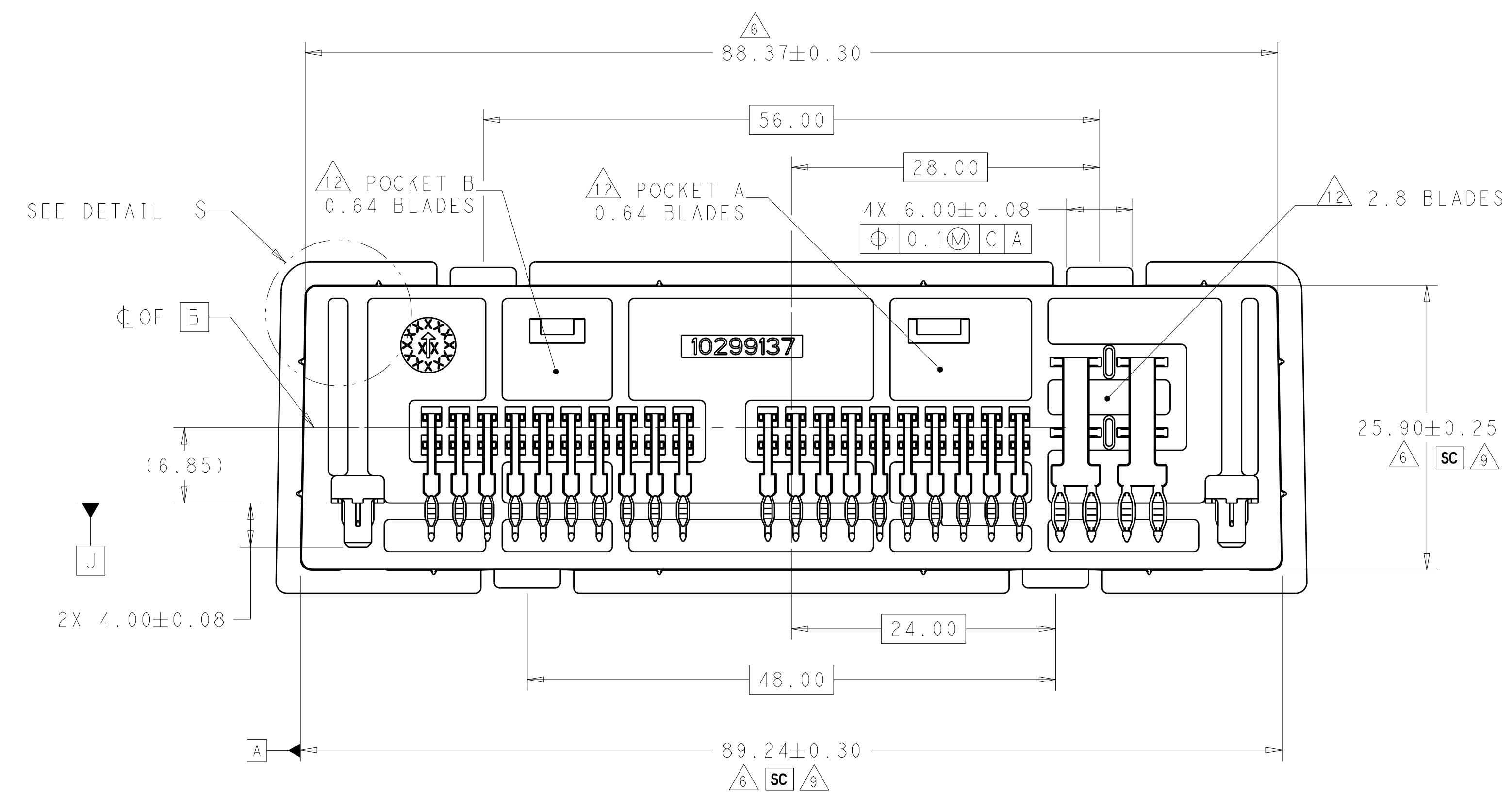

THIS DRAWING IS A CONTROLLED DOCUMENT.		DWN: D. DRUMMOND 27OCT2014	TE Connectivity
DIMENSIONS: mm		CHK: C. SCHMID 27OCT2014	
TOLERANCES UNLESS OTHERWISE SPECIFIED:		APVD: F. SCHMID 27OCT2014	NAME: 44-WAY UNSEALED HYBRID, MULTI-SPRING (20X 0.64, 20X 0.64-4X 2.8) RIGHT ANGLE HEADER ASSEMBLY
0 PLC ±0.3		PRODUCT SPEC	SIZE: 114-13312
1 PLC ±0.13		APPLICATION SPEC	WEIGHT
2 PLC ±0.13		RESTRICTED TO	SCALE: 3:1 SHEET 2 OF 3 REV: A5
3 PLC ±0.13		CUSTOMER DRAWING	
4 PLC ±0.13			
ANGLES ±0.5°			
FINISH: ±0.05			

REVISIONS				
P.	LTM	DESCRIPTION	DATE	APVD
-	-	SEE SHEET 1	-	-

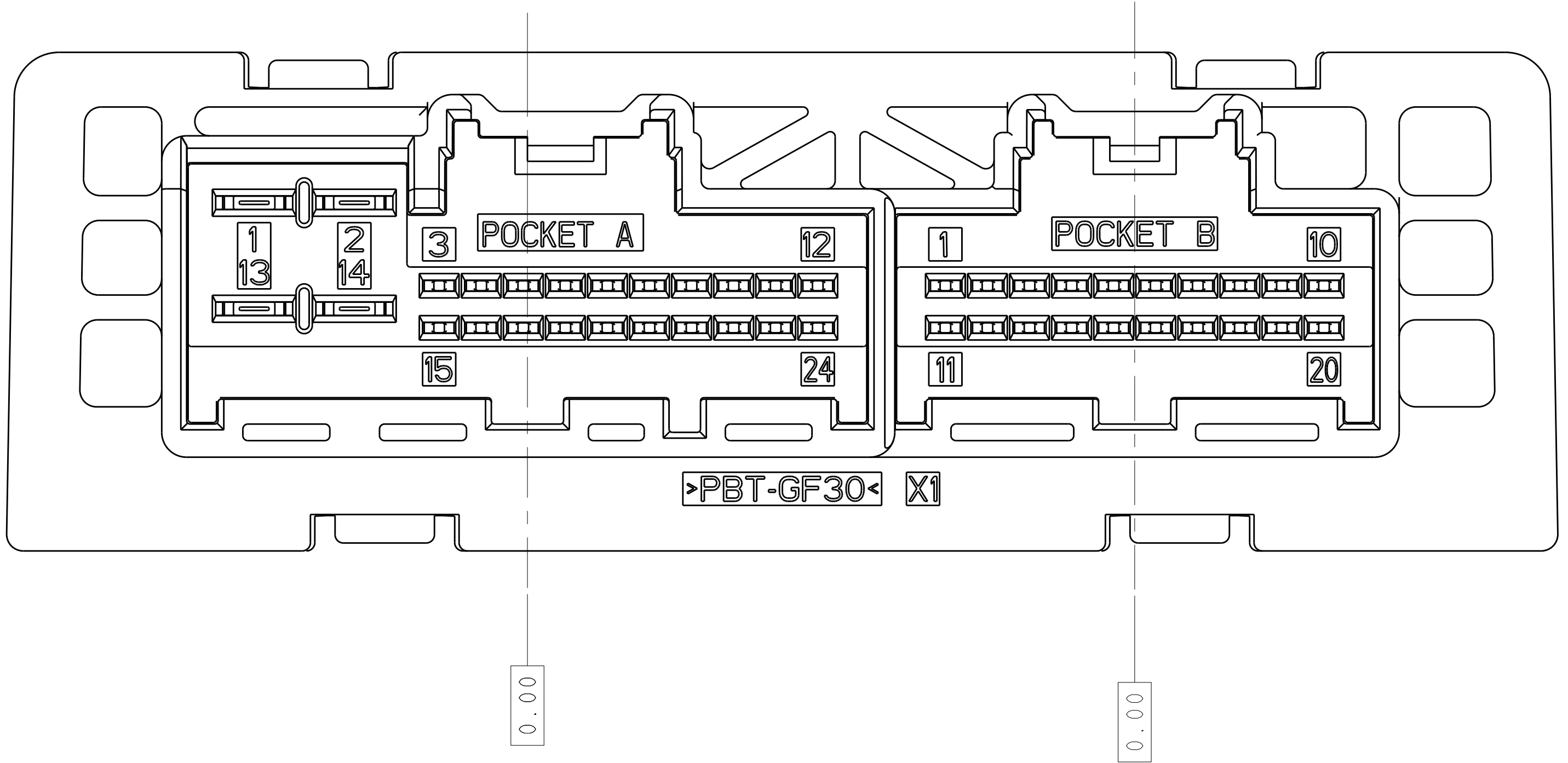

1-2288241-2 ¹³
 KEY B-B
 SCALE 4:1

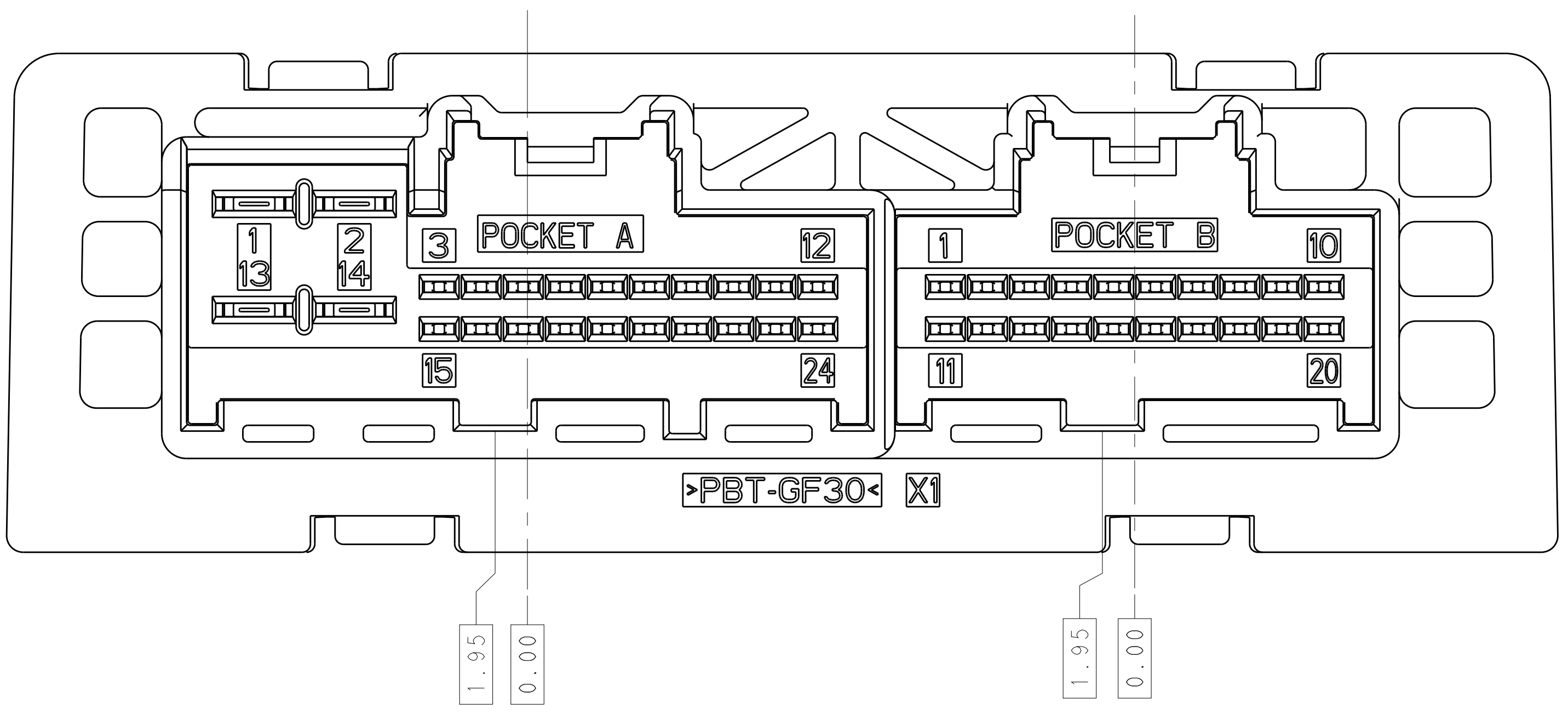

1-2288241-1
 KEY A-A
 SCALE 4:1

THIS DRAWING IS A CONTROLLED DOCUMENT.		DWN: D. DRUMMOND 27OCT2014	TE Connectivity
DIMENSIONS: mm		CHK: C. SCHMID 27OCT2014	
TOLERANCES UNLESS OTHERWISE SPECIFIED:		APVD: C. SCHMID 27OCT2014	NAME: 44-WAY UNSEALED HYBRID, MULTI-SPRING (20X 0.64, 20X 0.64-4X 2.8) RIGHT ANGLE HEADER ASSEMBLY
0 PLC ±	1 PLC ±0.3	PRODUCT SPEC	SIZE: A1
2 PLC ±0.13	3 PLC ±	APPLICATION SPEC	CAGE CODE: 114-13312
4 PLC ±	ANGLES ±°	WEIGHT	DRAWING NO: 2288241
MATERIAL	FINISH	CUSTOMER DRAWING	SCALE: 3:1 SHEET 3 OF 3 REV: A5