

4

3

2

1

THIS DRAWING IS UNPUBLISHED. RELEASED FOR PUBLICATION  
 © COPYRIGHT - by - ALL RIGHTS RESERVED.

LOC		DIST		REVISIONS			
P	LTR	DESCRIPTION		DATE	DWN	APVD	
B		REVISE PER ECR-14-007657		20MAY2014	E.C	K.Z	

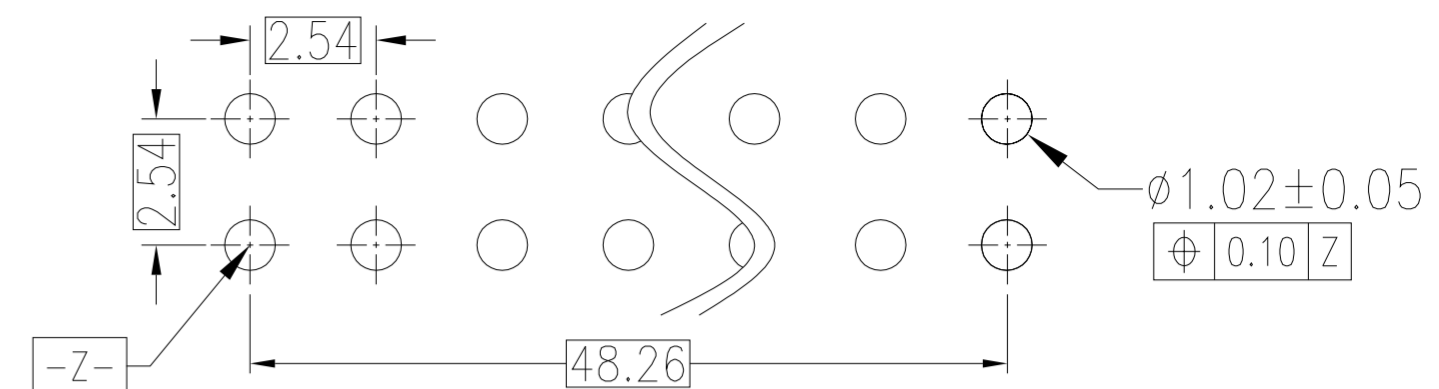
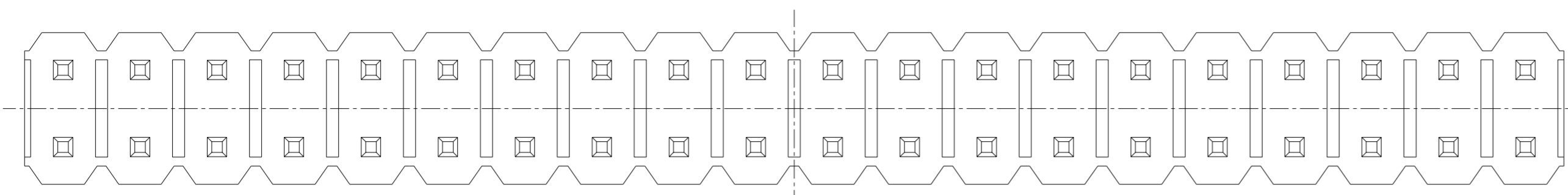

Recommended P.C.B Layout (Top View)

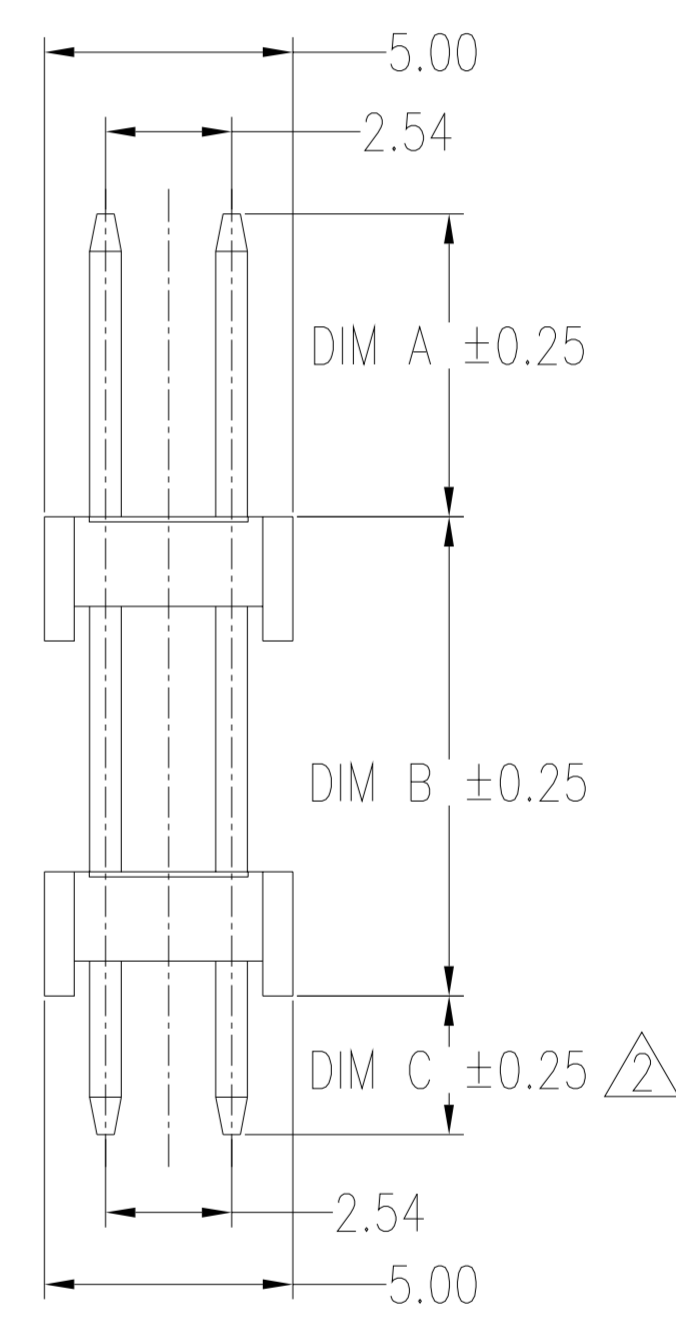
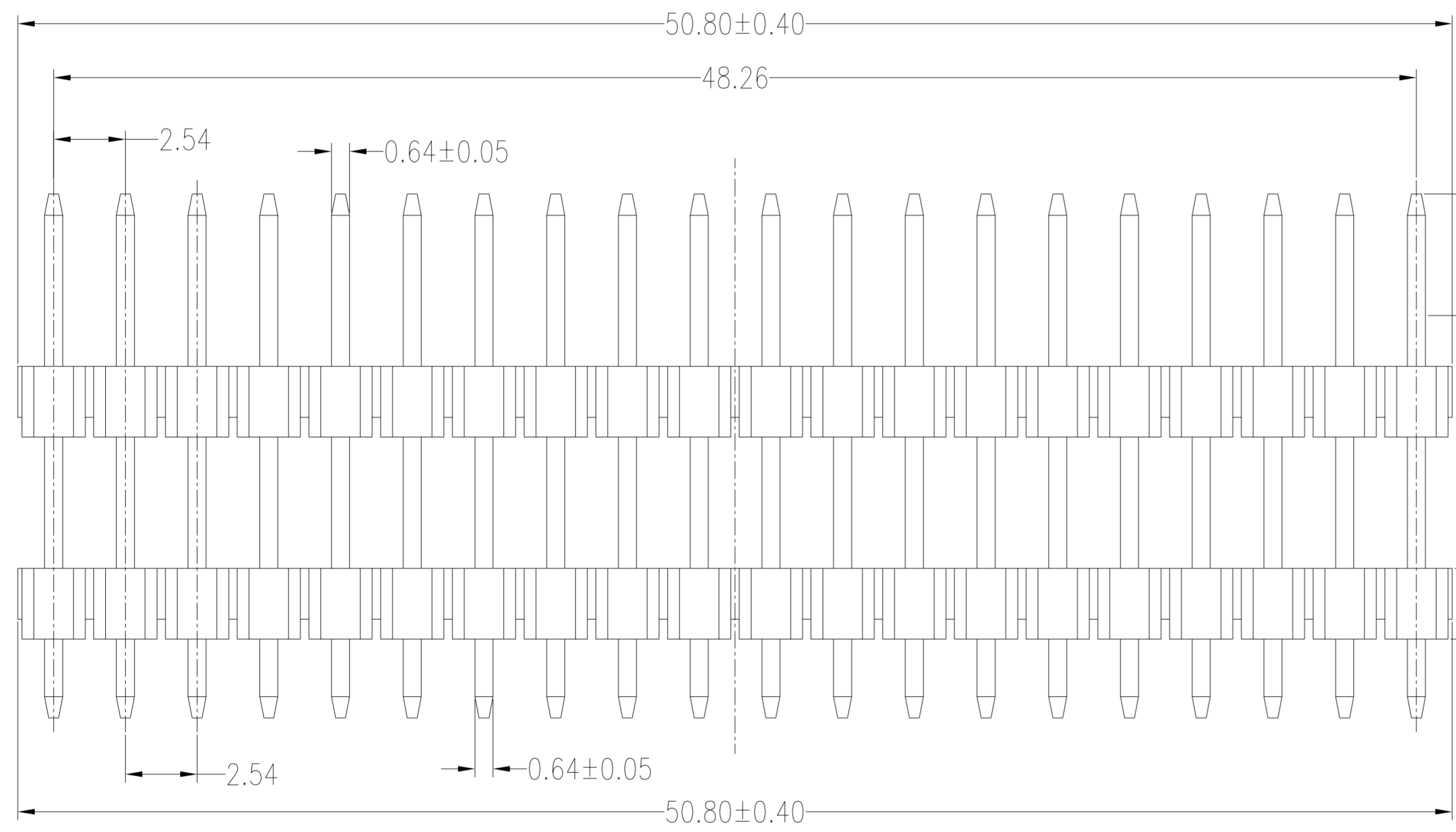

**PRODUCT SPECIFICATION:**  
 1. Rated Current:3.0AMP.  
 2. Contact Resistance:20mΩ Max.  
 3. Withstand Voltage:1000V AC/DC  
 4. Insulation Resistance:1000MΩ Min.  
 5. Operation Temperature:-40℃ to +105℃  
 6. Recommend Soldering Process:  
 Wave Soldering 260°3s  
 7. Packaging: Tube

**MATERIAL:**  
 CONTACT: COPPER ALLOY  
 HOUSING: LOW-TEMPRETURE PLASTIC,  
 UL94V-0 BLACK

**FINISH:**  
 NICKEL UNDERPLATING OVER ALL  
 ▲ GOLD FLASH ON CONTACT AREA  
 ▲ TIN PLATING ON SOLDERING AREA

3.00	15.70	6.30	2271015-2
2.79	9.65	6.10	2271015-1
DIM C	DIM B	DIM A	PN

PRODUCT FAMILY TABLE

THIS DRAWING IS A CONTROLLED DOCUMENT.		DWN ETHAN CHENG 25-NOV-13	TE Connectivity	
DIMENSIONS: mm		CHK KOBBOY ZHAO 26-NOV-13	NAME	
TOLERANCES UNLESS OTHERWISE SPECIFIED:		APVD XU XIANG 27-NOV-13	AMPMODU, 2.54 PITCH, 40 POSITION, PIN HEADER, THROUGH HOLE	
0 PLC ± -		PRODUCT SPEC	SIZE	CAGE CODE
1 PLC ± -		108-137777	A2	00779
2 PLC ± 0.25		APPLICATION SPEC	DRAWING NO	
3 PLC ± -		WEIGHT	©= 2271015	
4 PLC ± -		RESTRICTED TO	-	
ANGLES ± -		CUSTOMER DRAWING	SCALE	SHEET
FINISH		1:1	1 of 1	REV B

4

3

2

1