

NOTES

- ALL DIMENSIONS ARE IN INCHES
[MILLIMETERS]
- DIMENSIONS APPEARING IN TABLE ARE AS FOLLOWS:
a - AS SUPPLIED
b - AFTER UNRESTRICTED RECOVERY
- AS SUPPLIED DIMENSIONS APPEARING IN TABLE ARE FOR UNCOATED PARTS WHEN COATING IS ADDED, ENTRY DIAMETERS WILL BE REDUCED BY 0.06 MAX.

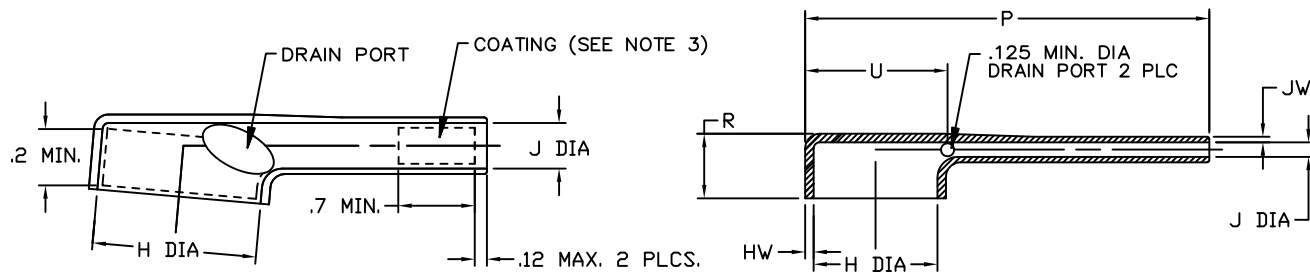

AS SUPPLIED

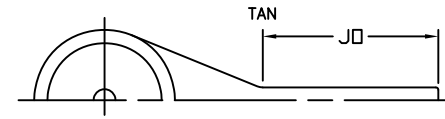

AFTER UNRESTRICTED RECOVERY

DIMENSIONING AND TOLERANCING PER ASME Y14.5M (ISO STANDARDS)		
REVISIONS		
LTR	DESCRIPTION	DATE
A	INITIAL RELEASE PER ECO-12-007620	04/20/2012

ORDERING INFORMATION

BASE PART NUMBER 222D953
 MATERIAL DASH NUMBER -X
 -25 ELASTOMER, FLUID RESISTANT (RW-2070)
 MODIFICATION NUMBER -15
 ADHESIVE SLASH NUMBER /180-0
 SEE COMPATIBILITY CHART BELOW
 COLOR DESIGNATOR

If this document is printed it becomes uncontrolled. Check for the latest revision

TABLE OF DIMENSIONS

PART DESCRIPTION	H		J		P	R	S	T	U	JO	HW	JW
	MIN	MAX	MIN	MAX	±10%	+ 0% -10%	REF	REF	±10%	±10%	±20%	±20%
	a	b	a	b	b	b	b	b	b	b	b	b
222D953-X-15	1.35 [34.2]	1.02 [26.0]	.38 [9.6]	.12 [3.0]	3.20 [81.3]	.45 [11.4]	.12 [3.05]	.04 [1.02]	1.00 [25.4]	1.39 [36.3]	.07 [1.78]	.045 [1.14]

Raychem Molded Parts
CUSTOMER DRAWING

COMPATIBILITY CHART

MATERIAL DASH NO.	ADHESIVE (COATING) SLASH NUMBER	ADHESIVE (COATING) S NUMBER
-25	/180	S-1030

THIS DRAWING AND THE INFORMATION SET FORTH HEREON ARE THE PROPERTY OF TYCO ELECTRONICS CORPORATION, AND ARE TO BE HELD IN TRUST AND CONFIDENCE. PUBLICATION, DUPLICATION, DISCLOSURE OR USE FOR ANY PURPOSE NOT EXPRESSLY AUTHORIZED IN WRITING BY TYCO ELECTRONICS CORPORATION IS PROHIBITED.

UNLESS OTHERWISE SPECIFIED DIMENSIONS ARE METRIC AND INCHES ARE IN BRACKETS. DECIMAL TOLERANCES xxx ± 0.13 (.005) xx ± 0.25 (.01) x ± 0.50 (.10) ANGLE TOLERANCE .x ± 1 DEG.	DRAWN M. Mazariegos 3/20/12	APPROVED D. Hurrell 3/20/12	STE TE Connectivity
TYCO ELECTRONICS RESERVES THE RIGHT TO AMEND THIS DRAWING AT ANY TIME. USERS SHOULD EVALUATE THE SUITABILITY OF THE PRODUCT FOR THEIR APPLICATION.	RPN	CAD FILE: 222D953-X-15_CD	TITLE BOOT 90°
THIRD ANGLE PROJECTION	SIZE B	CODE IDENT. NO. 06090	DWG. NO. 222D953-X-15
© 2012 Tyco Electronics Corporation. All rights reserved.	DO NOT SCALE THIS DRAWING		SHEET 1 OF 1