

REVISIONS				
P. LTR.	DESCRIPTION	DATE	OWN	APVD
I	INITIAL RELEASE	13MAY2014	MDB	MDB
A	RELEASED PER ECO-16-012664	11JAN2017	VP	MDB

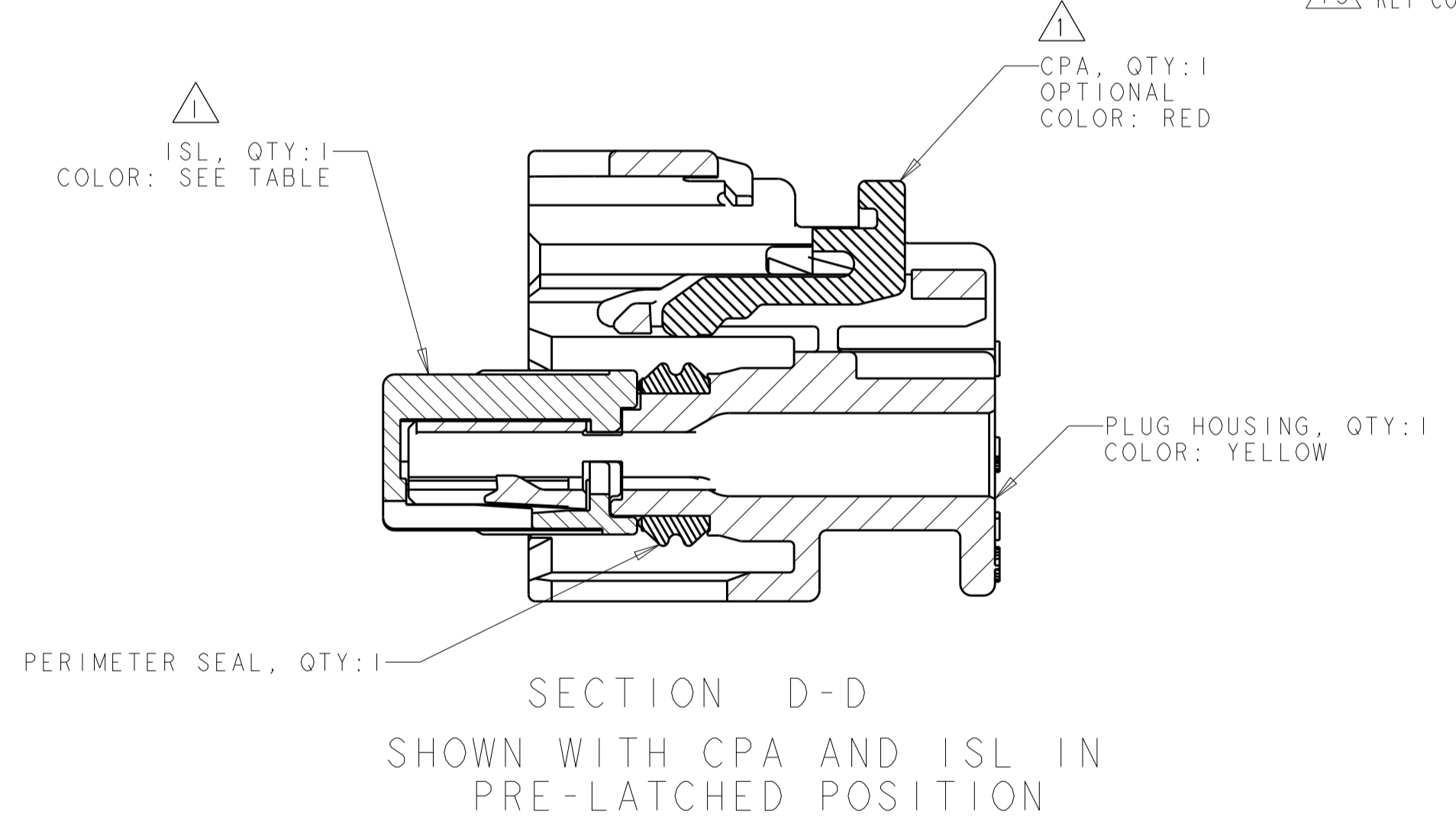

ISL SHOWN IN FINAL (LOCKED) POSITION (REF ONLY)
 SCALE 4:1

ISL SHOWN IN PRE-LATCHED (AS-SHIPED) POSITION
 SCALE 4:1

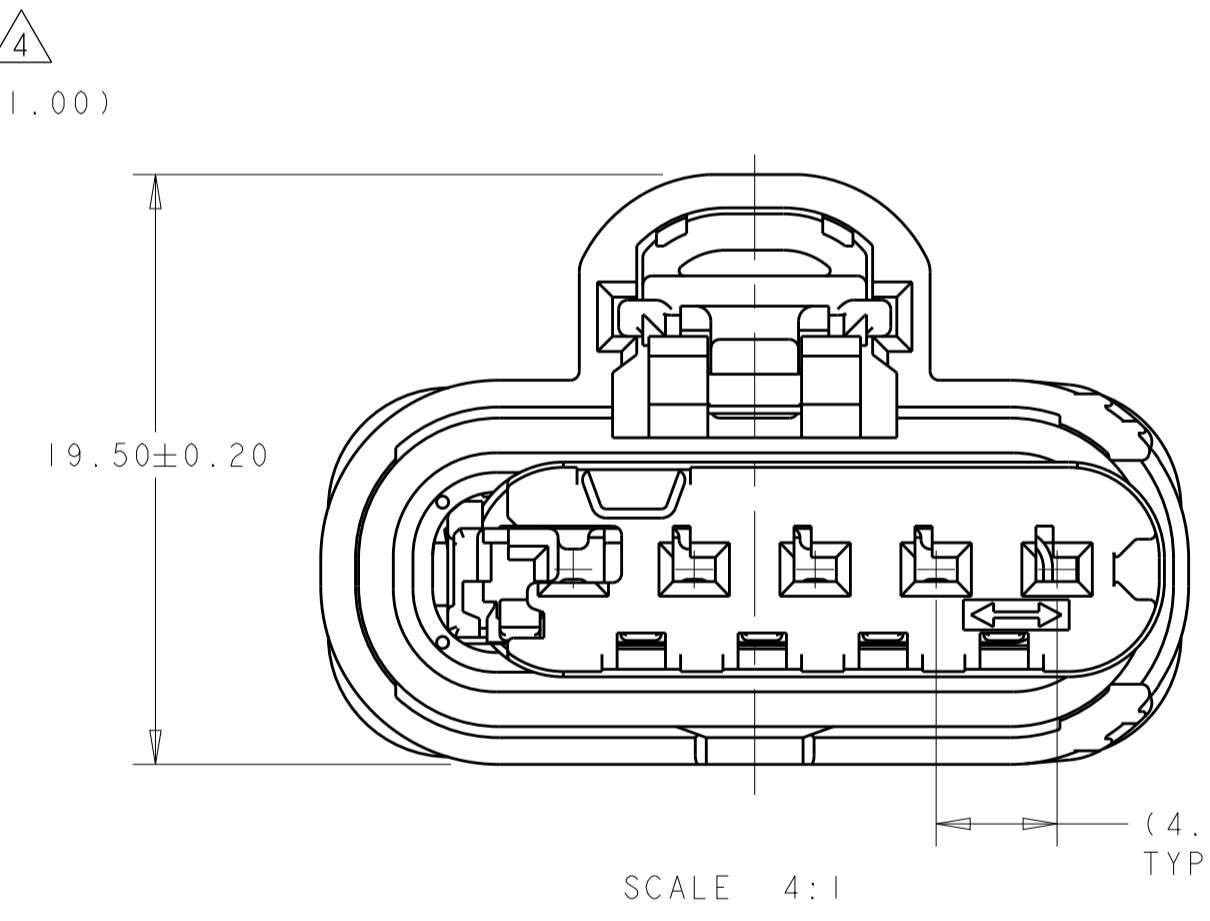
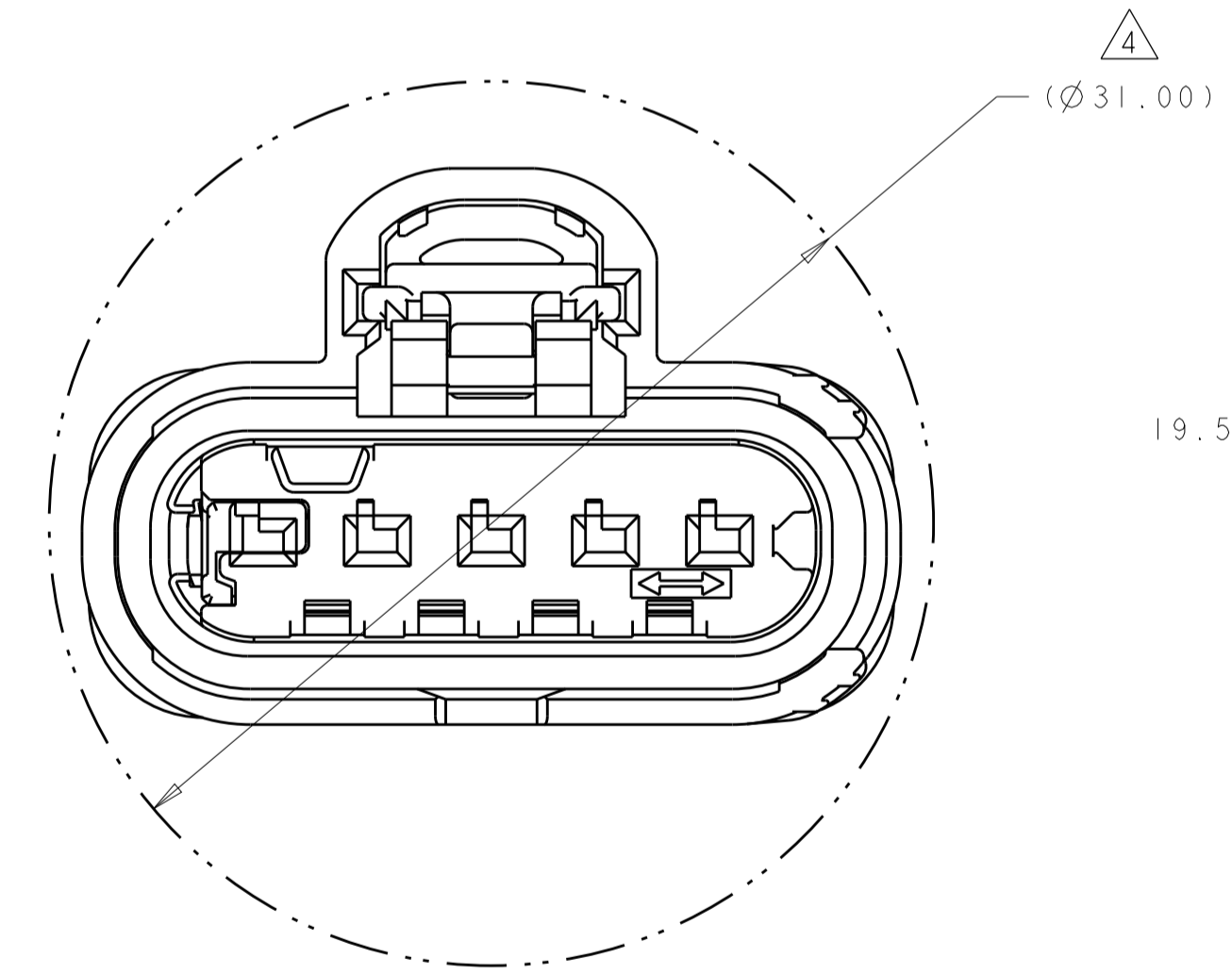
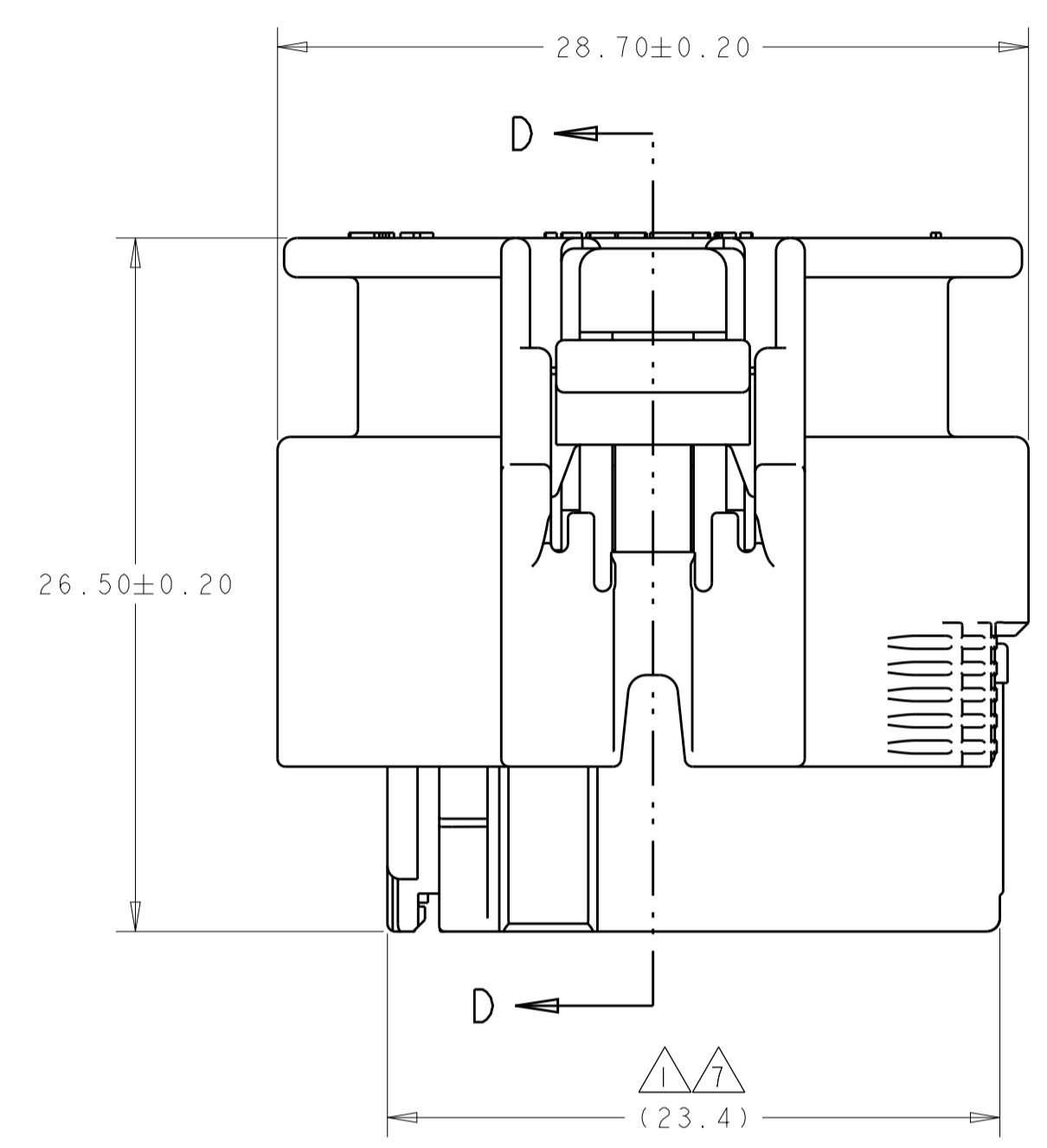
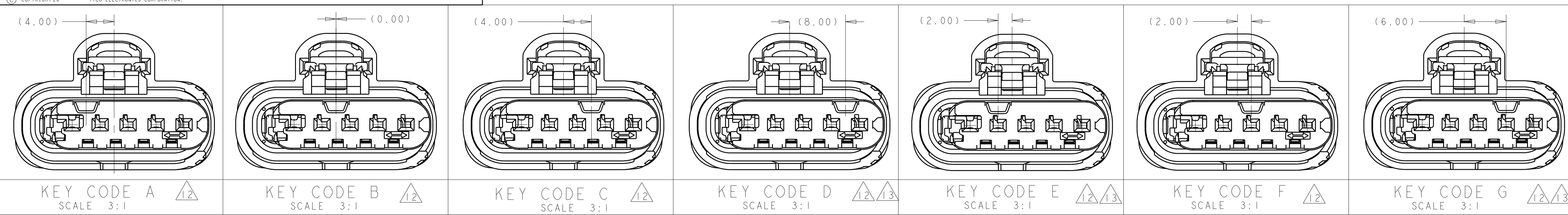
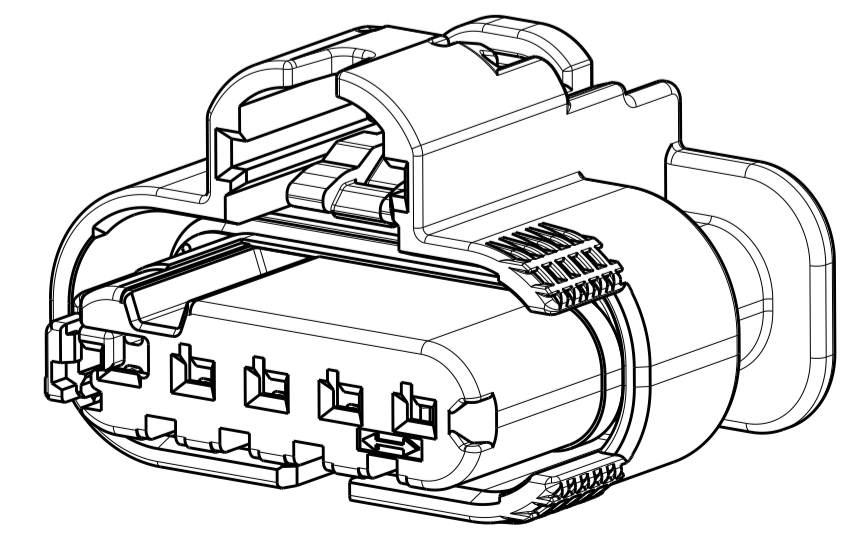
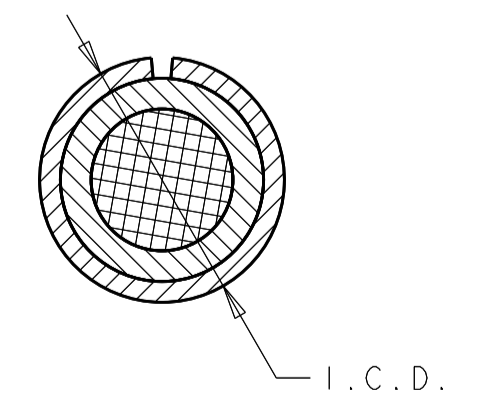
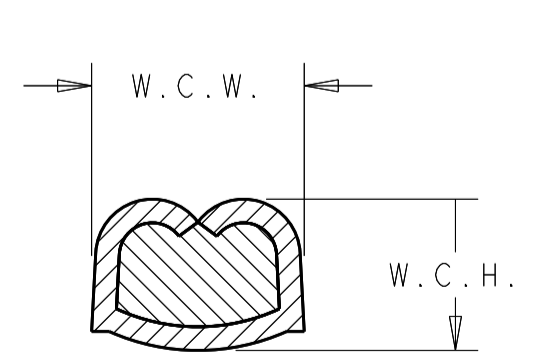

ISOMETRIC VIEW
 SCALE 3:1

- 1. ISL AND CPA (WHEN APPLICABLE) ARE SHIPPED IN THEIR PRE-LATCHED POSITIONS.
- 2. TERMINALS SOLD SEPARATELY. FOR USE WITH TE MCON 1.2mm CLEAN BODY CONTACT AND WIRE SEAL, SEE TABLE.
- 3. APPLICABLE INTERFACE DRAWINGS: EWCAP 120-S-005-1-Z02 AND 120-S-005-1-Z03
- 4. MINIMUM FEED-THROUGH CONDITION WITH 1.0mm CLEARANCE ALL AROUND.
- 5. TRACEABILITY CODE (YY = TWO DIGIT YEAR, JJJ = 3 DIGIT JULIAN DAY, S = 1 DIGIT SHIFT).
- 6. FOR OPTIONAL TERMINAL CAVITY BLOCKING, CONTACT TE SALES REPRESENTATIVE OR CUSTOMER SERVICE.
- 7. SEE INSTRUCTION SHEET 408-32103 FOR CONNECTOR SERVICE AND ISL OPERATION, ISL ACTUATION DISTANCE IS 2.0mm.
- 8. CONTACT PLATING AND APPLICABLE INDIVIDUAL WIRE SEAL ARE APPLICATION DEPENDENT, CONTACT TE SALES REPRESENTATIVE OR CUSTOMER SERVICE FOR DETAILS.
- 9. FOR WIRE CRIMP DETAILS, SEE TE APPLICATION SPECIFICATION 114-18464
- 10. DOCUMENTED I.C.D. IS SPECIFIED TO MEET MOST WIRE SEAL APPLICATIONS. HOWEVER, I.C.D. IS HIGHLY DEPENDENT ON INSULATION TYPE AND O.D. SUFFICIENT GRIP OF THE WIRE SEAL MUST BE OBTAINED SUCH THAT WIRE SEAL DOES NOT DISPLACE FROM INSULATION GRIP DURING CONTACT INSERTION INTO CONNECTOR HOUSING. THE WIRE SEAL SHALL NOT BE CRIMPED TOO TIGHTLY THAT THE WIRE SEAL TEARS DURING THE CRIMPING OPERATION.
- 11. NOTE REMOVED.
- 12. KEY CODE DIMENSIONS ARE SHOWN WITH ISL IN PRE-LATCHED POSITION. FOR DIMENSION OF KEY WITH ISL IN FINAL POSITION, ADJUST SHOWN DIMENSIONS BY 2.0mm.
- 13. KEY CODE NOT TOOLED.

BLACK	G	13	2203810-7
DARK GRAY	F		2203810-6
LIGHT GRAY	E	13	2203810-5
BLACK	D	13	2203810-4
DARK GRAY	C		2203810-3
LIGHT GRAY	B		2203810-2
BLACK	A		2203810-1
ISL COLOR	KEYING CONFIGURATION		PART NUMBER

125°C	1418844	1.40 - 1.90mm	9	9	9/10	967067-1
	1670146	1.40 - 1.90mm				967067-1
	1418850	1.90 - 2.40mm				964972-1
MAX TEMP	FEMALE TERMINAL P/N	APPLICABLE WIRE FINISHED O.D.	W.C.H	W.C.W	I.C.D	WIRE SEAL PART NUMBER

THIS DRAWING IS A CONTROLLED DOCUMENT.

DIMENSIONS: mm

TOLERANCES UNLESS OTHERWISE SPECIFIED:

0 PLC	±	
1 PLC	±0.3	
2 PLC	±0.15	
3 PLC	±	
4 PLC	±	
ANGLES	±	
FINISH		

MATERIAL: -

FINISH: -

TE Connectivity

CONNECTOR ASSEMBLY, FEMALE, SEALED, 5 POSITION MCON SIR

SIZE: A100779C=2203810

SCALE: 5:1 SHEET: 1 OF 1 REV: A