

LOC	DIST	REVISIONS					
A1		P	LTR	DESCRIPTION	DATE	DWN	APVD
PRODUCT NO.:		1		INITIAL DRAWING	21JUL2011	VA	MM
		A		DRAWING IS ACTIVATED	03DEC2013	SMD	SSI

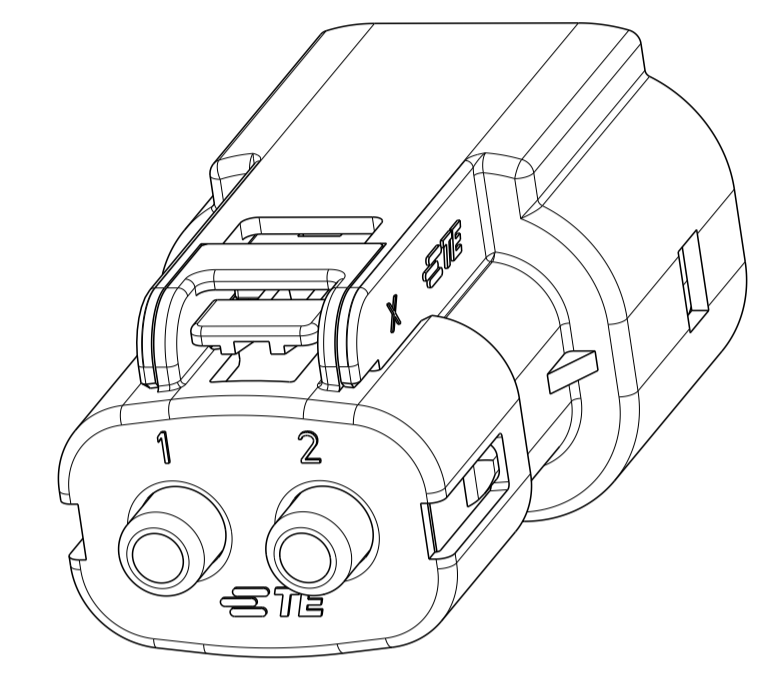
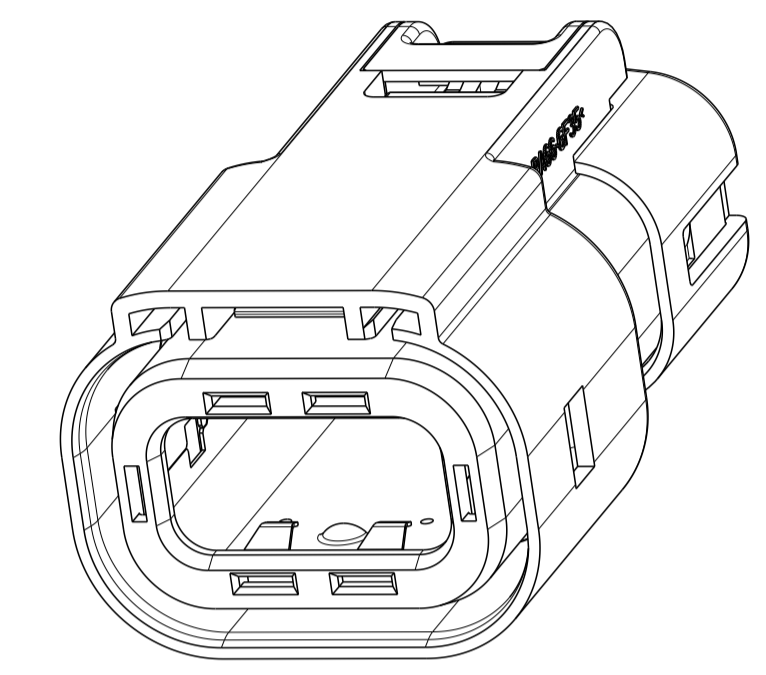
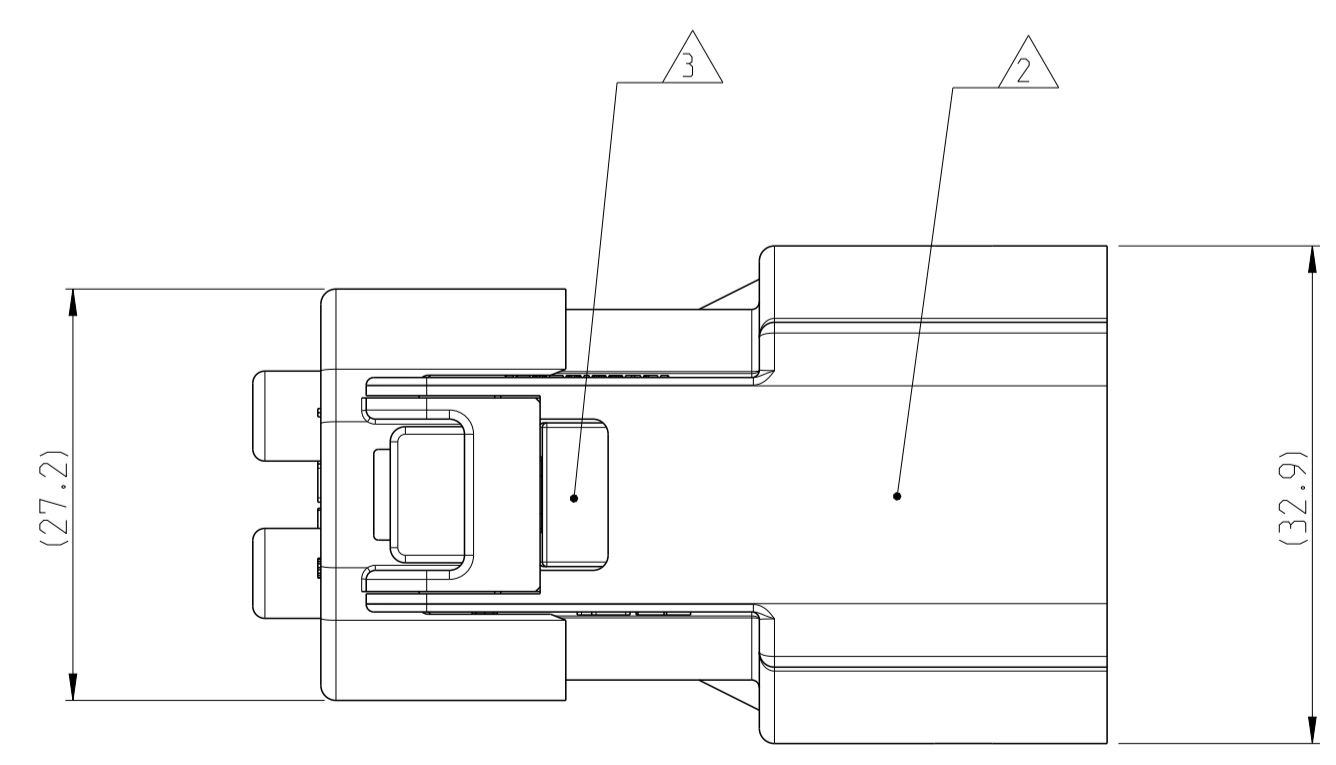
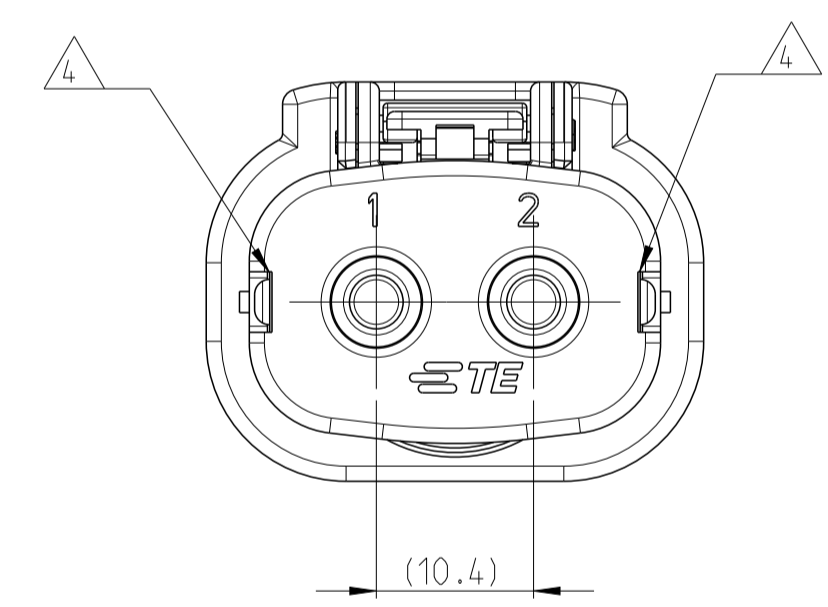
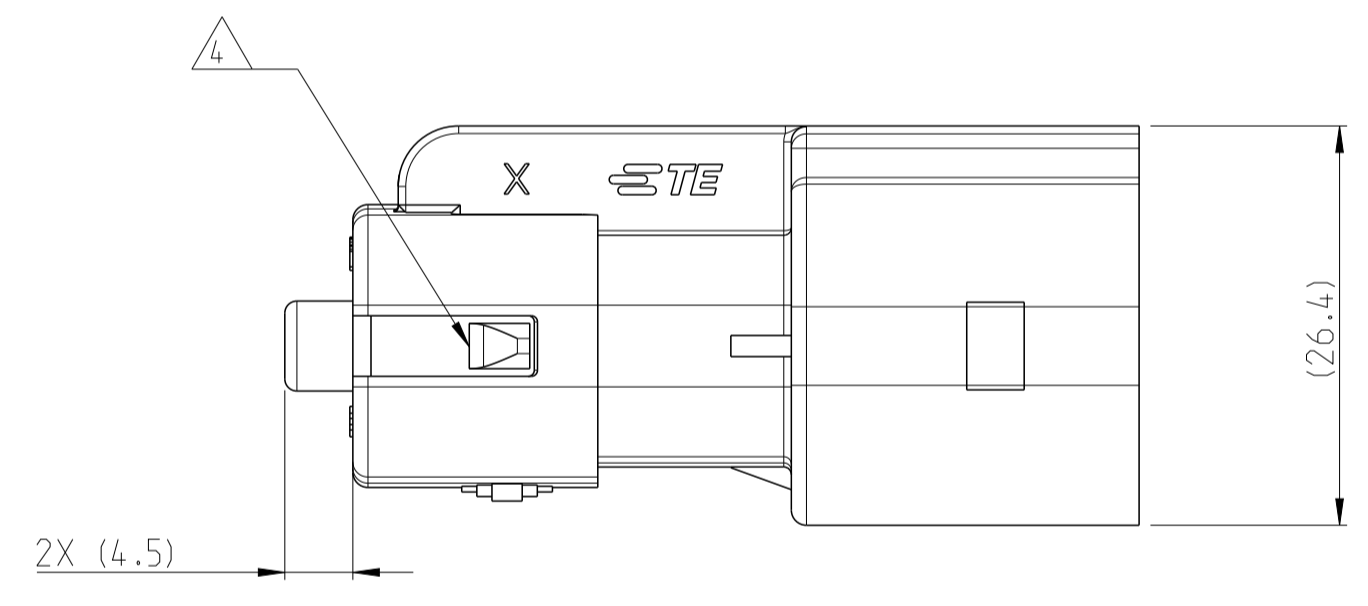
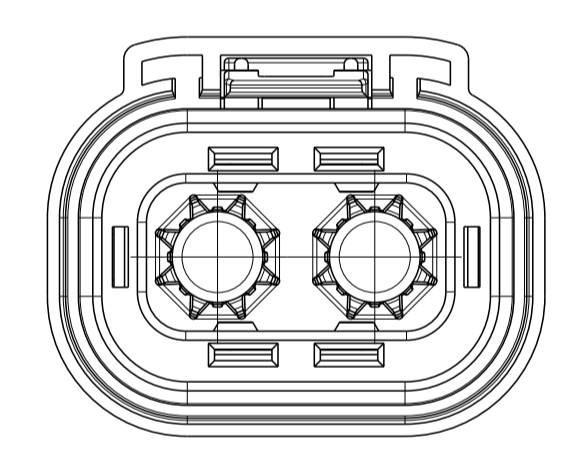
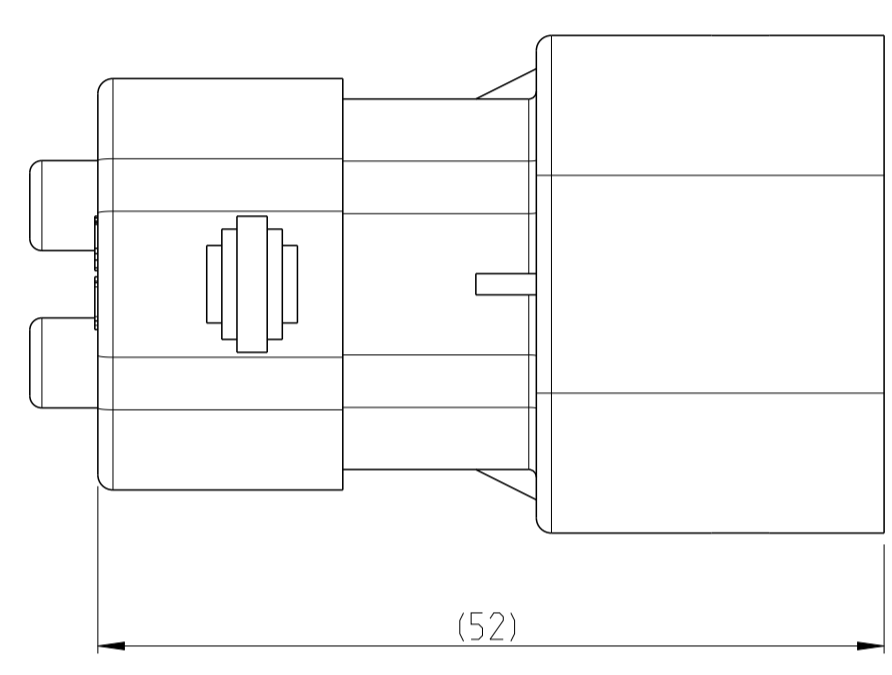
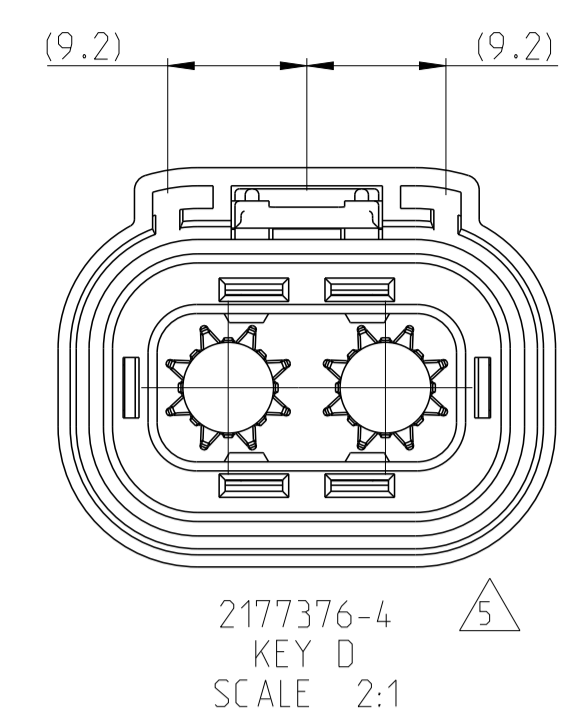
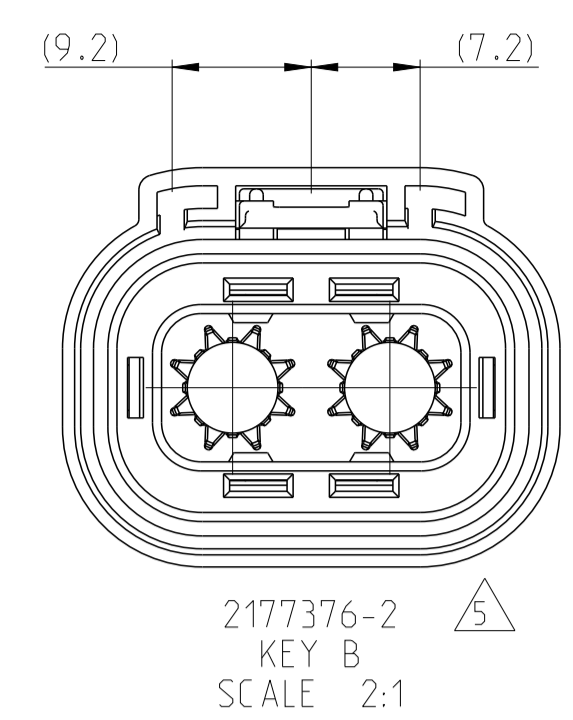
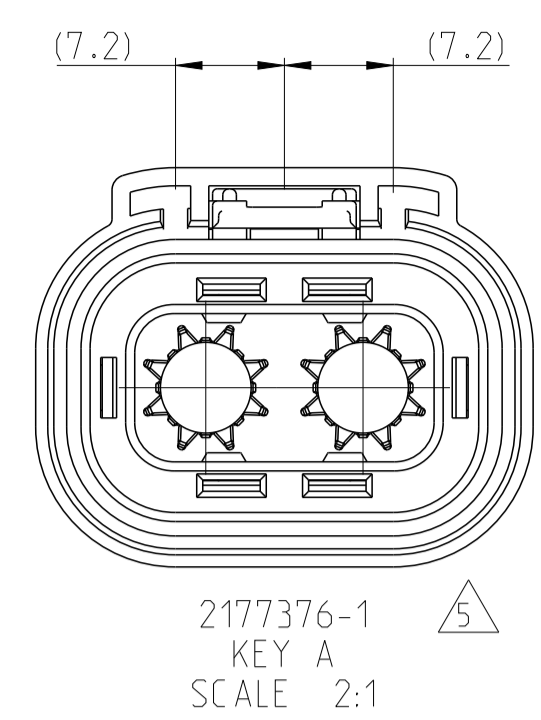

- CONNECTOR MUST BE FREE OF ANY MECHANICAL DEFECTS WHICH MAY AFFECT FIT, FORM, OR PERFORMANCE
 Stecker muss frei von irgendwelchen mechanischen Defekten, welche die Form, Kontur oder Funktion beeinträchtigen könnten
- PLUG SUB ASSEMBLY PART NUMBER AND JULIAN DATE CODE MARKED IN THIS AREA
 Teilenummer der Sub-Assy und julianischer Datumscode ist an dieser Stelle angebracht
- FLOATING LATCH MUST BE FULLY INSTALLED AS SHOWN
 Die bewegliche Lasche muss vollständig (eindeutig) installiert sein wie gezeigt
- WIRE SEAL RETAINER MUST BE FULLY LOCKED IN TWO LOCATIONS INTO OUTER HOUSING.
 Kappe fuer Kabel-Dummy muss an beiden Stellen des Aussengehaeusens vollständig verriegelt sein
- PRELIMINARY PART—NOT RELEASED FOR PRODUCTION
 vorlaeufiges Teil - noch nicht zur Herstellung / Produktion freigegeben

0- -1 AS SHOWN
 wie gezeichnet

1	PLUG, KEY D, HVA280	2177376-4
2	PLUG, KEY B, HVA280	2177376-2
3	PLUG, KEY A, HVA280	2177376-1
DESCRIPTION		PART NO

DIESE ZEICHNUNG IST EIN KONTROLLIERTES DOKUMENT. BEMASSUNGEN UND TOLERANZEN GEMAESS GPS (ISO STANDARDS).		DWN: Vishwa A 21JUL2011	
THIS DRAWING IS A CONTROLLED DOCUMENT. DIMENSIONING AND TOLERANCING PER GPS (ISO STANDARDS)		CHK: U.Hoedinger 21JUL2011	
DIMENSIONS: MASSENHEITEN MM	TOLERANCES UNLESS OTHERWISE SPECIFIED: ALLGEMEINTOLERANZEN	APVD: M.Mueller	NAME
0 PLC ±	1 PLC ±0.2	PRODUCT SPEC	3POS.PLUG TERM.HSG.ASSY.SEALED
2 PLC ±0.1	3 PLC ±0.013	PRODUCT SPEC	
4 PLC ±0.0001	ANGLES/DIMEL ±	APPLICATION SPEC	
MATERIAL	FINISH/BOERLECHE/FARBE	WEIGHT GEWICHT	RESTRICTED TO NUR FÜR
		Customer Drawing	
SIZE: A1		CAGE CODE: 00779	DRAWING NO: 2177376
SCALE: 2:1		SHEET: 1	OF: 1
REV: A			