

P	LTR	DESCRIPTION	DATE	DWN	APVD
	BA	NEW DRAWING RELEASE	18AUG2023	DM	AP

FOR FURTHER INFORMATION SEE DATA SHEET FOR
MINIATURE SMD POWER INDUCTOR TYPE 3627 SERIES

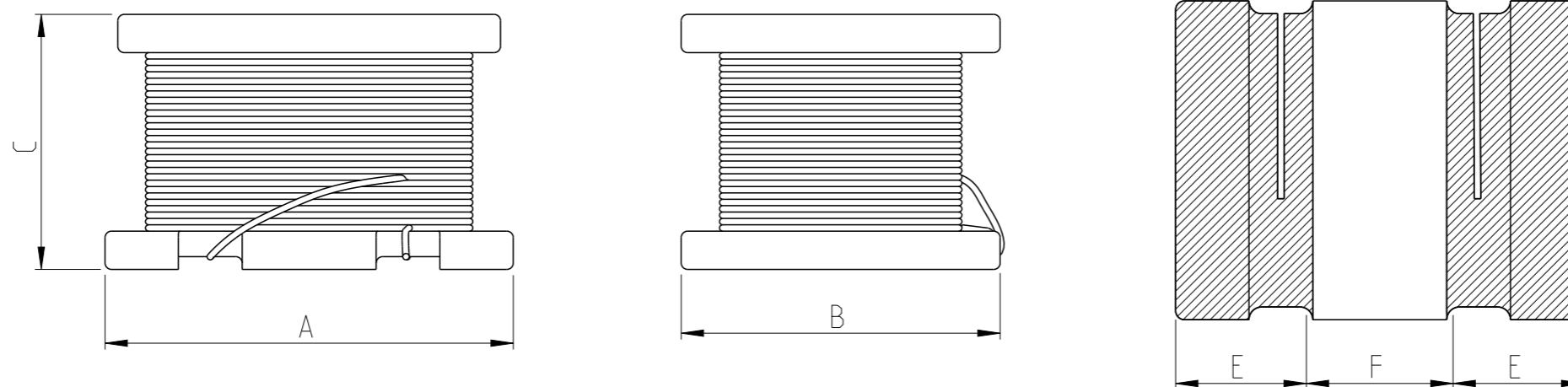

A	B	C	E	F
3.2±0.3	2.5±0.2	2.0±0.3	0.7 min.	0.7 min.

RoHS Compliant

RECOMMENDED LAND PATTERN

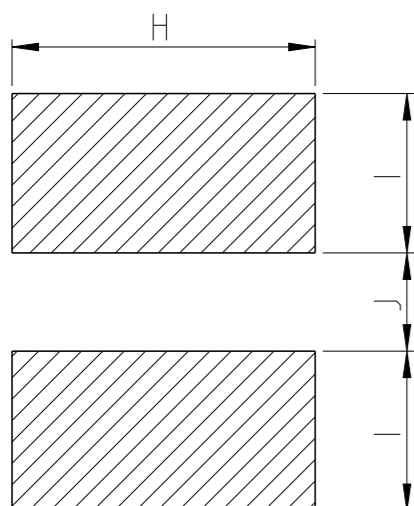

H	I	J
2.0	1.5	1.0

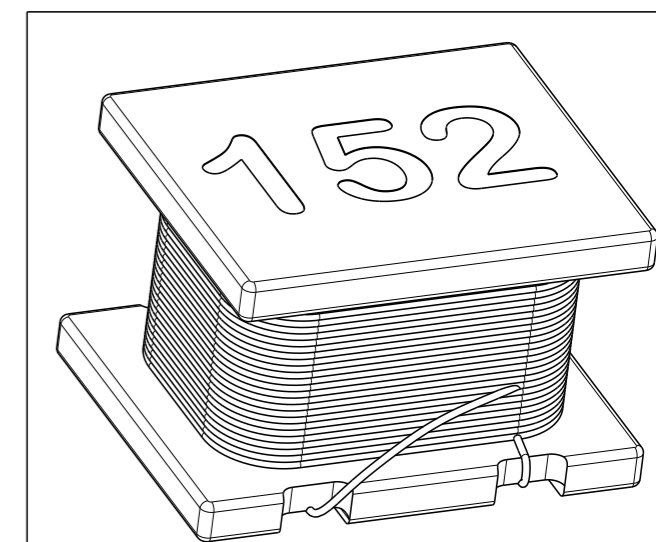

THIS DRAWING IS A CONTROLLED DOCUMENT.

DIMENSIONS:	TOLERANCES UNLESS OTHERWISE SPECIFIED:
mm	
	0 PLC ±
	1 PLC ±
	2 PLC ±
	3 PLC ±
	4 PLC ±
	ANGLES ±
MATERIAL	FINISH
-	-
-	-

DWN	DHEERAJ M	18AUG2023
CHK	TRACY G	18AUG2023
APVD	ALLAN P	18AUG2023
PRODUCT SPEC	-	-
APPLICATION SPEC	-	-
WEIGHT	-	-
CUSTOMER DRAWING		



NAME
MINIATURE SMD POWER INDUCTOR
TYPE 3627 322520 SERIES

SIZE	CAGE CODE	DRAWING NO	RESTRICTED TO
A3	00779	C=2176636-C	-
SCALE	20:1	SHEET	1 OF 3
REV	BA		

REVISIONS

P	LTR	DESCRIPTION	DATE	DWN	APVD
-		SEE SHEET 1	-	-	-

SCHEDULE

TCPN	CATALOGUE NUMBER	PART DESCRIPTION	PART STATUS
2176636-1	3627 322520 1R0 20%	3627 322520 1R0 20%	PRODUCTION
2176636-2	3627 322520 1R2 20%	3627 322520 1R2 20%	PRODUCTION
2176636-3	3627 322520 1R5 10%	3627 322520 1R5 10%	PRODUCTION
2176636-4	3627 322520 1R8 10%	3627 322520 1R8 10%	PRODUCTION
2176636-5	3627 322520 2R2 10%	3627 322520 2R2 10%	PRODUCTION
2176636-6	3627 322520 2R7 10%	3627 322520 2R7 10%	PRODUCTION
2176636-7	3627 322520 3R3 10%	3627 322520 3R3 10%	PRODUCTION
2176636-8	3627 322520 3R9 10%	3627 322520 3R9 10%	PRODUCTION
2176636-9	3627 322520 4R7 10%	3627 322520 4R7 10%	PRODUCTION
1-2176636-0	3627 322520 5R6 10%	3627 322520 5R6 10%	PRODUCTION
1-2176636-1	3627 322520 6R8 10%	3627 322520 6R8 10%	PRODUCTION
1-2176636-2	3627 322520 8R2 10%	3627 322520 8R2 10%	PRODUCTION
1-2176636-3	3627 322520 10UH 10%	3627 322520 100 10%	PRODUCTION
1-2176636-4	3627 322520 12UH 10%	3627 322520 120 10%	PRODUCTION
1-2176636-5	3627 322520 15UH 10%	3627 322520 150 10%	PRODUCTION
1-2176636-6	3627 322520 18UH 10%	3627 322520 180 10%	PRODUCTION
1-2176636-7	3627 322520 22UH 10%	3627 322520 220 10%	PRODUCTION

THIS DRAWING IS A CONTROLLED DOCUMENT.

DIMENSIONS:
mm

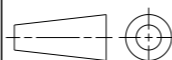

TOLERANCES UNLESS OTHERWISE SPECIFIED:

- 0 PLC ±
- 1 PLC ±
- 2 PLC ±
- 3 PLC ±
- 4 PLC ±
- ANGLES ±

MATERIAL

-

FINISH

-

DWN 18AUG2023

DHEERAJ M

CHK 18AUG2023

TRACY G

APVD 18AUG2023

ALLAN P

PRODUCT SPEC

-

APPLICATION SPEC

-

WEIGHT

-

CUSTOMER DRAWING



TE Connectivity

NAME
MINIATURE SMD POWER INDUCTOR
TYPE 3627 322520 SERIES

SIZE CAGE CODE DRAWING NO RESTRICTED TO

A3 00779 C=2176636-C -

SCALE 20:1 SHEET 2 OF 3 REV BA

REVISIONS

P	LTR	DESCRIPTION	DATE	DWN	APVD
-		SEE SHEET 1	-	-	-

SCHEDULE

TCPN	CATALOGUE NUMBER	PART DESCRIPTION	PART STATUS
1-2176636-8	3627 322520 27UH 10%	3627 322520 270 10%	PRODUCTION
1-2176636-9	3627 322520 33UH 10%	3627 322520 330 10%	PRODUCTION
2-2176636-0	3627 322520 39UH 10%	3627 322520 390 10%	PRODUCTION
2-2176636-1	3627 322520 47UH 10%	3627 322520 470 10%	PRODUCTION
2-2176636-2	3627 322520 56UH 10%	3627 322520 560 10%	PRODUCTION
2-2176636-3	3627 322520 68UH 10%	3627 322520 680 10%	PRODUCTION
2-2176636-4	3627 322520 82UH 10%	3627 322520 820 10%	PRODUCTION
2-2176636-5	3627 322520 100UH 10%	3627 322520 101 10%	PRODUCTION
2-2176636-6	3627 322520 120UH 10%	3627 322520 121 10%	PRODUCTION
2-2176636-7	3627 322520 150UH 10%	3627 322520 151 10%	PRODUCTION
2-2176636-8	3627 322520 180UH 10%	3627 322520 181 10%	PRODUCTION
2-2176636-9	3627 322520 220UH 10%	3627 322520 221 10%	PRODUCTION
3-2176636-0	3627 322520 270UH 10%	3627 322520 271 10%	PRODUCTION
3-2176636-1	3627 322520 330UH 10%	3627 322520 331 10%	PRODUCTION
3-2176636-2	3627 322520 390UH 10%	3627 322520 391 10%	PRODUCTION
3-2176636-3	3627 322520 470UH 10%	3627 322520 471 10%	PRODUCTION
3-2176636-4	3627 322520 560UH 10%	3627 322520 561 10%	PRODUCTION

THIS DRAWING IS A CONTROLLED DOCUMENT.

DIMENSIONS: mm	
MATERIAL -	

TOLERANCES UNLESS OTHERWISE SPECIFIED:	
0 PLC	±
1 PLC	±
2 PLC	±
3 PLC	±
4 PLC	±
ANGLES	±
FINISH	-

DWN	DHEERAJ M	18AUG2023
CHK	TRACY G	18AUG2023
APVD	ALLAN P	18AUG2023
PRODUCT SPEC	-	
APPLICATION SPEC	-	
WEIGHT	-	
CUSTOMER DRAWING		



NAME MINIATURE SMD POWER INDUCTOR TYPE 3627 322520 SERIES			
SIZE	CAGE CODE	DRAWING NO	RESTRICTED TO
A3	00779	©=2176636-C	-
SCALE		SHEET	REV
20:1		3 OF 3	BA