

LOC	DIST	REVISIONS			
ES	00	REV	DATE	BY	APPD
		1	PRELIMINARY	21DEC2011	KS AC

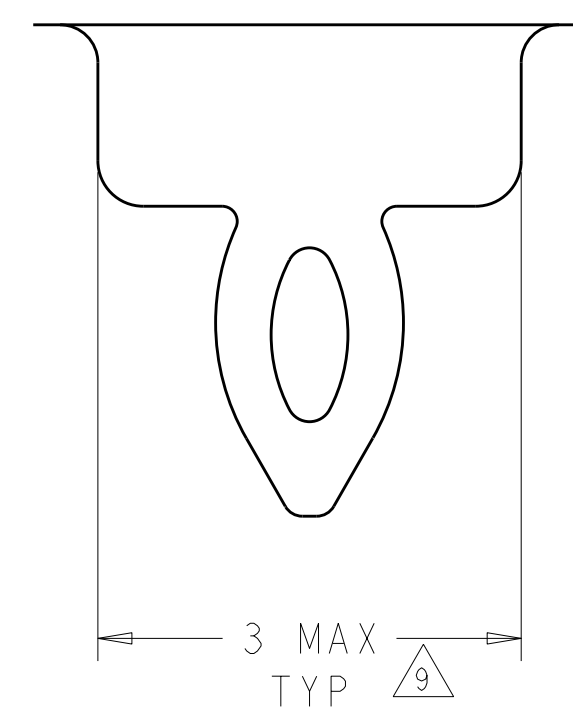

DETAIL J  
SCALE 20:1

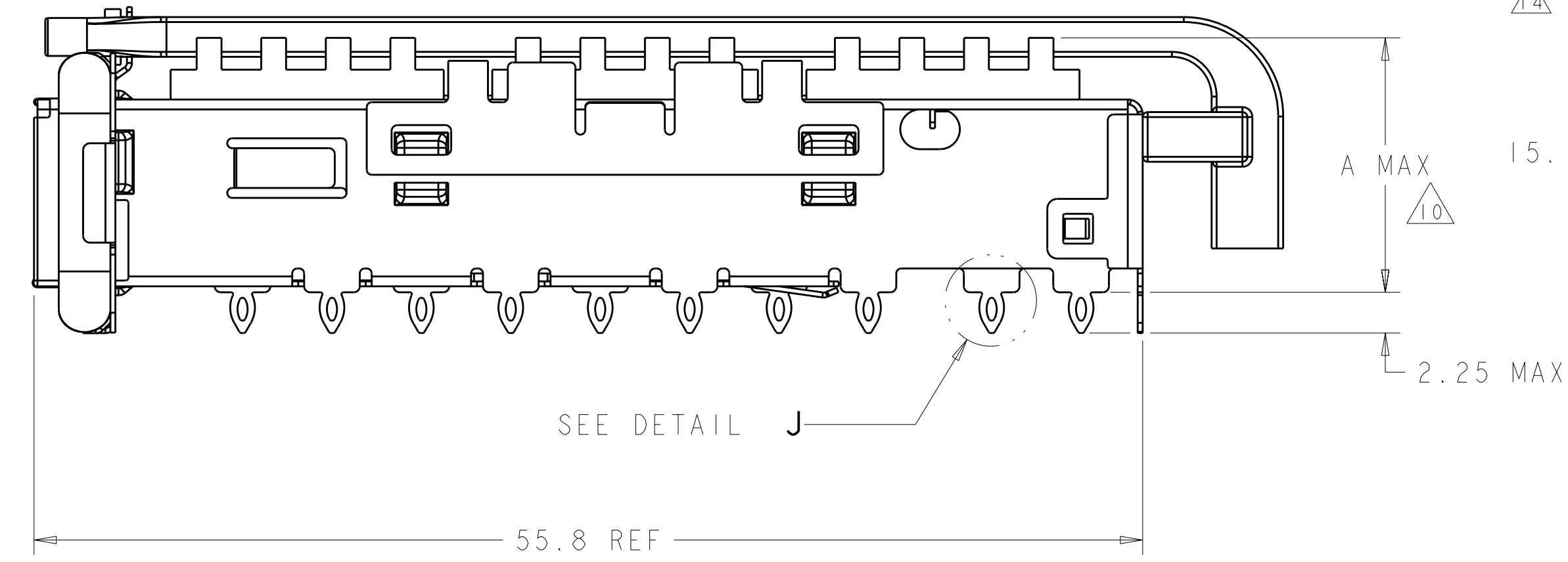
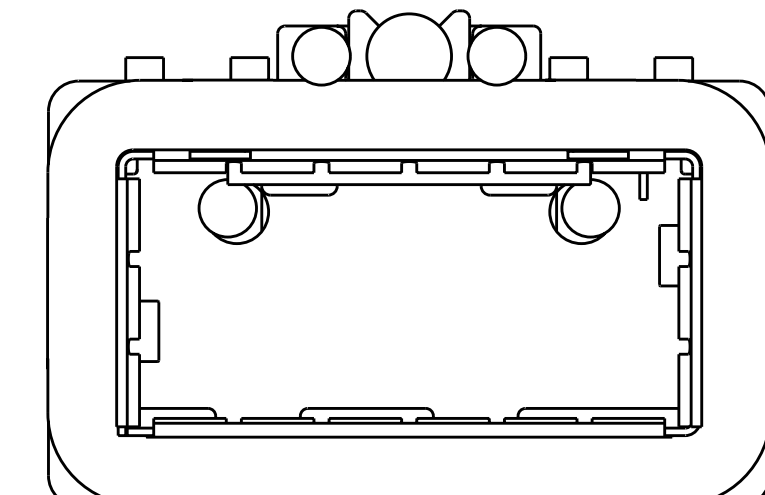
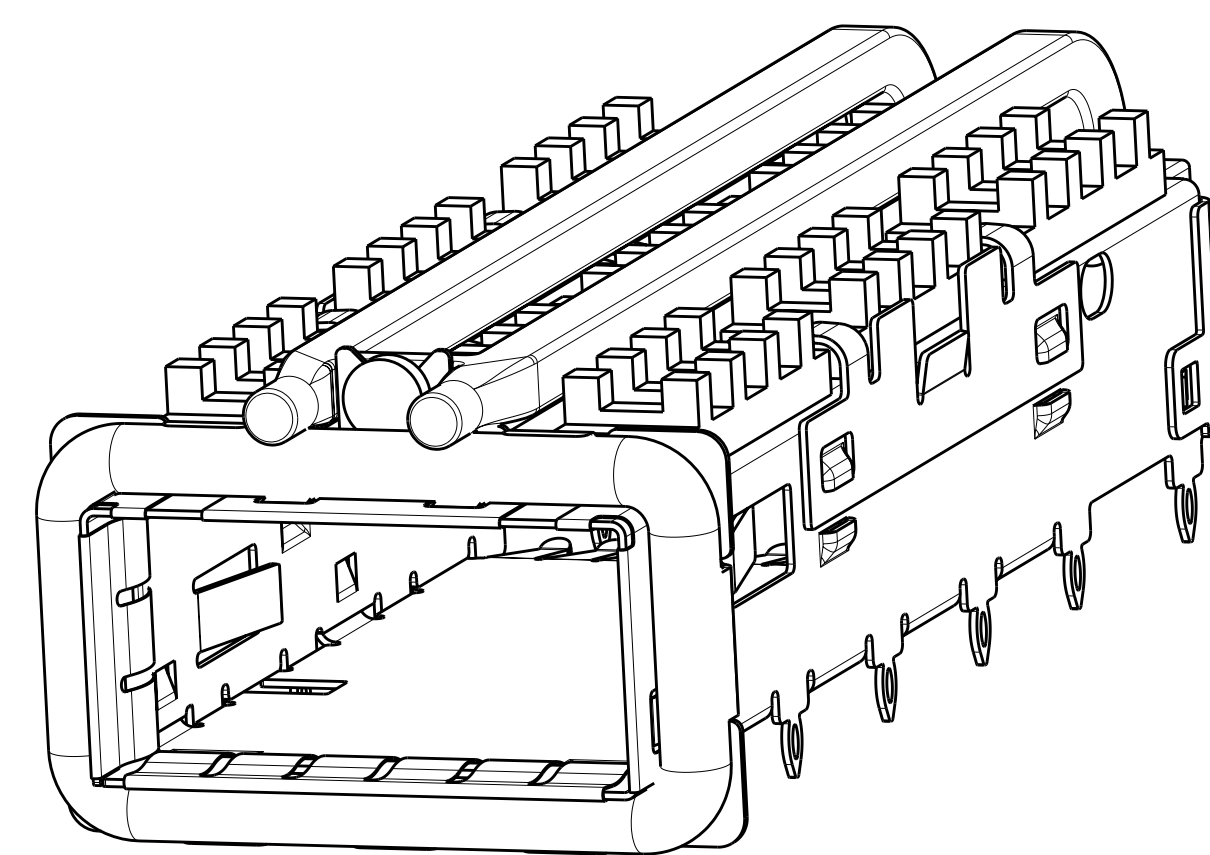
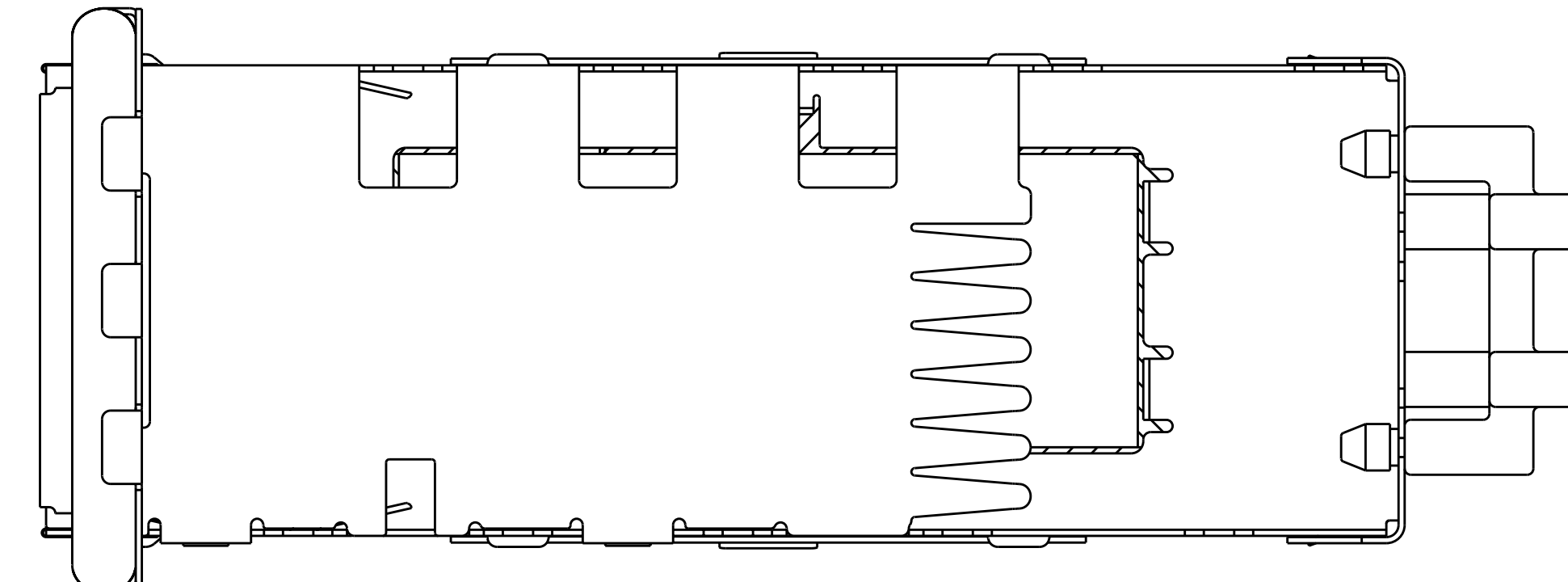

- 1. CAGE MATERIAL: NICKEL SILVER, 0.25 THICK  
 HEAT SINK MATERIAL: ALUMINUM  
 HEAT SINK CLIP MATERIAL: STAINLESS STEEL  
 LIGHT PIPE MATERIAL: CLEAR POLYCARBONATE, UL-94V-0 RATED.  
 EMI SPRING MATERIAL: COPPER ALLOY
- 2. MINIMUM PITCH DIMENSION.
- 3. MATES WITH QSFP MSA COMPATIBLE TRANSCEIVER.
- 4. REFERENCE APPLICATION SPEC 114-13217 FOR RECOMMENDED DRILL HOLE DIAMETER AND PLATING THICKNESS.
- 5. DATUMS AND BASIC DIMENSIONS ESTABLISHED BY CUSTOMER.
- 6. MINIMUM PC BOARD THICKNESS:  
 SINGLE SIDED = 1.45mm (shown, pg. 4)  
 DOUBLE SIDED = 2.2mm
- 7. HEAT SINK, CLIP, AND LIGHT PIPE SHIPPED ASSEMBLED TO CAGE ASSEMBLY. CAGE ASSEMBLY MAY BE PRESSED INTO THE PCB AS SHIPPED.
- 8. DATUM -A- IS TOP SURFACE OF HOST BOARD.
- 9. SURFACE TRACES PERMITTED WITHIN THIS AREA EXCEPT WHERE CAGE STANDOFFS, SHOWN IN DETAIL J, CONTACT PC BOARD.
- 10. DIMENSION APPLIES WITH MODULE INSTALLED IN THE CAGE TO TOP OF HEAT SINK.
- 11. MAXIMUM HEIGHT OF CUSTOMER SUPPLIED LED OFF PC BOARD: 1.70mm.
- 12. DATE CODE (YYWWD) MARKED ON TOP OF CAGE AND CONCEALED BY HEAT SINK APPLIES TO CAGE ASSEMBLY ONLY.
- 13. SPRING FINISH: MATT TIN 2µm MIN, NON-PLATED EDGES PERMISSIBLE.
- 14. HEAT SINK AND CLIP SHIPPED ASSEMBLED TO CAGE ASSEMBLY. CAGE ASSEMBLY MAY BE PRESSED INTO THE PCB AS SHIPPED. LIGHT PIPE MUST BE ASSEMBLED BY CUSTOMER AFTER THE CAGE IS SEATED ON THE PCB.
- 15. PRODUCT HAS NOT COMPLETED QUALIFICATION TESTING.

DESIGN APPROVED THIS PRINT IS  
**PRELIMINARY**  
 TO FIRST PIECE APPROVAL  
 CONTACT PRODUCT ENGINEERING  
 BEFORE USING THIS PRINT

DESCRIPTION	PART NUMBER
23.0 NETWORKING HEAT SINK	2170227-3
16.0 SAN HEAT SINK	2170227-2
13.7 PCI HEAT SINK	2170227-1

THIS DRAWING IS A CONTROLLED DOCUMENT.		DWN: R. SUN 21DEC2011	TE Connectivity
DIMENSIONS: mm		CHK: D. ZHU 21DEC2011	
TOLERANCES UNLESS OTHERWISE SPECIFIED:		APPD: ALEY CAI 21DEC2011	NAME: CAGE ASSEMBLY, THRU BEZEL, QSFP, W/ HEAT SINK, EMI GASEKT AND DUAL LIGHT PIPE
0 PLC ±.5 1 PLC ±0.5 2 PLC ±0.13 3 PLC ±0.013 4 PLC ±0.001 ANGLES ±.		PRODUCT SPEC: 108-2286 APPLICATION SPEC: 114-13217	
MATERIAL:		WEIGHT: -	RESTRICTED TO: -
FINISH: -		CUSTOMER DRAWING	SCALE: 4:1 SHEET 1 OF 4 REV

LOC	DIST	REV	DATE	BY	APPD
ES	00				
		1			

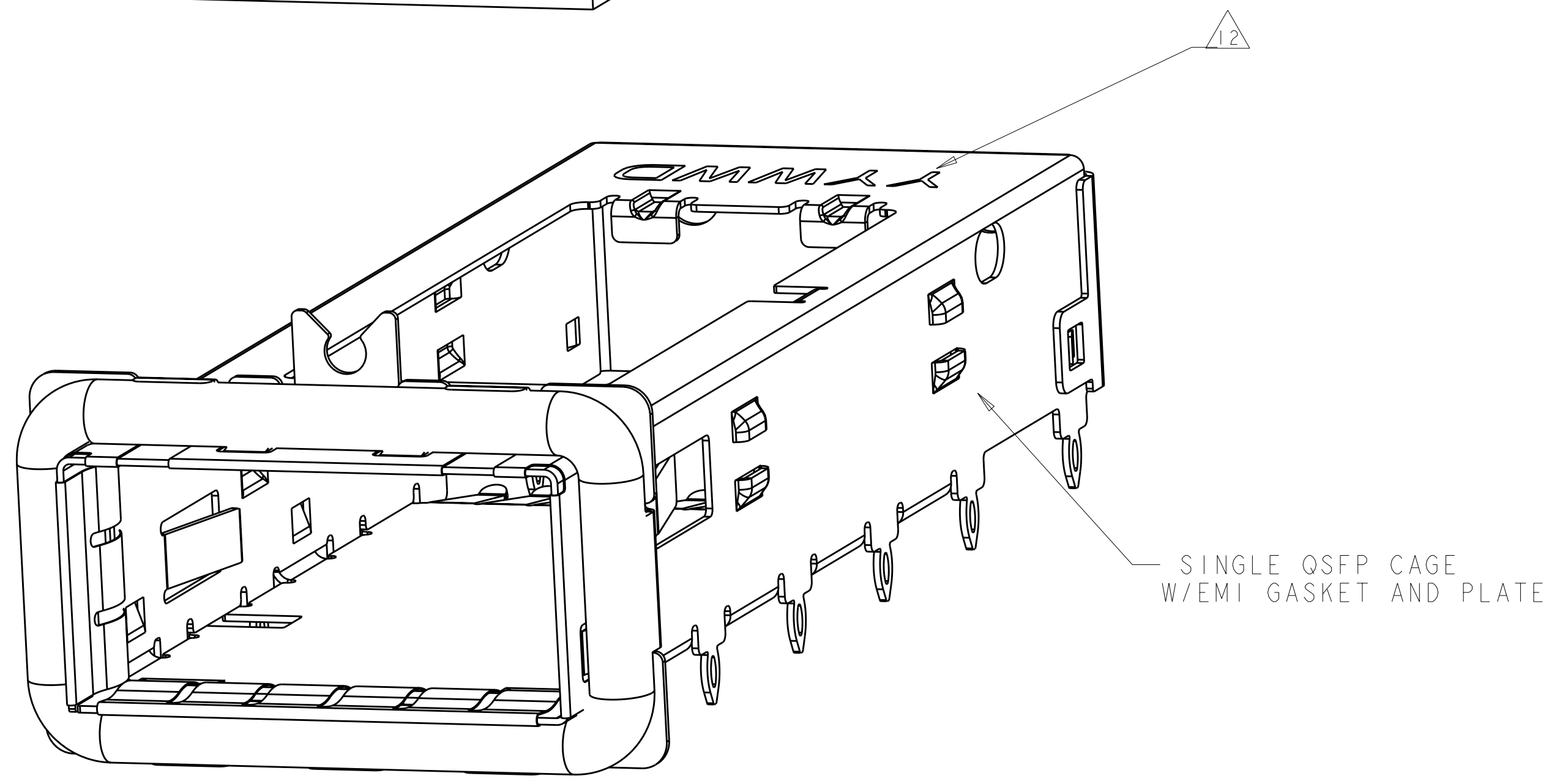
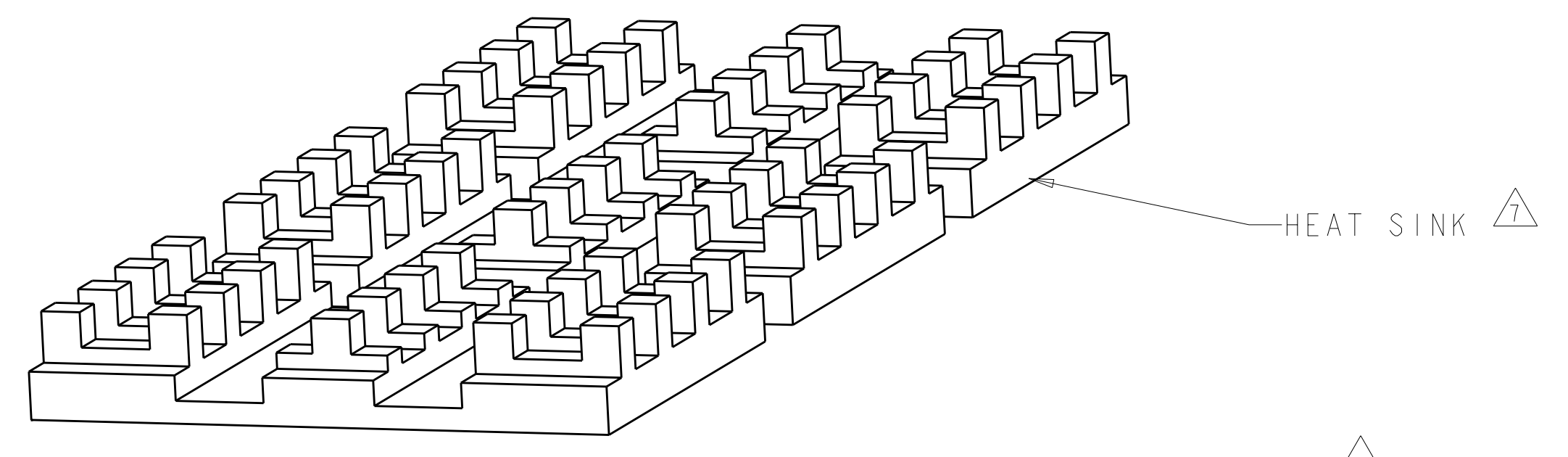
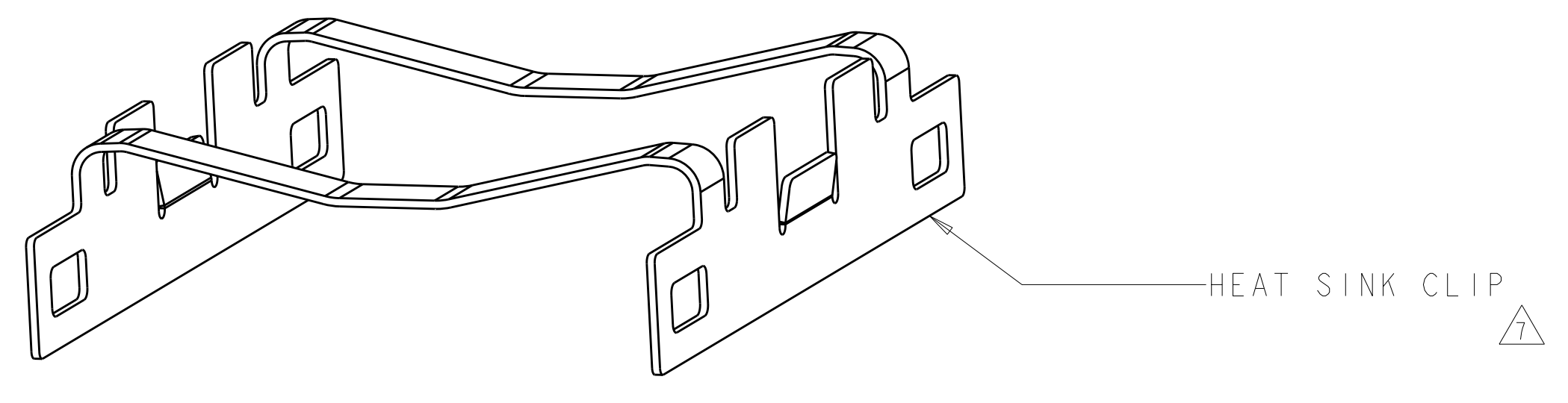
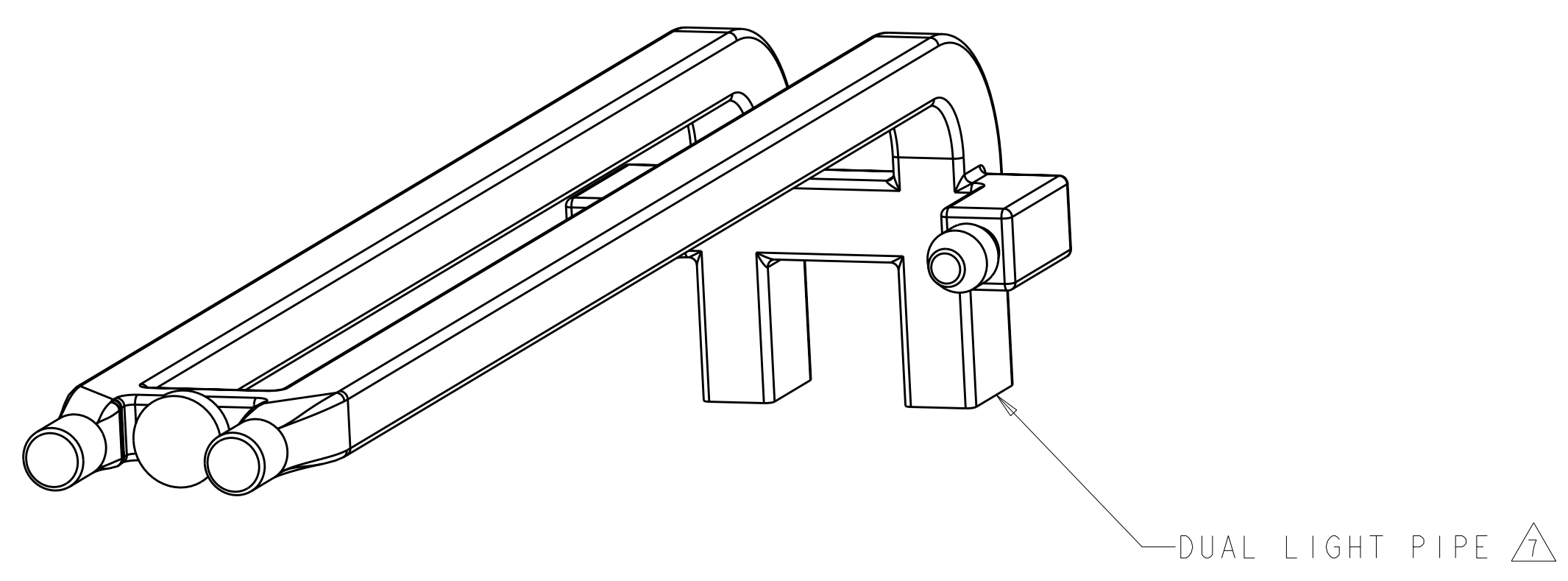

EXPLODED ISOMETRIC VIEW  
SCALE 6:1

THIS DRAWING IS A CONTROLLED DOCUMENT.		DWN R. SUN 21DEC2011	TE Connectivity
DIMENSIONS: mm		CHK D. ZHU 21DEC2011	
TOLERANCES UNLESS OTHERWISE SPECIFIED: 9 PLC ±.5 2 PLC ±0.13 5 PLC ±0.013 4 PLC ±0.001 ANGLES ±.0001		APVD ALEX CAI 21DEC2011	NAME CAGE ASSEMBLY, THRU BEZEL, QSFP, W/ HEAT SINK, EMI GASKET AND DUAL LIGHT PIPE
MATERIAL: - FINISH: -		PRODUCT SPEC 108-2286	SIZE 114-13217
		APPLICATION SPEC 114-13217	RESTRICTED TO
		WEIGHT -	A100779C=2170227
		CUSTOMER DRAWING	SCALE 4:1 SHEET 2 OF 4 REV 1

LOC	DIST	REV	DATE	BY	APPD
ES	00				

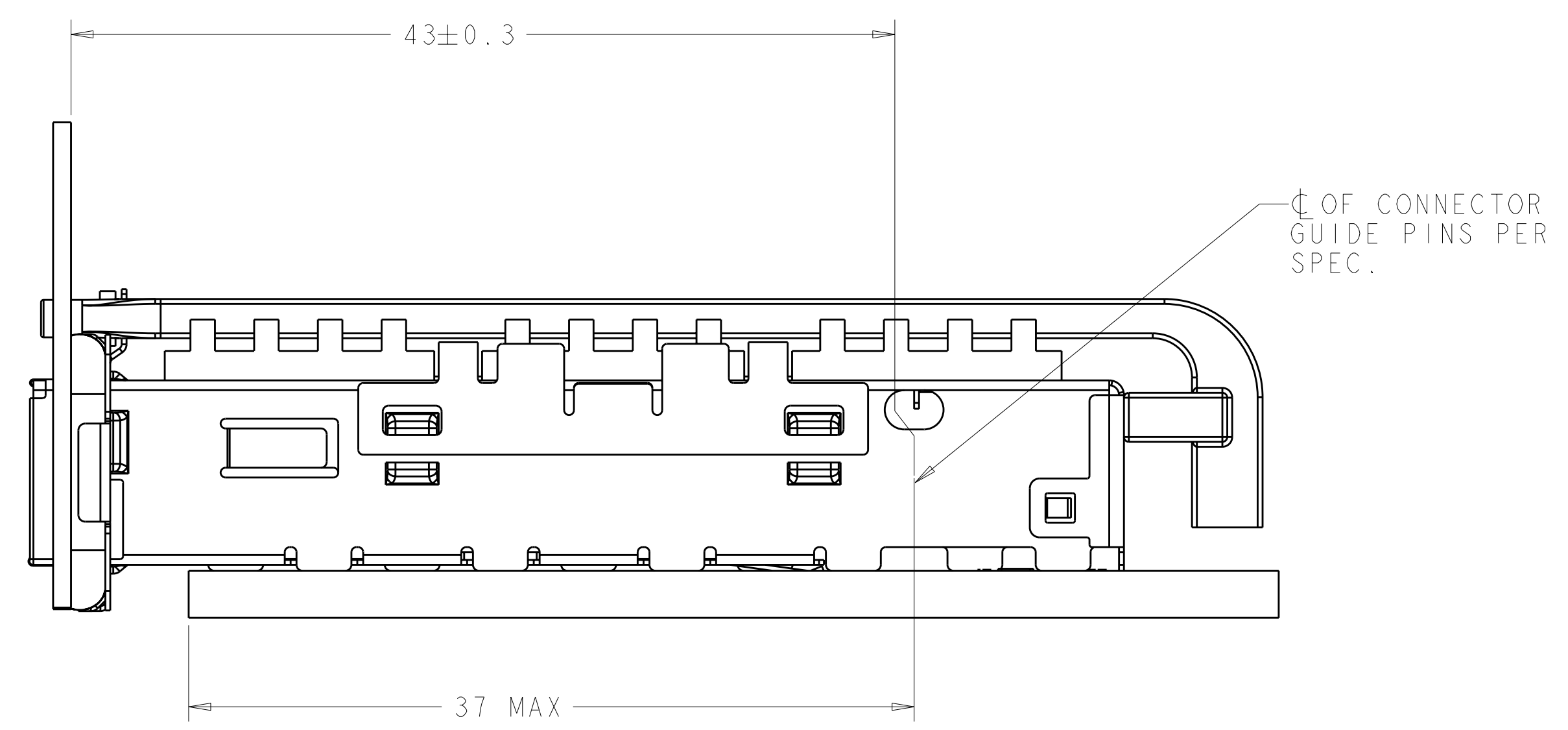
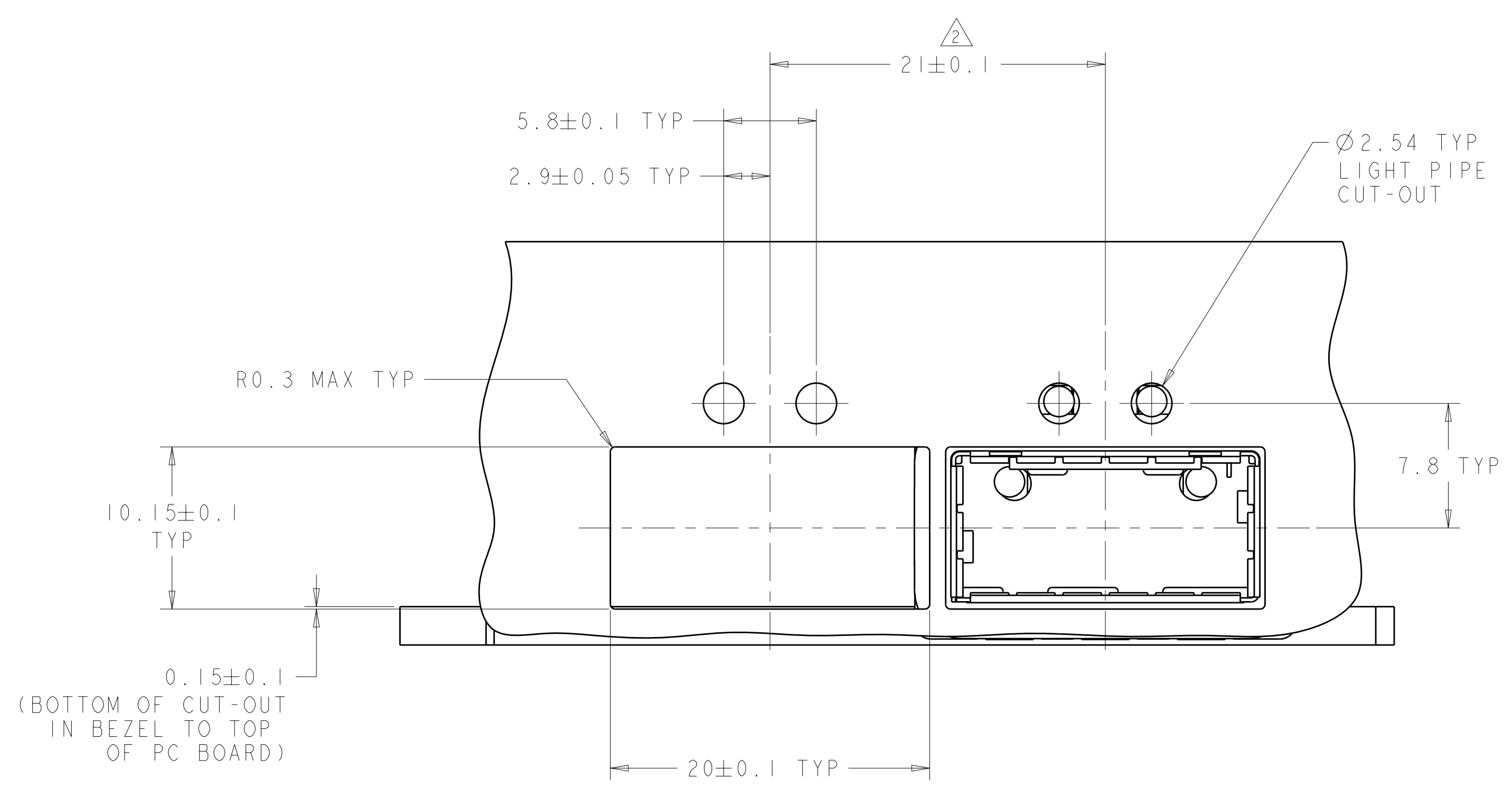

THIS DRAWING IS A CONTROLLED DOCUMENT.		DWN: R. SUN 21DEC2011	TE Connectivity
DIMENSIONS: mm		CHK: D. ZHU 21DEC2011	
TOLERANCES UNLESS OTHERWISE SPECIFIED:		APVD: AILEY CAI 21DEC2011	NAME: CAGE ASSEMBLY, THRU BEZEL, QSFP, W/ HEAT SINK, EMI GASKET AND DUAL LIGHT PIPE
0 PLC ± 1 PLC ±0.5 2 PLC ±0.13 3 PLC ±0.013 4 PLC ±0.001 ANGLES ±0.0001 FINISH ±	PRODUCT SPEC: 108-2286 APPLICATION SPEC: 114-13217 WEIGHT: - CUSTOMER DRAWING	SIZE: A100779 CAGE CODE: C=2170227 DRAWING NO: 114-13217	RESTRICTED TO: -
MATERIAL: -		SCALE: 4:1 SHEET 3 OF 4 REV 1	

LOC	DIST	REV	DATE	BY	APPD
ES	00				
REVISIONS			DESCRIPTION	DATE	BY
			SEE SHEET 1		

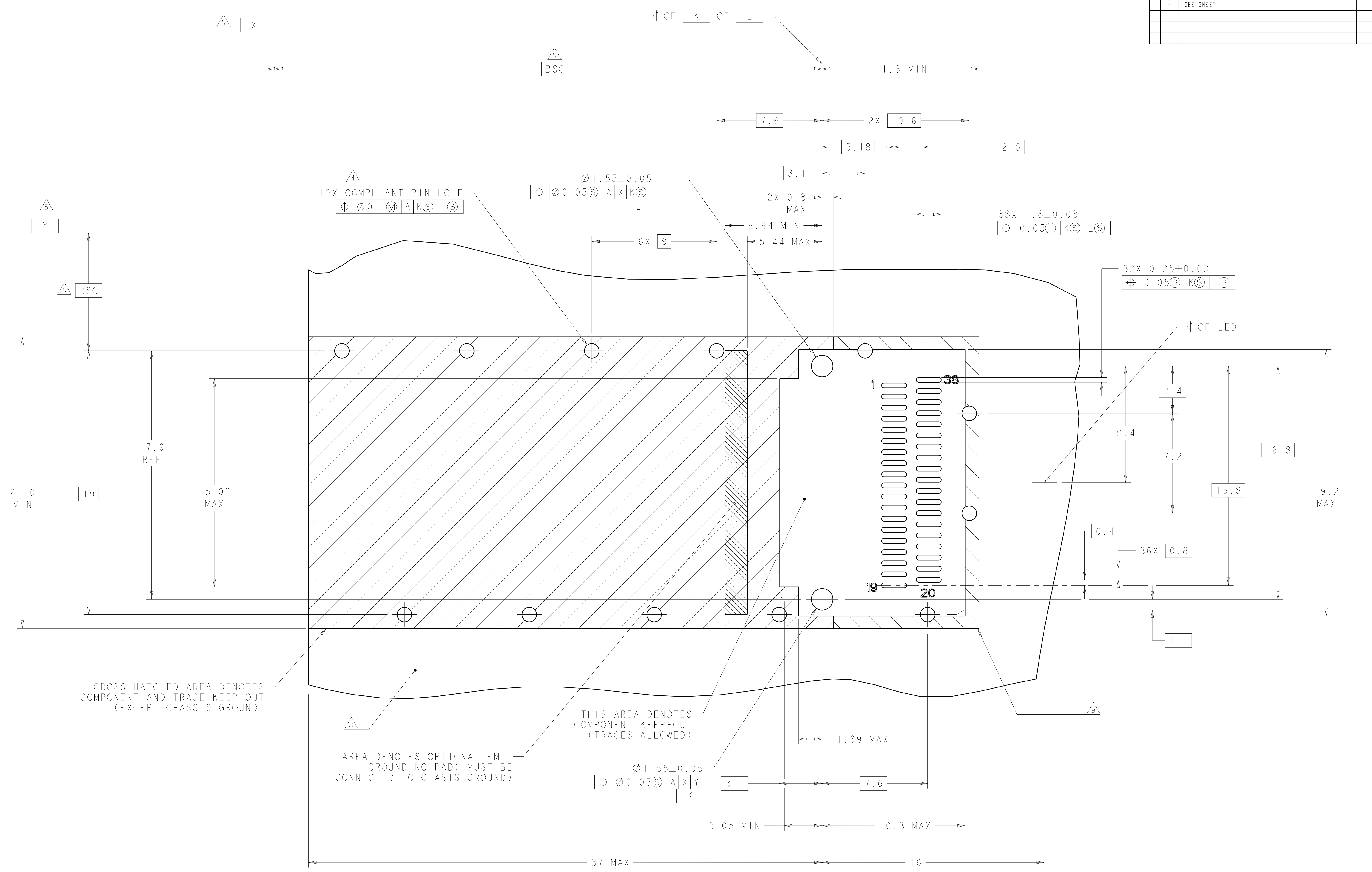

RECOMENDED PC BOARD LAYOUT  
 SCALE 8:1

THIS DRAWING IS A CONTROLLED DOCUMENT.		DWN R. SUN 21DEC2011	TE Connectivity NAME CAGE ASSEMBLY, THRU BEZEL, QSFP, W/ HEAT SINK, EMI GASEKT AND DUAL LIGHT PIPE
DIMENSIONS: mm		CHK D. ZHU 21DEC2011	
TOLERANCES UNLESS OTHERWISE SPECIFIED:		APVD ALEX CAI 21DEC2011	PRODUCT SPEC
9 PLC ±0.5			108-2286
2 PLC ±0.13			APPLICATION SPEC
5 PLC ±0.013			114-13217
4 PLC ±0.001			WEIGHT
ANGLES ±0.001			1100779C=2170227
MATERIAL	FINISH		CUSTOMER DRAWING
SCALE 4:1			SHEET 4 OF 4