

REVISIONS					
P.	LTR.	DESCRIPTION	DATE	DWN.	APVD.
	A1	REVISED PER ECR-17-015922	07NOV2017	BDA	KR

1. SMALL NICKS ARE PERMITTED ON THE CIRCUIT TOWERS WHICH COULD INCREASE THE INITIAL HOUSING MATING FORCE BY UP TO 4.4 NEWTONS [1.0 LBS]. NO INDIVIDUAL NICKED TOWER SHALL INCREASE THIS FORCE BY OVER 2.2 NEWTONS [.5 LBS].
2. RIBS EQUALLY SPACED, NO SPECIFIC ORIENTATION. FOUR RIBS PREFERRED, SIX RIBS OPTIONAL.
3. UNDERWRITES RECOGNIZED COMPONENT LOGO AND CSA CERTIFICATION LOGO TO BE LOCATED ONCE EACH ON SIDE OF HOUSING.
4. DIMENSIONS SHOWN REPRESENT PRODUCT IN DRY, AS MOLDED, CONDITION. ADDITIONAL 2% GROWTH DUE TO SUBSEQUENT MOISTURE ABSORPTION MAY OCCUR AND SHOULD BE ACCOUNTED FOR.

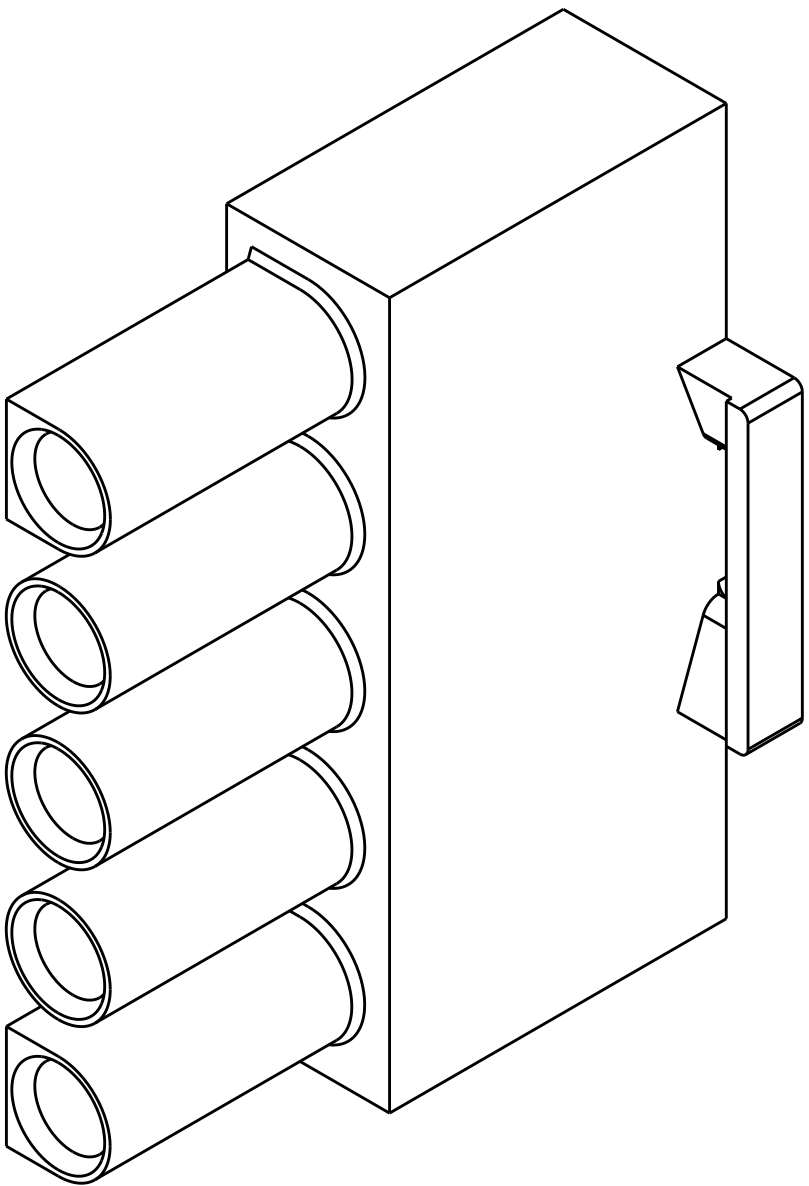
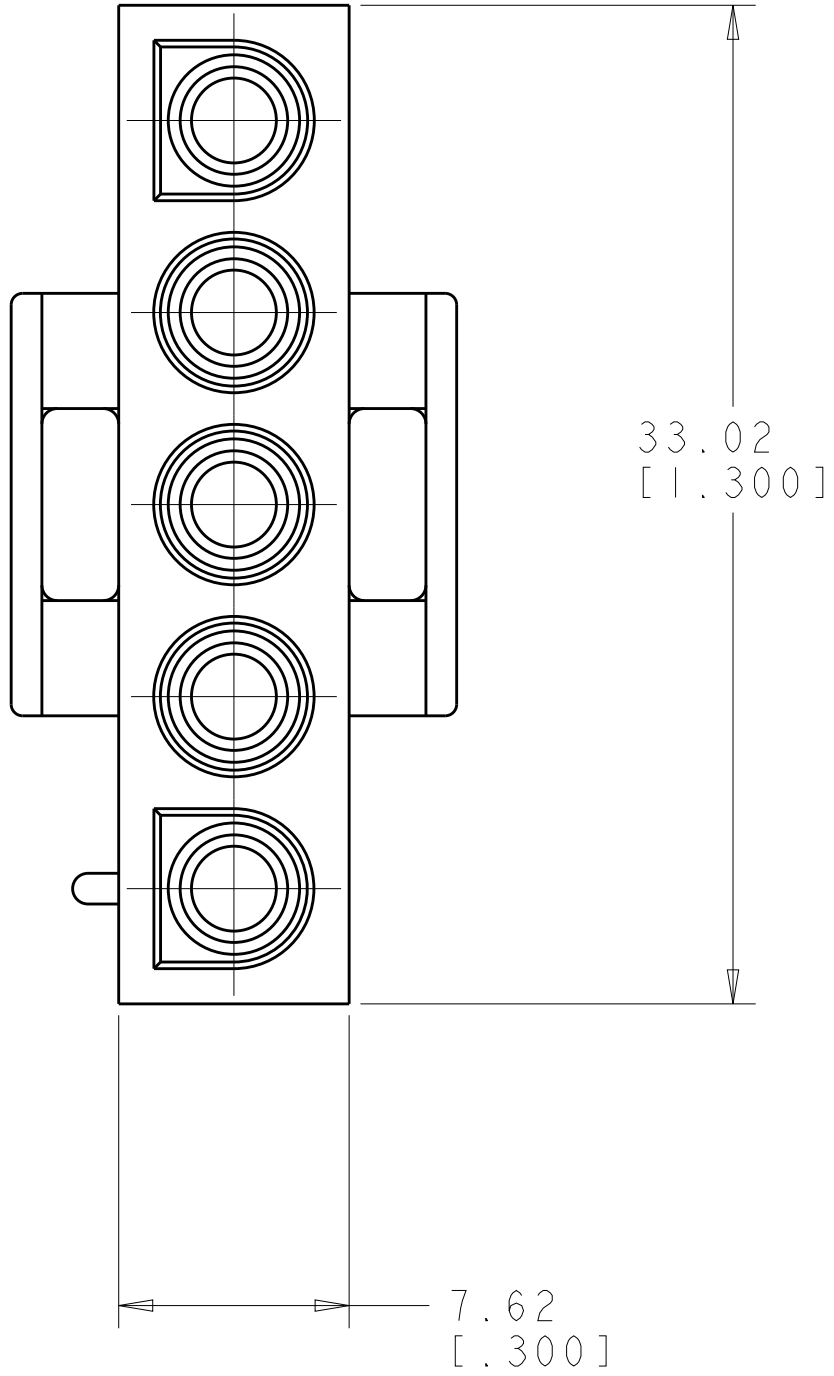
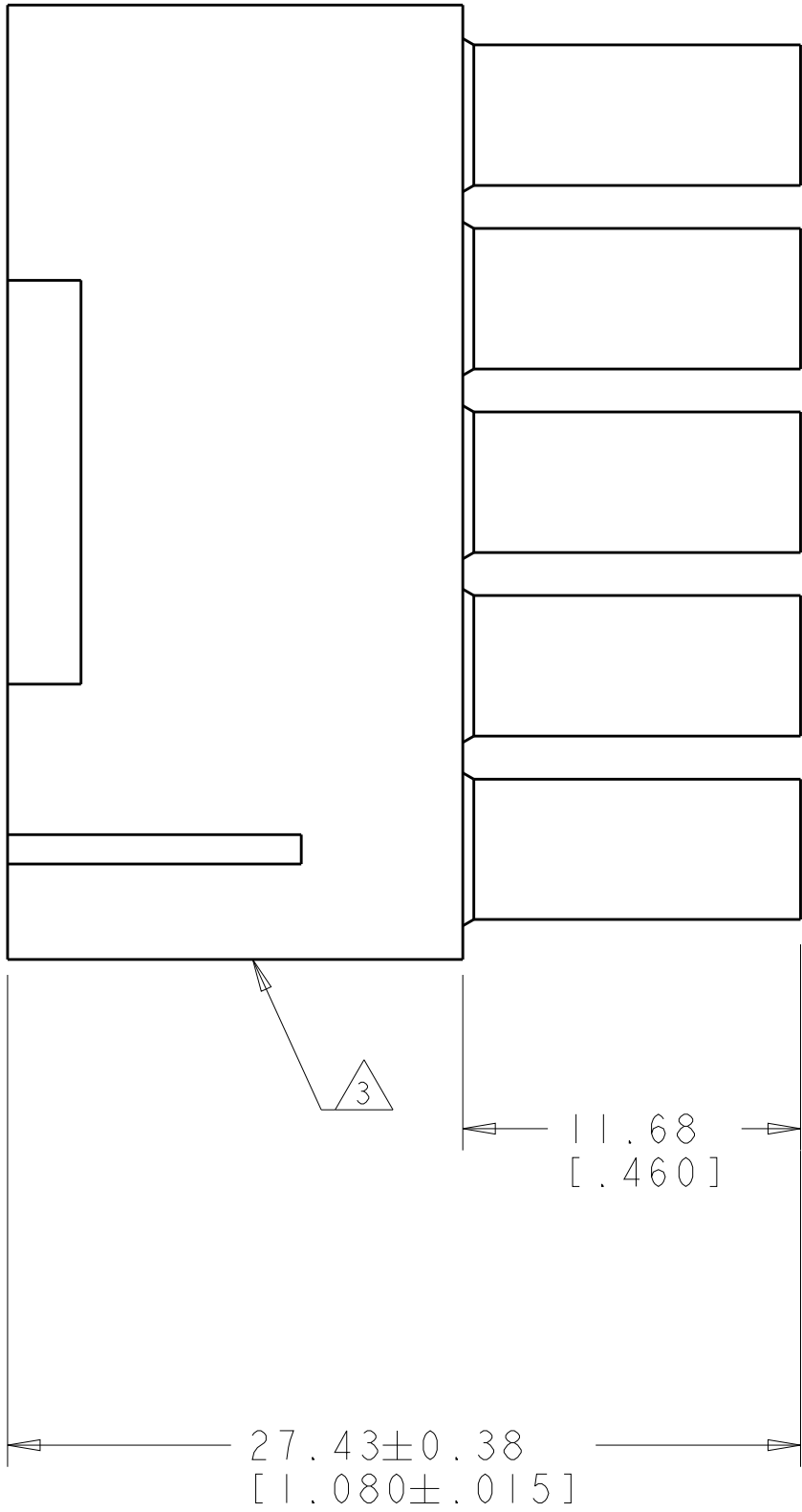
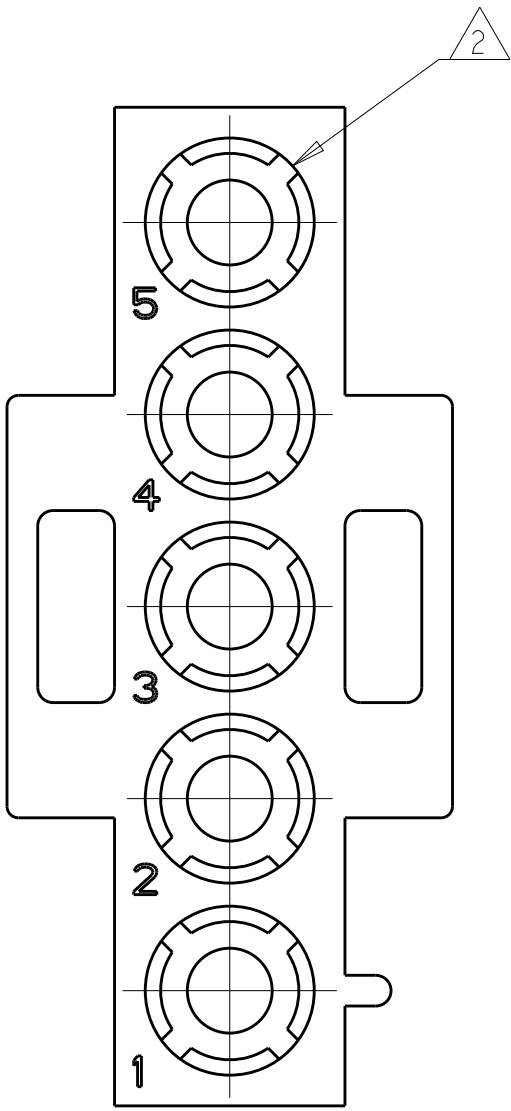

0.185 IN ³	2029124-1
VOLUME	PART NUMBER

THIS DRAWING IS A CONTROLLED DOCUMENT.		DWN K. WHITAKER 17JUL2008	TE Connectivity		
DIMENSIONS: mm[INCHES]		CHK D. COLEY 17JUL2008			
	TOLERANCES UNLESS OTHERWISE SPECIFIED:	APVD D. COLEY 17JUL2008	NAME PLUG, 5 CIRCUIT, UNIVERSAL MATE-N-LOK(TM)		
	0 PLC ±"	PRODUCT SPEC	SIZE A100779C=2029124		
	1 PLC ±"	APPLICATION SPEC			
	2 PLC ±0.13 [.005]	WEIGHT	RESTRICTED TO		
MATERIAL NYLON UL94V-2, BLACK		CUSTOMER DRAWING	SCALE 4:1	SHEET 1 OF 1	REV A1