

Manufacturing date consisting of:
2 digits for the year (YY), 2 digits for the week (WW) and 1 digit for the day (D)

old P/N (without V42254-)

Tyco P/N

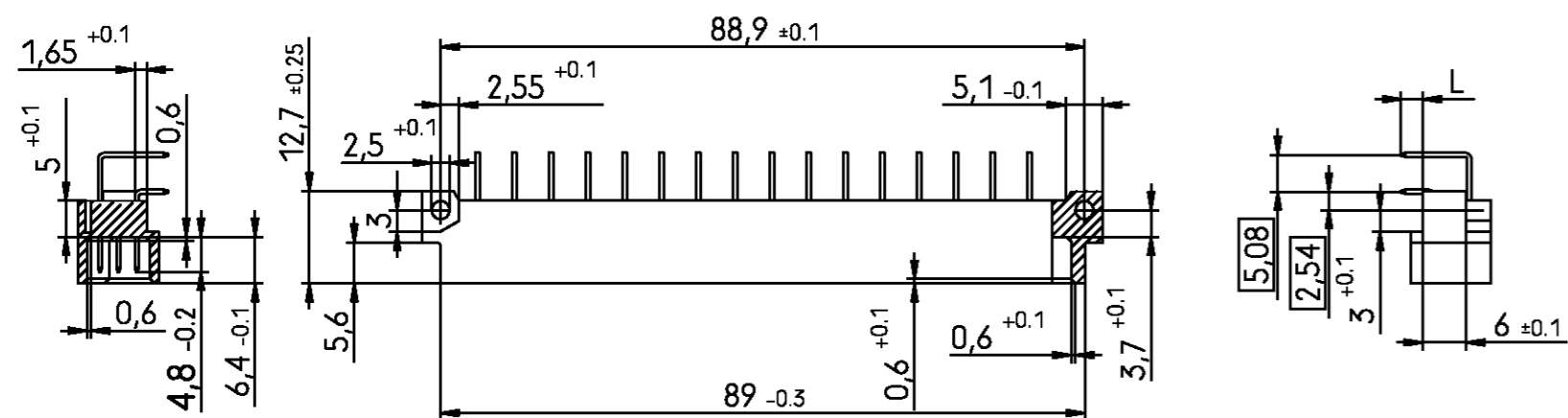
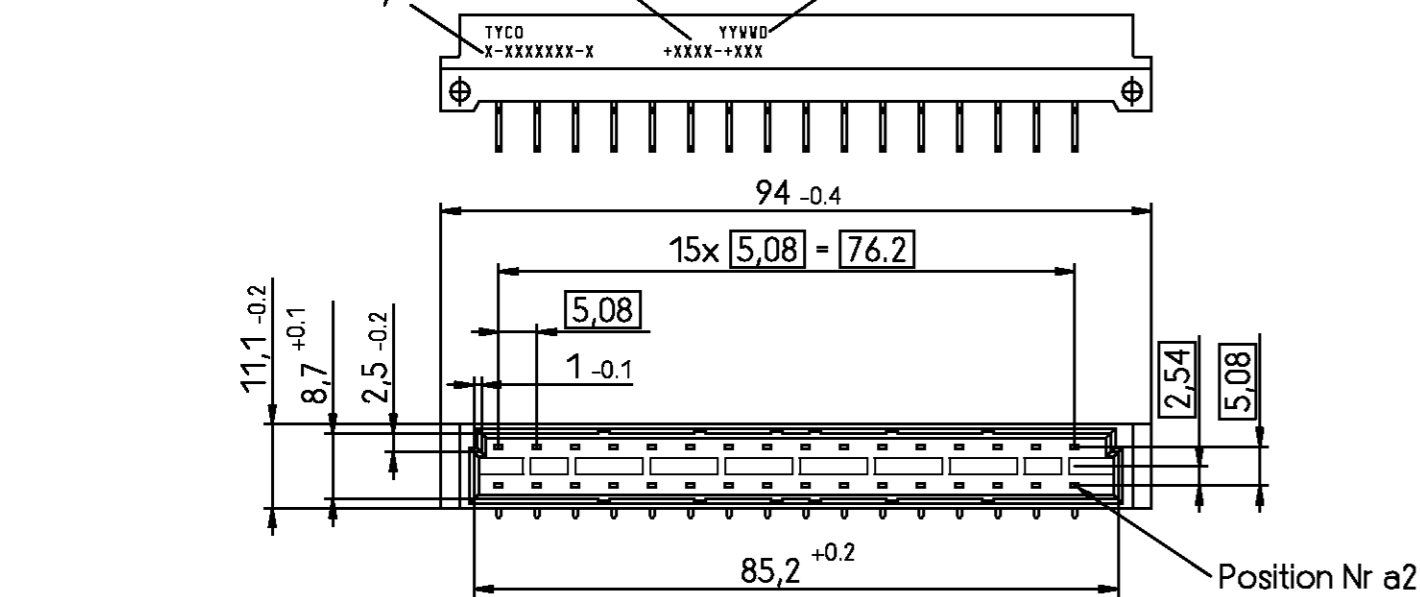

Mounting holes in PCB

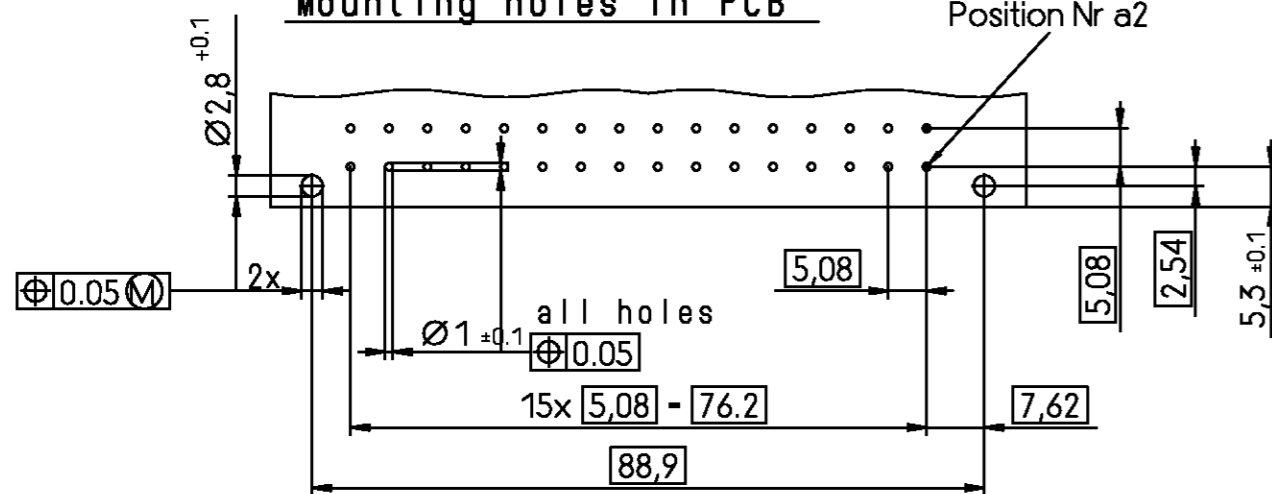

Termination Style

Soldering/Wire-Wrap pins

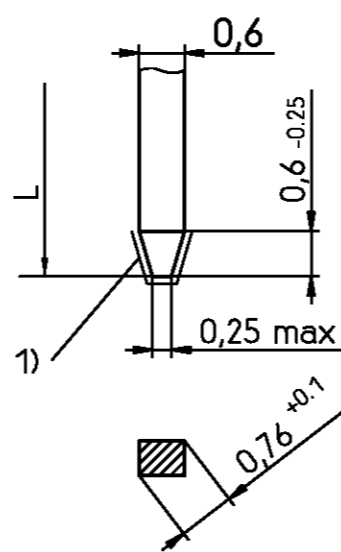

	L	Code
	3 -0.4	00
	2.9 ±0.3	01
	4.5 ±0.3	02

V42254-*1***-D325

1) Cutting edges not plated
Terminations with galvanic SnPb plating

Contact Plating:

Performance level acc to DIN41612 and IEC603-2	Noble metals	Code
Class I	PdNi + Au or Au	1
	Au	4
Class II	PdNi + Au or Au	2
	Au	5
Class III	PdNi + Au or Au	3

Nickel underlayer
Protection film: HF-grease

V42254-*1***-D325

B : Standard version
F : Versions with flux-tight coating

Old Part Number	TE Part Number	Style & Number of Positions	Termination posts	Loaded Rows	Standard Pre-Mating (mm 1)	Performance Level	
V42254-B1100-D325	2-1393644-1	D32	right-angle solder leads	row a+c , every even pitch	No	1	OBSOLETE
V42254-B1102-D325	3-1393644-7	D32	4,5mm straight solder leads	row a+c , every even pitch	No	1	
V42254-B1200-D325	9-1393644-8	D32	right-angle solder leads	row a+c , every even pitch	No	2	SUPERSEDED BY 1551603-1
V42254-B1200-D325N	9-1393644-9	D32	right-angle solder leads	row a+c , every even pitch	No	2	
V42254-B1201-D325	2-1393645-8	D32	2,9mm straight solder leads	row a+c , every even pitch	No	2	OBSOLETE 2)
V42254-B1202-D325	3-1393645-9	D32	4,5mm straight solder leads	row a+c , every even pitch	No	2	OBSOLETE 2)
V42254-F1200-D325	1-1393647-5	D32	right-angle solder leads	row a+c , every even pitch	No	2	OBSOLETE 3)

- 1) First and last contact of each loaded row is a pre-mating (make first / break last) contact.
- 2) No Company name marked on the connectors.
- 3) Connectors have a flux-tight coating.

Active part numbers.
Contact TE for other configuration availability

Acc to IEC 603-2
Housing material: PBT 30% glassfilled (UL94V-0), grey
Contact material: Copper alloy

THIS INFORMATION IS CONFIDENTIAL AND PROPRIETARY TO TYCO ELECTRONICS CORPORATION AND ITS WORLDWIDE SUBSIDIARIES AND AFFILIATES. IT MAY NOT BE DISCLOSED TO ANYONE, OTHER THAN TYCO ELECTRONICS PERSONEL, WITHOUT WRITTEN AUTHORIZATION FROM TYCO ELECTRONICS CORPORATION, HARRISBURG PENNSYLVANIA USA.

		TE Connectivity		SCALE 1:1; 2:1		WEIGHT	
LOC		DIMENSIONS IN MM		MATERIAL			
GW				PART NAME			
		DATE 9 Jan 02		NAME Colpaert B.		Customer Drawing	
		APP. PE Com				Male type D	
A4	ECR-10-004503	13SEP11	MKO	TOLERANCE UNLESS SPECIFIED OTHERWISE		PART NO.	
A3	ECR-10-003044	03JUN10	MKO			V42254-B1xxx-D325-*2676	
A2	SR10-0177-03	04 AUG 03	KV			SHT. 1-	
A1	SR10-0157-02	13 Mar 02	BC				
A		9 Jan 02	BC				
REV.	CHANGE ORDER	DATE	APP.	Customer Drawing : C 2-1393644-1			