



P	LTR	DESCRIPTION	DATE	DWN	APVD
	A	ECO-20-012219	19NOV2020	GK	DR

	 Certified
16-14 AWG STRANDED	16-14 AWG STRANDED



- 1. WIRE INSULATION DIAMETER: $\phi 2.921-4.826$ [$\phi .115-.190$]
- 2 MATERIAL: BODY - COPPER PER ASTM B152
INSULATION - PVC
- 3 FINISH: BODY - TIN PLATE 0.00254 [.000100] MIN EXT THK PER ASTM B545
INSULATION COLOR - BLUE
- 4 STAMP AMP 16-14* APPROX AS SHOWN

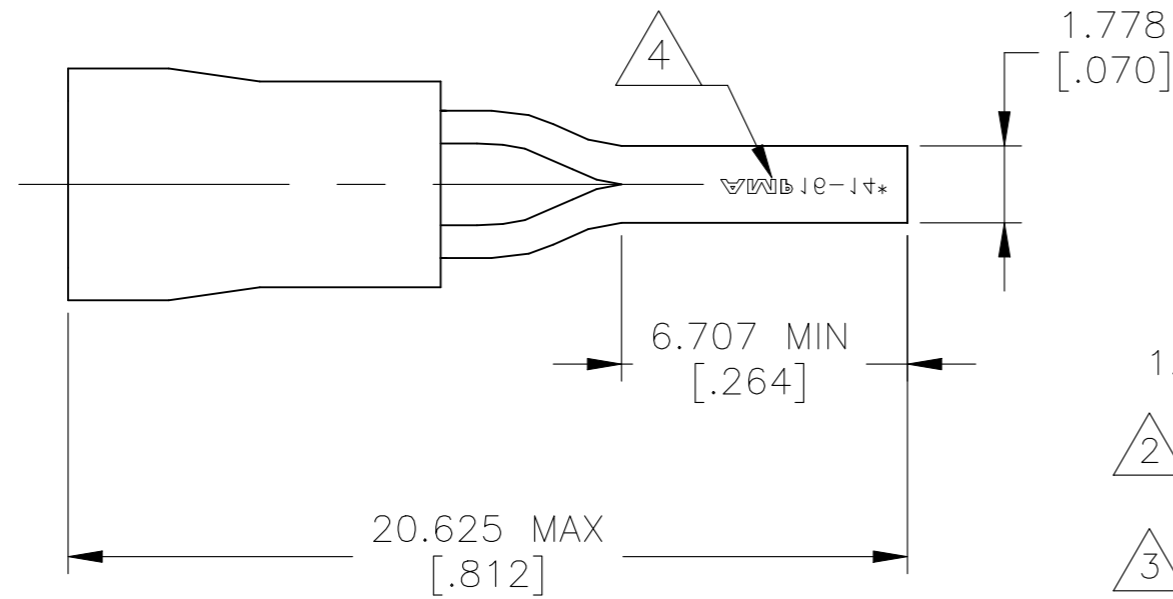
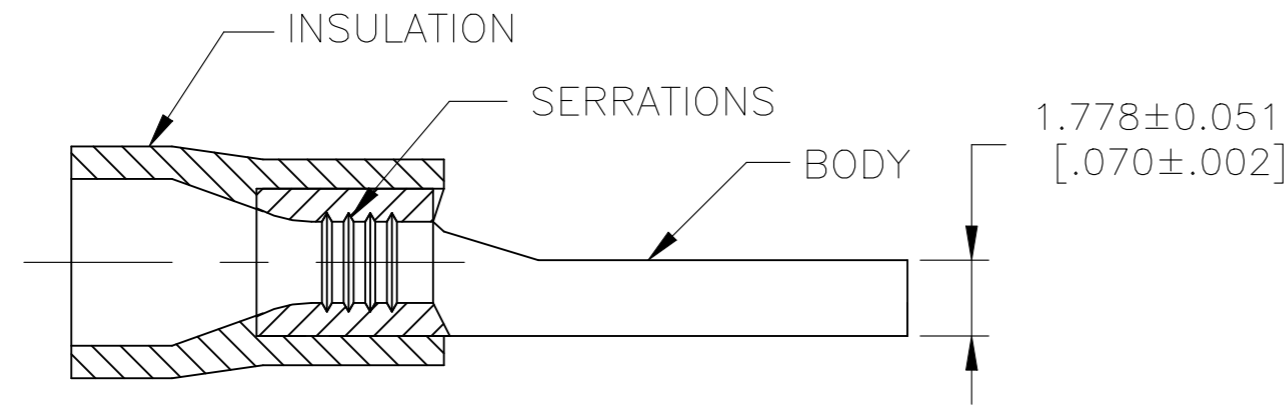

100	WP025-V-R1	1SET151003R0000	165075
QTY	DESIGNATION	ENTRELEC PN	TE PN

MAX RECOMMENDED OPERATING TEMPERATURE: 105°C [221°F] VOLTAGE RATING: 600 V MAX (1000 V SIGN OR FIXTURE) CIRCULAR MIL AREA: 1.04-2.62mm ² [2,050-5,180] SOLID OR STRANDED	THIS DRAWING IS A CONTROLLED DOCUMENT.		DWN 18NOV2020 GOPALAKRISHNA HV CHK 18NOV2020 ROHDE DANIEL F APVD 18NOV2020 ROHDE DANIEL F		ENTRELEC Electrical Solutions			
	DIMENSIONS: mm [INCHES]	TOLERANCES UNLESS OTHERWISE SPECIFIED: 0 PLC ± - 1 PLC ± - 2 PLC ± - 3 PLC ± 0.127 [.005] 4 PLC ± - ANGLES ± 1°	PRODUCT SPEC UL 486A-B APPLICATION SPEC 114-2161					NAME TERMINAL, WIRE PIN, PLASTI-GRIP, WIRE SIZE: 16 - 14 AWG
	MATERIAL	- 2	FINISH	- 3	SIZE A3	CAGE CODE 00779	DRAWING NO C-1SET151003R0000	RESTRICTED TO -
	CUSTOMER DRAWING				WEIGHT -	SCALE 8:1	SHEET 1 OF 1	REV A