

THIS DRAWING IS UNPUBLISHED. RELEASED FOR PUBLICATION 20
 © COPYRIGHT 20 BY - ALL RIGHTS RESERVED.

LOC		DIST		REVISIONS			
P	LTR	DESCRIPTION		DATE	DWN	APVD	
	A1	NOTE 1 CORRECTED		18DEC2018	RK	PS	

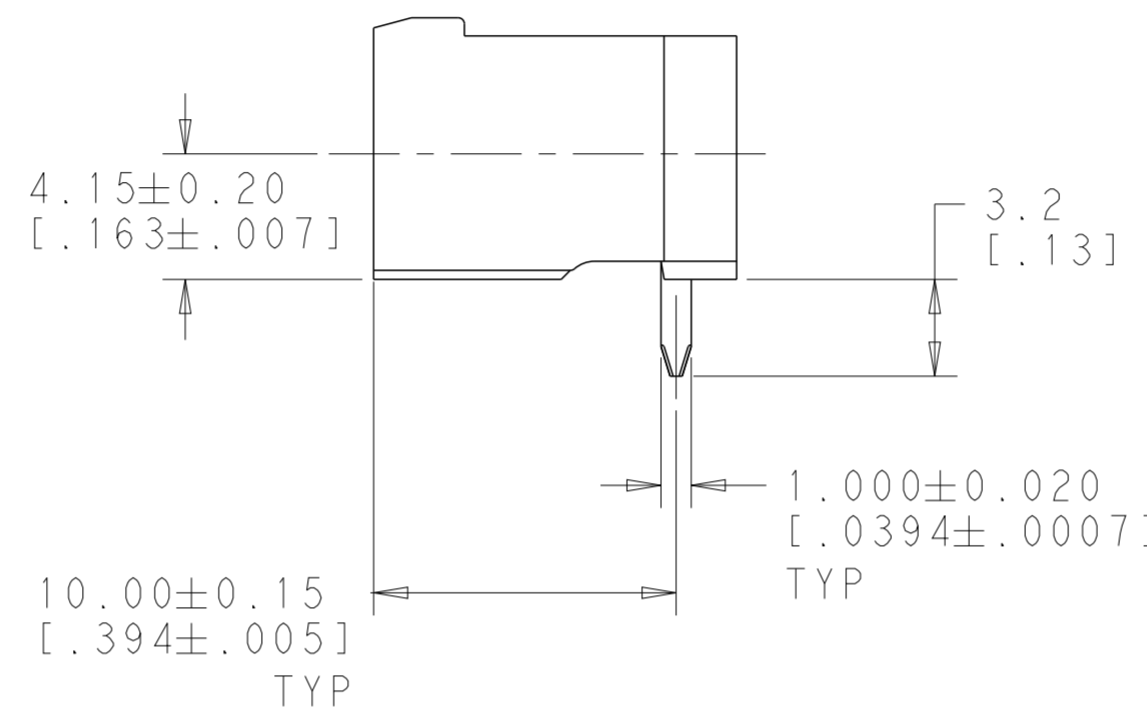

- MATERIALS AND FINISH:**
 HOUSING: HIGH TEMPERATURE POLYAMIDE, UL 94-V0,
 COLOR: SEE TABLE.
 TERMINAL: COPPER ALLOY, PLATING: SEE TABLE
- MECHANICAL CHARACTERISTICS:**
 PLUG INSERTION FORCE PER POLE: MAX 3N (.674 LBF)
 PLUG WITHDRAWAL FORCE PER POLE: MIN 1.5N (.337 LBF)
 PCB THICKNESS: MAX 2.4mm
 PCB HOLE DIAMETER: MIN 1.6mm
 SOLDERABLE UP TO: 275°C (527°F)
 REFLOW CAPABLE
- ELECTRICAL CHARACTERISTICS:**
 RATED VOLTAGE: 300 V
 RATED CURRENT: 15 A
 CONTACT RESISTANCE: <15mΩ
 INSULATION RESISTANCE: > 10⁹Ω (500V DC)
- NOT CUMULATIVE TOLERANCE.
- OPERATING TEMPERATURE RANGE: -40°C TO +105°C.

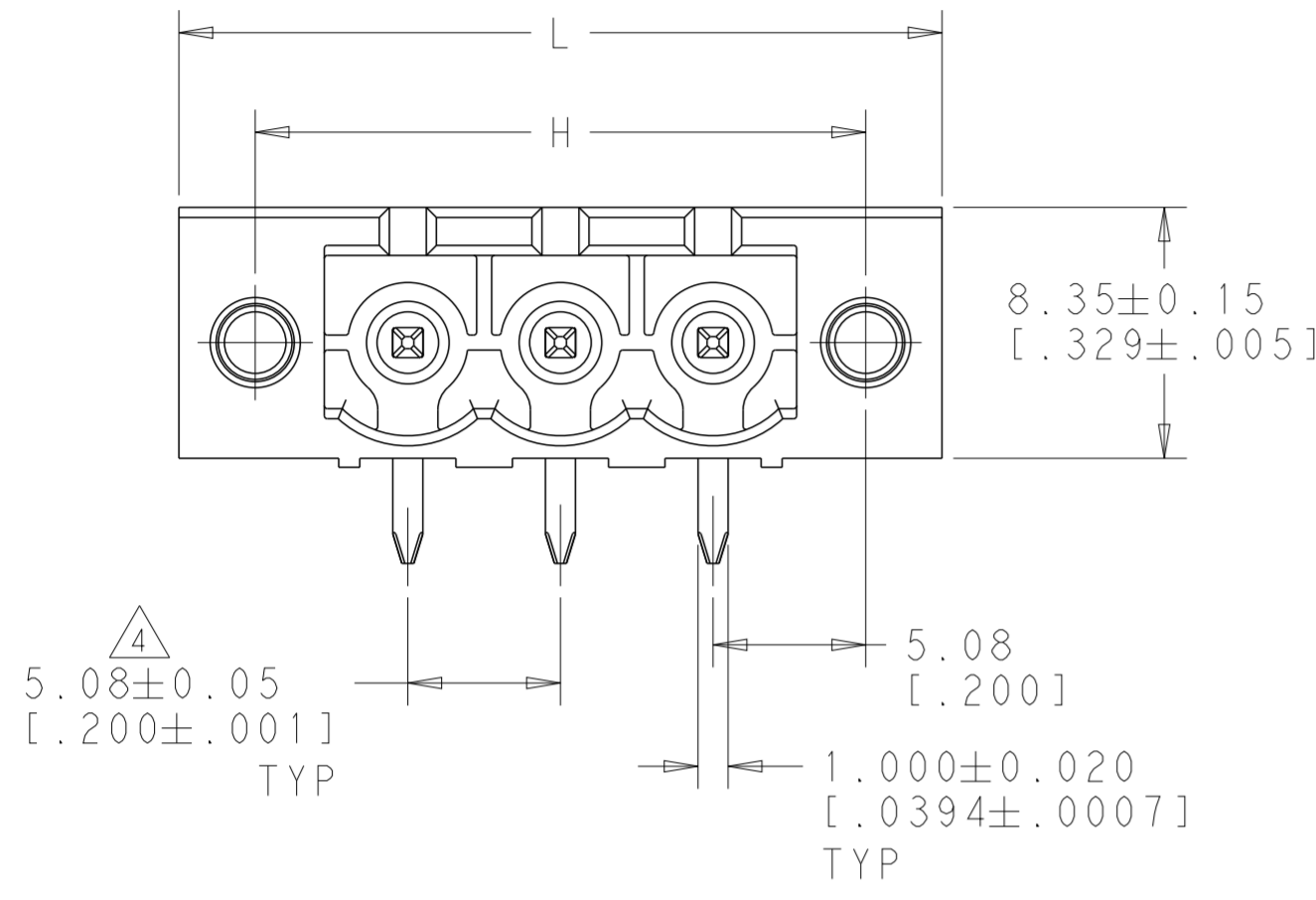
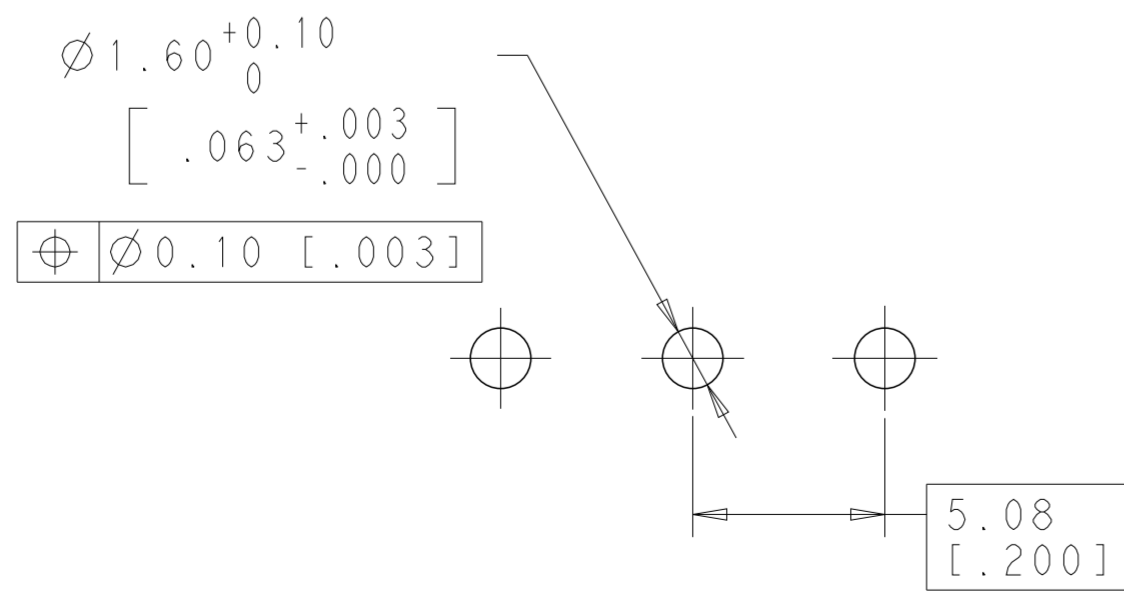
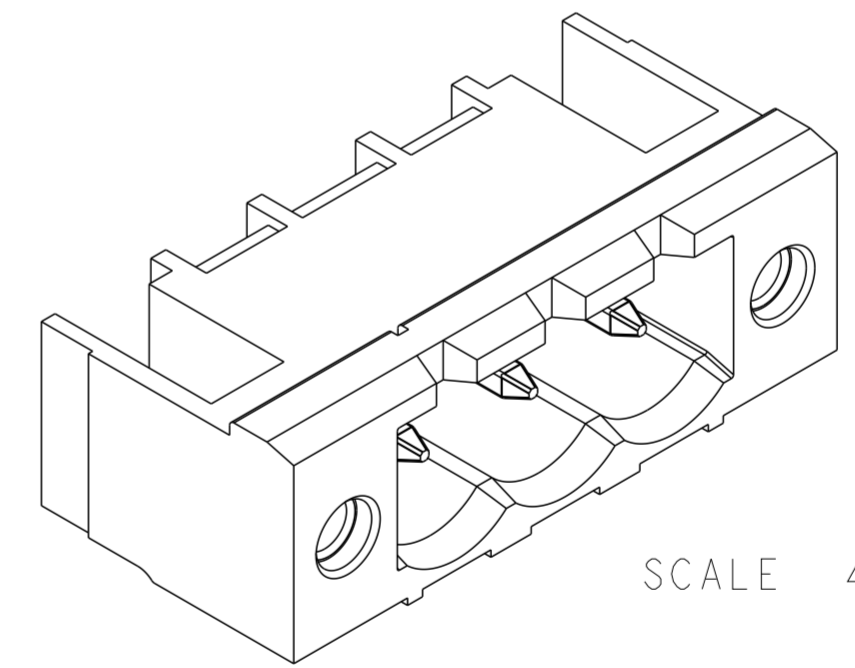
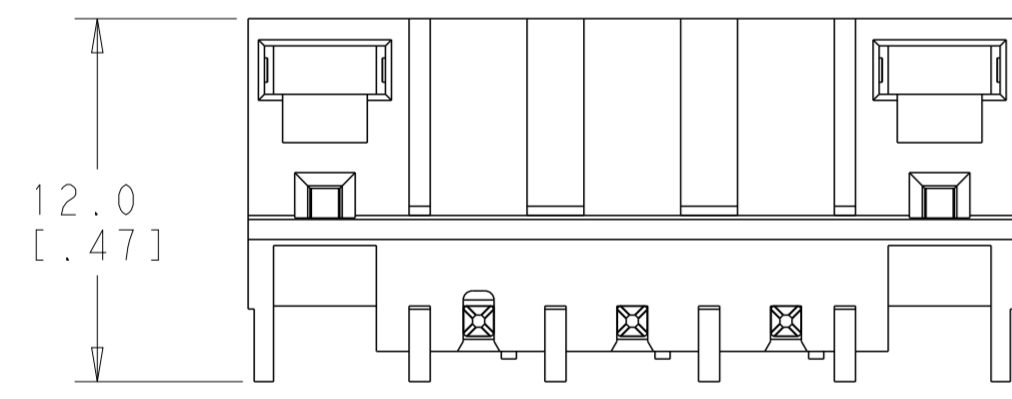

RECOMENDED PC BOARD LAYOUT

BLACK	TIN	25.32 [0.996]	20.32 [0.800]	3	1986766-3
COLOR	TERMINAL PLATING	L	H	NO OF POSITION	PART NUMBER
THIS DRAWING IS A CONTROLLED DOCUMENT.		DWN KIRAN HOLA 07AUG2012		TE Connectivity TERMINAL BLOCK HEADER ASSEMBLY, 90 DEGREE, WITH FLANGE,	
DIMENSIONS: mm [INCHES]		CHK BRUBAKER, MARK 07AUG2012			
TOLERANCES UNLESS OTHERWISE SPECIFIED:		APVD BRUBAKER, MARK 07AUG2012			
0 PLC	±	PRODUCT SPEC		NAME	
1 PLC	±0.2	APPLICATION SPEC		SIZE	
2 PLC	±0.15 [0.008]	WEIGHT		CAGE CODE	
3 PLC	±[0.006]	CUSTOMER DRAWING		DRAWING NO	
4 PLC	±	SCALE 3:1		RESTRICTED TO	
ANGLES	±2°	SHEET 1 OF 1		REV A1	
FINISH					
SEE NOTES	SEE NOTES				