

THIS DRAWING IS UNPUBLISHED. RELEASED FOR PUBLICATION 20
 © COPYRIGHT 20 BY - ALL RIGHTS RESERVED.

REVISIONS					
P	LTR	DESCRIPTION	DATE	DWN	APVD
A		REVISED PER ECR-16-014077	06OCT2016	BW	RS
C		REVISED PER ECR-23-173364	25MAY2023	SS	AF

1 THIS HOUSING ACCEPTS BOTH FASTON AND POSI-LOCK MKII TERMINALS.

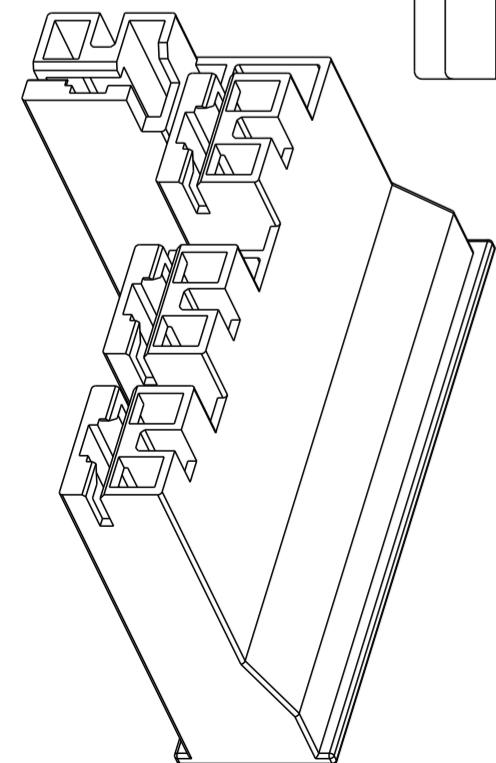
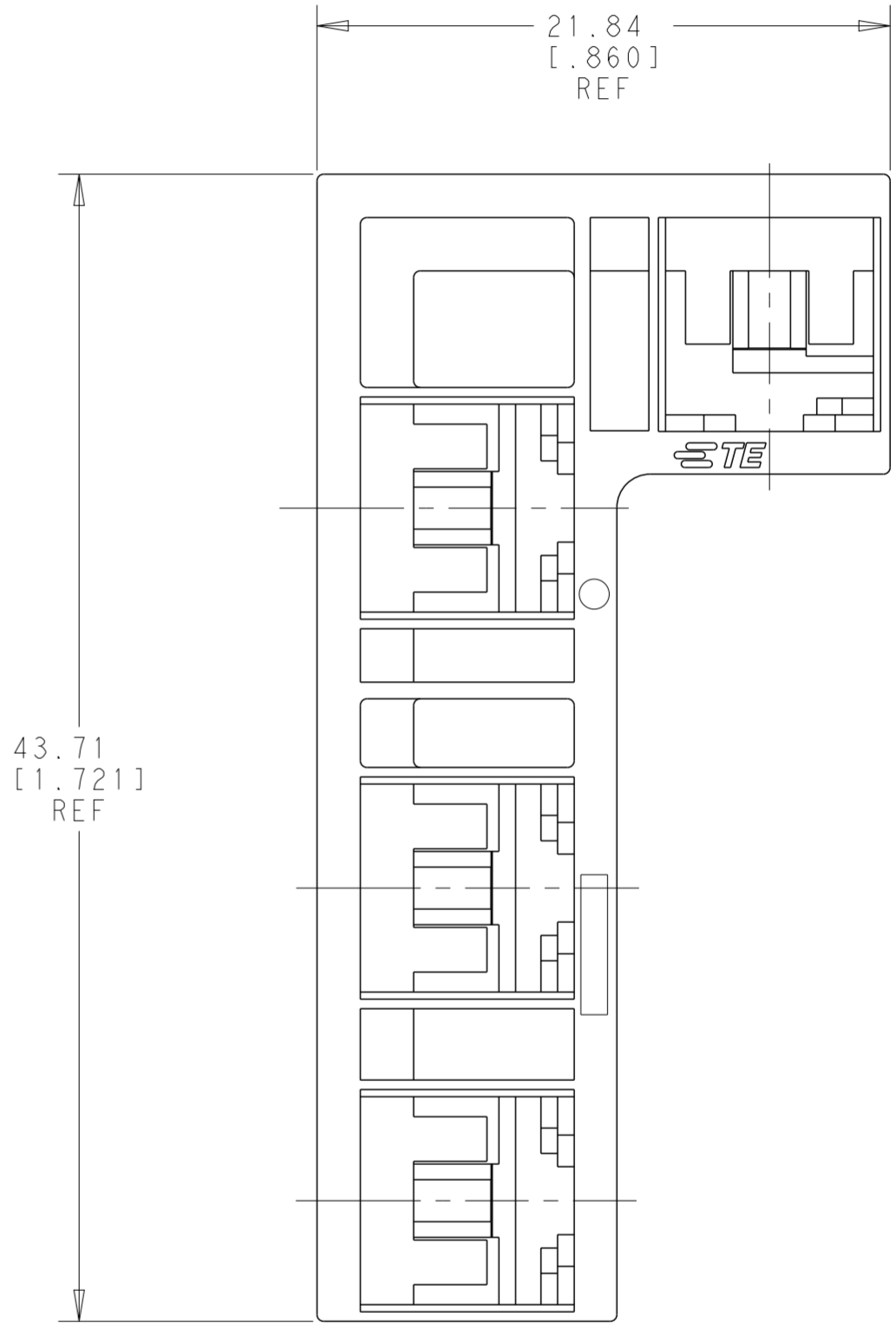
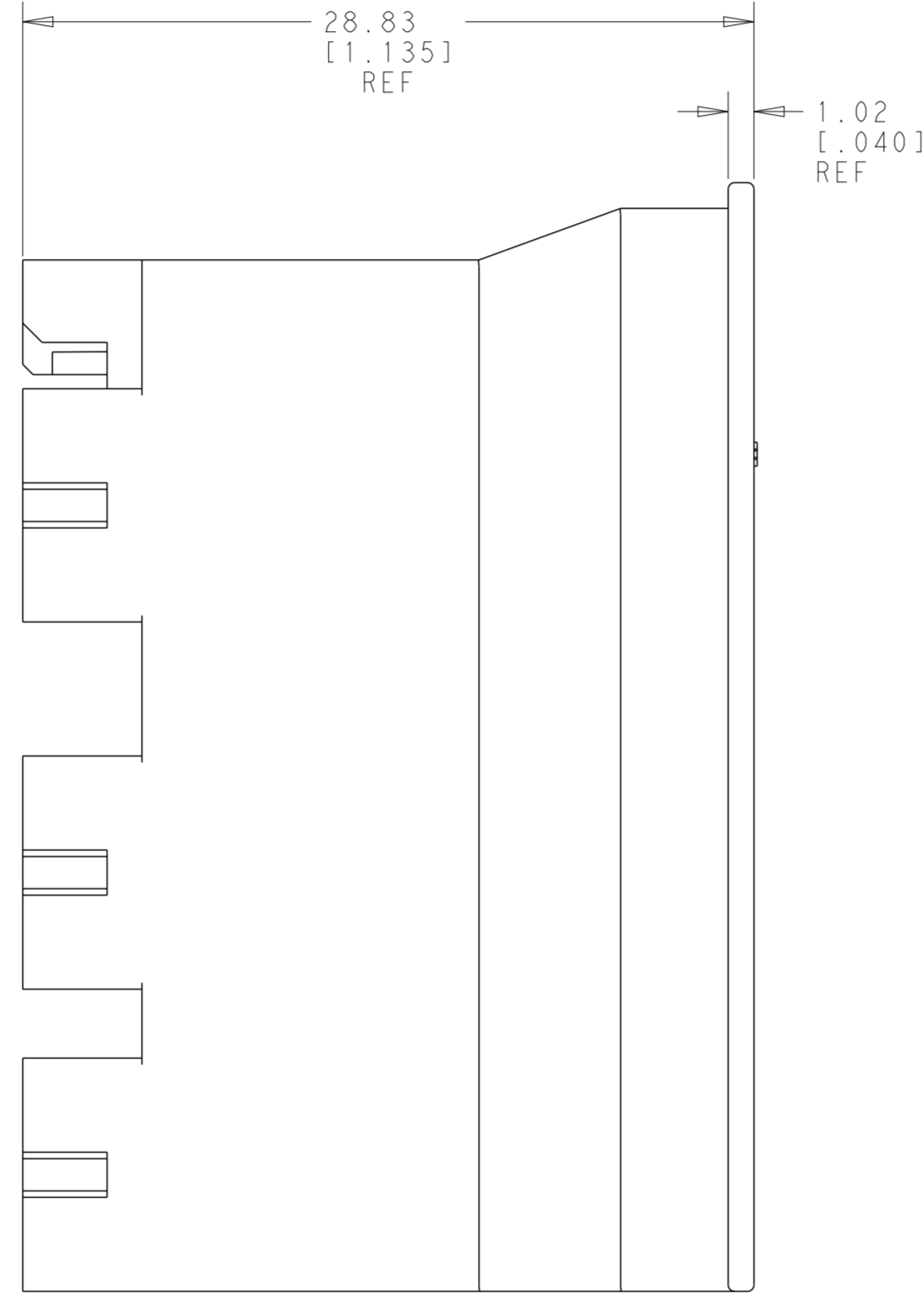
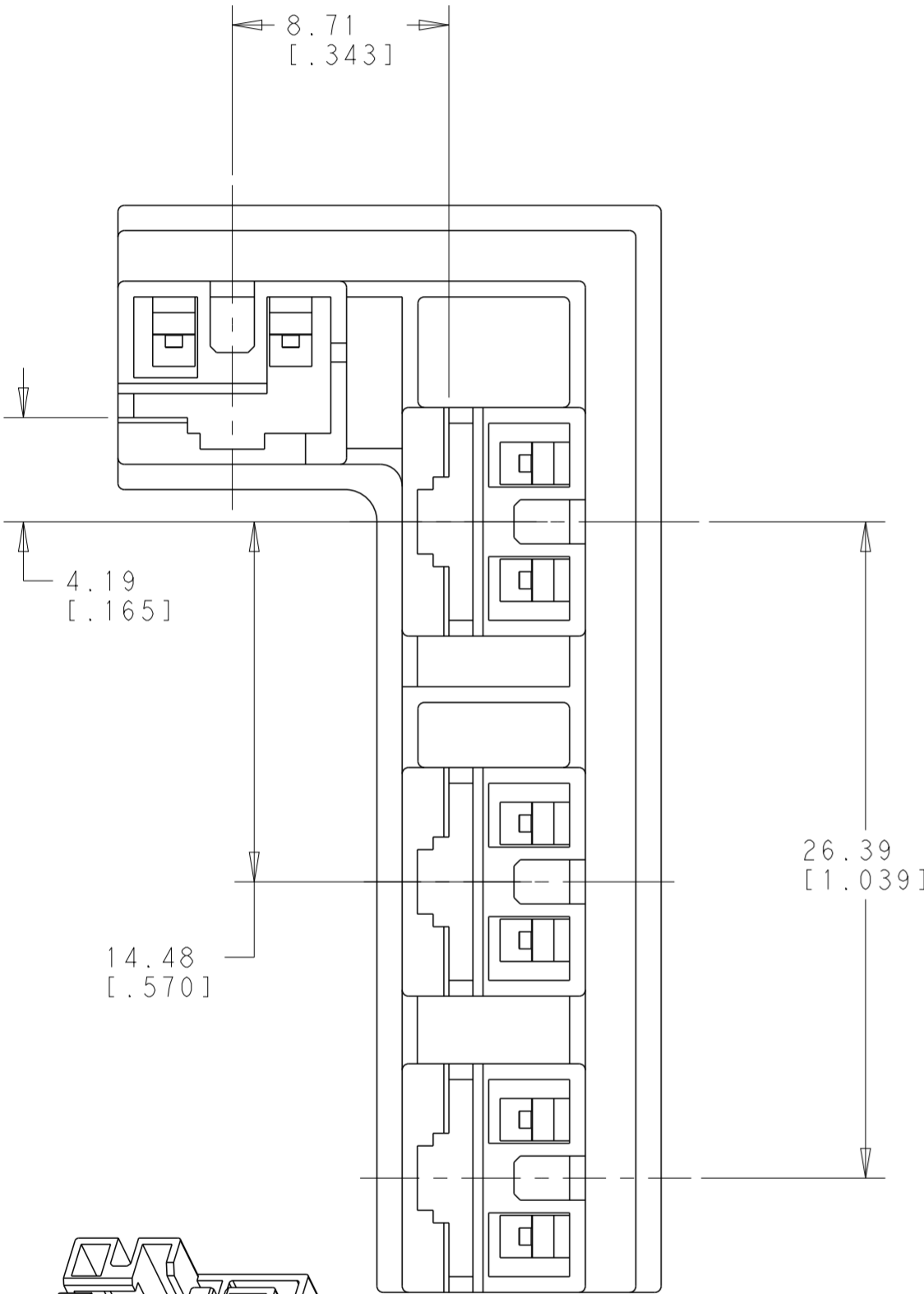

SCALE 2:1

THIS DRAWING IS A CONTROLLED DOCUMENT.		DWN MAGALAKSHMI, K	26 JUN 2015	NATURAL		NYLON V0	1969761-1
DIMENSIONS: mm [INCHES]		CHK DIDONATO, MICHAEL	26 JUN 2015	COLOR		MATERIAL	PART NO
TOLERANCES UNLESS OTHERWISE SPECIFIED:		APVD DIDONATO, MICHAEL	26 JUN 2015	TE Connectivity NAME 4P POSITIVE LOCK HOUSING, MARK II			
0 PLC ± 1 PLC ± 2 PLC ± 3 PLC ±0.25 [.010] 4 PLC ± ANGLES ± FINISH -		PRODUCT SPEC -	APPLICATION SPEC -				
MATERIAL NYLON V0		WEIGHT -	CUSTOMER DRAWING	A200779	C-1969761	-	
				SCALE	4:1	SHEET	1 OF 1
				REV C			