

THIS DRAWING IS UNPUBLISHED. RELEASED FOR PUBLICATION  
 © COPYRIGHT - By - ALL RIGHTS RESERVED.

LOC	DIST	REVISIONS					
		P	LTR	DESCRIPTION	DATE	DWN	APVD
G	14		A	REVISED PER ECO-13-018045	16NOV2013	KH	DR

- 1 STAMP AMP LOCATE APPROX AS SHOWN
- 2 WIRE INSUL DIA, 1.27-2.08 [.050-.082]
- 3 TONGUE MATL THK, 0.46±0.05 [.018±.002]

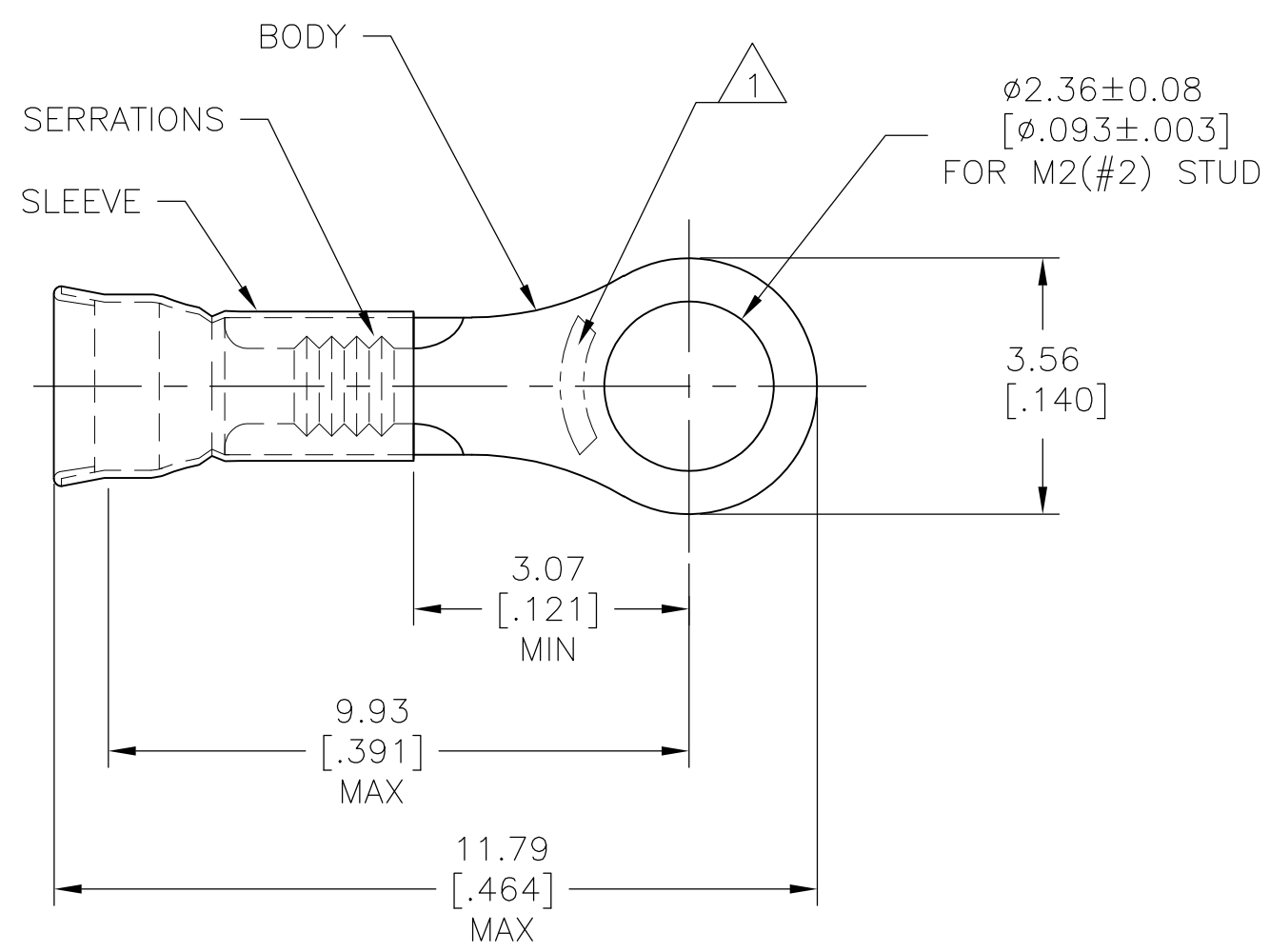

1000	LOOSE PIECE	1958447-1
QTY	PACKAGE TYPE	PART NUMBER

<b>AMP INCORPORATED</b> <b>CUSTOMER SERVICE SYSTEMS</b>		MAX RECOMMENDED OPERATING TEMPERATURE: 343°[650°F]	THIS DRAWING IS A CONTROLLED DOCUMENT.		DWN KIRAN HOLAL 29JAN13 CHK ROHDE DANIEL 29JAN13 APVD ROHDE DANIEL 29JAN13	TE Connectivity				
FOR ADDITIONAL PRODUCT INFORMATION OR COPIES OF DRAWINGS AND TECHNICAL DOCUMENTS	PRODUCT INFORMATION CENTER 1-800-522-6752	VOLTAGE RATING: -	DIMENSIONS: mm [INCHES]	TOLERANCES UNLESS OTHERWISE SPECIFIED: 0 PLC ± - 1 PLC ± - 2 PLC ± 0.20 [.008] 3 PLC ± - 4 PLC ± - ANGLES ± -	NAME TERMINAL, RING, STRATO-THERM DIAMOND GRIP,HR WIRE SIZE: 26-22 AWG	PRODUCT SPEC -	SIZE A3	CAGE CODE 00779	DRAWING NO C-1958447	RESTRICTED TO -
FOR APPLICATION TOOLING INFORMATION	TOOLING ASSISTANCE CENTER 1-800-722-1111	CIRCULAR MIL AREA: 0.10mm²-0.41mm² [202-810] STRANDED WIRE		MATERIAL BODY, CU, SLV, CU PER ASTM B152	FINISH NICKEL PLATE PER SAE AMS 00-N-290	APPLICATION SPEC -	WEIGHT -	SCALE 10:1	SHEET 1 OF 1	REV A
FOR ORDER ENTRY 1-800-526-5142	THIS DRAWING IS A CONTROLLED DOCUMENT FOR AMP INCORPORATED. IT IS SUBJECT TO CHANGE AND THE CONTROLLING ENGINEERING ORGANIZATION SHOULD BE CONTACTED FOR THE LATEST REVISION.		CUSTOMER DRAWING			SCALE 10:1 SHEET 1 OF 1 REV A				