

© COPYRIGHT 2010 BY TYCO ELECTRONICS CORPORATION. ALL INTERNATIONAL RIGHTS RESERVED.

一般公差 GENERAL TOLERANCE	
30以下 100以下 OVER 30 NOT REACHING 100	±0.3
10以下 30以下 OVER 10 NOT REACHING 30	±0.25
NOT REACHING 10 角 ANGLE	±0.2 ±0°

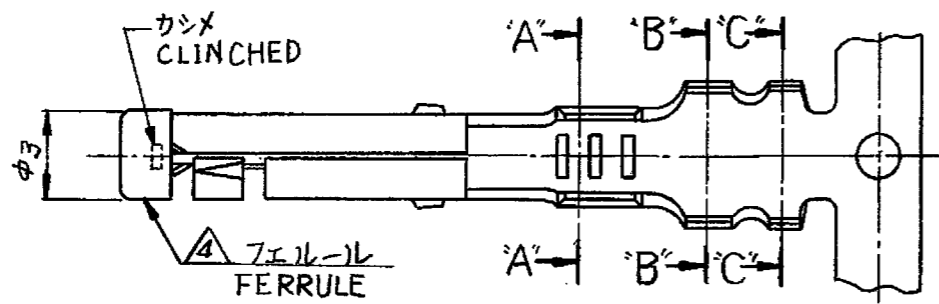

断面 'A-A'
(SECTION "A"- "A")

断面 'C-C'
(SECTION "C"- "C")

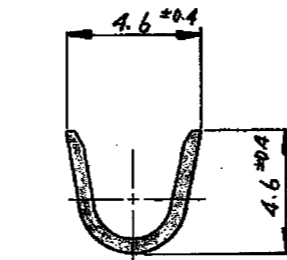
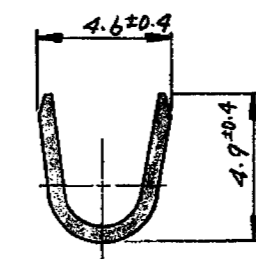
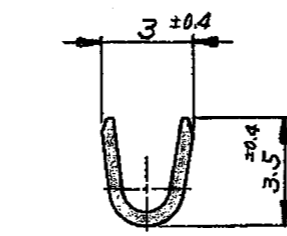

断面 'B-B'
(SECTION "B"- "B")

注:

- 嵌合相手型番 170279
 - 適用製品規格番号 108-5121
 - 適用端子圧着仕様書番号 114-5039
- △ フェルル材料: 黄銅

NOTES

- MATING COUNTERPART PART NUMBER 170279
 - APPLICABLE PRODUCT SPECIFICATION NUMBER 108-5121
 - APPLICABLE APPLICATION SPECIFICATION NUMBER 114-5039
- △ FERRULE MATERIAL: BRASS

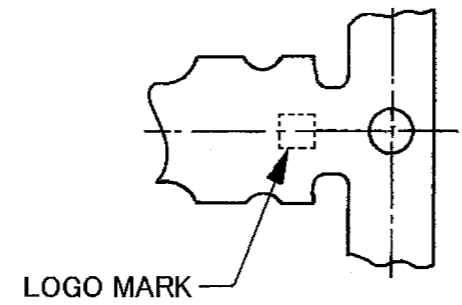
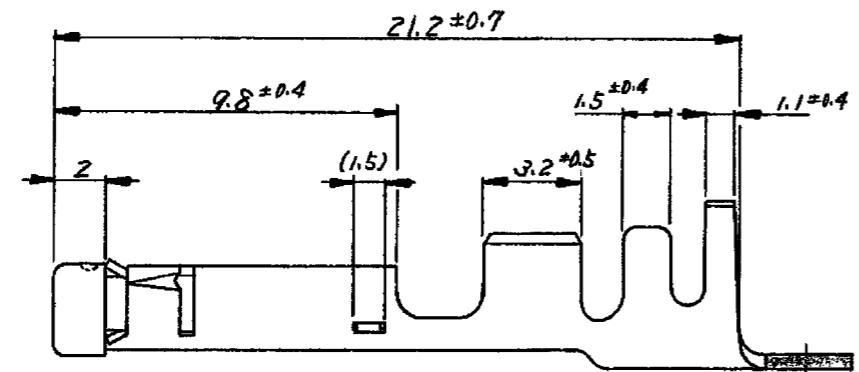
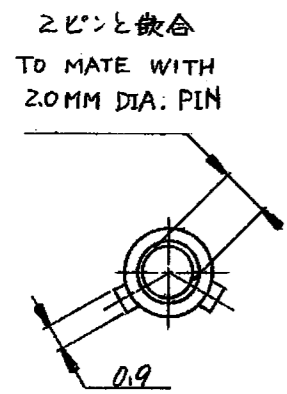

逆巻リール (REVERSED REEL)	0.32	錫めき付黄銅 (PRETIN BRASS)	1-170280-1
170293-1	0.32	錫めき付黄銅 (PRETIN BRASS)	170280-1
パラ 端子型番 (LP PART No)	備考 (REMARKS)	板厚 (STOCK THICKNESS)	材料 (MATERIAL)
	材料 (MATERIAL)	一般公差 (TOLERANCE) ± 4 (EXCEPT AS NOTED)	名称 (NAME) 2φピンリセプタクルランスレス
表参照 (SEE TABLE)	DR. X. ymas 5/19/78	適用配線範囲 (APPLICABLE WIRE RANGE) 0.5~2mm	2MM DIA PIN RECEPTACLE LANCELESS
被覆外径 (INSULATION DIAMETER) 2.2~3.4mm	CHK. Mr. Ito 5-21-78	DE. Mr. Ito 5-21-78	SIZE B LOC J 番号 (NO.) C-170280
	APP. X. ymas 5/17/78		尺度 (SCALE) 4:1 REV. C SHEET #

単位: 概 DIMENSIONS IN MM. DO NOT SCALE PRINT

LTR.	変更 (REVISION RECORD)	DR.	CHK.	DATE
C	EGR-10-018948	TS	MP	12/27/2010
B ₁	ECN J-12303	DMK	Y	3/19/78
B	ECN J80-5657	KA	JK	7/1/78
A ₁	ECN JB-5003	S.O	HN	7/30/78
A	変更	PN	YS	9/8/78
0	作成	X.Y	JK	5/26/78