

THIS DRAWING IS UNPUBLISHED. RELEASED FOR PUBLICATION. COPYRIGHT 2002 BY TE Connectivity. ALL RIGHTS RESERVED.

THE DRAWING SHOWS THE 2-DIMENSIONAL REFERENCE COMPONENT CONDITION OF THE ASSEMBLY TO IDENTIFY AND SPECIFY THE NECESSARY DIMENSIONS ONLY. THE DELIVERED PARTS MAY DEVIATE FROM THE DRAWING REGARDING THE ORIENTATION AND POSITION OF EACH COMPONENT (e.g. SLACK CABLE), SO FAR THE FUNCTIONALITY IS NOT CONCERNED.

DIE ZEICHNUNG ZEIGT DEN 2-DIMENSIONALEN IDEALZUSTAND DES ZUSAMMENBAUTEILS BEZUGLICH DER KOMPONENTEN ZUR IDENTIFIKATION UND SPEZIFIKATION DER NOTWENDIGEN DIMENSIONEN. HINSICHTLICH DER ORIENTIERUNG UND DER LAGE DER KOMPONENTEN (z.B. BIEGESCHLAFTE KABEL) KÖNNEN DIE DELIEFERTEN TEILE VON DER ZEICHNUNG ABWEICHEN, SOFERN DIE FUNKTIONALITÄT NICHT BEEINTRÄCHTIGT IST.

PROJECT NO. EGAUT00524. REVISIONS table with columns: P, LTN, DESCRIPTION, DATE, DWN, APVD.

A-A

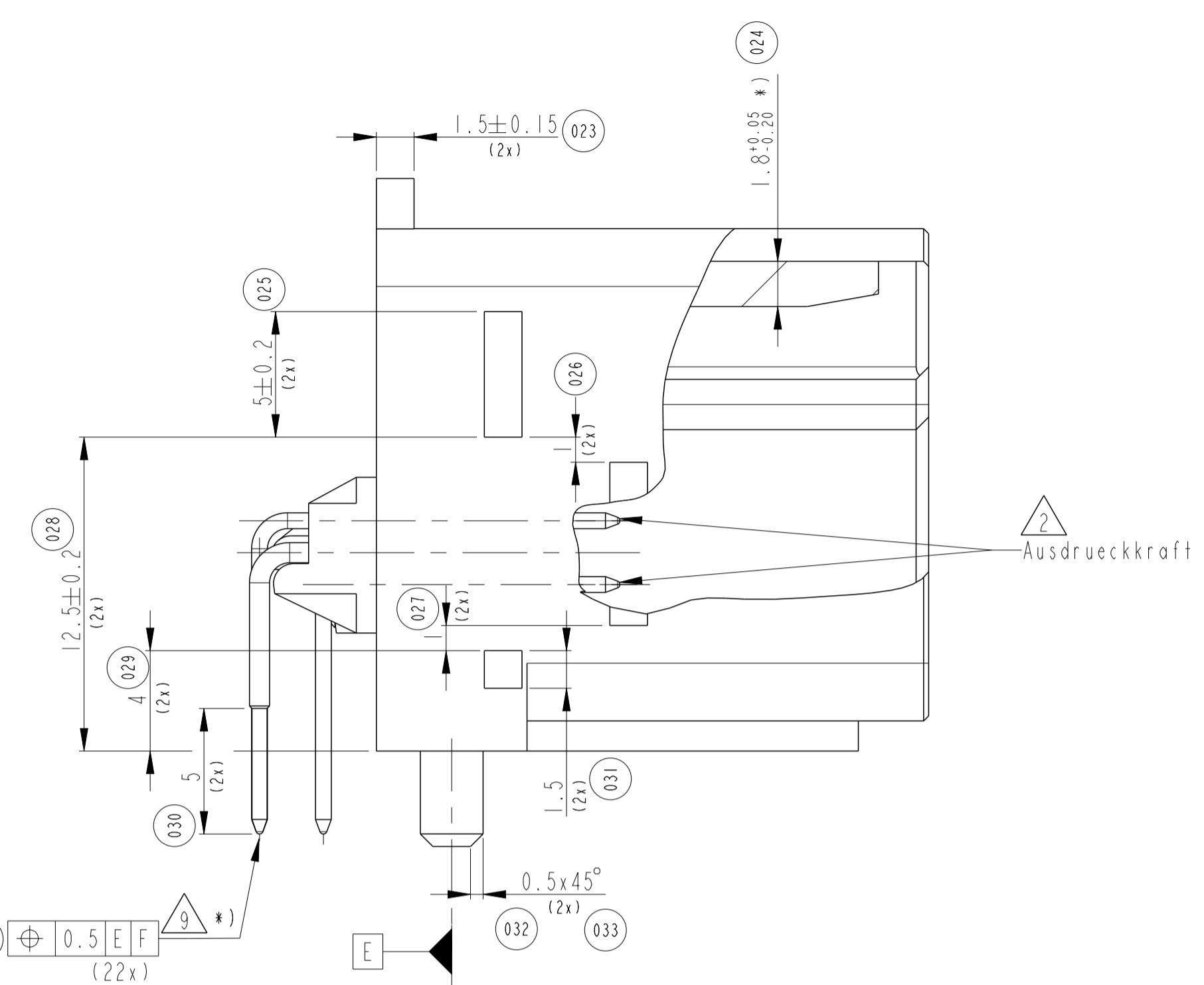
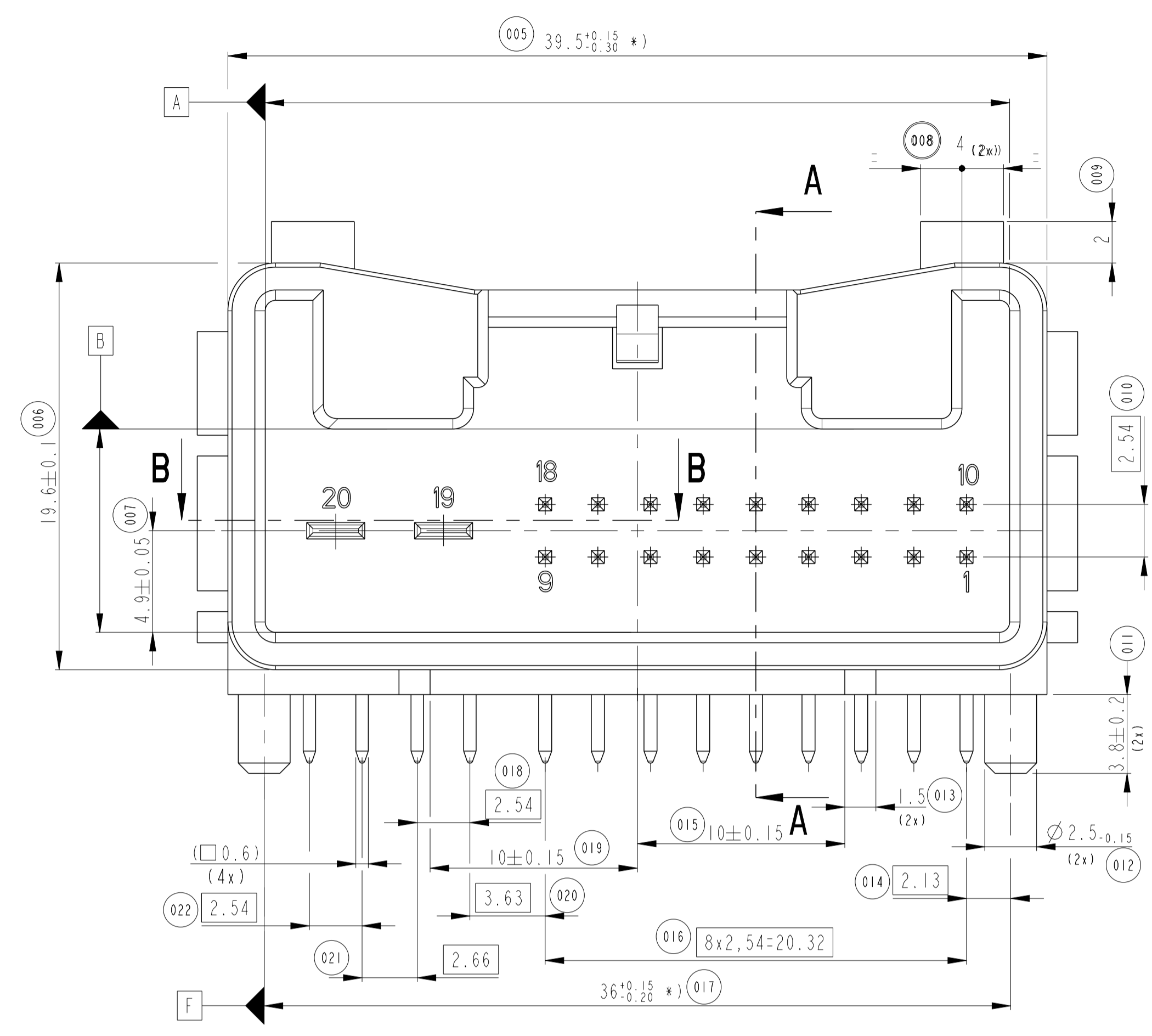
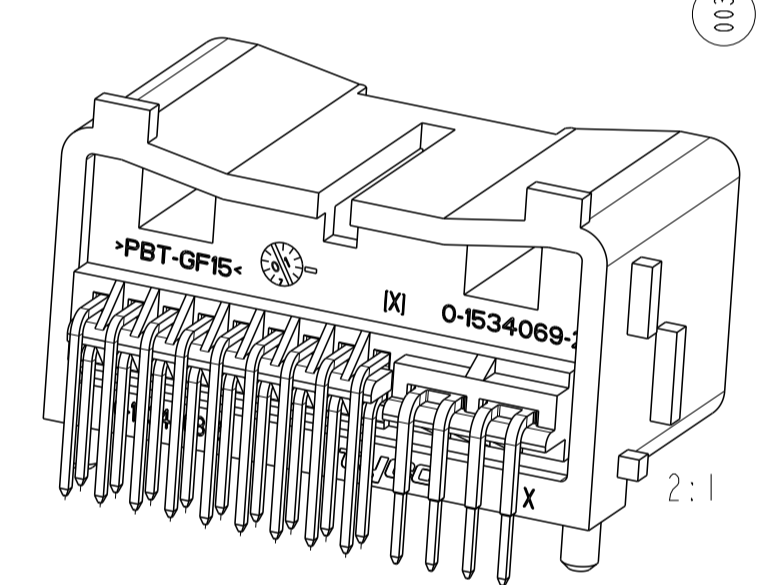
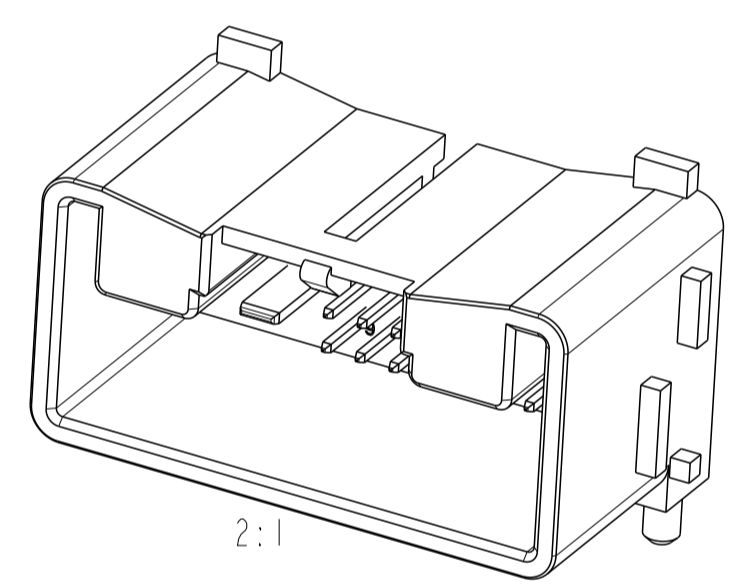
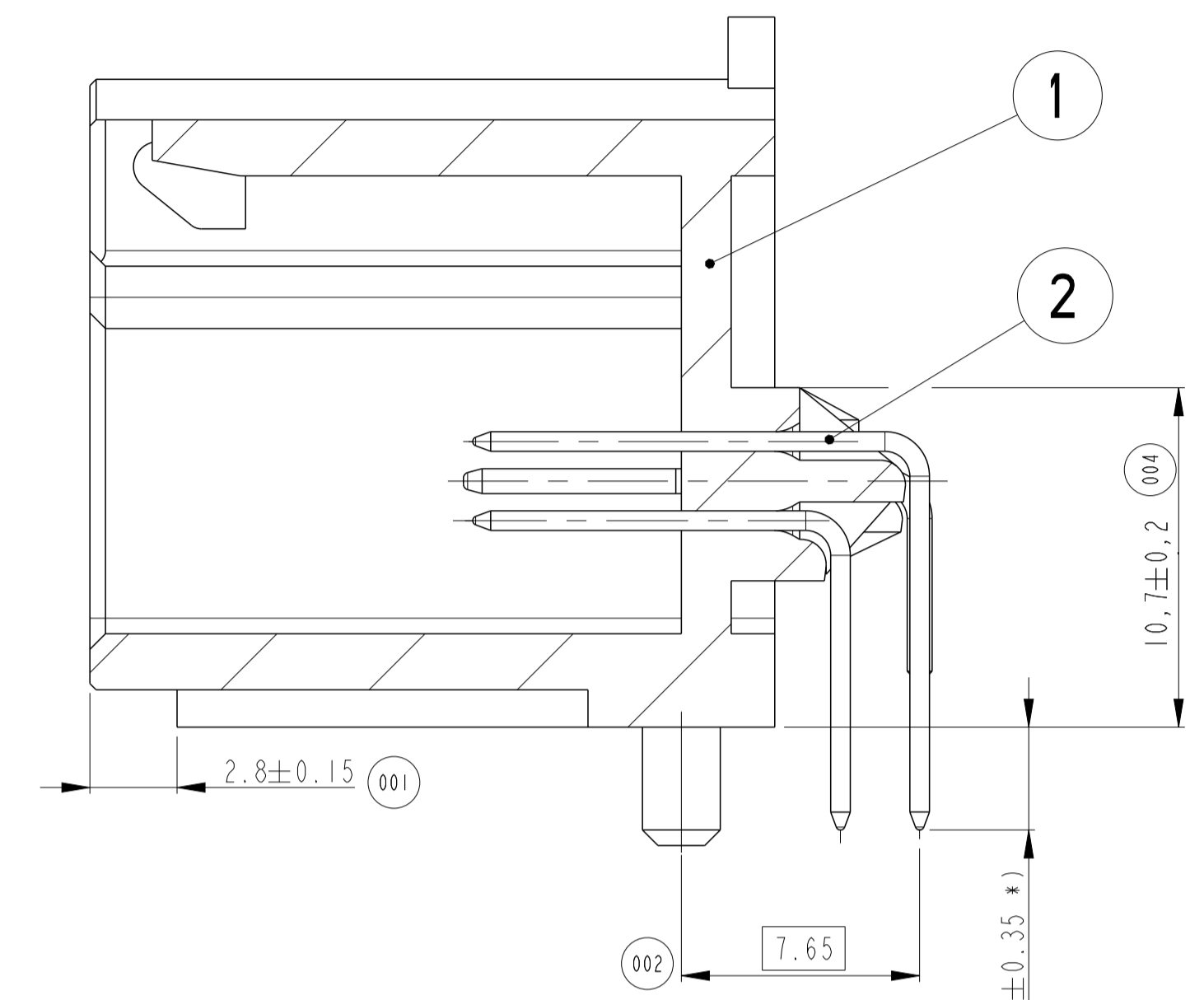

NOTES Bemerkungen

- (101) 1 SOLDERABILITY ACCORDING TO DIN IEC 68 PART 2-20. (102) 2 PIN RETENTION FORCE MIN. 40N AGAINST STITCHING DIRECTION. (103) 3 PIN RETENTION FORCE MIN. 80N AGAINST STITCHING DIRECTION. (104) 4 SURFACE POS. 4: 1-4µm Sn. (105) 5 SURFACE POS. 2+3: 1-3µm Sn OVER 1,3-2,2µm Ni IN THE MATTING AREA. (106) 6 PACKAGING ACCORDING TO SPECIFICATION VI534068 / TRAY PN 741303-1. (107) 7 SUITABLE FOR SOCKET-HOUSING TE PN 1-1394806-1 AND VW NO. 1K0 971 975. (108) 8 MISSING DIMENSIONS SEE VW INTERFACE DRAWING NO. 1K0.900.962.F. (109) 9 CHECKED BY GAUGE. (110) 10 DEVIATIONS SIGNED WITH * ONLY VALID FOR TOOLS 21-1774981 / 51-1014695.

PCB LAYOUT Leiterplatten-Layout

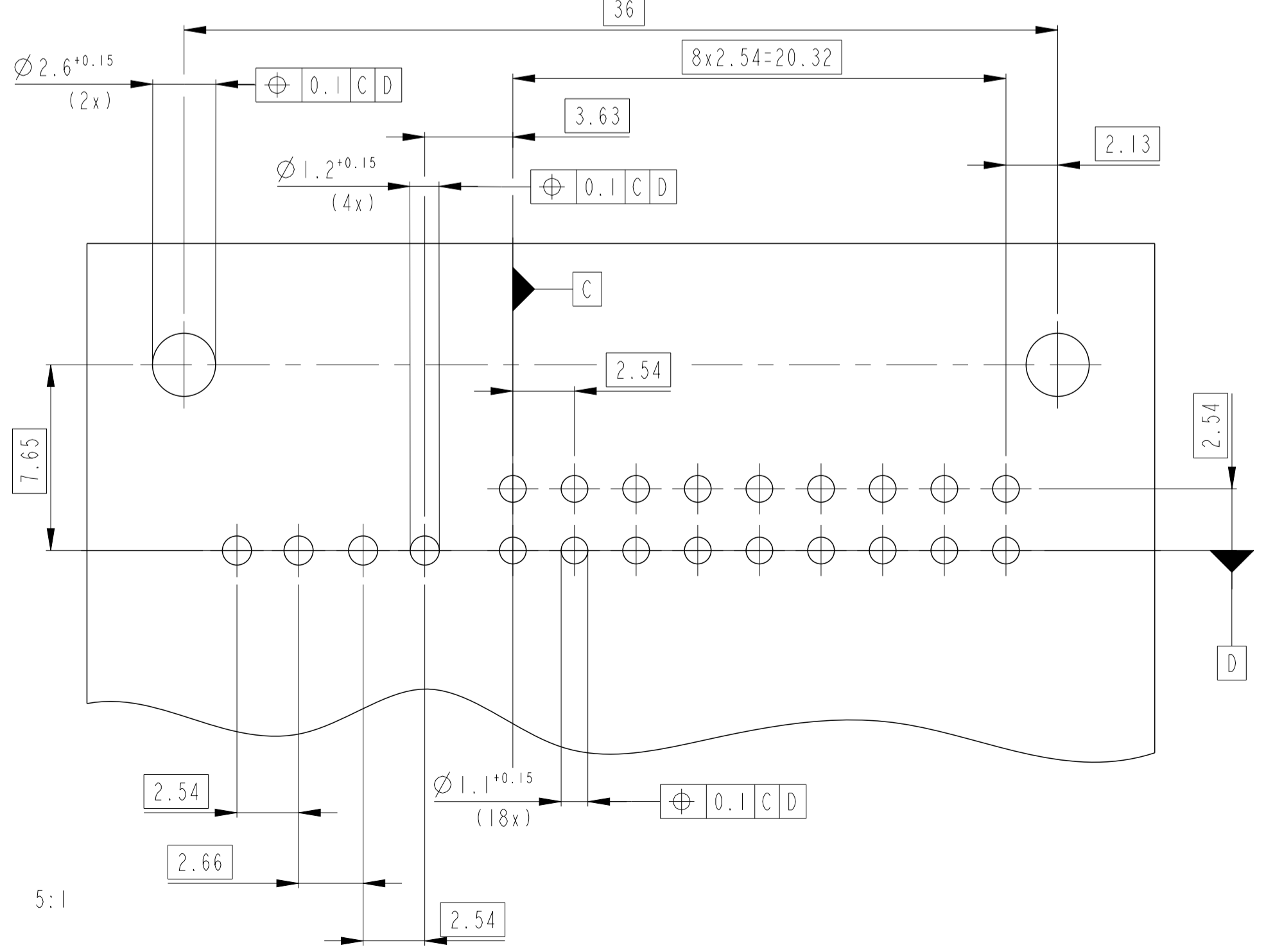

B-B

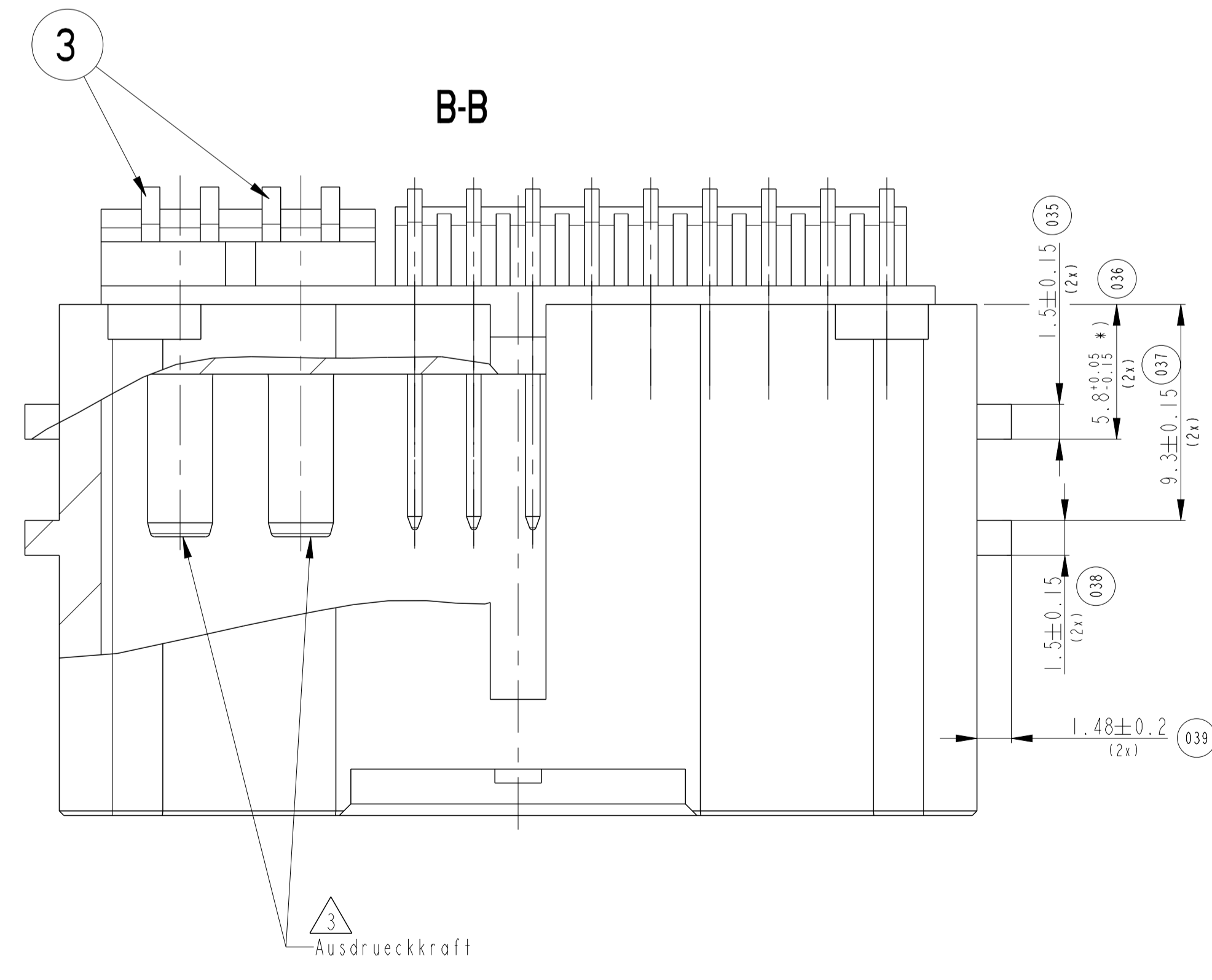

Table with columns: ASS'Y NO., REV., MATERIAL, COLOUR SURFACE, DESCRIPTION, QTY., ITEM NO. for part 0-1534068-2.

Controlled document header including DIMENSIONS (mm), TOLERANCES, MATERIAL, WEIGHT, CUSTOMER DRAWING, and TE Connectivity logo.