

NUMBER  
C153226

3rd ANGLE (AMERICAN) PROJECTION

DIMENSIONS IN INCHES. DO NOT SCALE PRINT  
DIMENSIONS THUS [ ] IN MM.

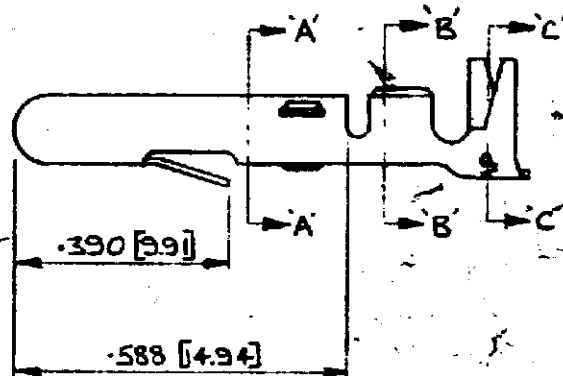
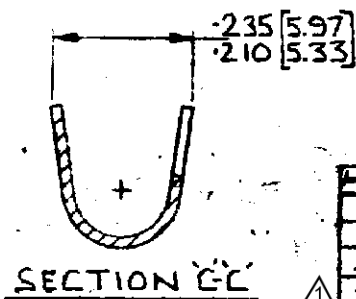
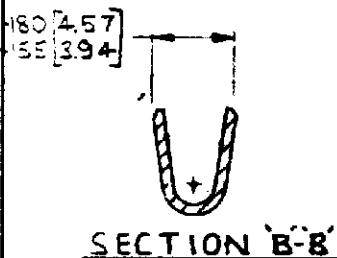
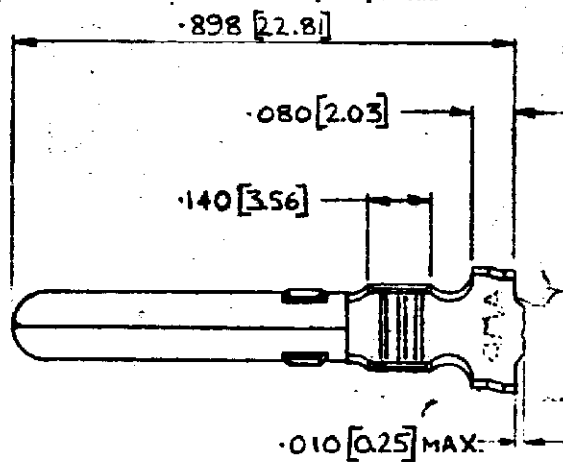
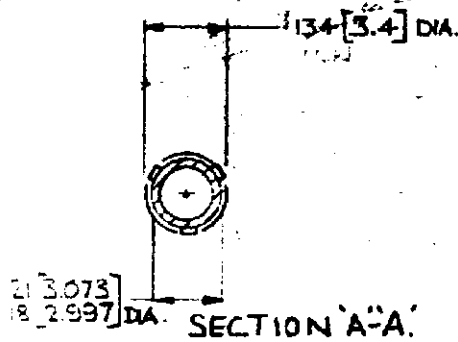

△ OBSOLETE

INSULATION: 170-170 [4.32]

PART NO.	FINISH	MATERIAL
153226-1	PRE-TIN	BRASS (REVERSE SIDE)
153226-5	PRE-TIN	PHOS BRONZE
153226-4	ELECTRO-TIN	BRASS
153226-3	NONE	PHOS BRONZE
153226-2	NONE	BRASS
153226-1	PRE-TIN	BRASS

REV.	REVISION RECORD	DATE
L	REVISED PER ECR-21-101087	05MAY2021
K	WIRE BAREL SCRIBATIONS ADDED	
J	.134 DIA. MAIN AXIAL	
H	170-170 ADDED TO LIST	
G	REDRAWN MACHINE	
F		
E		
D		
C		
B		
A		

AMP of GREAT BRITAIN LTD  
1971.

CUSTOMER COPY  
REFERENCE ONLY

MATERIAL AND FINISH	CLASS	TYPE
013 [2.33]		
WIRE - RANGE - INSULATION		
20-35ML		
SEE TABLE		
STOCK #		
SCALE		
1:1		
REF. NO.		
E A C153226		
REV. NO.		
M1		

115 [3] DIA. LANCED PIN.