

THIS DRAWING IS UNPUBLISHED.

RELEASED FOR PUBLICATION

20

© COPYRIGHT 20 BY - ALL RIGHTS RESERVED.

REVISIONS

P	LTR	DESCRIPTION	DATE	DWN	APVD
E		ECR-09-007414	01JUN2009	KG	DW
F		ECR-19-004234	18MAR2019	TS	DW

1. USE WITH FERRULE ASSEMBLY KIT P/N 1588908-1.

2 PROTECTIVE LABEL APPLIED AFTER FINAL CLEAN ROOM TEST TO PREVENT OPTICAL CAVITY CONTAMINATION. REMOVE ONLY WHEN READY TO ASSEMBLE.

3 MULTIMODE IDENTIFIER.

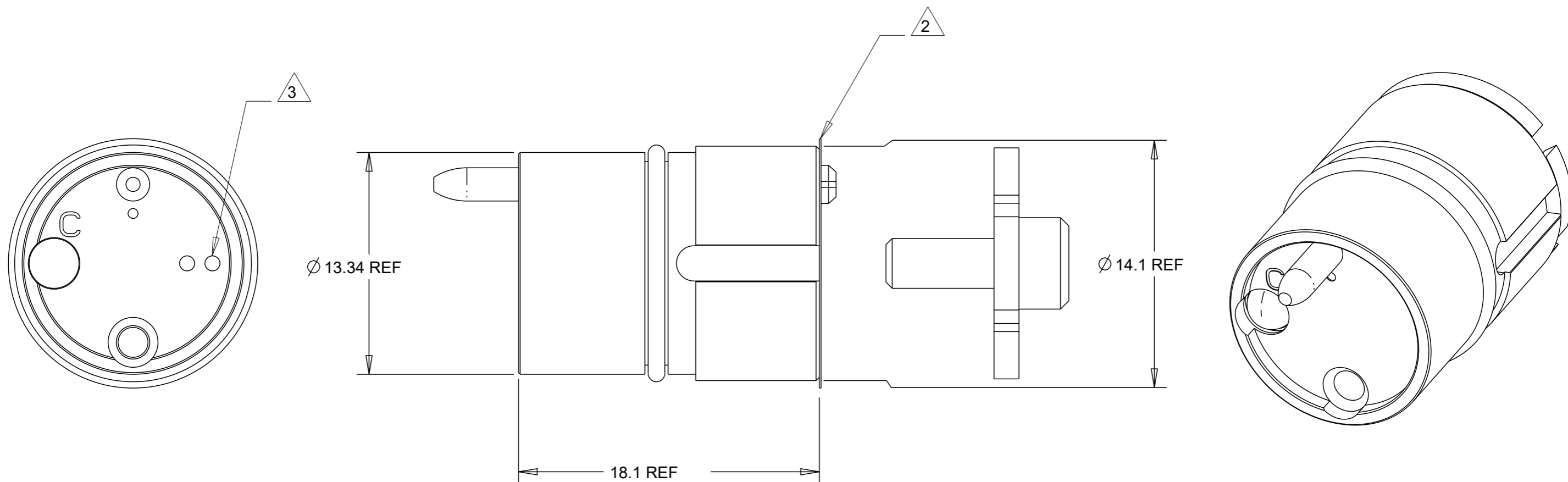

1 CHANNEL, 850/1300nm MM	1515737-1
DESCRIPTION	PART NUMBER

THIS DRAWING IS A CONTROLLED DOCUMENT.		DWN	07JAN2004		
DIMENSIONS:		CHK	07JAN2004		
mm		APVD	08JAN2004		
		PRODUCT SPEC	-		
TOLERANCES UNLESS OTHERWISE SPECIFIED:		APVD	08JAN2004	NAME	
0 PLC	±-	D. WERTMAN		INSERT ASSEMBLY, PRO BEAM JR.,	
1 PLC	±-	D. WERTMAN		1 CH, 850/1300nm, MM	
2 PLC	±-			-	
3 PLC	±-			SIZE	CAGE CODE
4 PLC	±-			A3	00779
ANGLES	±-			DRAWING NO	RESTRICTED TO
	±-			C-1515737	
MATERIAL	FINISH	WEIGHT	-	SCALE	SHEET
STAINLESS ALLOYS & NBR	N/A			4:1	1 OF 1
	-				REV
					F