

REVISIONS				
P.	LTN.	DESCRIPTION	DATE	APPROV.
B6	ECR-13-017490		24OCT2013	SR VC
B7	ECR-19-008364		29MAY2019	JPN NR

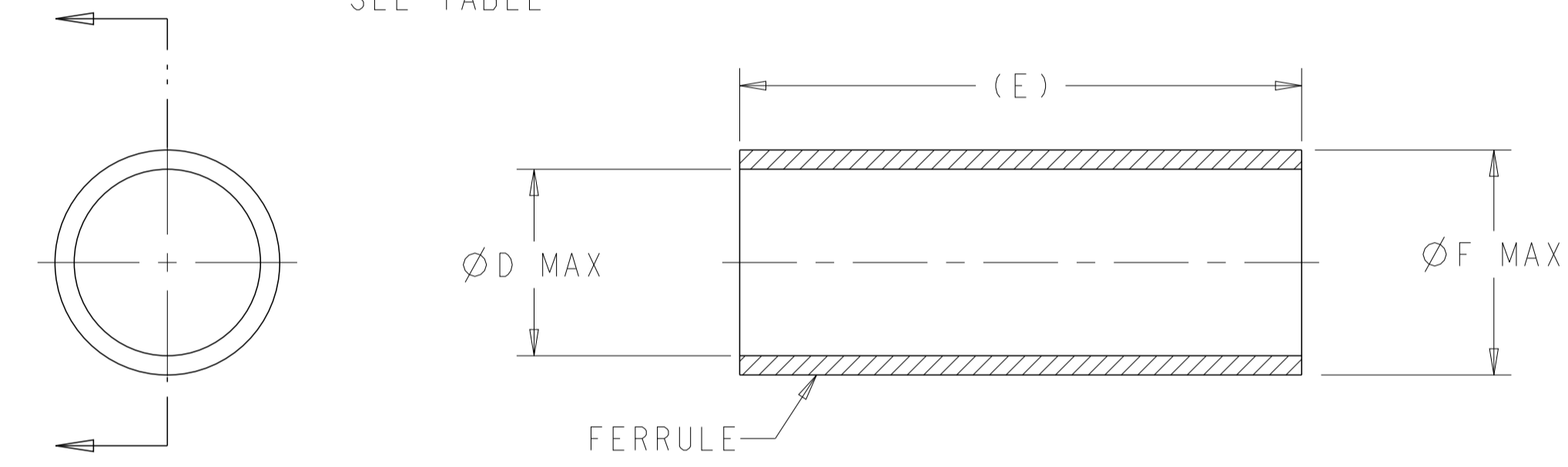

CONTACT KIT		REPLACEMENT ONLY				
COMPONENTS		MATERIAL	FINISH		MATERIAL	FINISH
SUBASSEMBLY	OUTER SHELL	ZP0410	OUTER SURFACE: min. 2 µm Sn over min. 1,27 µm Ni both over min. 5,08 µm Cu INNER SURFACE: min. 0,3 µm Sn over min. 0,5 µm Ni both over min. 2 µm Cu		ZP0410	OUTER SURFACE: min. 2 µm Sn over min. 1,27 µm Ni both over min. 5,08 µm Cu INNER SURFACE: min. 0,3 µm Sn over min. 0,5 µm Ni both over min. 2 µm Cu
	DIELECTRIC	PE BLUE	-		PP	GREEN COLOUR LOCAL DISCOLORATION ALLOWED
CENTER CONTACT	-	CuZn SCREW MACHINED	min. 0,8 µm Au over min. 1,27 µm Ni		CuSn STAMPED AND BENT	Zone I: min. 0,8 µm Au over min. 1,25 µm Ni Zone II: min. 0,1 µm Ni Zone III: min. 2 µm Sn over min. 0,1 µm Ni
FERRULE	-	SfCu	min. 1,25 µm Ni		SfCu	min. 1,25 µm Ni

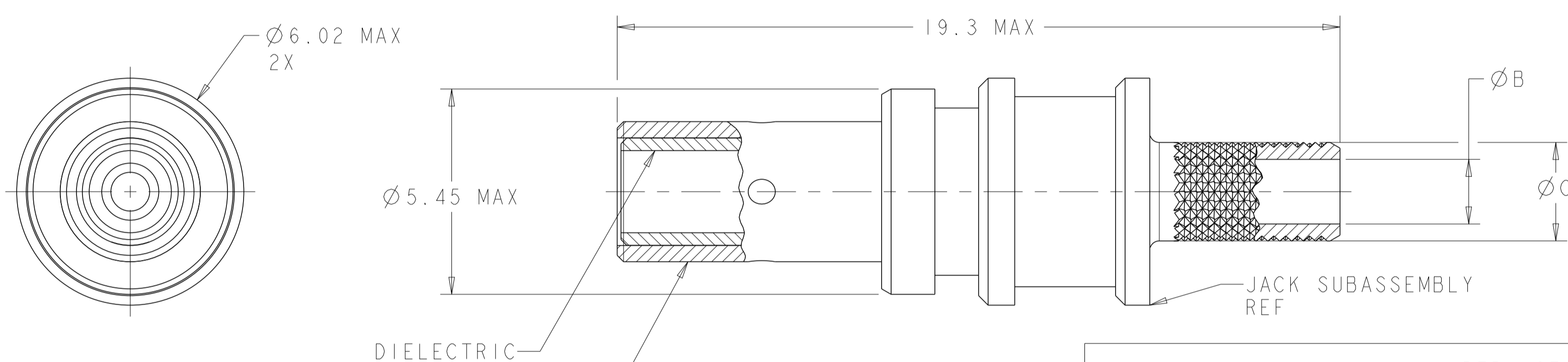
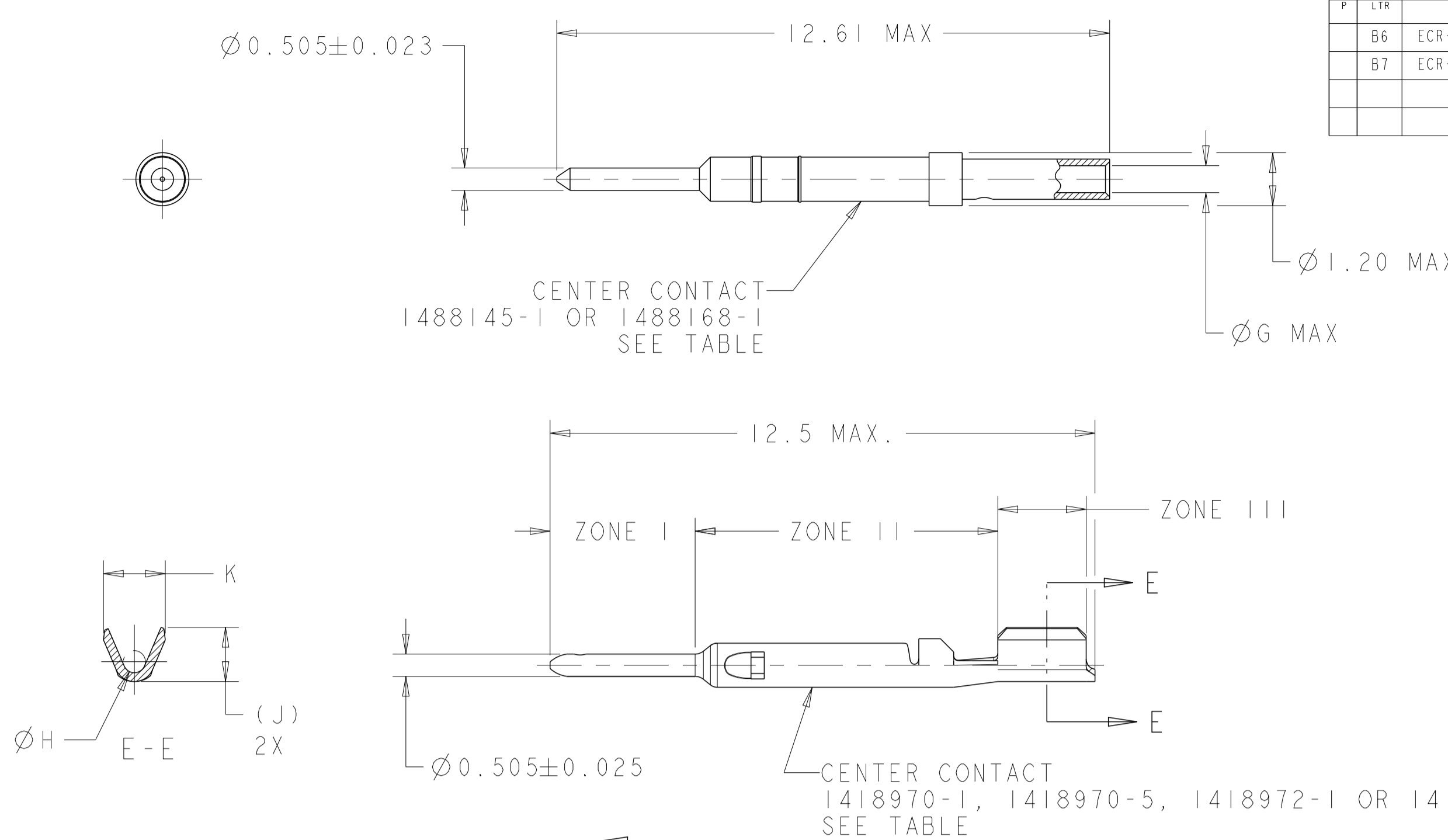
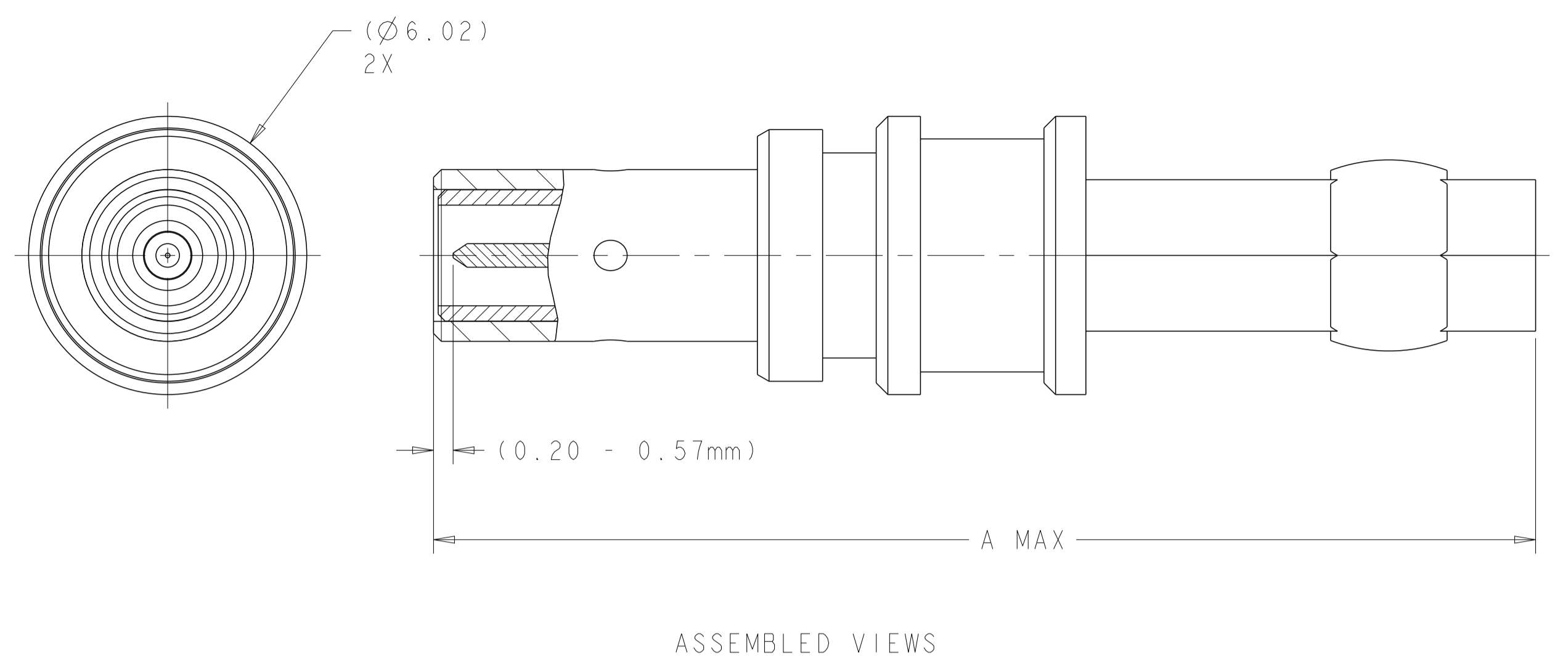
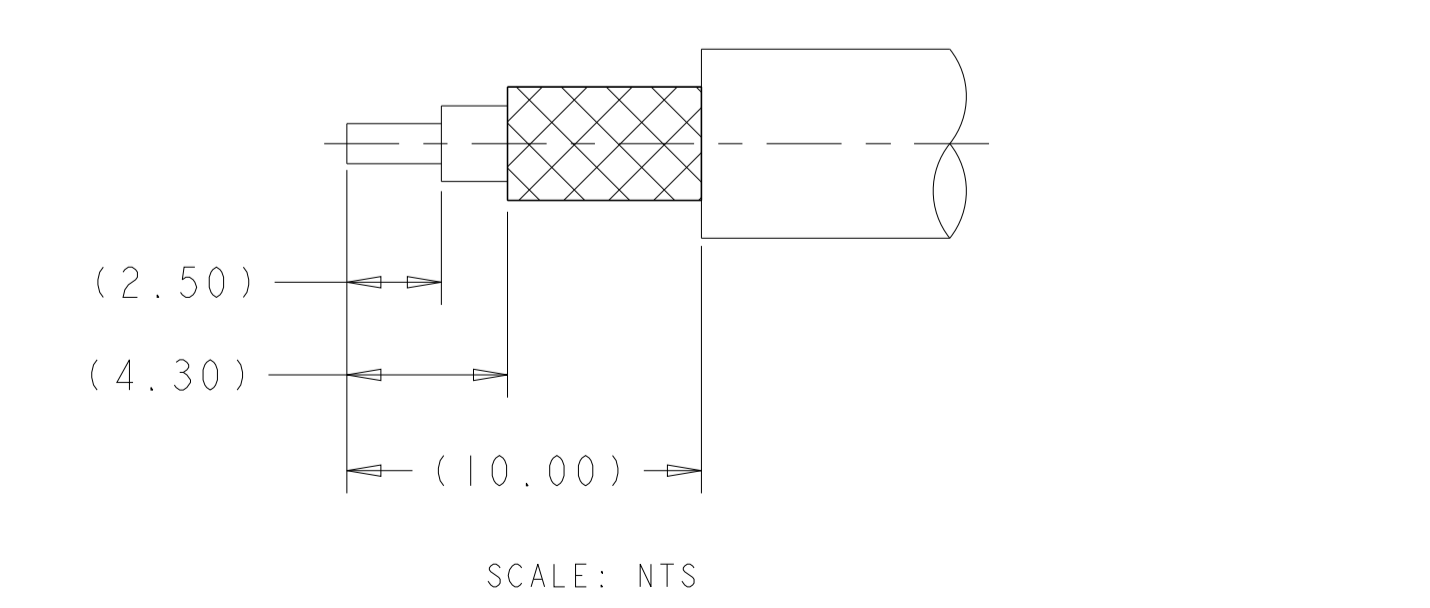

1.8±0.3	1.85	0.80 MAX.	-	4.75	9.5	3.80	3.20	2.33±0.03	24.3	1418972-5 STAMPED AND BENT	RTK031	A	1488171-5	CENTER CONTACT SUBASSEMBLY FERRULE	1418972-5 1488170-2 1488167-1	△	
1.4±0.3	1.3	0.60 MAX.	-	3.91	9.65	3.25	2.59 ^{+0.05} _{-0.08}	1.65	24.2	1418970-5 STAMPED AND BENT	RG-174	A	1488147-5	CENTER CONTACT SUBASSEMBLY FERRULE	1418970-5 1488146-2/-3 1-413889-3	△ B7	
1.8±0.3	1.85	0.80 MAX.	-	4.75	9.5	3.80	3.20	2.33±0.03	24.3	1418972-1 STAMPED AND BENT	RTK031	C	1488171-2	CENTER CONTACT SUBASSEMBLY FERRULE	1418972-1 1488170-2 1488167-1	△	
1.4±0.3	1.3	0.60 MAX.	-	3.91	9.65	3.25	2.59 ^{+0.05} _{-0.08}	1.65	24.2	1418970-1 STAMPED AND BENT	RG-174	C	1488147-2	CENTER CONTACT SUBASSEMBLY FERRULE	1418970-1 1488146-2/-3 1-413889-3	△ B7	
REPLACEMENT ONLY	-	-	-	0.92	4.75	9.5	3.80	3.20	2.33±0.03	24.3	1488168-1 SCREW MACHINED	RTK031	C	1488171-1	CONTACT KIT	1488171-1	
REPLACEMENT ONLY	-	-	-	0.64	3.91	9.65	3.25	2.59 ^{+0.05} _{-0.08}	1.65	24.2	1488145-1 SCREW MACHINED	RG-174	C	1488147-1	PIN CONTACT SUBASSEMBLY FERRULE	1488145-1 1488146-1 1-413889-3	△ B7
	K	J	H	G	F	E	D	C	B	A	CENTER CONTACT	CABLE	CONTACT KIT REV	CONTACT KIT PART NUMBER	PART NUMBERS FOR PLACING ORDER		

1. THE CONNECTION HAS TO FULFILL THE DIMENSIONAL, MECHANICAL AND ELECTRICAL REQUIREMENTS OF SAE/USCAR 17 REV. 2 AND OF DIN 72594-1 RELEASED MARCH 2006.
 △ COMPONENTS OF CONTACT KITS 1488147-2, 1488147-5, 1488171-2 AND 1488171-5 MUST BE PURCHASED SEPARATELY.

THIS DRAWING IS A CONTROLLED DOCUMENT.

DIMENSIONS:	TOLERANCES UNLESS OTHERWISE SPECIFIED:	DATE	APPROV.
mm	ISO 2768-M S	30SEP2002	D. J. HARDY
	0 PLC ±0.05	02OCT2002	O. DE CLOET
	1 PLC ±0.05	02OCT2002	O. DE CLOET
	2 PLC ±0.05		
	3 PLC ±0.05		
	4 PLC ±0.05		
	ANGLES ±0.1		
MATERIAL	FINISH	WEIGHT	
SEE TABLE	SEE TABLE		

CUSTOMER DRAWING

SCALE 10:1 SHEET 1 OF 1 REV B7

STE TE Connectivity

JACK KIT, UNASSEMBLED, HF, FAKRA II

SIZE CAGE CODE DRAWING NO RESTRICTED TO

A1 - C=1488570