

REVISIONS					
P	LTR	DESCRIPTION	DATE	DWN	APVD
	A1	REVISED PER ECR-21-103794	03JUN2021	RS	WK

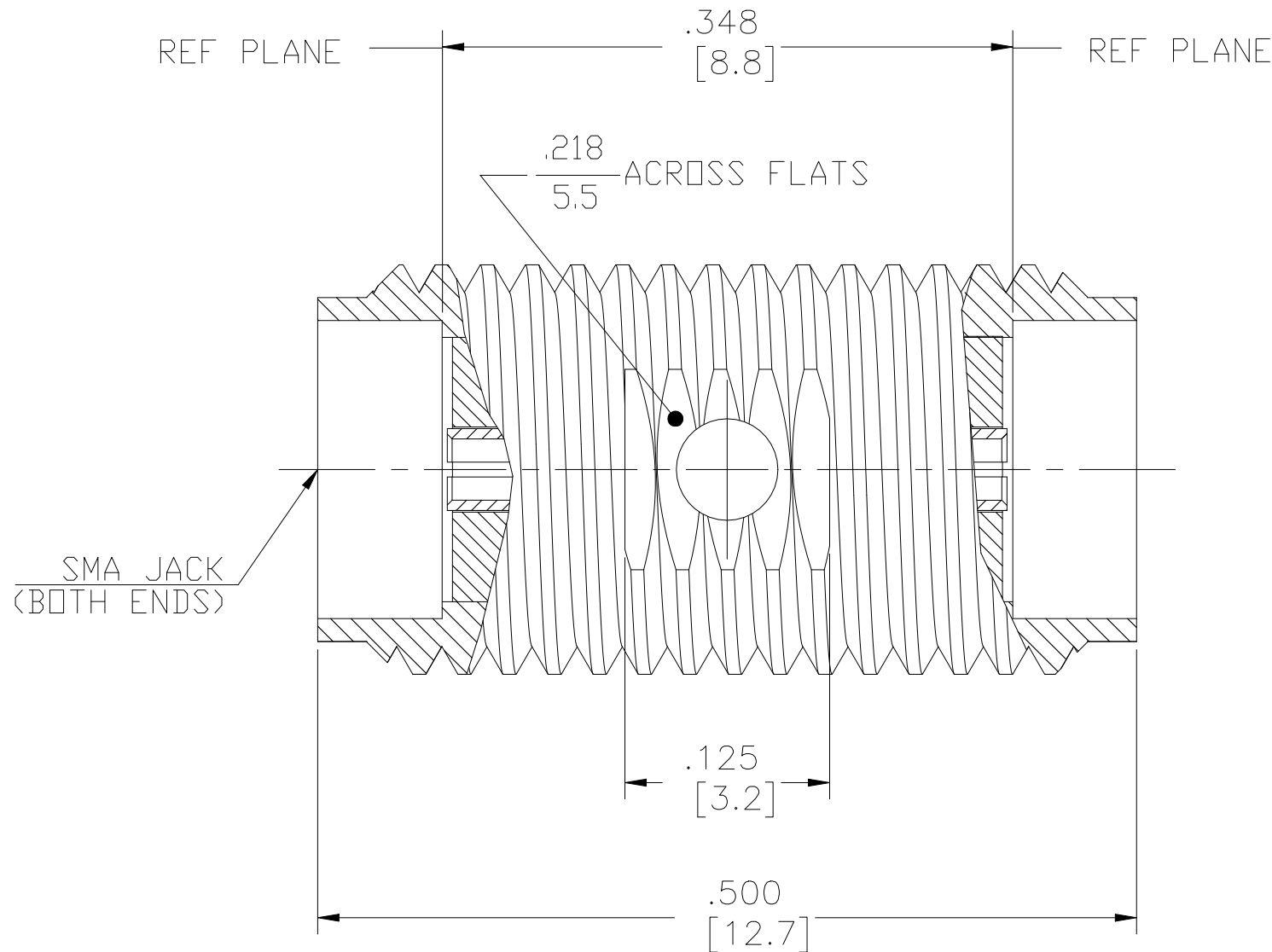

ELECTRICAL	MECHANICAL	ENVIRONMENTAL
Nominal Impedance (Ohms) 50	Interface Dimensions MIL-STD-348A, Fig. 310.2	Temperature Rating -65°C To 165°C
Frequency Range (GHz) DC to 18	Recommended Mating Torque 7 - 10 in-lbs	Vibration MIL-STD-202, Method 204, Condition D
Volt Rating (VRMS MAX) @ Sea Level 335	Mating Characteristics: Insertion (MAX Lbs) 3.0	Shock MIL-STD-202, Method 213, Condition I
VSWR 1.05 + .005 f(GHz)	Withdrawal (MIN Oz) 1.0	Thermal Shock MIL-STD-202, Method 107, Condition C,
Insertion Loss (dB MAX) .06 √f(GHz)	Force to Engage and Disengage (In/Lbs MAX) 2.0	Moisture Resistance MIL-STD-202, Method 106, Except Vibration Shall Be Omitted
RF Leakage (dB MIN) -[60-f(GHz)]	Center Contact Captivation Axial (Lbs) 6.0	Corrosion - MIL-STD-202, Method 101, Condition B, 5% salt spray
Corona, 70,000 Ft (VRMS MIN) 250	Radial (In/Oz) N/A	
Dielectric Withstanding Voltage (VRMS MIN) @ Sea Level 1500	Cable Retention Axial Force (Lbs) N/A	
Contact Resistance (Milliohms MAX) Center Contact 4.0	Torque (In/Oz) N/A	
Outer Contact 2.0	Weight (Grams) 2.0	
Cable to Housing N/A		
RF High Potential @ Sea Level (VRMS MIN @ 5 MHz) 670		
I.R.(Megohms MIN) 5.0		

.XXX = in  
XX.X = mm

THIS DRAWING IS A CONTROLLED DOCUMENT.

DIMENSIONS: INCHES	TOLERANCES UNLESS OTHERWISE SPECIFIED:
	0 PLC ± -
	1 PLC ± -
	2 PLC ± -
	3 PLC ± .005
	4 PLC ± -
	ANGLES ± 1°
MATERIAL	FINISH
-	1/64

QUANTITY PER ASSY	PARTS LIST			
1	Au	STAINLESS STEEL	HOUSING	3
1	-	PTFE	INSULATION	2
1	Au	BeCu	CENTER CONTACT	1
-1	PLATING	MATERIAL	DESCRIPTION	ITEM

STE TE Connectivity

SMA JACK TO JACK ADAPTER

DWN BWC 6/9/67	NAME	SIZE	CAGE CODE	DRAWING NO	RESTRICTED TO
CHK D.F 7/1/68		A3	00779	C-1053488	-
APVD J. E. 7/5/68					
PRODUCT SPEC					
APPLICATION SPEC					
WEIGHT -					

CUSTOMER DRAWING SCALE 1:1 SHEET 1 OF 1 REV A1