

## UTILUX ALUMINIUM SECTOR CRIMP LINKS AKS3 & AKS4 TYPE

### KEY FEATURES

- Clear markings on barrel to indicate correct crimping sequence
- Prefilled with jointing compound
- Suit 3 core 120° or 4 core 90° solid sector aluminium conductor
- 99.9% pure, high conductivity aluminium
- Individually packed in sealed plastic bags
- Alternative sizes made to order

Utilux is a brand that has built an enviable reputation for high quality, reliable electrical connectors. For over 90 years, this dynamic Australian brand has been a leader in the field of interconnection systems.

Our aim is to provide the best possible products and services to keep our customers at the cutting edge of industry standards - internationally.

You can be sure that Utilux branded products are fabricated from the finest materials and produced to exacting tolerances. They represent the latest technology and the best design for the tasks they are required to perform.

Utilux is a leading brand of electrical connectors sold to original equipment manufacturers and electrical distribution companies throughout Australia, New Zealand and Asia. A comprehensive range, the most up to date production technology and the highest quality control standards ensure that there are Utilux connectors, of optimum reliability and durability, for all major power distribution applications.

As part of the worlds largest electrical connector company, TE Connectivity, the development of products is an ongoing commitment. It is done on a global basis, utilising the talents of many people throughout the organisation to ensure a global product for a local market.

**Customers can count on consistent, high quality products, driven by TE's proven innovation and backed by our extraordinary customer support.**

## UTILUX ALUMINIUM SECTOR CRIMP LINKS



Utilux Aluminium Lugs and Links are manufactured from high conductivity aluminium.

Markings are used to clearly identify the cable to be used, die combination and crimping sequence.

Care should be taken in the preparation of aluminium conductors to ensure proper scratch brushing and inhibiting compound is applied.

### 3 CORE SECTOR PRODUCT SELECTION INFORMATION

| Catalogue Number | Conductor Area (mm <sup>2</sup> ) | Dimensions (mm) |  |  |  | Tool No. | Nest | Indent |
|------------------|-----------------------------------|-----------------|--|--|--|----------|------|--------|
|                  |                                   | A               |  |  |  |          |      |        |
| AKS3I120         | 120                               | 90              |  |  |  | 38A      | 12   | 16     |
| AKS3I150         | 150                               | 90              |  |  |  | 38A      | 12   | 17     |
| AKS3I185         | 185                               | 105             |  |  |  | 38A      | 12   | 18     |
| AKS3I240         | 240                               | 110             |  |  |  | 38A      | 12   | 19     |

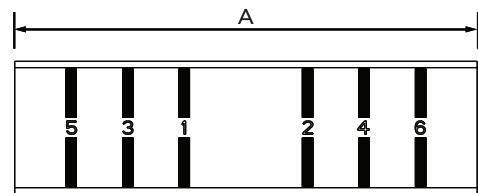

### 3 CORE SECTOR TO ROUND PRODUCT SELECTION INFORMATION

| Catalogue Number | Conductor Area (mm <sup>2</sup> ) |       | Dimensions (mm) |      |    |    | Round End Hexcrimp Die | Sector Crimp |        |
|------------------|-----------------------------------|-------|-----------------|------|----|----|------------------------|--------------|--------|
|                  | Sector                            | Round | A               | G    | H  | I  |                        | Nest         | Indent |
| AKS3I185-240     | 185                               | 240   | 149             | 21   | 57 | 60 | 38-284AL               | 12           | 18     |
| AKS3I240-300     | 240                               | 300   | 148             | 23.5 | 61 | 60 | 38-284AL               | 15           | 20     |

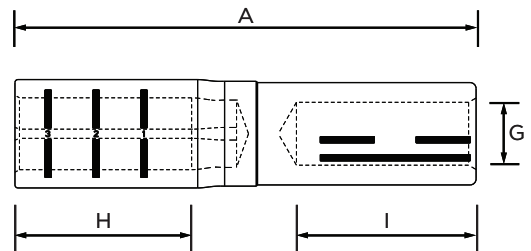

### 4 CORE SECTOR TO ROUND PRODUCT SELECTION INFORMATION

| Catalogue Number | Conductor Area (mm <sup>2</sup> ) |       | Dimensions (mm) |      |    |    | Round End Hexcrimp Die | Sector Crimp |        |
|------------------|-----------------------------------|-------|-----------------|------|----|----|------------------------|--------------|--------|
|                  | Sector                            | Round | A               | G    | H  | I  |                        | Nest         | Indent |
| AKS4I240-240     | 240                               | 240   | 149             | 23.5 | 61 | 60 | 38-284AL               | 15           | 19     |
| AKS4I240-300     | 240                               | 300   | 149             | 21   | 61 | 60 | 38-284AL               | 15           | 19     |

[te.com/energy](http://te.com/energy)

©2016 TE Connectivity Ltd. family of companies. All Rights Reserved. EPP-2487-DDS23-AU-2/16

Utilux, TE Connectivity and TE Connectivity (logo) are trademarks. Other logos, product and/or company names might be trademarks of their respective owners. While TE has made every reasonable effort to ensure the accuracy of the information in this brochure, TE does not guarantee that it is error-free, nor does TE make any other representation, warranty or guarantee that the information is accurate, correct, reliable or current. TE reserves the right to make any adjustments to the information contained herein at any time without notice. TE expressly disclaims all implied warranties regarding the information contained herein, including, but not limited to, any implied warranties of merchantability or fitness for a particular purpose. The dimensions in this catalog are for reference purposes only and are subject to change without notice. Specifications are subject to change without notice. Consult TE for the latest dimensions and design specifications.

#### FOR MORE INFORMATION:

#### TE Customer Support Centers

|                 |                   |
|-----------------|-------------------|
| NSW/QLD/NT/ACT: | +61 (2) 9554 2695 |
| VIC/TAS/SA:     | +61 (3) 9271 5243 |
| WA:             | +61 (8) 9358 7806 |
| New Zealand:    | +64 (9) 634 4580  |