

REV
F WHDS-18-1

| REVISIONS | | | |
|-----------|---------------------------------|----------|----------|
| SYM | DESCRIPTION | DATE | APPROVED |
| C | REVISED/REDRAWN PER E.O. A14840 | 05/08/95 | R.D.R. |
| D | REVISED PER E.O. P15468 | 11/7/97 | R.D.R. |
| E | REVISED PER E.O. P18579 | 6/14/04 | R.D.R. |
| F | REVISED PER E.O. P19027 | 8-3-05 | RDR |

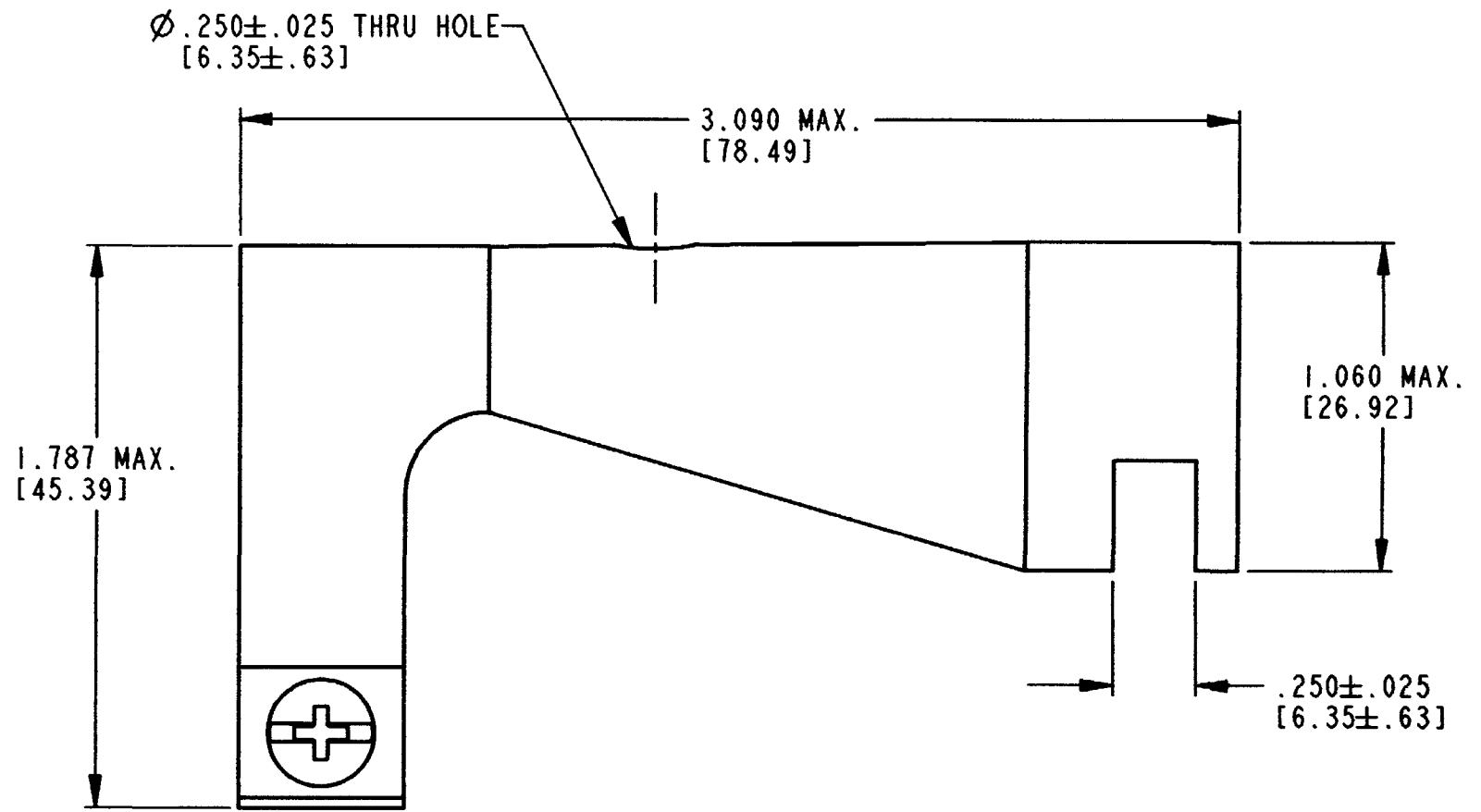
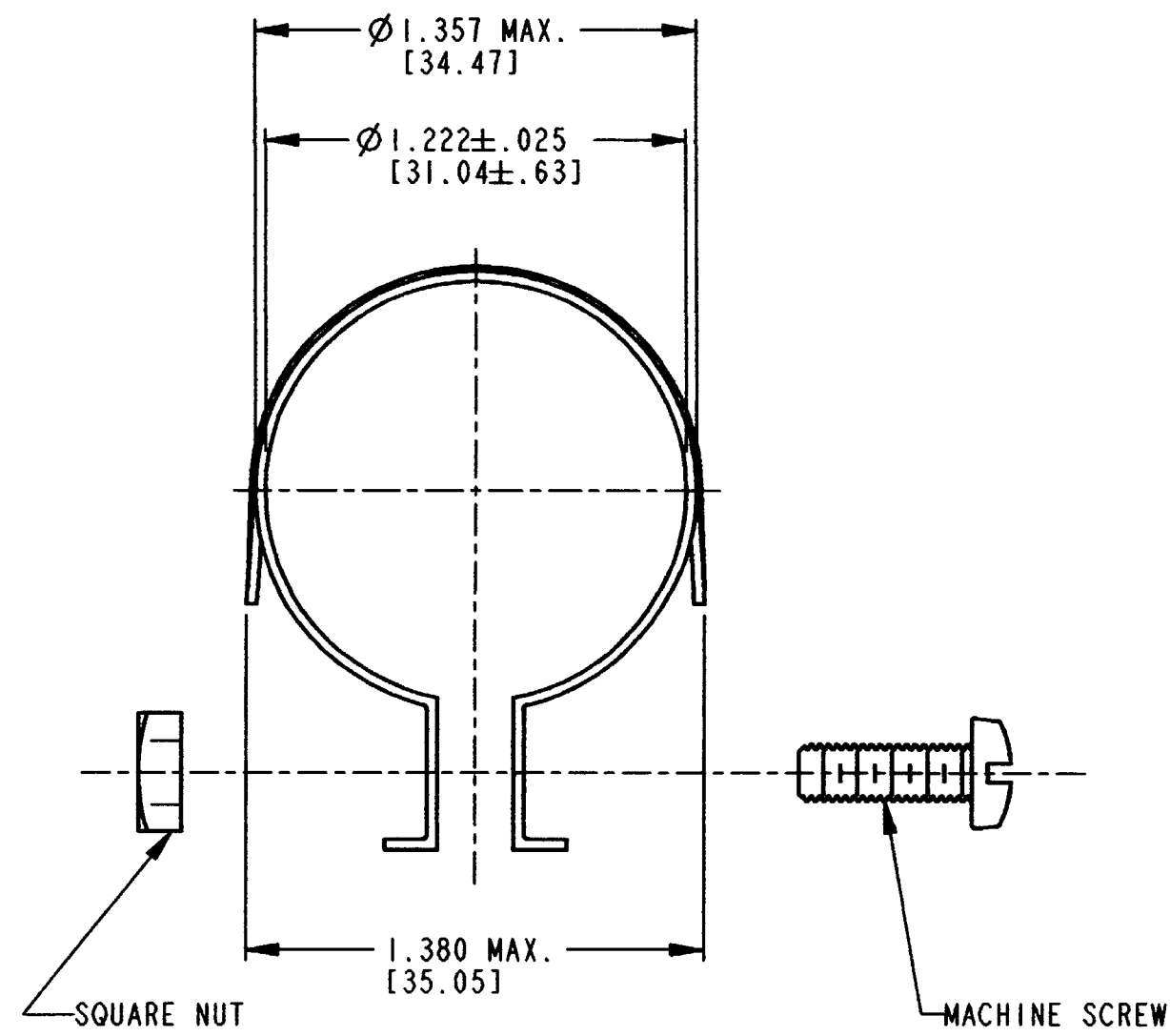

- 5. MACHINE SCREW TORQUE RANGE: 7-10 IN LBS [0.79-1.13 NM].
- 4. MATERIAL: STEEL.
- 3. FINISH: TIN OVER NICKEL PLATE.
- 2. PARTS SHIPPED UNASSEMBLED.

NOTES: 1. DIMENSIONS ARE IN INCHES [MILLIMETERS] UNLESS OTHERWISE SPECIFIED.

| | | | | | |
|------------------|-----------------------------|--|---|------------|------------|
| SIGNATURE & DATE | | CLAMP, STRAIGHT BODY SIZE 18 HD SERIES | CP | MATL. CODE | |
| DR | L. MAGANA 5/2/95 | | The Deutch Company DEUTSCH I.P.D. 3850 INDUSTRIAL AVE. HEMET, CALIF. 92545 | | |
| CHK | <i>[Signature]</i> 11/21/05 | | B | WHDS-18-1 | |
| PE | <i>[Signature]</i> 8/21/05 | | | DWG SIZE | CODE 11139 |
| APPD | <i>[Signature]</i> 8/29/05 | ENVELOPE | | | |
| SCALE | NONE | WT | | | |