

3D VIEW

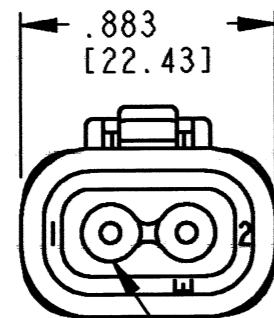

E-SEAL GROMMET $\triangle 7$

$\triangle 7$ SHRINK BOOT

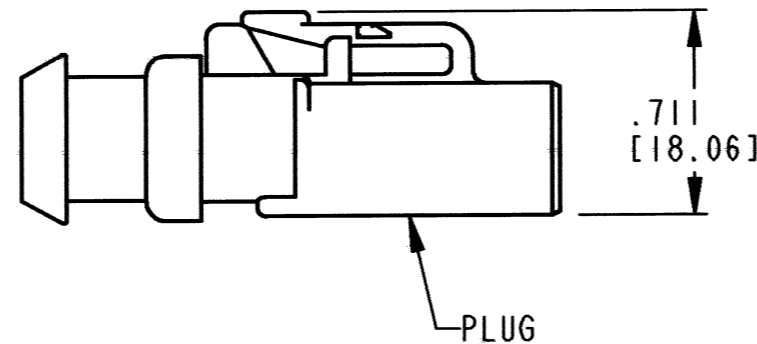
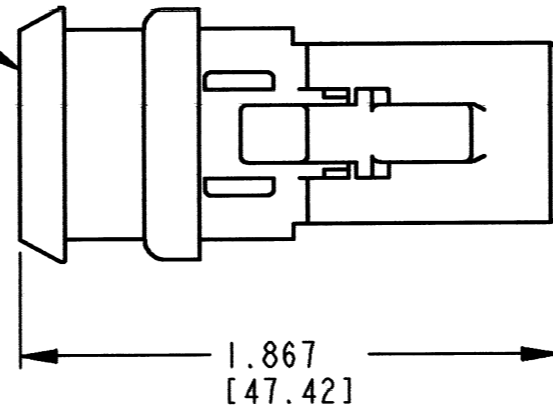

PLUG

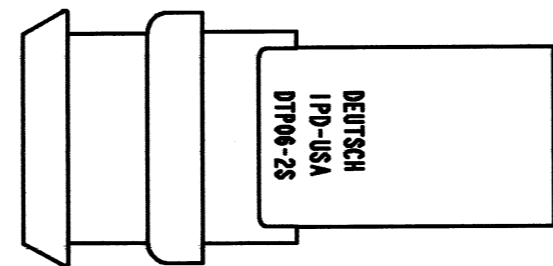
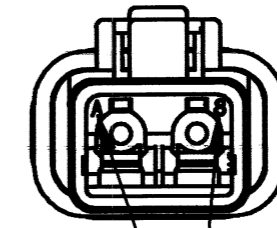

REV
A DTP06-2S-CE09

REVISIONS			
SYM	DESCRIPTION	DATE	APPROVED
NC	NEW RELEASE PER E.O. P19839	5/13/08	R.D.R.
A	REVISED PER E.O. P20259	4-16-10	RDR

DATE CODE: MONTH IS REPRESENTED BY SEQUENTIAL ALPHA CHARACTERS. EX: A=JANUARY; YEAR IS REPRESENTED BY LAST NUMERICAL DIGIT. EX: 8=2008

- $\triangle 7$. MODIFICATION: PLUG IS BLACK, GROMMET IS AN E-SEAL, SHRINK BOOT.
- 6. MATERIAL: HOUSING: PLASTIC; GROMMET: RUBBER
- 5. PART DESIGNED TO BE USED WITH DTP04-2P-**** RECEPTACLES. (****) = ALL HIGH TEMPERATURE MODIFICATIONS. CONSULT FACTORY FOR MODIFICATIONS.
- $\triangle 4$. FOR CONTACT AND WIRE PERFORMANCE AND APPLICATION CHARACTERISTICS SEE ENVELOPE DRAWING 0425-015-0000.
- 3. SECONDARY WEDGE LOCK SOLD SEPARATELY, WP-2S.
- 2. DIMENSION TOLERANCE: $\pm .025$ [.64].
- 1. DIMENSIONS ARE IN INCHES [mm].

NOTES: UNLESS OTHERWISE SPECIFIED

CONTACT SIZE	MIN. INSUL. O.D.	MAX INSUL. O.D.	WIRE RANGE [mm ²] REF ONLY $\triangle 4$
12	.097 [2.46]	.158 [4.01]	12-14 AWG [3.0-2.0]

SIGNATURE & DATE	
DR	P. CARNAHAN 04/21/08
CHK	<i>[Signature]</i> 4/16/10
PE	R. Millegan 3/10/10
APPD	<i>[Signature]</i> 4-15-10
SCALE	NONE WT —

PLUG
2 CONTACTS, SIZE 12
COLOR: BLACK, E-SEAL
-CE09 MOD
DTP SERIES

ENVELOPE

EP	MATL. CODE
3850 INDUSTRIAL AVE. HEMET, CA 92545 DEUTSCH INDUSTRIAL	
B	DTP06-2S-CE09
DWG SIZE	CODE 11139 SHEET OF