

THIS DRAWING IS UNPUBLISHED. RELEASED FOR PUBLICATION
 © COPYRIGHT 2017 BY TE CONNECTIVITY ALL RIGHTS RESERVED.

REVISIONS					
P	LTR	DESCRIPTION	DATE	DWN	APVD
A		INITIAL RELEASE PER ECO-17-017242	20NOV17	PT	TR

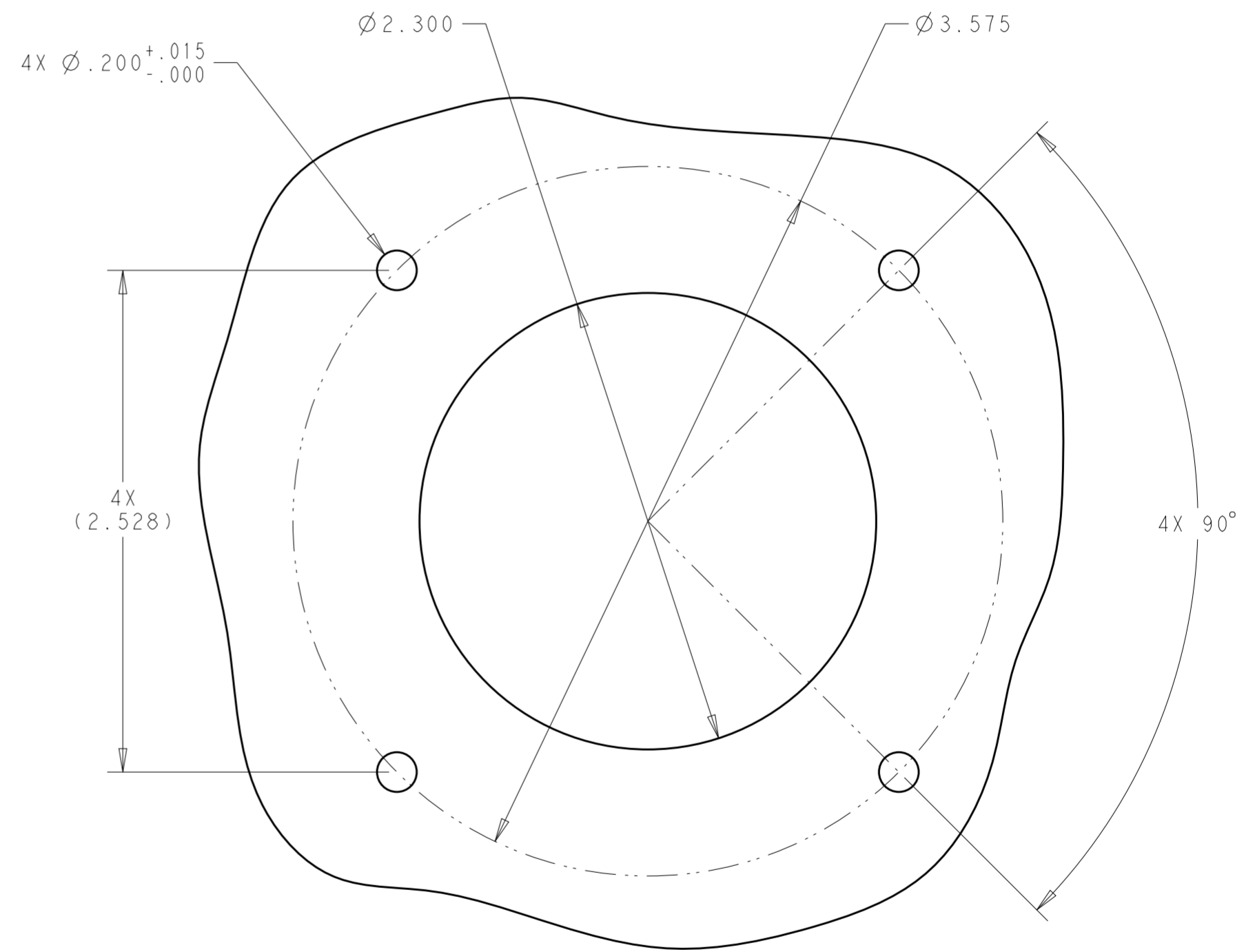
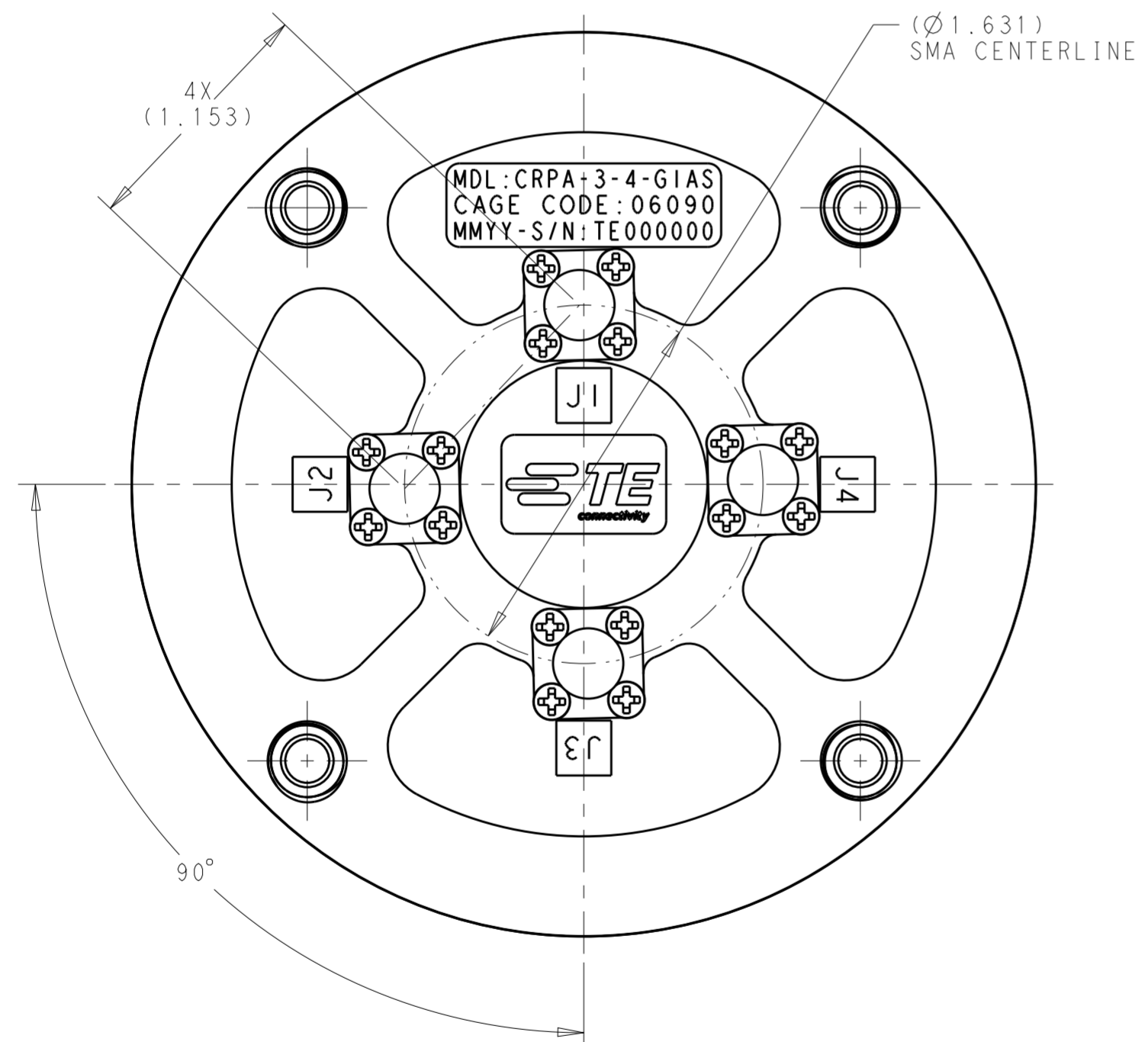
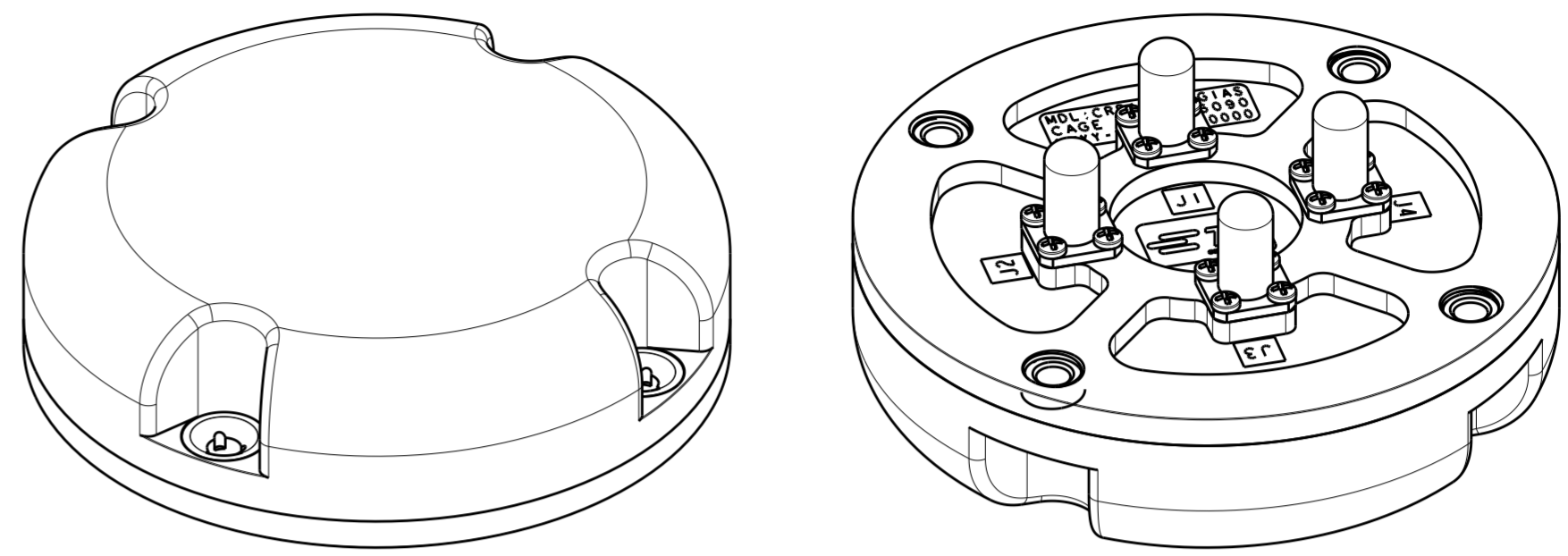
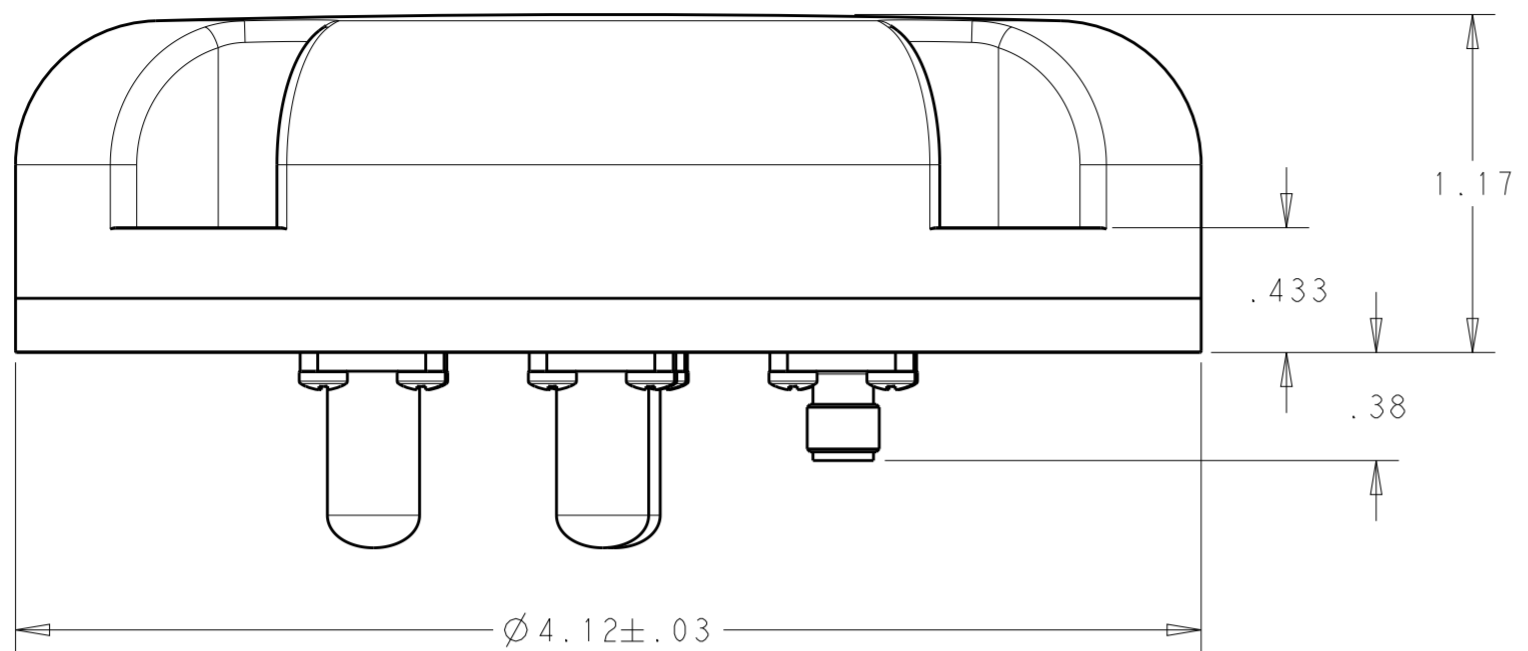

MOUNTING AND THROUGH HOLE DETAIL

INSTALLATION NOTES:

- USE OF SELF-LOCKING FASTENERS OR THREAD LOCKING COMPOUND IS RECOMMENDED ON EACH MOUNTING SCREW (4X).
- INTERFACE SEAL TO BE DEFINED AND FABRICATED BY CUSTOMER.
- MOUNTING SCREW LENGTH IS APPLICATION SPECIFIC AND IS DETERMINED BY CUSTOMER.
- ALODINE COATING MUST BE SCRATCH AND BLEMISH FREE FOR PROPER GROUNDING AND CORROSION PROTECTION TO ANTENNA BASE.
- INSERT (4X) NUMBER 10, 100°, FLATHEAD STAINLESS STEEL SCREWS INTO MOUNTING POSITIONS.
- THREAD SCREWS INTO MOUNTING HOLES UNTIL SCREW BEGINS TO CONTACT COUNTERSINK SURFACE.
- TORQUE SCREWS 18-20 POUND-INCH USING THE SEQUENCE PATTERN SHOWN (SHEET 2).
- TORQUE SMA CONNECTOR NUTS TO 8-9 POUND-INCH.

CRPA-3-4-GIAS	EG4466-000
DESCRIPTION	TCPN

THIS DRAWING IS A CONTROLLED DOCUMENT.		DWN	20OCT2017	TE Connectivity	NAME WIDEBAND 4-ELEMENT GNSS ANTENNA
DIMENSIONS: INCH		CHK	22NOV2017		
TOLERANCES UNLESS OTHERWISE SPECIFIED:		APVD		SIZE	
0 PLC	±	PRODUCT SPEC		CAGE CODE	DRAWING NO
1 PLC	±0.1	APPLICATION SPEC		A206090	CRPA-3-4-GIAS
2 PLC	±0.02			RESTRICTED TO	
3 PLC	±0.005			WEIGHT	0.88 LB
4 PLC	±0.0005			CUSTOMER DRAWING	SCALE 3:2 SHEET 1 OF 2 REV A
ANGLES	±				
FINISH					

REVISIONS				
P	LTR	DESCRIPTION	DATE	APVD

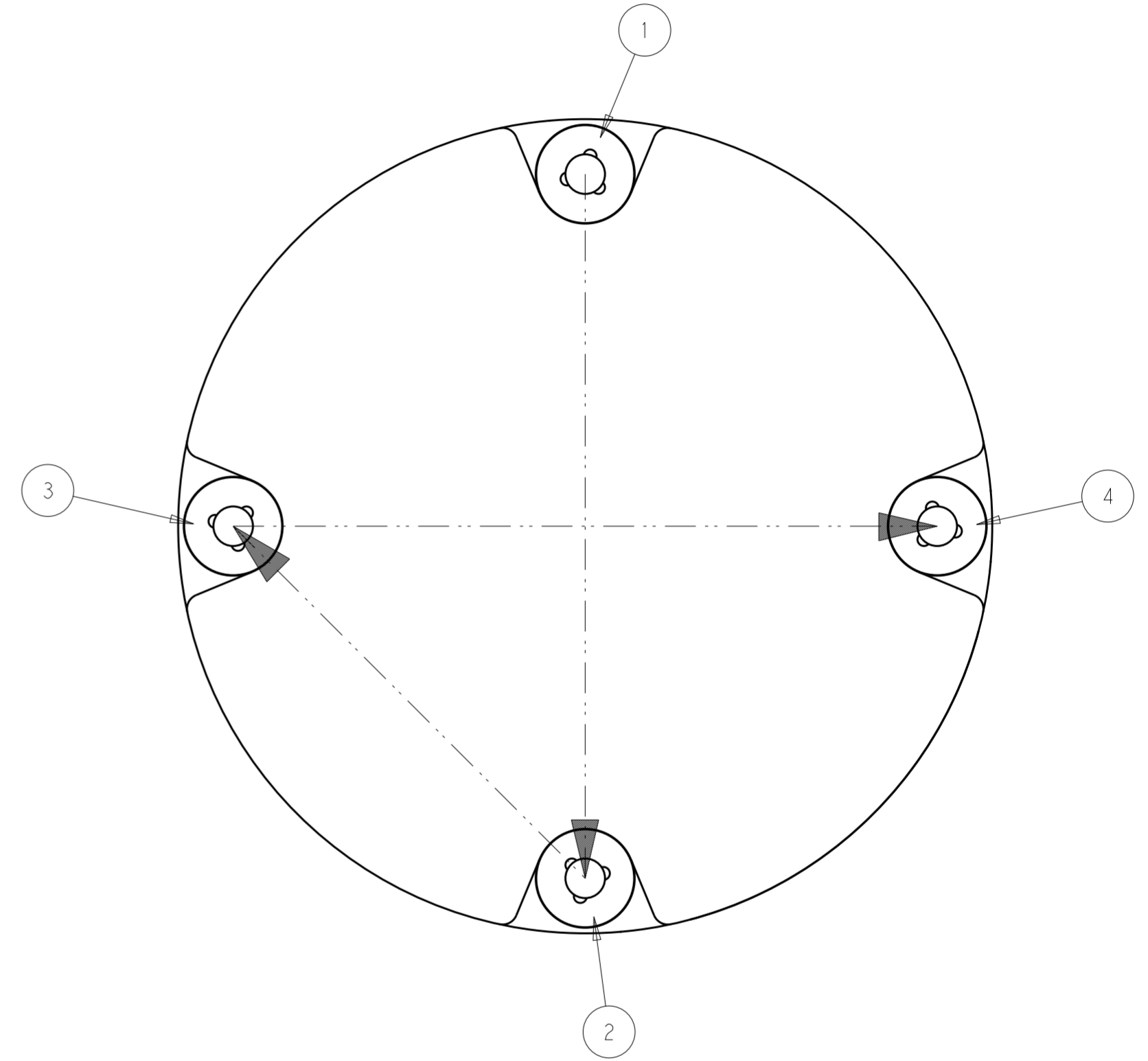
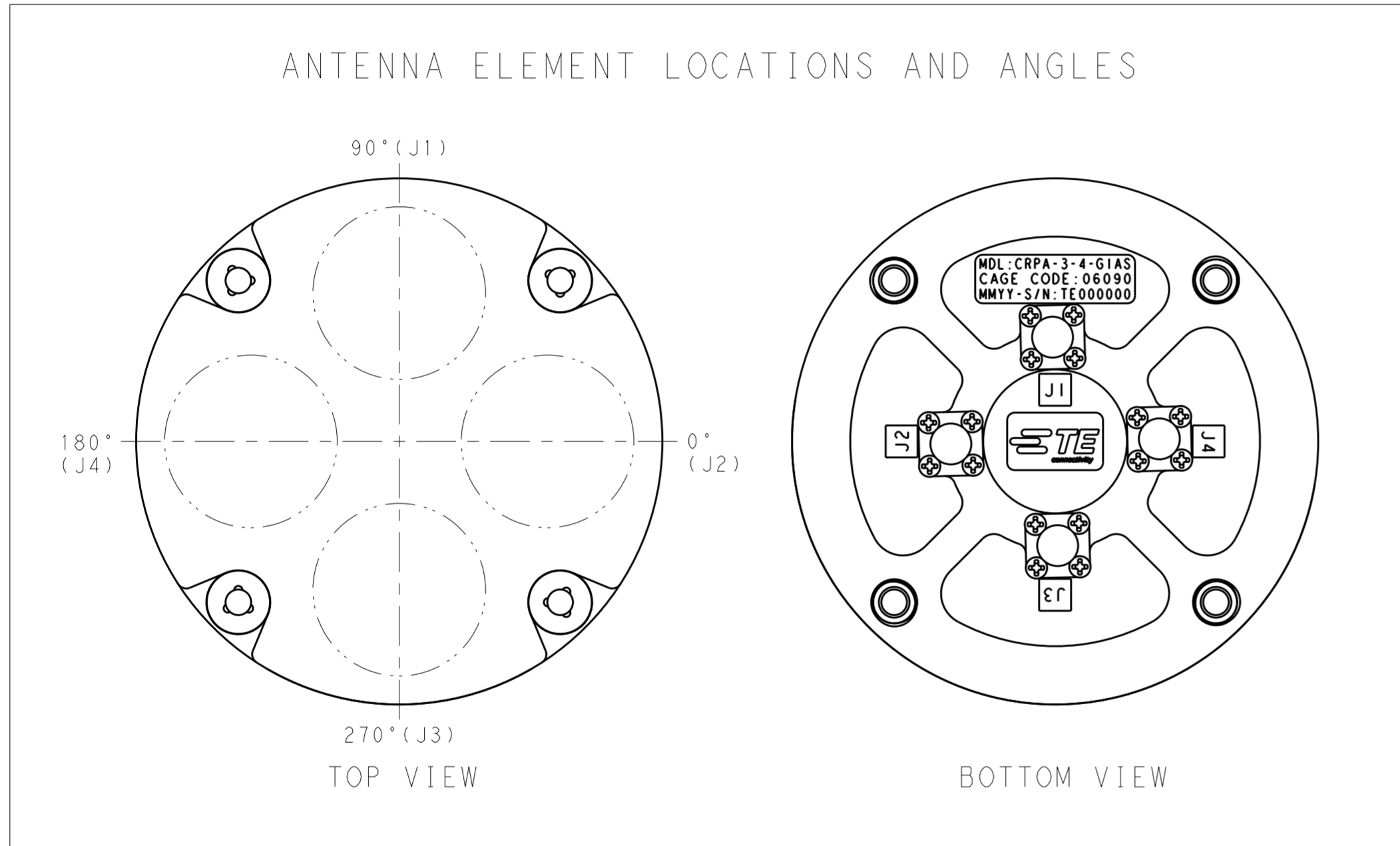

INSTALLATION TORQUE PATTERN

THIS DRAWING IS A CONTROLLED DOCUMENT.		DWN PTALLY 20OCT2017	STC TE Connectivity	
		CHK TRATZLAFF 22NOV2017		
DIMENSIONS: INCH		TOLERANCES UNLESS OTHERWISE SPECIFIED:		NAME WIDEBAND 4-ELEMENT GNSS ANTENNA
		0 PLC ±-	PRODUCT SPEC	SIZE
		1 PLC ±0.1	APPLICATION SPEC	CAGE CODE
		2 PLC ±0.02	WEIGHT	DRAWING NO
		3 PLC ±0.005	CUSTOMER DRAWING	RESTRICTED TO
MATERIAL		4 PLC ±0.0005	SCALE	3:2
		ANGLES ±-	SHEET	2 OF 2
		FINISH -	REV	A