

SCALE 1:2

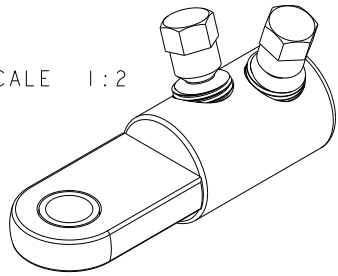

ITEM	TCPN NO	DESCRIPTION	QTY	DESCRIPTION
1	609722-000	BAH-017000082	2	M16x1.5 12.8 A/F 26.0 LONG BRASS SINGLE-SHEAR BOLT
2	799168-000	BAH-017070001	1	BRASS REDUCING BUSH 16.0 O/D 12.5 I/D 9.8 LONG
3	D48140-000	BSM-35/150-E-Z	1	BSM-35/150-E-Z INSERT BSM-35/150
4	C47646-000	BAH-014030112	1	MV BRASS END TERMINATION BODY - 31.5 O/D 16.2 I/D - CENTRE PALM WITH Ø17.0 HOLE

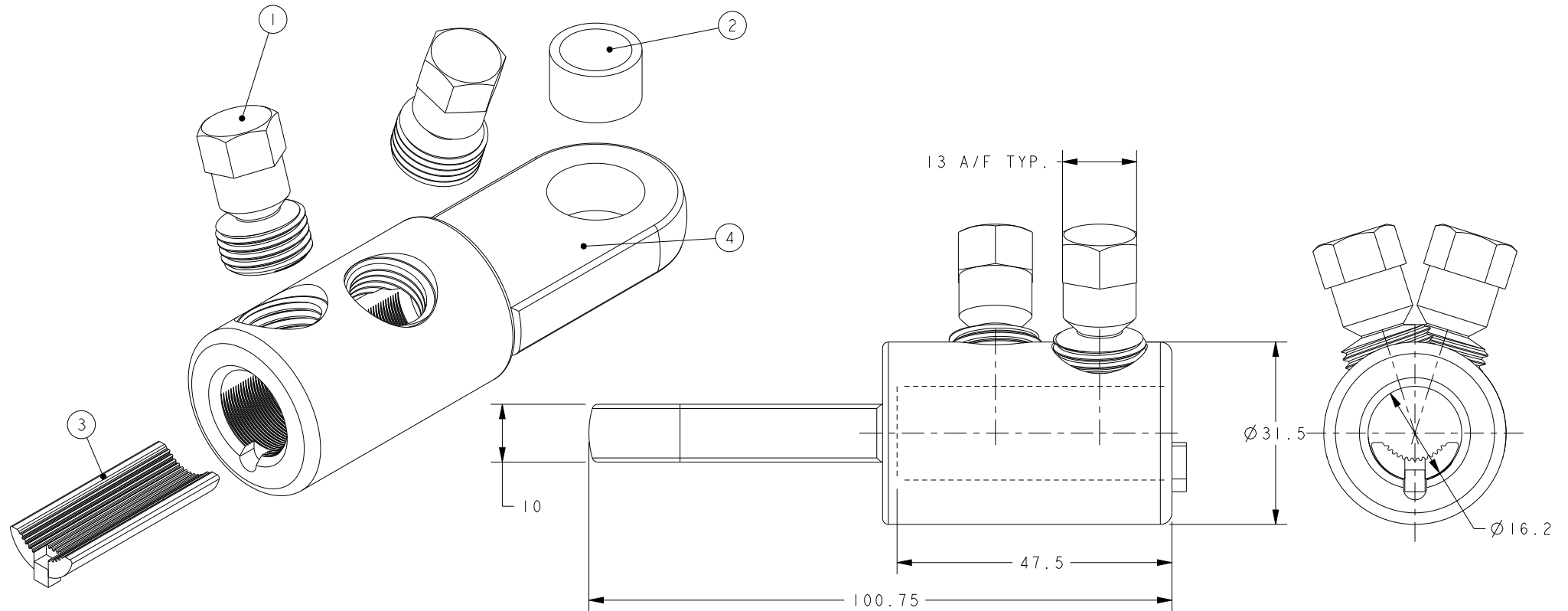

D	CHANGE INSERT REFERENCE	GC-00031	25/07/24
C	HEX BOLT HEAD REDUCED AS PER ECR	SD/DMR-GC-0020	21JAN21
B	B&H SHORT DESCRIPTION CORRECTED FROM VETB16/32-16UTB	BH-00004	25/11/04
A	FIRST ISSUE	S.P.W	13.6.02
Revision	Description	Name/ECN	Date

Design/Drawn	S.P.WEST	Date	13-Jun-02	Scale (UOS)	1:1	 THIRD ANGLE PROJECTION	 A4
TCPN	E26029-000	Part Weight	398g				
Drawing/Part No	BAH-024030127	Drawing Type	CUSTOMER DRAWING		Rev	D	



Material	-
Finish	-
Tolerances (UOS)	-
B&H Short Desc.	VETB16/32-16

- IF IN DOUBT ASK - DO NOT SCALE -	
Part Description	MV BRASS END TERMINATION - 31.5 O/D 16.2 I/D CENTRE PALM WITH Ø17.0 HOLE

REMOVE ALL BURRS AND SHARP EDGES - SURFACES TO BE FREE FROM SCRATCHES AND DEFECTS - ALL THREADS TO BS3643 PT 2

© 2017 TYCO ELECTRONICS UK LTD, WITHAM, UK