

4

3

2

1

THIS DRAWING IS UNPUBLISHED. RELEASED FOR PUBLICATION .19 .  
 © COPYRIGHT 19 BY AMP INCORPORATED. ALL RIGHTS RESERVED.

LOC	DIST	REVISIONS					
		P	LTR	DESCRIPTION	DATE	DWN	APVD
G	14			PROPOSED	06NOV00	JR	TM

**AMP**  
WIRE RANGE

12-10 AWG  
SOLID OR STRANDED

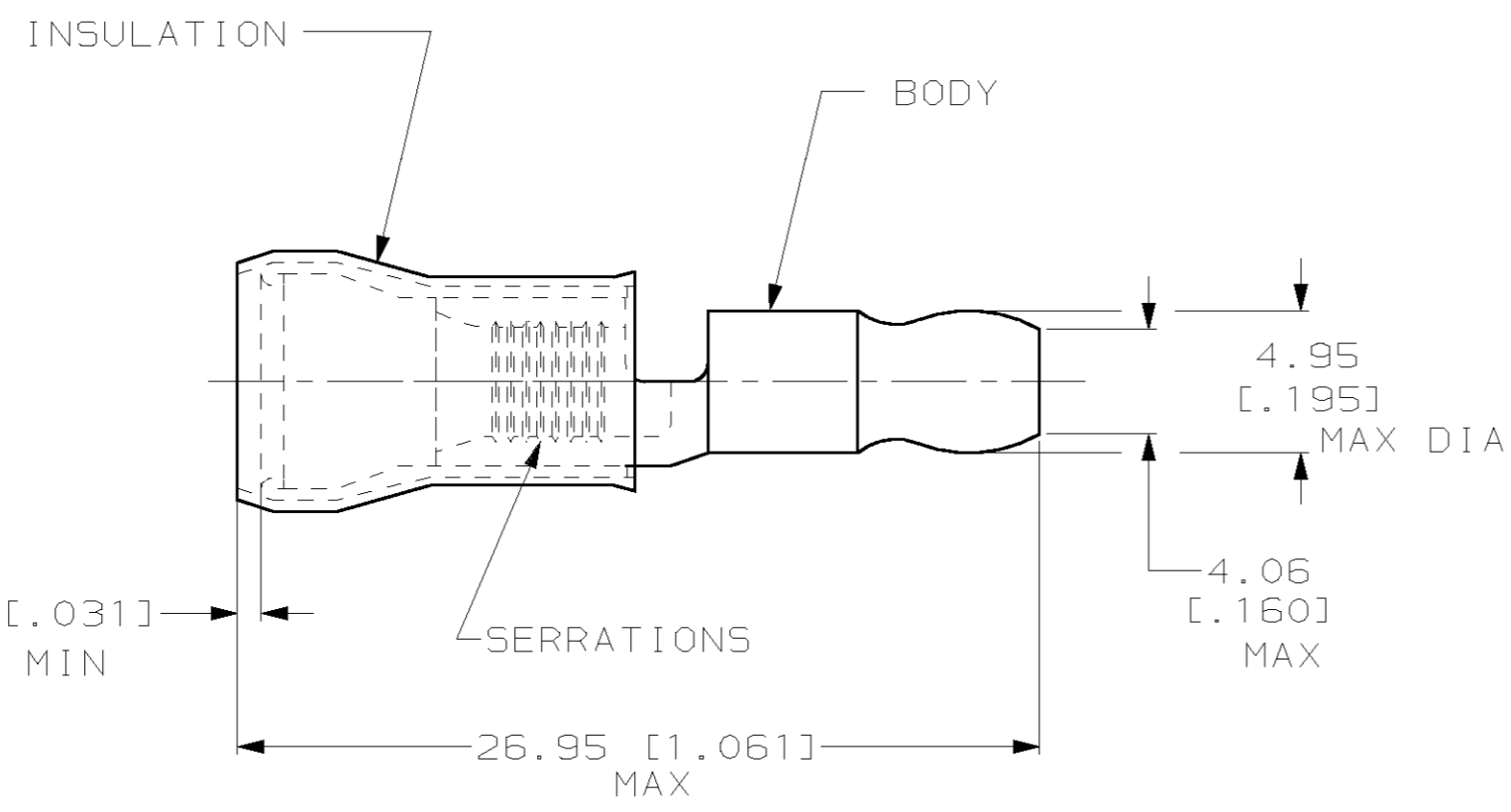

- 1 WIRE INSULATION DIA: 3.81-6.35 [.150-.250] DIA.
- 2 MATES WITH 4.57 [.180] SERIES RECEPTACLE.
- 3 PRELIMINARY - NOT FOR PRODUCTION

500	LOOSE PIECE	3 696260-1
QTY	PACKAGE TYPE	PART NO

AMP INCORPORATED  
CUSTOMER SERVICE SYSTEM

FOR ADDITIONAL PRODUCT INFORMATION OR COPIES OF DRAWINGS AND TECHNICAL DOCUMENTS  
PRODUCT INFORMATION CENTER  
1-800-522-6752

FOR APPLICATION TOOLING INFORMATION  
TOOLING ASSISTANCE CENTER  
1-800-722-1111

FOR ORDER ENTRY  
1-800-526-5142

MAX RECOMMENDED OPERATING TEMPERATURE:  
105°C [221°F]

VOLTAGE RATING:  
300 V MAX

CIRCULAR MIL AREA:  
2.62mm<sup>2</sup>-6.64mm<sup>2</sup> [5180-13100]

SOLID OR STRANDED

THIS DRAWING IS A CONTROLLED DOCUMENT FOR AMP INCORPORATED. IT IS SUBJECT TO CHANGE AND THE CONTROLLING ENGINEERING ORGANIZATION SHOULD BE CONTACTED FOR THE LATEST REVISION.

DIMENSIONS:  
mm [in]

TOLERANCES UNLESS OTHERWISE SPECIFIED:

0 PLC	±-
1 PLC	±-
2 PLC	±0.20 [.008]
3 PLC	±-
4 PLC	±-
ANGLES	±-

MATERIAL  
BODY: COPPER ASTM B-152  
SLEEVE: YELLOW NYLON

FINISH  
BODY & SLV, TIN PLATE  
PER ASTM B545

DWN JR RUTH 06NOV00	AMP Incorporated Harrisburg, PA 17105-3608	
CHK T MICHIELUTTI 06NOV00	NAME	
APVD T MICHIELUTTI 06NOV00	TERMINAL, 180 SERIES, SHUR PLUG, PIDG, PIN, WIRE SIZE: 12-10 AWG	
PRODUCT SPEC	SIZE	DRAWING NO
APPLICATION SPEC	A3	C-696260
WEIGHT	CAGE CODE 00779	SCALE 4:1
CUSTOMER DRAWING	SHEET 1 OF 1	REV 0